



Release Notes

Visure Authoring 6

DATE

October, 2020

AUTHOR

Visure Solutions, Inc.

Table of Contents

1	Visure Authoring Release Notes	3
1.1	Compatibility	3
1.2	Visure Requirements ALM 6.....	3
1.2.1	New features, enhancements and usability improvements.....	3
1	Questions? Next steps?.....	8

1 Visure Authoring Release Notes

1.1 Compatibility

WARNING

Please review this list carefully, as there may be database changes that can affect compatibility between versions.

Visure Authoring 6 is compatible with Visure Requirements ALM 6.0

1.2 Visure Requirements ALM 6

1.2.1 New features, enhancements and usability improvements

1.2.1.1 Onyx User Interface

Visure Authoring 6 features the new Onyx User interface, a state-of-the-art interface for easy collaboration. Users can easily access all the project documents and create and edit their own requirements, upload documents, share comments and transition the status of any project element. The one-click split window also provides users a hassle-free way to establish traceability between documents.

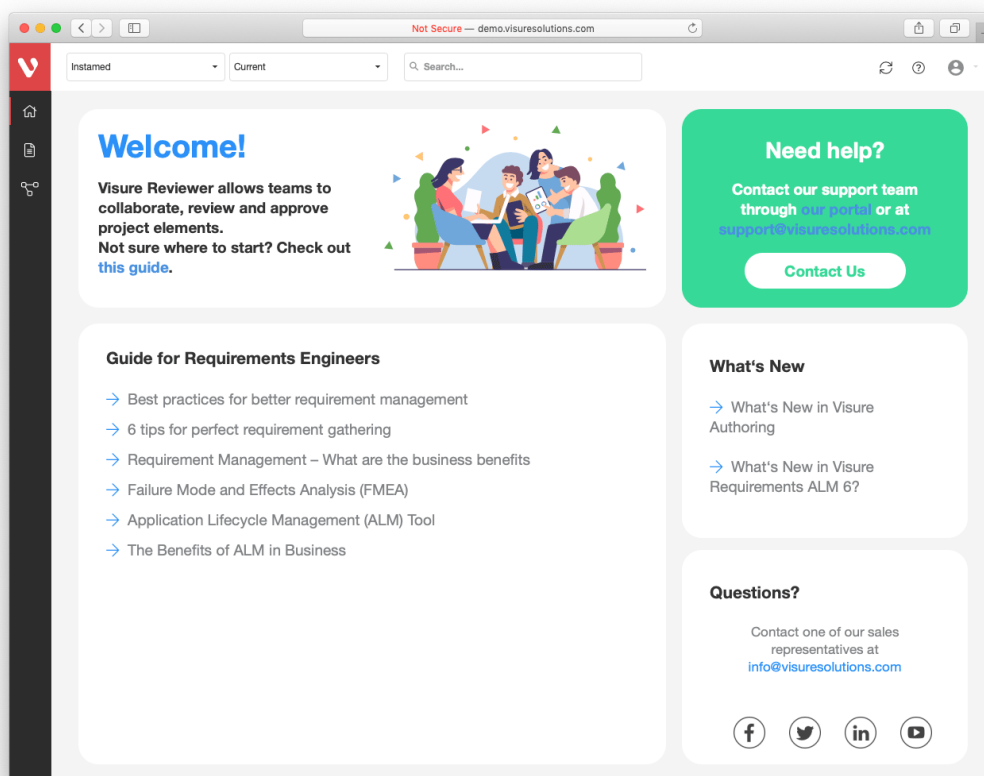

1.2.1.2 Reviews: Comments, baselines and electronic signature

Visure Authoring 6 helps users involve internal and external stakeholders in the review of the project artifacts by providing an easy way to provide feedback and gather explicit approval via electronic signature of baselines.

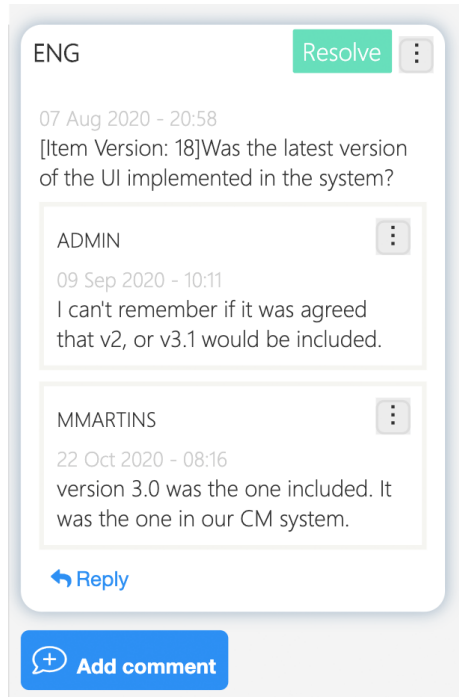

1.2.1.3 Document and list view

Users will be able to choose between a document and list view to display requirements, allowing them to visualize requirements and other items in the most convenient way to achieve their goals.

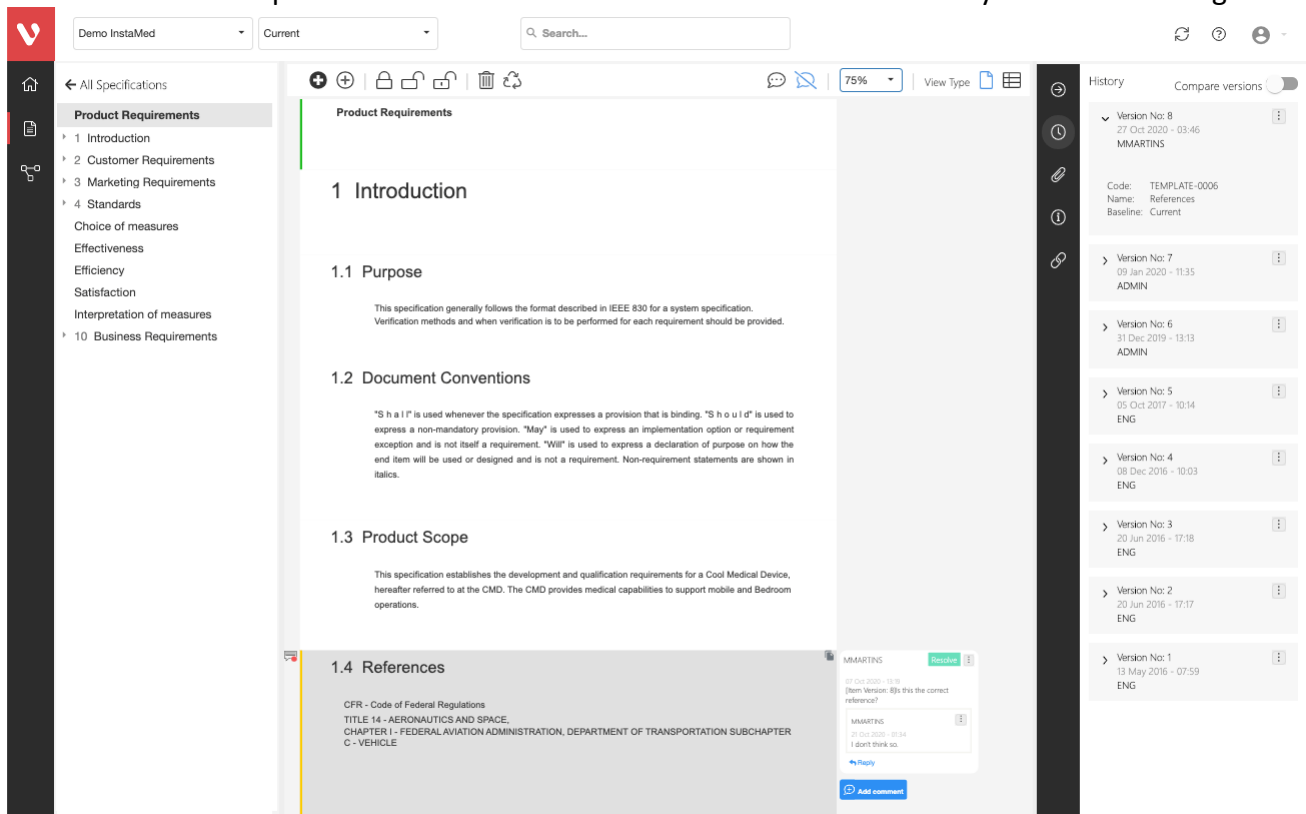

1.2.1.4 Editing

A new simplified way of creating and editing requirements, test cases, risks and other artifacts will facilitate the authoring of specifications with the organization. A full-featured HTML description will allow customers to upload pictures, tables and any other artifact to the specifications.



1.2.1.5 LaTeX support

Descriptions in Visure Authoring support mathematical equations using LaTeX, enabling users to quickly formulate and build up beautiful and accessible math equations in a simple way.

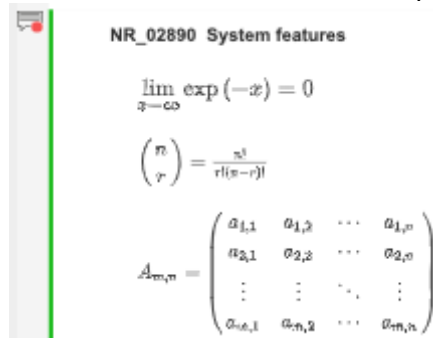

1.2.1.6 History

Visure Authoring provides a detailed tracking and audit trail of all changes made to the artifacts in the project, giving users full control and visibility over who made what, when and why. In a couple of clicks, all this information is made available to the user.

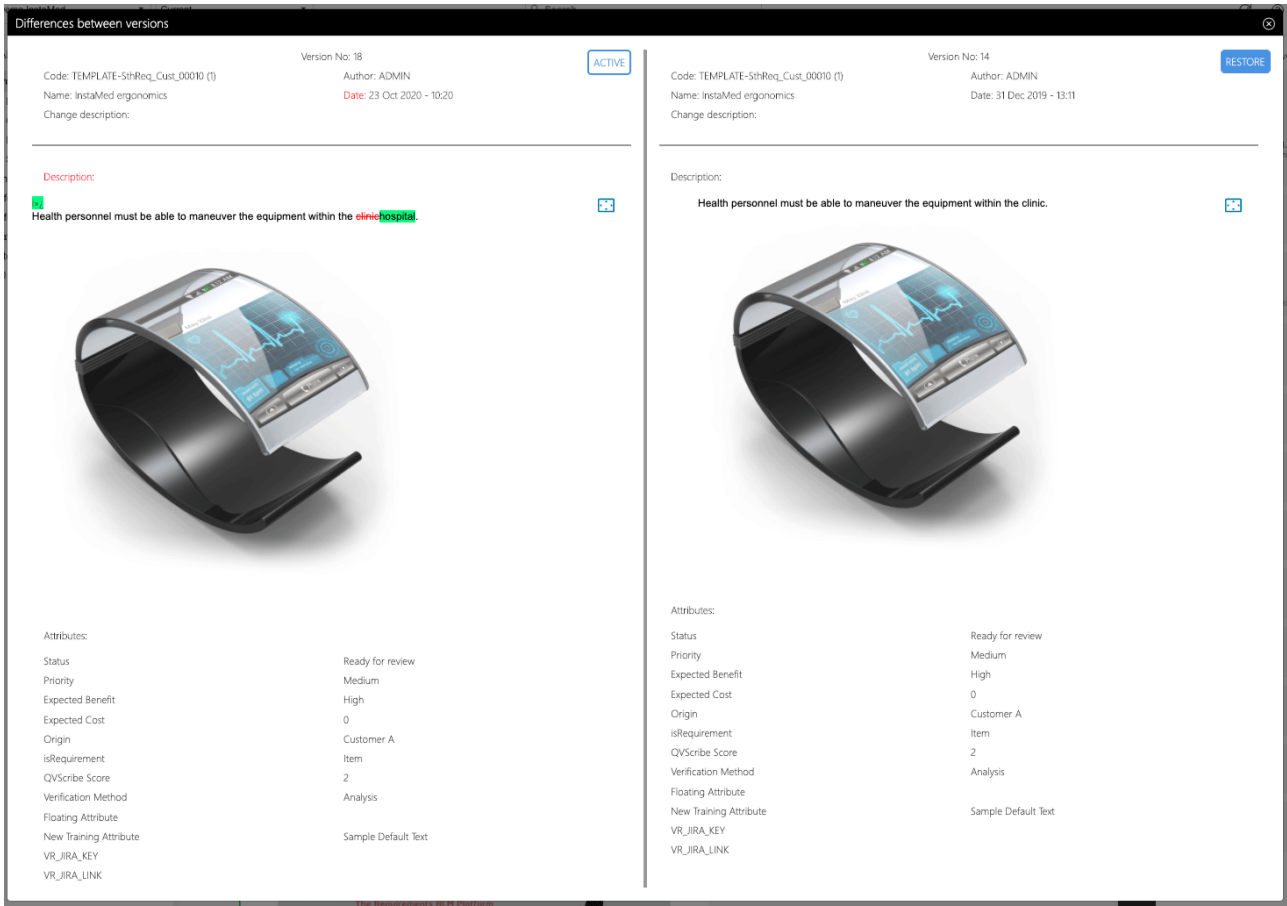

1.2.1.7 Associated files

Users can easily share information with other members of the team by uploading and attaching additional relevant documents to the requirements.

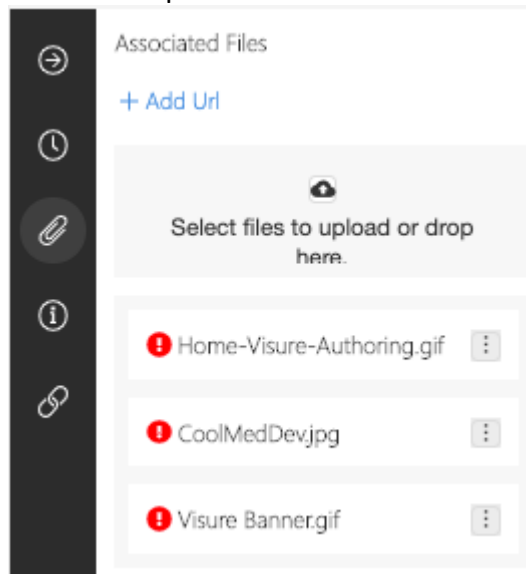

1.2.1.8 Attributes

The verification method of a requirement, status of a test case, probability of a risk and any other attribute can be managed from Visure Authoring in a simple and easy way, in a similar way to the full feature Visure Requirements ALM platform.

Code	Name	Priority	Verification Method	Created on	Status	Expected Benefit	isRequirement	QVScr... Score
Product Requirements	Product Requirements			6/14/2011				
TEMPLATE-0001	Introduction	Low		5/6/2016	Ready for review	Low	Heading	1
TEMPLATE-0002	Purpose	Low		5/6/2016	Ready for review	Low	Heading	1
TEMPLATE-0003	Document Conventions	Low		5/6/2016	Ready for review	Low	Heading	1
TEMPLATE-0005	Product Scope	Low		5/6/2016	Ready for review	Low	Heading	1
TEMPLATE-0006	References	Low		5/6/2016	Ready for review	Low	Heading	1
TEMPLATE-DOC_PRD_00030	Customer Requirements	Low		2/22/2016	Ready for review	Low	Heading	1
TEMPLATE-SthReq_Cust_00010 (1)	InstaMed ergonomics	Medium	Analysis	6/17/2011	Ready for review	High	Item	2
03310	New requirement from Vestas Test	High	Analysis	9/29/2020	Reviewed	High	Item	2
NR_02890	System features	Medium	Analysis	7/21/2020	Ready for review	High	Item	2
TEMPLATE-SthReq_Cust_00020 (1)	Preferences	High	Inspection	6/17/2011	Ready for review	Medium	Item	2
TEMPLATE-SthReq_Cust_00030 (1)	US Hospital	Low	Demonstration	1/23/2012	Ready for review	Low	Item	4
TEMPLATE-SthReq_Cust_00040 (1)	Ease of calibration	Medium	Inspection	1/23/2012	Ready for review	Low	Item	4
TEMPLATE-DOC_PRD_00040	Marketing Requirements	Low		2/22/2016	Ready for review	Low	Heading	1
TEMPLATE-SthReq_Mkt_00010 (1)	Company logo	Low	Testing	6/19/2011	More info needed	Medium	Item	4
SthReq_Mkt_00020 (1)	case colour	Low	Testing	6/17/2011	Approved	Medium	Item	1
TEMPLATE-SthReq_Mkt_00030 (1)	HD support for screens	Low	Inspection	6/17/2011	On Hold	Low	Item	4
TEMPLATE-DOC_PRD_00050	Standards	Low		2/22/2016	Ready for review	Low		
TEMPLATE-Std_00010 (1)	Air transportation - maximum sizes	Medium	Analysis	6/17/2011	Approved	Medium		
TEMPLATE-Std_00020 (1)	IATA Container Requirements Regulations	Low	Testing	1/13/2012	Reviewed	Medium		
TEMPLATE-IS09241-11_010 (1)	Choice of measures	High	Analysis	1/27/2012	Ready for review	Low		
TEMPLATE-IS09241-11_020 (1)	Effectiveness	High	Testing	1/27/2012	Ready for review	Low		
TEMPLATE-IS09241-11_030 (1)	Efficiency	Low	Inspection	1/27/2012	Ready for review	Low		
TEMPLATE-IS09241-11_040 (1)	Satisfaction	Medium	Inspection	1/27/2012	Ready for review	Low		
TEMPLATE-IS09241-11_050 (1)	Interpretation of measures	Medium	Testing	1/27/2012	Ready for review	Low		
TEMPLATE-DOC_PRD_00060	Business Requirements	Low		2/22/2016	Ready for review	Low		

1.2.1.9 Traceability

Users can manage the traceability between requirements, tests, risks and other artifacts of the project directly from Visure Authoring by establishing traceability through the split-screen capability, reviewing suspect links or navigating through the links.

Product Requirements

1 Introduction

1.1 Purpose

1.2 Document Conventions

1.3 Product Scope

1.4 References

2 Customer Requirements

System Requirements

TEMPLATE-SysReq_0010 (1) **Maximum weights and dimensions**
No single crate shall exceed maximum dimensions and weights for airplanes transporting systems to domestic or international municipal airports. Subassembly and field replaceable unit designs should consider install-ability and avoid the maximum shipping size where possible.

TEMPLATE-SysReq_0020 (1) **Packaging**
Packaging shall sufficiently protect the product during all approved shipping methods, including air and ground transportation modes. – Standard shipping test methods shall be used to test packaging. Changes to adapt this requirement to the modifications in the product architecture

TEMPLATE-SysReq_0030 (1) **Cart mobility**
Rolling the mobile carts shall require a low enough pushing and pulling force to be transported throughout the hospital by a small adult

TEMPLATE-SysReq_0040 (1) **Doorway thresholds**
The mobile carts shall be capable of rolling over standard doorway thresholds.

TEMPLATE-SysReq_0050 (1) **Standard truck elevator tailgates**
The mobile carts shall be capable of rolling up standard truck elevator tailgates.

TEMPLATE-SysReq_0060 (1) **Preference setting**
The system shall be able to save and later modify “preference settings” by Surgeon. These settings might include camera, scope, audio, video, and ergonomic preferences.

TEMPLATE-SysReq_0070 (1) **Calibration and setup**
Subsystems shall not be required to be uniquely matched. As long as each

1 Questions? Next steps?

We hope you found this tutorial useful, but we understand that you may have many more questions. Please feel free to contact us at helpdesk@visuresolutions.com for technical questions, or info@visuresolutions.com for pricing or licensing information.