



WILDFIRE

EDEN PRAIRIE

Parties & Special Events

WILDFIRE

EDEN PRAIRIE

Private Room Map & Capacities

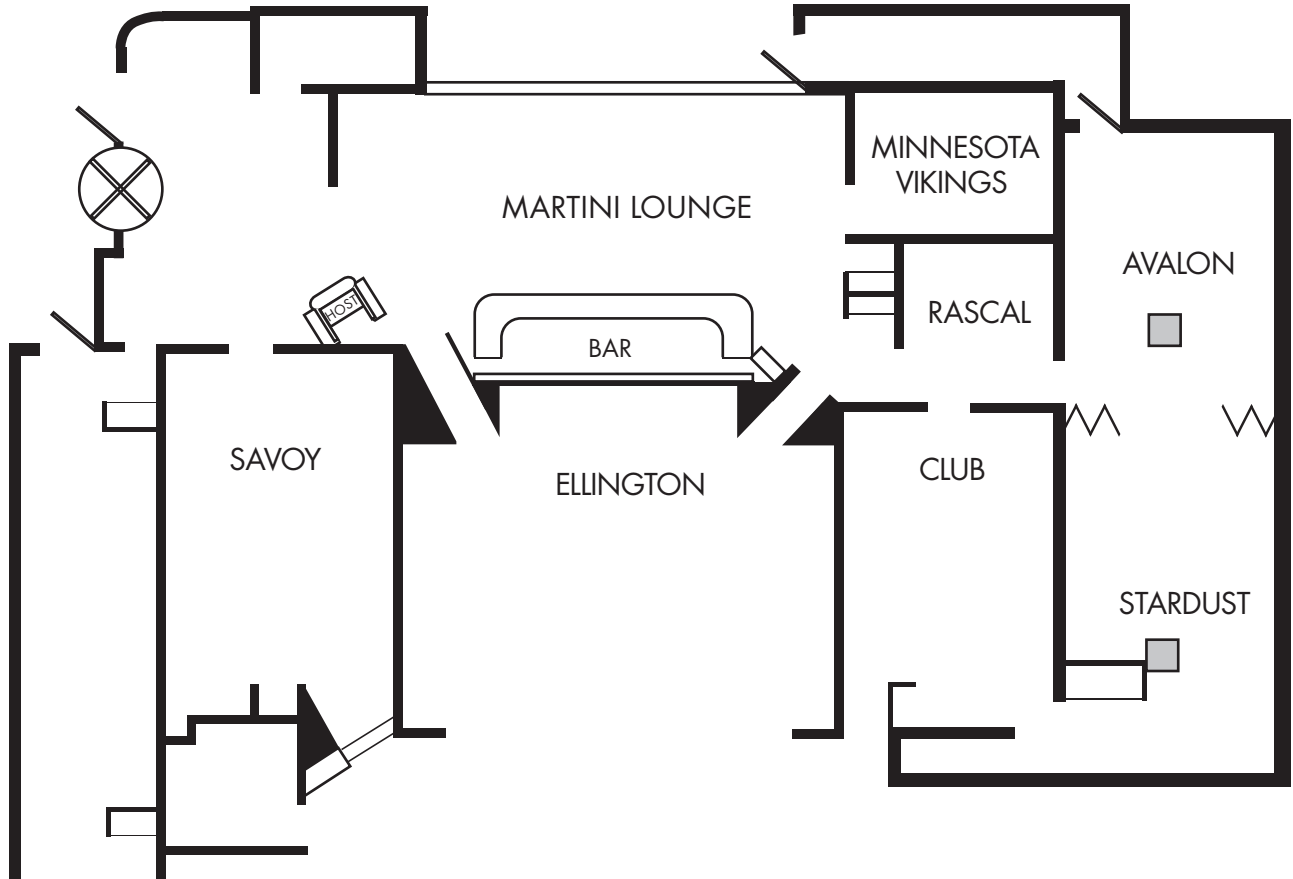

ROOM	MAXIMUM CAPACITY
SAVOY	-
ELLINGTON	-
MINNESOTA VIKINGS	12
RASCAL	12
CLUB	45
AVALON	30
STARDUST	40
AVALON / STARDUST	75+

WILDFIRE

Club Supper Menu

~ PERFECT FOR LARGE GATHERINGS ~

Served to your table family style

Appetizers

choose two - served family style

BAKED GOAT CHEESE • TOMATO & CHEESE FLATBREAD • GRILLED PEPPERONI FLATBREAD
MEDITERRANEAN CHICKEN SKEWERS • BISON MEATBALLS
CRISPY FRIED FRESH CALAMARI (\$2 per person extra) • JUMBO SHRIMP COCKTAIL (\$2 per person extra)
OVEN-ROASTED LUMP CRAB CAKES (\$2 per person extra)
APPLEWOOD-SMOKED BACON-WRAPPED SEA SCALLOP SKEWERS (\$2 per person extra)

Salads

choose two - served family style

TUSCAN KALE & SPINACH • CAESAR • GREEK • WILDFIRE CHOPPED SALAD

Main Courses

choose two - served family style

ROASTED HERB CHICKEN • BARBECUED CHICKEN • LEMON-PEPPER CHICKEN BREAST
CHICKEN MORENO • MUSHROOM-CRUSTED PORK CHOPS
DILL-CRUSTED WALLEYE • CEDAR-PLANKED SALMON
PASTA WITH ROASTED MARKET VEGETABLES & GOAT CHEESE • BARBECUED BABY BACK RIBS
BASIL HAYDEN'S® BOURBON TENDERLOIN TIPS
ROUMANIAN SKIRT STEAK (\$5 per person extra) • FRESH FISH OF THE DAY (\$5 per person extra)
ROASTED PRIME RIB OF BEEF (\$6 per person extra) • NEW YORK STRIP STEAK (\$8 per person extra)
FILET MIGNON (\$8 per person extra)

Side Dishes

choose two - served family style

RED SKIN MASHED POTATOES • ROASTED MARKET VEGETABLES • FRESH VEGETABLE OF THE DAY
ROASTED MUSHROOM CAPS • CREAMED SPINACH • FRESH BROCCOLI lemon vinaigrette

Desserts

choose two - served family style

TRIPLE-LAYER CHOCOLATE CAKE • HOMEMADE KEY LIME PIE
SEASONAL PIE • DOOR COUNTY CHERRY PIE
SEASONAL BERRIES CRISP WITH ICE CREAM • CHEESECAKE WITH CHERRY SAUCE

59.95 per person

Menu prices are subject to change.

WILDFIRERESTAURANT.COM

©2024 A LETTUCE ENTERTAIN YOU® RESTAURANT

MN - 05/24

WILDFIRE

Executive Club Supper Menu

~ PERFECT FOR LARGE GATHERINGS ~

Appetizers

choose two - served family style

BAKED GOAT CHEESE • TOMATO & CHEESE FLATBREAD • GRILLED PEPPERONI FLATBREAD
MEDITERRANEAN CHICKEN SKEWERS • BISON MEATBALLS
CRISPY FRIED FRESH CALAMARI (\$2 per person extra) • JUMBO SHRIMP COCKTAIL (\$2 per person extra)
OVEN-ROASTED LUMP CRAB CAKES (\$2 per person extra)
APPLEWOOD-SMOKED BACON-WRAPPED SEA SCALLOP SKEWERS (\$2 per person extra)

Salads

choose two - served family style

TUSCAN KALE & SPINACH • CAESAR • GREEK • WILDFIRE CHOPPED SALAD

Main Courses

individually plated main course - host to pre-select three, guest to select one upon arrival for dinner

ROASTED HERB CHICKEN • CEDAR-PLANKED SALMON • LEMON-PEPPER CHICKEN BREAST
CHICKEN MORENO • BARBECUED CHICKEN • FRESH FISH OF THE DAY
MUSHROOM-CRUSTED PORK CHOPS • BARBECUED BABY BACK RIBS
BASIL HAYDEN'S® BOURBON TENDERLOIN TIPS
NEW YORK STRIP STEAK • ROASTED PRIME RIB OF BEEF (16 oz.) • FILET MIGNON
PASTA WITH ROASTED MARKET VEGETABLES & GOAT CHEESE

Side Dishes

choose two - served family style

RED SKIN MASHED POTATOES • ROASTED MARKET VEGETABLES • FRESH VEGETABLE OF THE DAY
ROASTED MUSHROOM CAPS • CREAMED SPINACH • FRESH BROCCOLI lemon vinaigrette

Desserts

choose two - served family style

TRIPLE-LAYER CHOCOLATE CAKE • HOMEMADE KEY LIME PIE • SEASONAL PIE • DOOR COUNTY CHERRY PIE
SEASONAL BERRIES CRISP WITH ICE CREAM • CHEESECAKE WITH CHERRY SAUCE

75.95

per person

Maximum of 40 guests. • Menu prices are subject to change.

WILDFIRERESTAURANT.COM

©2024 A LETTUCE ENTERTAIN YOU® RESTAURANT

MN - 05/24

WILDFIRE

Club Lunch Menu

~ PERFECT FOR LARGE GATHERINGS ~

Served to your table family style

Appetizers

choose two - served family style

BAKED GOAT CHEESE • BISON MEATBALLS • MEDITERRANEAN CHICKEN SKEWERS
TOMATO & CHEESE FLATBREAD • GRILLED PEPPERONI FLATBREAD
CAESAR SALAD • WILDFIRE CHOPPED SALAD • TUSCAN KALE & SPINACH SALAD • GREEK SALAD
JUMBO SHRIMP COCKTAIL (\$2 per person extra) • CRISPY FRIED FRESH CALAMARI (\$2 per person extra)
OVEN-ROASTED LUMP CRAB CAKES (\$2 per person extra)
APPLEWOOD-SMOKED BACON-WRAPPED SEA SCALLOP SKEWERS (\$2 per person extra)

Main Courses

choose two - served family style

ROASTED HERB CHICKEN • BARBECUED CHICKEN • LEMON-PEPPER CHICKEN BREAST • CHICKEN MORENO
MUSHROOM-CRUSTED PORK CHOPS • CEDAR-PLANKED SALMON • DILL-CRUSTED WALLEYE
PASTA WITH ROASTED MARKET VEGETABLES & GOAT CHEESE
BASIL HAYDEN'S® BOURBON TENDERLOIN TIPS (\$2 per person extra)
FRESH FISH OF THE DAY (\$2 per person extra) • BARBECUED BABY BACK RIBS (\$2 per person extra)
ROUMANIAN SKIRT STEAK (\$2 per person extra) • ROASTED PRIME RIB OF BEEF (\$2 per person extra)
FILET MIGNON (\$3 per person extra)

Side Dishes

choose two - served family style

RED SKIN MASHED POTATOES • ROASTED MARKET VEGETABLES • FRESH BROCCOLI lemon vinaigrette
ROASTED MUSHROOM CAPS • CREAMED SPINACH • FRESH VEGETABLE OF THE DAY

INCLUDES coffee, tea & soda

33.95

per person

Desserts

\$3 per person extra

choose two - served family style

TRIPLE-LAYER CHOCOLATE CAKE • HOMEMADE KEY LIME PIE
SEASONAL PIE • DOOR COUNTY CHERRY PIE
SEASONAL BERRIES CRISP WITH ICE CREAM • CHEESECAKE WITH CHERRY SAUCE

Menu prices are subject to change.

WILDFIRERESTAURANT.COM

©2024 A LETTUCE ENTERTAIN YOU® RESTAURANT

MN - 05/24

WILDFIRE

Executive Club Lunch Menu

~ PERFECT FOR LARGE GATHERINGS ~

Appetizers

choose two - served family style

BAKED GOAT CHEESE • TOMATO & CHEESE FLATBREAD • GRILLED PEPPERONI FLATBREAD
CAESAR SALAD • WILDFIRE CHOPPED SALAD • TUSCAN KALE & SPINACH SALAD • GREEK SALAD
MEDITERRANEAN CHICKEN SKEWERS • BISON MEATBALLS
CRISPY FRIED FRESH CALAMARI (\$2 per person extra) • JUMBO SHRIMP COCKTAIL (\$2 per person extra)
OVEN-ROASTED LUMP CRAB CAKES (\$2 per person extra)
APPLEWOOD-SMOKED BACON-WRAPPED SEA SCALLOP SKEWERS (\$2 per person extra)

Main Courses

individually plated main course - host to pre-select three, guest to select one upon arrival for lunch

BARBECUED CHICKEN • ROASTED HERB CHICKEN • LEMON-PEPPER CHICKEN BREAST
CHICKEN MORENO • CEDAR-PLANKED SALMON • FRESH FISH OF THE DAY
MUSHROOM-CRUSTED PORK CHOP • BARBECUED BABY BACK RIBS
BASIL HAYDEN'S® BOURBON TENDERLOIN TIPS • ROASTED PRIME RIB OF BEEF (10 oz.)
FILET MIGNON • PASTA WITH ROASTED MARKET VEGETABLES & GOAT CHEESE

Side Dishes

choose two - served family style

RED SKIN MASHED POTATOES • ROASTED MARKET VEGETABLES • CREAMED SPINACH
ROASTED MUSHROOM CAPS • FRESH BROCCOLI lemon vinaigrette • FRESH VEGETABLE OF THE DAY

INCLUDES coffee, tea & soda

39.95
per person

Desserts

(\$3 per person extra)

choose two - served family style

TRIPLE-LAYER CHOCOLATE CAKE • HOMEMADE KEY LIME PIE
SEASONAL PIE • DOOR COUNTY CHERRY PIE
SEASONAL BERRIES CRISP WITH ICE CREAM • CHEESECAKE WITH CHERRY SAUCE

Maximum of 40 guests. • Menu prices are subject to change.

WILDFIRERESTAURANT.COM

©2024 A LETTUCE ENTERTAIN YOU® RESTAURANT

MN - 05/24

WILDFIRE

Passed Appetizer & Mini Desserts Menu

ALL OF THE ITEMS BELOW ARE PRICED PER DOZEN • THREE DOZEN MINIMUM PER ITEM • THREE-DAY NOTICE REQUIRED

Seafood

MINI LUMP CRAB CAKES	44.00
CRISPY MANGO-GLAZED SHRIMP	36.00
TUNA TARTARE ON TOAST POINTS	40.00
SHRIMP COCKTAIL	40.00
BLUE CRAB DEVILED EGGS	36.00

Beef & Bison

STEAK RUMAKI	46.00
BEEF TENDERLOIN ON BBQ POTATO CHIPS	46.00
STEAKHOUSE CHEDDAR BURGER SLIDERS	39.00
BACON & CHEDDAR DATES	32.00
BISON MEATBALLS	32.00

Chicken

CHICKEN WELLINGTON	32.00
CRISPY COCONUT CHICKEN BITES	32.00
ROAST CHICKEN & WILD MUSHROOM QUESADILLAS	28.00
CRISPY CHICKEN SLIDERS	30.00
BARBECUE CHICKEN FLATBREAD	20.00

Vegetarian

GOAT CHEESE-STUFFED MUSHROOMS	25.00
MINI CORNBREAD MUFFINS	18.00
MAC & CHEESE BITES	24.00
TOMATO & 3-CHEESE TARTINE	25.00
MEDITERRANEAN FLATBREAD	20.00

Mini Desserts

CHOCOLATE CHIP SKILLET COOKIES	24.00
KEY LIME PIES	30.00
CHERRY CHEESECAKE BITES	32.00
CHOCOLATE MOUSSE CUPCAKES	30.00
DOOR COUNTY CHERRY BARS	30.00

Platters

all of the items below are priced per platter • all platters serve 10 - 12 people

VEGETABLES WITH RED PEPPER DIP	40.00
CHEESE PLATTER	50.00
SEASONAL FRESH FRUIT	60.00

Menu prices are subject to change.

WILDFIRERESTAURANT.COM

©2022 A LETTUCE ENTERTAIN YOU® RESTAURANT

09/22

WILDFIRE

Bar Packages

Beer & Wine

SELECT IMPORTED & DOMESTIC DRAUGHT, BOTTLED BEERS & HARD CIDER,
WILDFIRE CHARDONNAY, WILDFIRE CABERNET SAUVIGNON,
SODA, JUICES, COFFEE & TEA

One Hour	20.00	per person
Two Hours	25.00	per person
Three Hours.....	30.00	per person
Four Hours	35.00	per person

House Brands

FEATURING HOUSE BRAND LIQUORS,
SELECT IMPORTED & DOMESTIC DRAUGHT, BOTTLED BEERS & HARD CIDER,
WILDFIRE CHARDONNAY, WILDFIRE CABERNET SAUVIGNON,
SODA, JUICES, COFFEE & TEA

One Hour	23.00	per person
Two Hours	28.00	per person
Three Hours.....	33.00	per person
Four Hours	38.00	per person

Call Brands

FEATURING CALL BRAND LIQUORS,
SELECT WILDFIRE SPECIALTY MARTINIS & CLASSIC COCKTAILS,
IMPORTED & DOMESTIC DRAUGHT, BOTTLED BEERS & HARD CIDER,
BOULDER BANK SAUVIGNON BLANC, HESS SHIRTAIL RANCHES CHARDONNAY,
ELOUAN PINOT NOIR, CONUNDRUM RED BLEND,
SODA, JUICES, COFFEE & TEA

One Hour	27.00	per person
Two Hours	32.00	per person
Three Hours.....	37.00	per person
Four Hours	42.00	per person

Premium Brands

FEATURING PREMIUM BRAND LIQUORS,
WILDFIRE SPECIALTY MARTINIS & CLASSIC COCKTAILS,
IMPORTED & DOMESTIC DRAUGHT, BOTTLED BEERS & HARD CIDER,
MASO CANALI PINOT GRIGIO, GROOM SAUVIGNON BLANC, BONANNO CHARDONAY,
LA CREMA PINOT NOIR, KILLKA MALBEC, FRANCISCAN ESTATE CABERNET SAUVIGNON,
SODA, JUICES, COFFEE & TEA

One Hour	32.00	per person
Two Hours	37.00	per person
Three Hours.....	42.00	per person
Four Hours	47.00	per person

*For a list of our House Brand Liquors, Call Brand Liquors & Premium Brand Liquors included in our packages,
please ask our Parties & Special Events Manager. Bar Packages available for private events only.

WILDFIRERESTAURANT.COM

©2024 A LETTUCE ENTERTAIN YOU® RESTAURANT

MN - 04/24