

WINDERMERE

MAMBOURIN



LOT 2445 - BROOKLYN 22

FROM **\$644,500***

boutique
homes

*PRICE BASED ON STANDARD FLOOR PLAN AND FACADE.
IMAGE DEPICTS UPGRADE ITEMS NOT INCLUDED IN THE PRICE.

4 2 2

| | |
|------------------|-------------------------|
| Land Size | 350m² |
| Frontage | 12.5m |
| Depth | 28m |

INCLUSION LIST

- STUNNING FAÇADE INCLUDED
- WESTINGHOUSE 600MM APPLIANCES
- DOUBLE GLAZING
- QUALITY CAROMA BASINS AND TAPWARE

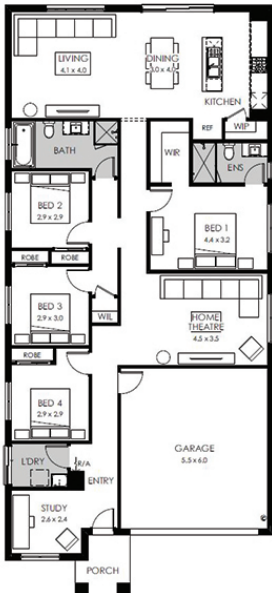

mywindermere.com.au | 1300 008 555
275 Greens Road Mambourin VIC 3024

PROUDLY DEVELOPED BY
RISLAND

DISCLAIMER: Prices are indicative only and subject to change without notice. Risland is responsible for the sale of the land only. Areas, dimensions and lot layouts are indicative only subject to the terms in the Contract of Sale. Floor plans, specifications and finishes relating to the construction of a home are subject to the building contract with the builder. Purchasers will be required to comply with construction and design requirements – refer to the Contract of Sale, a copy of which is available at our Sales Gallery.