



www.seura.com  
 PH. 920.857.9069  
 FAX 920.857.9490

Reseller

Drawing ID Number

Date Created

Revised Date

6/MAR/2023

Item and Description  
 LMR-2400x3600-RE-VE-COB5-SC-ES-DM  
 24.000"(W) X 36.000"(H) Custom Surface-Mounted Mirror with Veda Lighted Design and Silver Mirror Glass

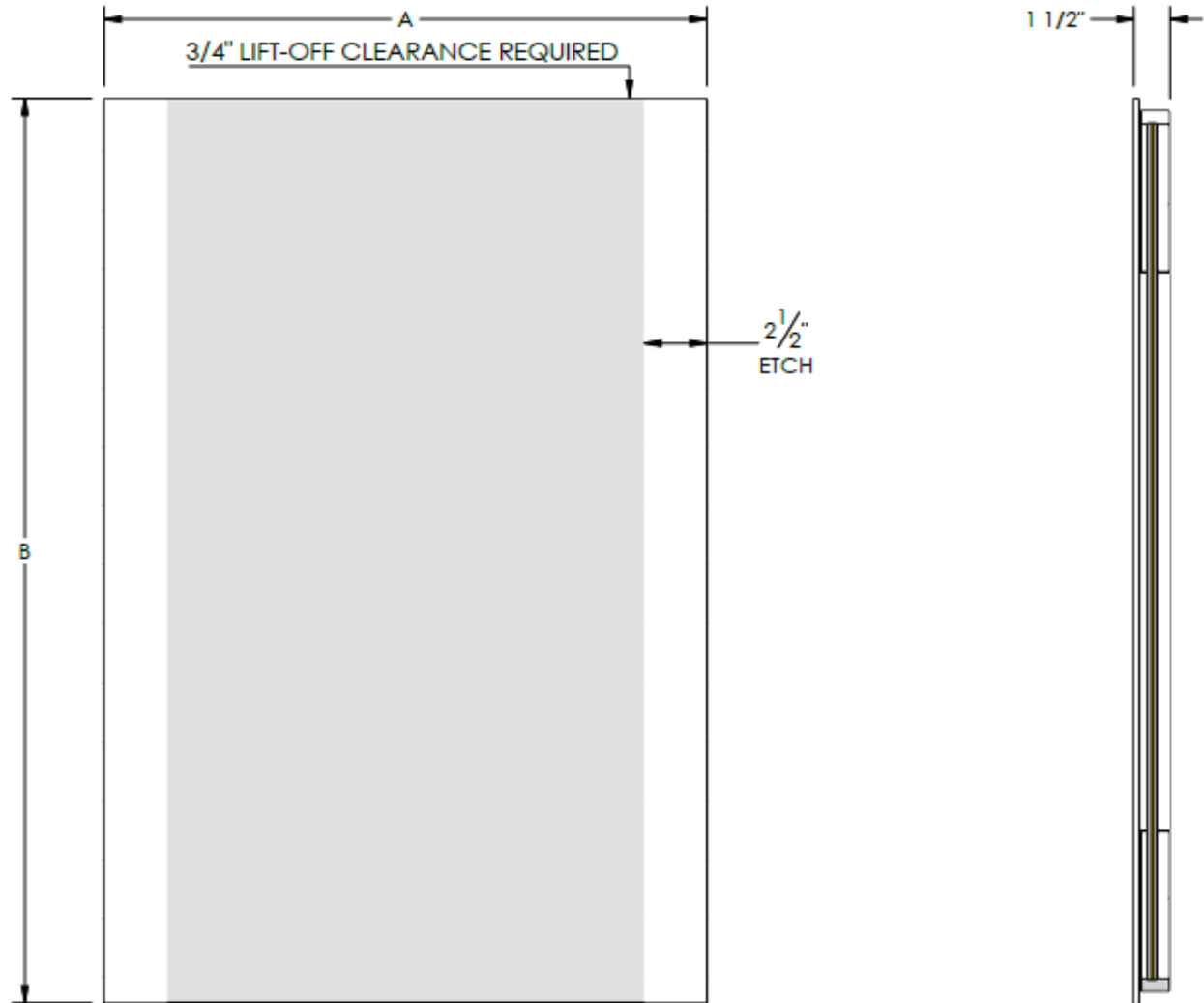

Letter Key:

**A:** 24.000

**B:** 36.000

**SIGNATURE:**

**DATE:**

NOTE: PLEASE SIGN AND DATE THIS PAGE BEFORE RETURNING TO SEURA, SIGNIFYING YOU AGREE TO ALL SPECIFICATIONS SHOWN ON ALL DRAWING SHEETS. THE BUILD PROCESS WILL NOT BEGIN WITHOUT AN AUTHORIZED SIGNATURE. FOR DRAWINGS THAT REQUIRE REVISIONS, SEND THE REVISIONS TO SEURA NOTED ON THE ORIGINAL DRAWINGS. A REVISED DRAWING PACKAGE WILL BE RE-SENT FOR SIGNATURE.

TOLERANCES  
 (UNLESS OTHERWISE NOTED)  
 FRACTIONAL: 1/8"  
 ANGULAR: 1.0  
 TWO PLACE DECIMAL: .03"  
 THREE PLACE DECIMAL: .015"

**PROPRIETARY AND CONFIDENTIAL:**

THE INFORMATION CONTAINED IN THIS DOCUMENT IS THE SOLE PROPERTY OF THE MANUFACTURER. ANY REPRODUCTION IN PART, OR AS A WHOLE, WITHOUT THE WRITTEN PERMISSION OF MANUFACTURER, IS PROHIBITED

**SHEET**  
**1**

**CLICK LINK FOR FULL INSTALLATION INSTRUCTIONS**

[seura.com/manuals](https://seura.com/manuals)

**LED LIGHTING SPECIFICATIONS**

4.6 W/FT

3000K COLOR TEMPERATURE

**DRIVER SPECIFICATIONS**

INPUT: 120V, 50/60Hz

Dimming

REQUIRES GFCI

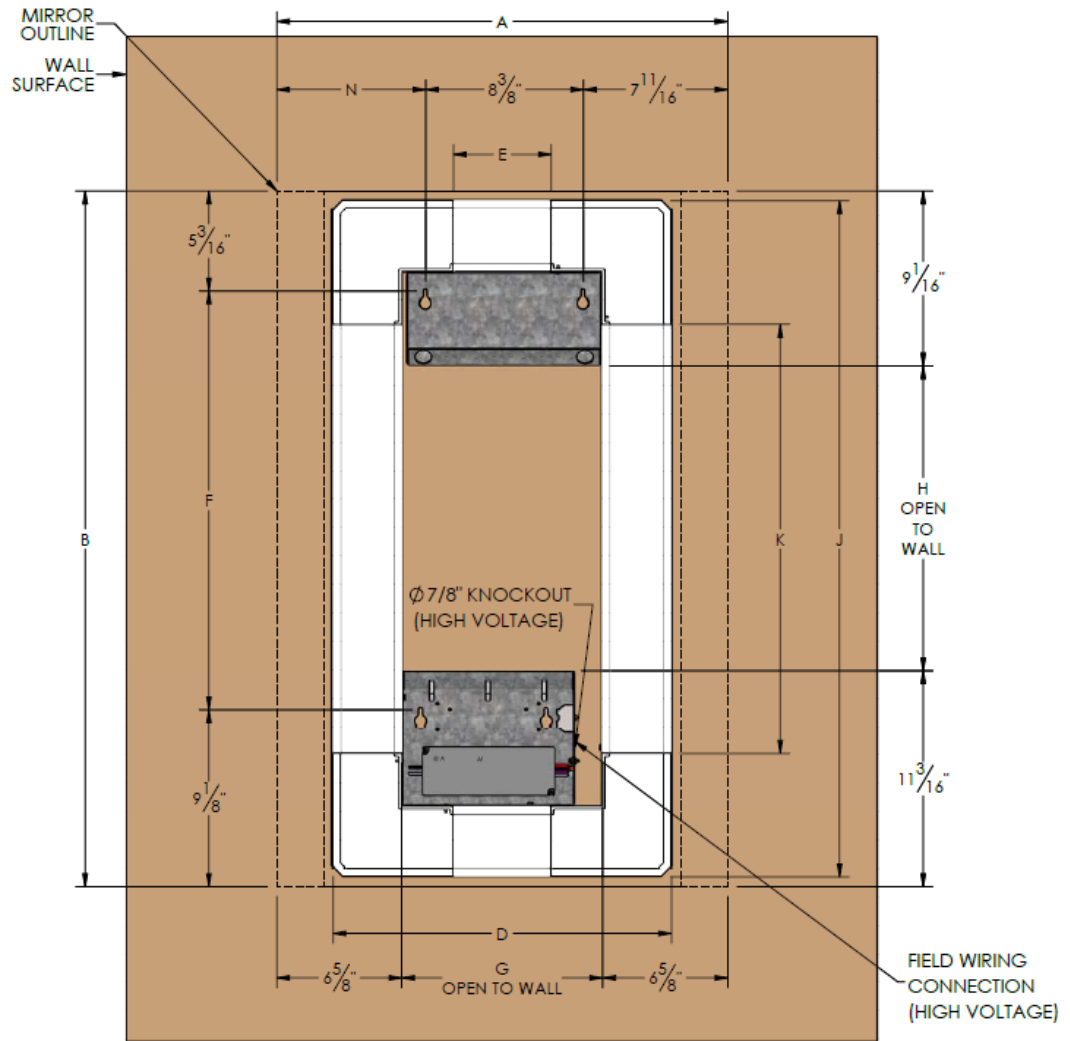

**Letter Key:**

**A:** 24.000

**B:** 36.000

**D:** 18.000

**E:** 5.200

**F:** 21.688

**G:** 10.750

**H:** 15.750

**J:** 35.000

**K:** 22.200

Model Number

LMR-2400x3600-RE-VE-COB5-SC-ES-DM

Date Created

6/MAR/2023

Revised Date

TOLERANCES  
(UNLESS OTHERWISE NOTED)

FRACTIONAL: 1/8"  
ANGULAR: 1.0  
TWO PLACE DECIMAL: .03"  
THREE PLACE DECIMAL: .015"

PROPRIETARY AND CONFIDENTIAL:

THE INFORMATION CONTAINED IN THIS DOCUMENT IS THE SOLE PROPERTY OF THE MANUFACTURER. ANY REPRODUCTION IN PART, OR AS A WHOLE, WITHOUT THE WRITTEN PERMISSION OF MANUFACTURER, IS PROHIBITED

**SHEET**

**2**

INITIALS & DATE

ADHESION BY: \_\_\_\_\_

Notes:

- MIRROR SHOWN FROM REAR
- ADHERE MOUNTING BRACKETS TO MIRROR USING SOP S-P-FI-02

## GLASS ADHESION

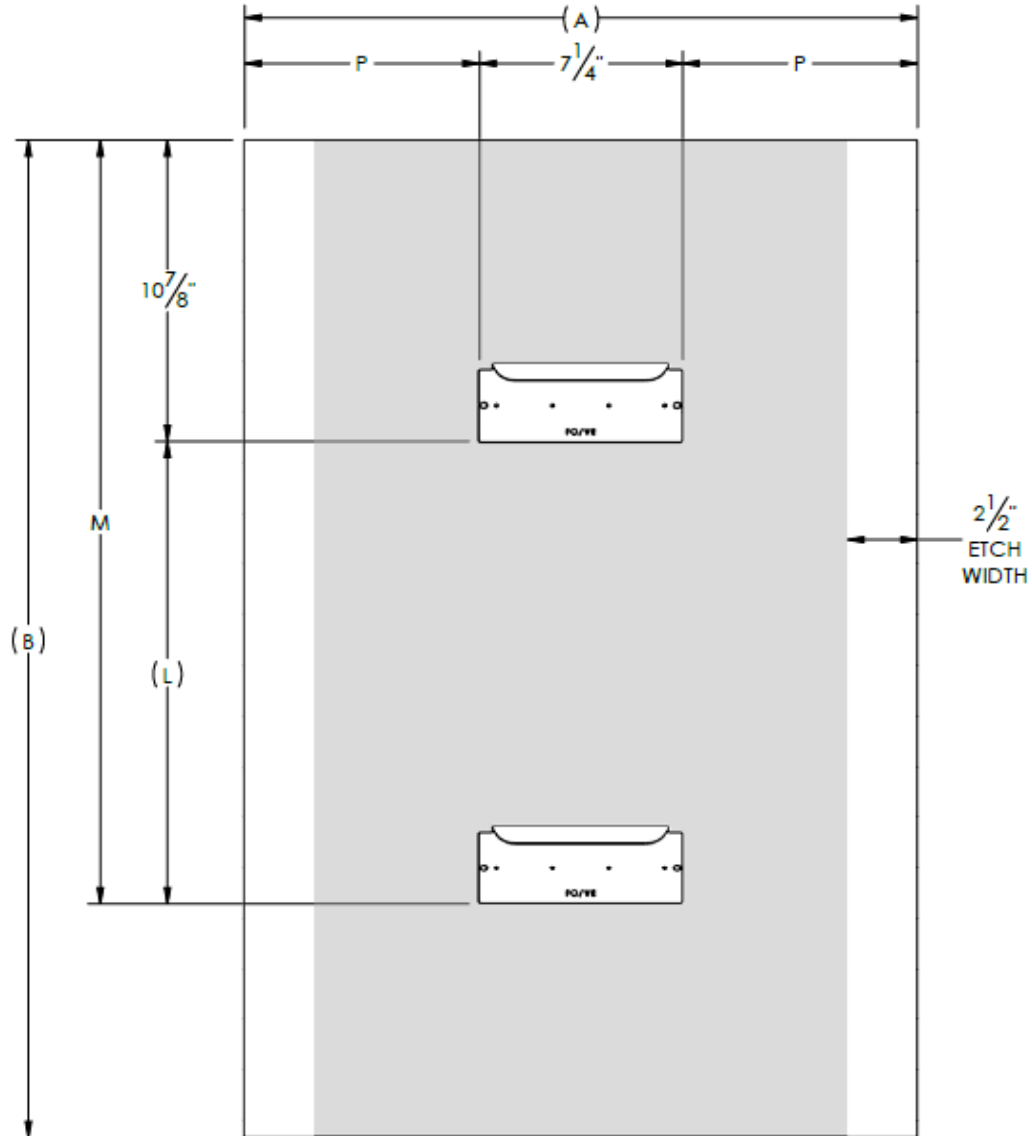

### Letter Key:

- A:** 24.000
- B:** 36.000
- L:** 16.688
- M:** 27.563

Model Number

LMR-2400x3600-RE-VE-COB5-SC-ES-DM

Date Created

6/MAR/2023

Revised Date

Drawn By

PROPRIETARY AND CONFIDENTIAL:

THE INFORMATION CONTAINED IN THIS DOCUMENT IS THE SOLE PROPERTY OF THE MANUFACTURER. ANY REPRODUCTION IN PART, OR AS A WHOLE, WITHOUT THE WRITTEN PERMISSION OF MANUFACTURER, IS PROHIBITED

SHEET

3