

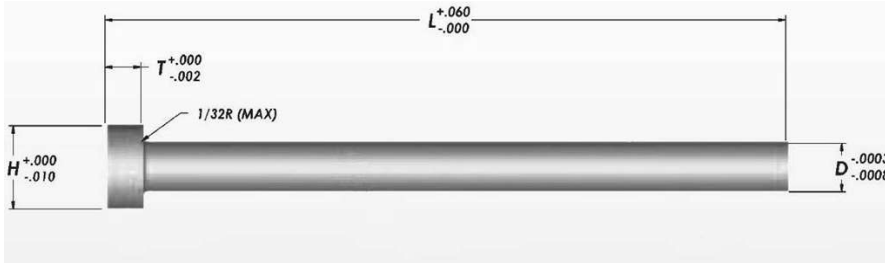

Ejector Pins

COMPONENT GUYS INC.



Material: H-13 / 1.2344 / SKD61

Outside diameter nitrided to 65-74 HRC

Core hardness 40-45 HRC

Heads annealed for easy machining

D	Cat. No.	L													H	T		
		6"			10"		14"		18"		25"		36"	39"			45"	50"
		STD.	STD.	+0.005	STD.	+0.005	STD.	+0.005	STD.	+0.005	STD.	STD.						
1/16	EJP062	x06	x10	x105													1/4	1/8
5/64	EJP078	x06	x10	x105													1/4	1/8
3/32	EJP093	x06	x10	x105	x14												1/4	1/8
7/64	EJP109	x06	x10	x105													1/4	1/8
1/8	EJP125	x06	x10	x105	x14	x145	x18		x25								1/4	1/8
9/64	EJP140		x10	x105	x14	x145											1/4	1/8
5/32	EJP156	x06	x10	x105	x14	x145	x18		x25		x36						9/32	5/3
11/64	EJP171		x10	x105	x14		x18										11/32	3/1
3/16	EJP187	x06	x10	x105	x14	x145	x18		x25		x36	x39	x45				3/8	3/1
13/64	EJP203		x10	x105	x14		x18		x25								3/8	3/1
7/32	EJP218	x06	x10	x105	x14	x145	x18		x25								13/32	3/1
15/64	EJP234		x10	x105	x14		x18		x25								13/32	3/1
1/4	EJP250	x06	x10	x105	x14	x145	x18	x185	x25	x255	x36	x39	x45				7/16	3/1
17/64	EJP265		x10	x105	x14		x18		x25								7/16	1/4
9/32	EJP281	x06	x10	x105	x14	x145	x18		x25								7/16	1/4
19/64	EJP296		x10	x105	x14		x18		x25								1/2	1/4
5/16	EJP312	x06	x10	x105	x14	x145	x18	x185	x25	x255	x36	x39					1/2	1/4
21/64	EJP328		x10	x105	x14		x18		x25								9/16	1/4
11/32	EJP343	x06	x10	x105	x14	x145	x18		x25								9/16	1/4
23/64	EJP359		x10	x105	x14		x18		x25								5/8	1/4
3/8	EJP375	x06	x10	x105	x14	x145	x18	x185	x25	x255	x36	x39			x50		5/8	1/4
25/64	EJP390		x10	x105													5/8	1/4
13/32	EJP406	x06	x10	x105	x14	x145	x18		x25								11/16	1/4
27/64	EJP421		x10	x105	x14												11/16	1/4
7/16	EJP437	x06	x10	x105	x14	x145	x18		x25		x36	x39					11/16	1/4
29/64	EJP453		x10	x105													11/16	1/4
15/32	EJP468	x06	x10	x105	x14		x18		x25								3/4	1/4
31/64	EJP484		x10	x105	x14												3/4	1/4
1/2	EJP500	x06	x10	x105	x14	x145	x18		x25	x255	x36	x39			x50		3/4	1/4
17/32	EJP531		x10		x14												3/4	1/4
9/16	EJP562	x06	x10		x14		x18		x25								13/16	1/4
5/8	EJP625	x06	x10		x14		x18		x25		x36	x39	x45				7/8	1/4
11/16	EJP687	x06	x10		x14		x18		x25								15/16	1/4
3/4	EJP750	x06	x10		x14		x18		x25		x36	x39	x45				1	1/4
7/8	EJP875	x06	x10		x14		x18		x25								1-1/8	1/4
1	EJP1	x06	x10		x14		x18		x25		x36	x39	x45				1-1/4	1/4