

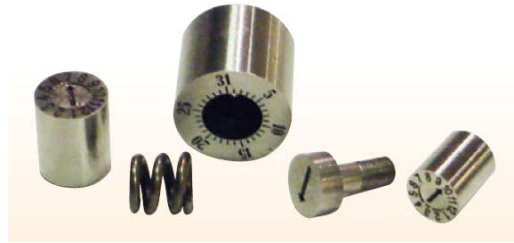

# Date Stamps Front Removable

COMPONENT GUYS INC.

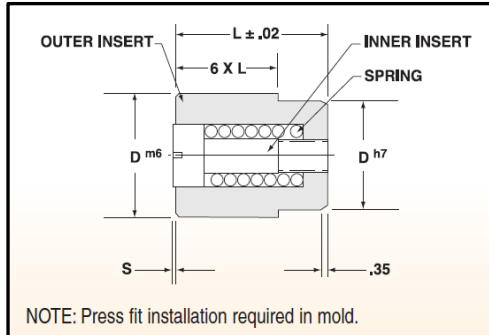

Material: 420 Stainless; 1.4021; 46Hrc +/- 2

- Provides part traceability
- Maximum working Temperature: 300F
- Markings are Laser etched.
- Insert changes can be done from parting line
- Press fit installation required
- Interchangeable with DME Front Removable or Progressive C-series

## Date Insert Assemblies

D	L	12 Months	12 Months w arrow/year*	Years/ arrow**	Days/ arrow	Shifts/ arrow	Blank/ arrow
4	8	MO408	MO4 x __	A04 x __	DA04	SH04	BL0408
5	8	MO508	MO5 x __	AO5 x __	DA05	SH05	BL0508
6	8	MO608	MO6 x __	AO6 x __	DA06	SH06	BL0608
8	10	MO810	MO8 x __	AO8 x __	DA08	SH08	BL0810
10	12	MO1012	M10 x __	A10 x __	DA10	SH10	BL1012
12	14	MO1214	M12 x __	A12 x __	DA12	SH12	BL1214
16	14	MO1614	M16 x __	A16 x __	DA16	SH16	BL1614
20	16	MO2016	M20 x __	A20 x __	DA20	SH20	BL2016

\* When ordering add the year required to the part number

\*\*When ordering specify beginning year

## Replacement Bodies & Inserts

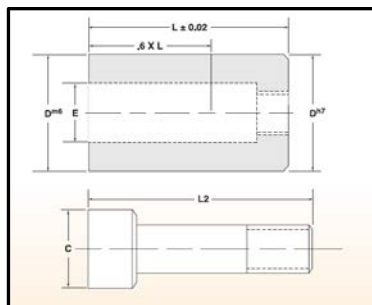

### Dimensional Data

D(mm) Dia.	E	L(mm)	S(mm)	Toleranc	
				m6	h7
4	2,1	8	0.203	+ ,012 to	0 to
5	3,1	8	0.203	+ ,012 to	0 to
6	3,1	8	0.203	+ ,012 to	0 to
8	4,4	10	0.254	+ ,015 to	0 to
10	5,2	12	0.3556	+ ,015 to	0 to
12	6,2	14	0.3556	+ ,018 to	0 to
16	8,2	14	0.3556	+ ,018 to	0 to
20	11	16	0.3556	+ ,021 to	0 to

### Replacement Inserts (with springs)

Arrow Only	Arrow & Year*	C	L2
AR04	AY04	2,1	8
AR05	AY05	3,1	8
AR06	AY06	3,1	8
AR08	AY08	4,4	10
AR10	AY10	5,2	12
AR12	AY12	6,2	14
AR16	AY16	8,2	14
AR20	AY20	11	16

\* When ordering add the year required to the part no.

### Replacement Bodies

12 Months	Years*	Days	Shifts	Blank	D	L
MBO4	AB04	DBO4	SB04	BLB04	4	8
MBO5	ABO5	DBO5	SB05	BLB05	5	8
MBO6	ABO6	DBO6	SB06	BLB06	6	8
MBO8	ABO8	DBO8	SB08	BLB08	8	10
MB10	AB10	DB10	SB10	BLB10	10	12
MB12	AB12	DB12	SB12	BLB12	12	14
MB16	AB16	DB16	SB16	BLB16	16	14
MB20	AB20	DB20	SB20	BLB20	20	16

\*When ordering specify beginning year