



# PAV-6 - Rotary Airlock

## HEAVY DUTY SERIES ROTARY AIRLOCK VALVE



### AVAILABLE FEATURES

- Air purged seals
- Food grade Teflon seals
- Food grade white epoxy paint
- 304 or 316 stainless steel body & rotor
- Hastelloy body and rotor
- Shear pins / Zero speed switch
- High temp bearings & seals for operation to 1100° F
- Wear & corrosion resistant coatings
- Inlet baffle / Inlet v-plow for shear protection
- Discharge adapter / Finger guards
- Bolt on or flexible tips
- Vented pockets / Vented housing
- Die cut flange gaskets
- Manual hand crank or pneumatic maintenance gates available
- Drive: 1/2 HP, TEFC, or TEXP / Various voltages available



### PRATER 6" ROTARY AIRLOCK

- Constructed of high strength cast iron or stainless steel body & end plates
- 8 blade, mild steel, open-end rotor with welded pocket bottoms
- Self-adjusting, maintenance-free packing gland assemblies
- Outboard mounted, maintenance-free bearings
- Universal flanges custom-drilled at no extra charge
- Complimentary temperature compensation
- End plates pre-drilled & tapped for optional shaft air purge
- Quick and easy end plate removal using included jack bolt holes
- Operating temperature up to 500° F with standard components
- Keyed shaft extension for most drive assemblies
- Premium, 1/2 HP, inverter duty, helical gear motor
- Standard models in stock

**NFPA-69**  
**MSHA**  
**V-Plow**  
**10-Bar**  
**PSR11**  
**CSA**

**THE ONLY AIRLOCK**  
**IN NORTH AMERICA TO BE**  
**TESTED & CERTIFIED**  
**TO COMPLY WITH NFPA-69**



[praterindustries.com](http://praterindustries.com)

**Capacity:**

Theoretical: 0.15 cu. Ft.  
(4.3 L) / rev.  
Practical: 0.12 cu. Ft.  
(3.4 L) / rev.

**Housing:**

Material: Gray Cast Iron  
Thickness: 0.38" x 0.31"  
9.5 x 7.9 mm

**Flanges:**

Square Outline: Drilled  
Round or Square  
Inlet Size: 6.0" / 152 mm  
Outlet Size: 6.0" / 152 mm  
Thickness: 0.31" / 7.9 mm

**Bearings:**

Type: Ball Bearing  
Size: 1.0" / 25.4 mm  
Life Rating L-10: > 60,000 hours  
Outboard Mounted: Yes

**Shaft:**

Material: Mild or Stainless Steel  
Drive Stub Shaft D: 1.00" / 25.4 mm  
Packing Seal: Abrasion Resistant

**Drive Includes:**

0.5 Hp, 60Hz, 3 Ph  
230/460 V. Motor, Motor Base  
Gear Reducer, Chain Drive  
TEFC & OSHA Guard

**Approx. Weight & Dimensions:  
Airlock Only**

Length: 19-3/8" / 492 mm  
Width: 10.0" / 254 mm  
Height: 10.0" / 254 mm  
Weight: 70 lbs / 32 kg  
Shipping Weight: 90 lbs / 41 kg

**With Drive & Standard Guard:**

Length: 27-1/4" / 692 mm  
Width: 27-1/16" / 687 mm  
Height: 16-3/4" / 425 mm  
Weight: 145 lbs / 66 kg  
Shipping Weight: 180 lbs / 82 kg

**Sound Level:**

< 75 db scale A

**Paint:**

Primer: Gray Chromate  
Finish: White, Urethane

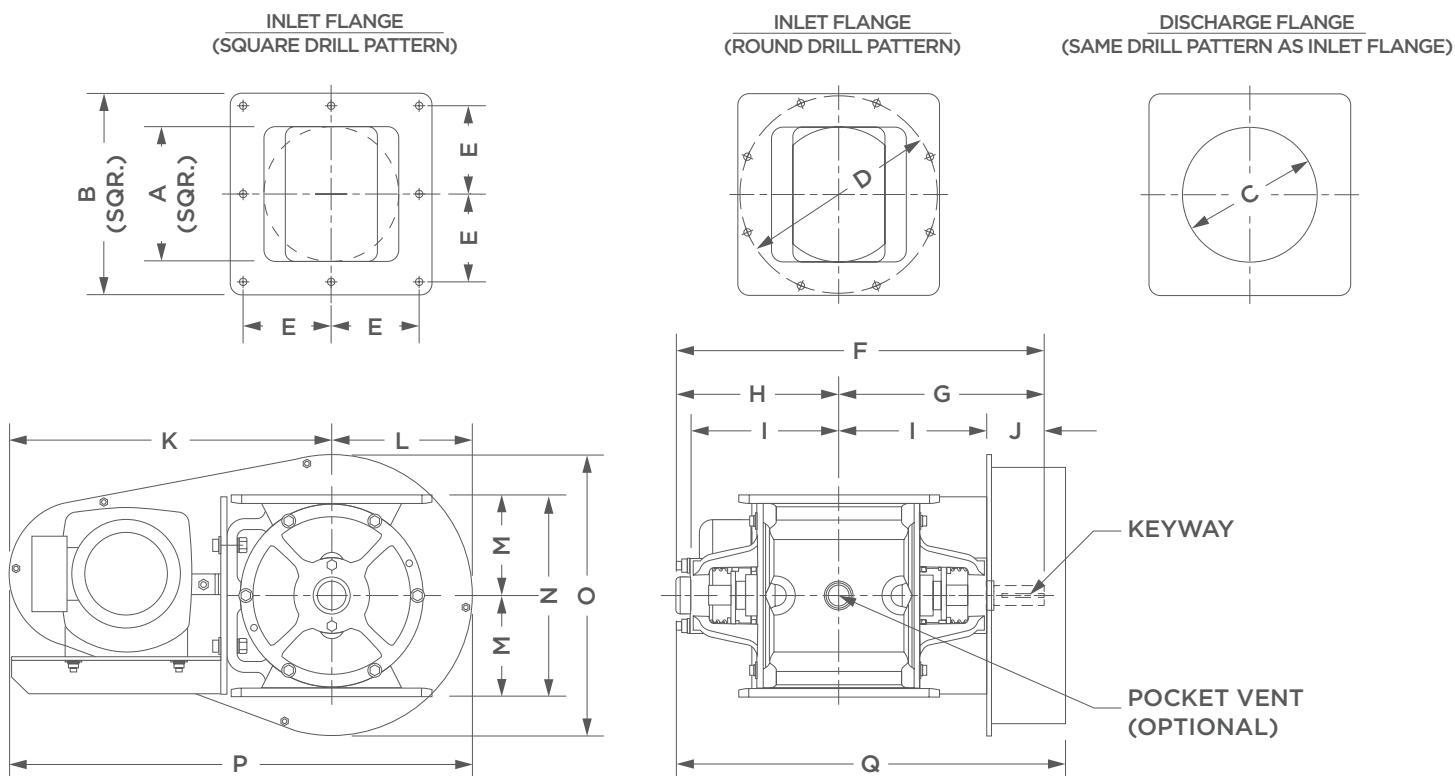

MODEL	DISPLACEMENT (CU. FT./REV)	A	B	C	D	E	F	G	H	I	J	K	L	M	N	O	P	Q	HOLE (QTY)	KEYWAY W X D	DRIVE SHAFT DIA.	FLANGE THK.	WEIGHT (LBS)	WEIGHT W/ DRIVE (LBS)
PAV-6	.15	6	10	6	9 1/2	4 5/16	19 3/8	10 11/16	8 11/16	7 13/16	2 1/2	19 1/4	8 3/8	5	10	16 3/4	27 1/4	21 1/16	8	1/4 x 1/8	1	5/16	70	145

**PRATER**<sup>®</sup>  
AIRLOCKS • MILLS • SEPARATORS

2 Sammons Court, Bolingbrook, IL 60440  
800.323.5735 • [praterindustries.com](http://praterindustries.com)