

# SUPER DOMINATOR 600 / 650 HD

## MAINTENANCE SHEET - HOW TO ASSEMBLE



- 1
- 2
- 3
- 4
- 5
- 6
- 7
- 8
- 9
- 10
- 11
- 12
- 13
- 14
- 15
- 16
- 17
- 18
- 19
- 20

**A.** Before assembly ensure that all components are cleaned, greased and lubricated. Lay out components in the order of the illustration above for ease of identification.



**B.** Secure Cylinder (11) on a bench or suitable stripping equipment. The cylinder has two identically positioned snap ring grooves and is reversible.

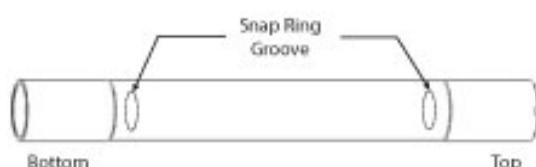

**C.** Insert Snap Ring (13) into bottom of Cylinder (11). Ensure that it sits in the snap ring groove.



**D.** Fit 'O' Ring (14) onto Bit Guide Bush (15). Ensure it sits in the 'O' Ring groove. Insert Bit Guide Bush (15) into bottom of Cylinder (11).

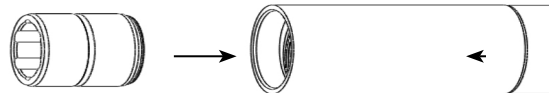

**E.** Grease Splines and fit Chuck (19) onto Drill Bit.

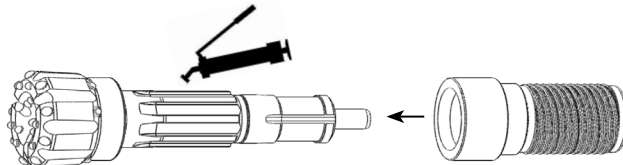

**F.** Fit Chuck Spacer (18) over Chuck (19). Fit 'O' Ring (17) onto Bit Retaining Ring (16). Ensure it sits in the 'O' Ring groove. Fit Bit Retaining Ring (16) onto Drill Bit.

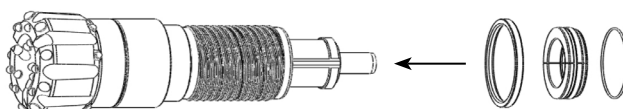

**G.** Grease threads and screw the Drill Bit, Chuck (19), Chuck Spacer (18) and Bit Retaining Ring (16) into the bottom of the Cylinder (11) until fully tightened.

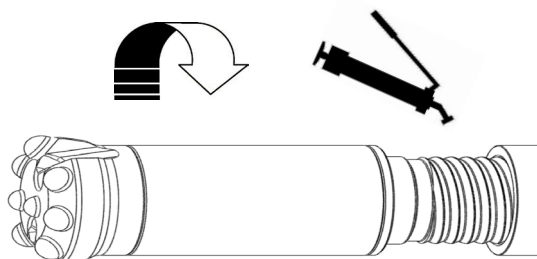

**H.** Coat Piston (12) liberally with rock oil - minimum 200 centistroke and insert into the top of the Cylinder (11). Ensure that the Piston is inserted the right way around - as illustrated below.

Top of Cylinder

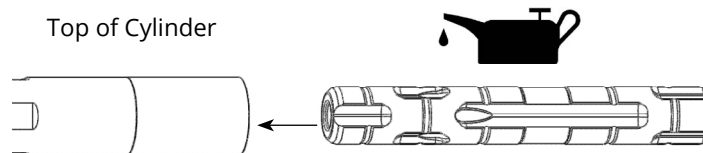

**I.** Fit 'O' Ring (4) to N.R.V. Seat (3). Ensure it sits in the 'O' Ring groove.

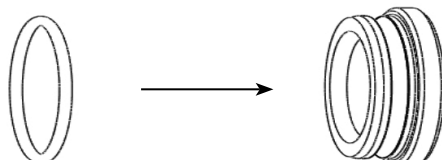

**J.** Insert N.R.V. Assembly (3-7) into Top Adaptor (8).

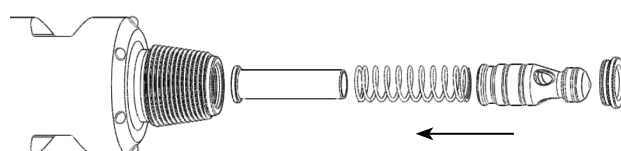

**K.** Insert Snap Ring (2) into Top Adaptor (8). Ensure it sits in the snap ring groove.

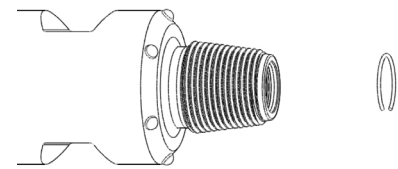

**L.** Fit 'O'Rings (9& 10) onto Top Adaptor (8). Ensure they sit in the 'O' Ring grooves.

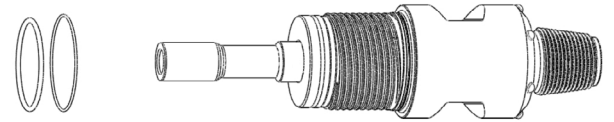

**M.** Grease threads and screw Top Adaptor (2) into Cylinder (11) until fully tightened.

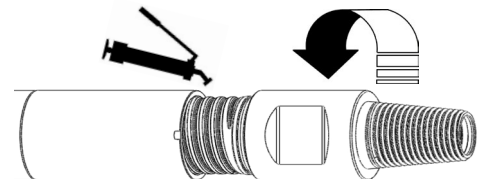

**N.** Depress N.R.V (5) and pour 1/3 litre of air line oil into the hammer.

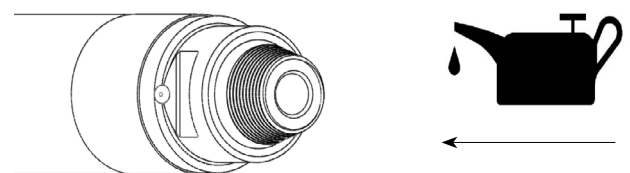

If you need further assistance, please call us on:  
(0)1422 399900 or email [salesuk@halcorocktools.com](mailto:salesuk@halcorocktools.com)

# SUPER DOMINATOR 600 / 650 HD

## MAINTENANCE SHEET - HOW TO DISMANTLE



- ①
- ②
- ③
- ④
- ⑤
- ⑥
- ⑦
- ⑧
- ⑨
- ⑩
- ⑪
- ⑫
- ⑬
- ⑭
- ⑮
- ⑯
- ⑰
- ⑱
- ⑲
- ⑳

**B.** Break the top joint between Cylinder (11) and Top Adaptor (8) and bottom joint between Cylinder (11) and Chuck (19).

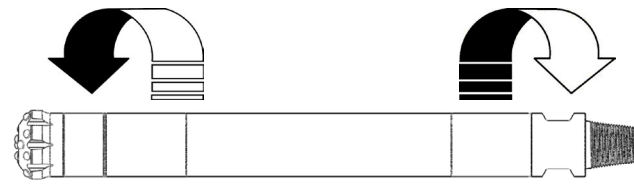

**C.** Unscrew and remove the Drill Bit, Chuck (19), Chuck Spacer (18) and Bit Retaining Ring (16) from Cylinder (11).

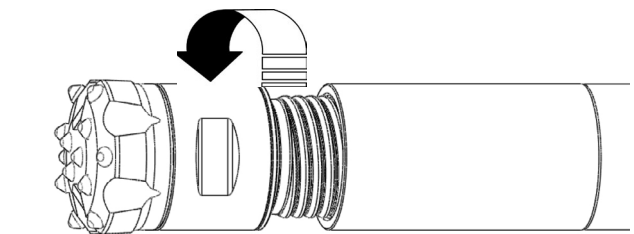

**D.** Remove Chuck Spacer (18) from the Chuck (19). Remove Bit Retaining Ring (16) from Drill Bit. Remove 'O' Ring (17) from Bit Retaining Ring (16).

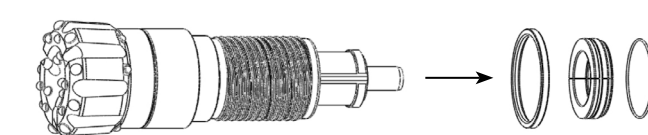

**E.** Remove the Chuck (19) from the Drill Bit.

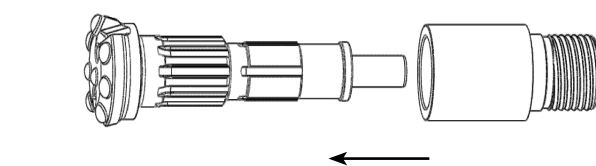

**F.** Remove Bit Guide Bush (15) from Cylinder (11).

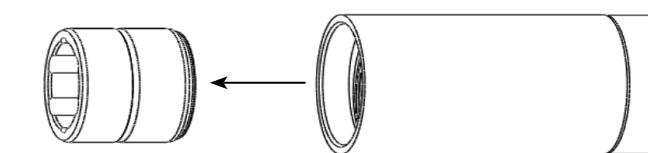

**G.** Remove Snap Ring (13) from the Cylinder (11) using the tools illustrated below.

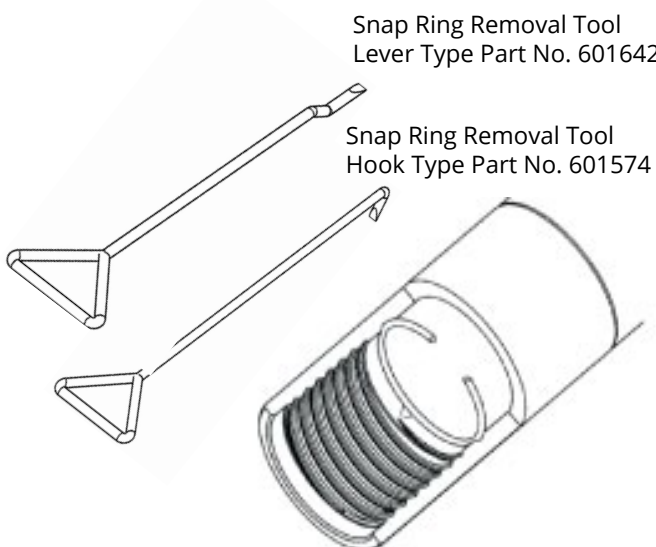

**H.** Remove Piston (12) from Cylinder (11).

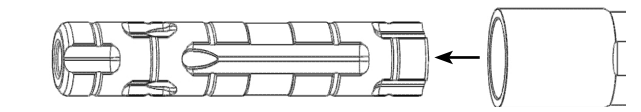

**I.** Remove Snap Ring (2) from Top Adaptor (8).

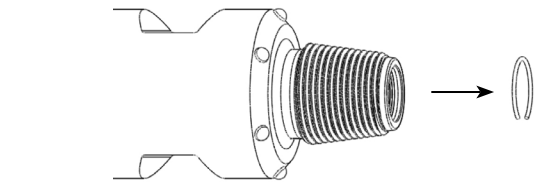

**J.** Remove N.R.V. Assembly (3-7) from Top Adaptor (8).

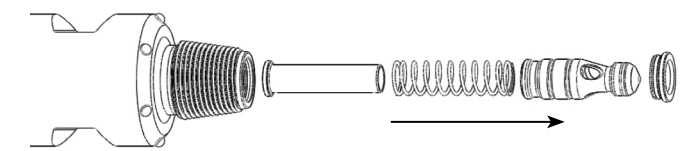

**K.** Unscrew and remove Top Adaptor (8) from the Cylinder (11).

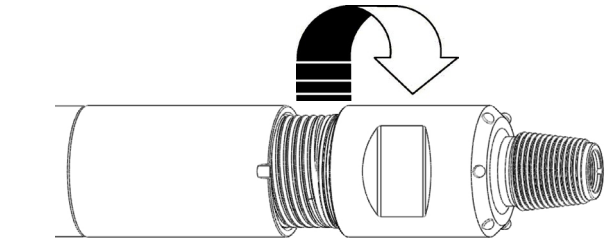

**L.** Remove 'O' Ring (8 & 9) from the Top Adaptor (2).

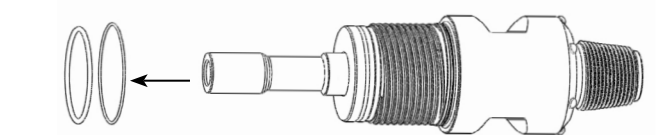

**DO NOT** apply heat or direct impact to the outside of the hammer as this usually damages the equipment.

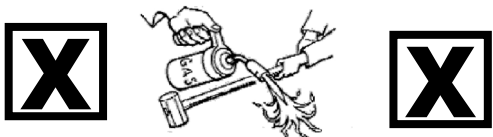

**A.** When dismantling hammers it is essential that cylinders are clamped into the correct position, away from threads, which can be damaged.



**X & Y = DO NOT CLAMP HERE**  
X = 200 mm (7.874")  
Y = 390 mm (15.354")

If you need further assistance, please call us on:  
(0)1422 399900 or email [salesuk@halcorocktools.com](mailto:salesuk@halcorocktools.com)