



ASTORIA

INDUSTRIES
OF IOWA, INC.

Astoria Industries of Iowa, Inc.
1001 Furnas Drive
P.O. Box 485
Osceola, IA 50213
(p) 641-342-3456
(f) 641-342-7002



Fiberglass service bodies—
designed to work...
built to last.



Astoria fiberglass bodies are
manufactured with recycled
materials, patent pending.

www.astoriainc.com

SERVICE KING FIBERGLASS TRUCK BODIES



Outstanding Value!

Long-lasting

Astoria's transferable utility bodies provide long life and an appearance that will represent your company for years to come. The low-maintenance gel coat finish used on our bodies is resistant to rust, chemicals, and peeling. Astoria offers you a long-lasting body that translates into high returns on your investment.

Durable

Astoria's engineers team up with major universities to ensure that our bodies will hold up to the stresses of all industries. Tests show that Astoria's body design exhibits superior load and stress transfer capabilities when compared to other service bodies.

Lightweight

An Astoria fiberglass body weighs 30% less than a comparable steel body, allowing you to carry a larger payload, improve gas mileage, and reduce wear on your truck.

5-Year Warranty

Astoria backs all products with a 5-year limited warranty.



Flip Top

Astoria's aluminum flip-top compartment provides additional storage for your utility body. It comes with lift-out tubs, and you can choose from a variety of dividers.

Recessed Doors

Our doors are double laminated with a smooth gel coat finish inside. The 96-inch and 108-inch bodies are recessed—a design that adds strength without more weight. No oil-canning or warping here! Mechanically attached automotive bulb gasket seals make our compartments weather-tight.

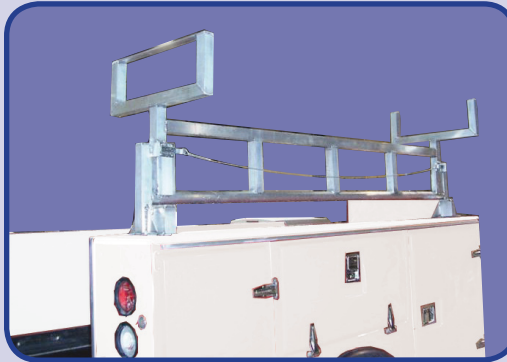

Ladder Rack

The tilt-down aluminum ladder rack allows easy access to your ladder. Choose from our assortment of slide-up, bow-type, and ladder boxes in steel or aluminum.



Hinges & Latches

Door hinges are heavy-duty stainless steel with stainless-steel bolts. Nuts are self-locking. Choose paddle latches that are free-wheeling with adjustable strikers, D-ring handles, folding handles or others to meet your needs. Our latching systems are long-lasting and require little maintenance.

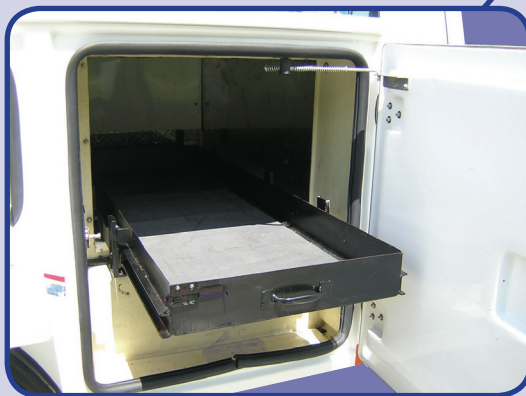

Transverse Compartment

Astoria's transverse compartment with drawer(s) adds versatility to your storage. Store large equipment or add dividers to provide room for smaller items. This transverse compartment allows you to gain easy access from both sides of your service body.



Shelving

Astoria's patented fiberglass shelving can be designed to meet your needs. These shelves have load capacities of 250 pounds for 30 inches. They are rustproof and nonconductive to electricity. We can also provide aluminum shelving.

FIBERGLASS LINE BODIES



Standard Equipment

- Molded Fiberglass Side Compartments
- Gel Coat Exterior Finish (White)
- Fiberglass Reinforced Doors (Double Laminated)
- Heavy-Duty Stainless-Steel Hinges
- Stainless-Steel Rotary Latches, Keyed Alike
- Heavy-Duty Strikers
- Automotive Bulb Gasket Door Seal
- 12-Gauge Steel Load Bed, Primed and Painted Black
- Steel Understructure, Primed
- FMVS108 Exterior Lighting Package
- Flush-Mounted Taillights and Backup Lights
- Corrosion-Resistant Fasteners
- All Self-Locking Nuts
- Compartment Drains
- Loomed Wiring Harness
- Extruded Aluminum Drip Rail
- Full-Height Fiberglass Bulkheads Between Compartments
- Nonskid Finish Module Tops
- Rubber Fenders
- Integrated Fender and Side Pack
- Fiberglass Shelving

Optional Equipment

- Variable Compartment Depth Up to 24 Inches
- Keyless Remote Electric Door Locks
- Shock-Absorbing Spring Mount
- Quick-Plug Wiring Adaptor
- Heavy-Duty Rollout Power Floors (250 pounds/square foot)
- Ladder Racks



Flip-Top Compartment

Astoria's aluminum flip-top compartment provides additional storage for your utility body.



Tail Shelf

A custom tail shelf can be added to an Astoria body.



Hinges & Latches

Wheel chock holders can be inserted into the wheel well openings. Rubber fender extensions are also included with an Astoria body.



Safe Steps

Aluminum Gripstrut Access Steps with Chrome Grab Handles.



Hinges & Latches

Astoria's stainless steel hinges and latches are installed with stainless steel bolts and nylon brushings. Choose paddle latches, D-ring handles, folding handles, or others to meet your needs. Also included is Astoria's extruded aluminum drip rail, to help keep the water out.

FIBERGLASS TRUCK BODY DIMENSIONS

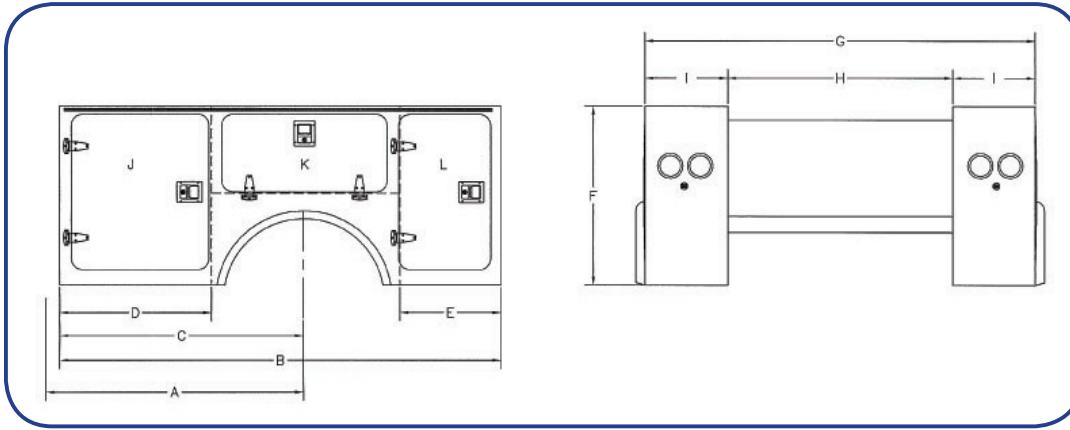

	81 STD-SRW	83 STD-SRW	96 STD-SRW	96 STD-DRW	108 STD-SRW	108 STD-DRW	108 VT-DRW
(A) Cab to Axle	40"	42"	56"	56"	60"	60"	60"
(B) Overall Length	81"	83"	96"	96"	108"	108"	108"
(C) Body Front to Axle	37"	39"	53"	53"	57"	57"	57"
(D) Compt Width	17"	19"	33"	33"	33"	33"	33"
(E) Compt Width	23"	23"	23"	23"	27"	27"	27"
(F) Height	39"	39"	39"	39"	39"	39"	48"
(G) Overall Width	79"	79"	79"	95"	79"	93"	93"
(H) Floor Width	49"	49"	49"	53"	49"	53"	53"
(I) Compt Depth**	15"	15"	15"	21"	15"	20"	20"
(J) Door Opening	11" x 31"	11" x 31"	27" x 31"	27" x 31"	27" x 31"	27" x 31"	26" x 41"
(K) Door Opening	14" x 33"	14" x 33"	14" x 33"	14" x 33"	14" x 39"	14" x 39"	17" x 41"
(L) Door Opening	16" x 31"	16" x 31"	16" x 31"	16" x 31"	22" x 31"	22" x 31"	20" x 41"

**Compartment Depths available from 15 inches to 24 inches.

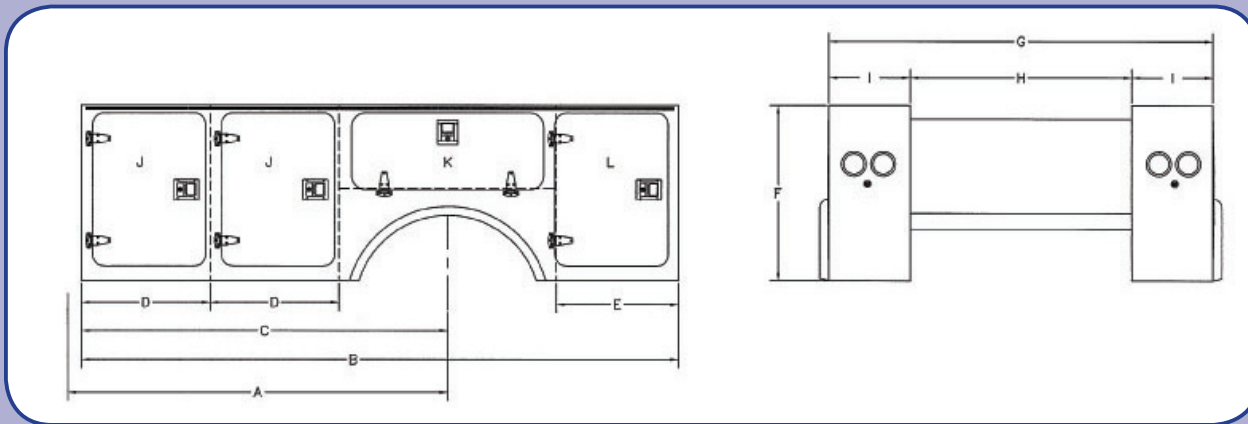

	132 STD-DRW	132 STDE-DRW	132 VT-DRW
(A) Cab to Axle	84"	84"	84"
(B) Overall Length	132"	132"	132"
(C) Body Front to Axle	81"	81"	81"
(D) Compt Width	33" & 24"	28.5"	27"
(E) Compt Width	27"	27"	24"
(F) Height	39"	39"	48"
(G) Overall Width	93"	93"	93"
(H) Floor Width	53"	53"	53"
(I) Compt Depth**	20"	20"	20"
(J) Door Opening	27" x 31" & 16" x 31"	22" x 31"	20" x 41"
(K) Door Opening	14" x 39"	14" x 39"	17" x 41"
(L) Door Opening	22" x 31"	22" x 31"	17" x 41"

**Compartment Depths available from 15 inches to 24 inches.

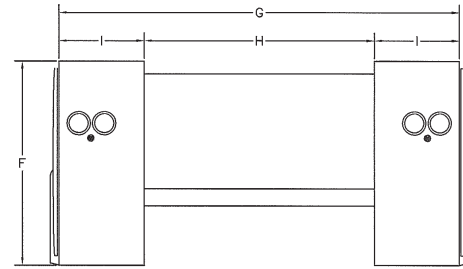
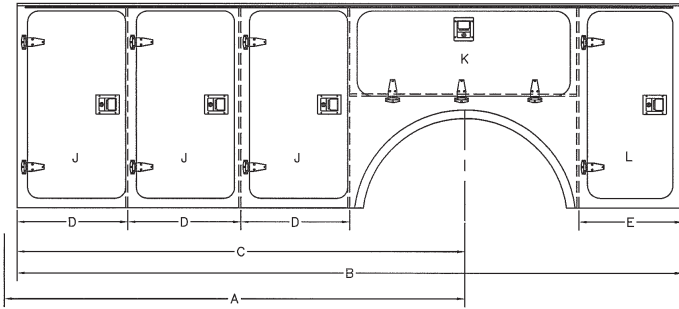

	150 VT-DRW	156 VT-DRW
(A) Cab to Axle	102"	108"
(B) Overall Length	150"	156"
(C) Body Front to Axle	99"	105"
(D) Compt Width	24"	26"
(E) Compt Width	24- $\frac{3}{4}$ "	24- $\frac{3}{4}$ "
(F) Height	48"	48"
(G) Overall Width	93"	93"
(H) Floor Width	53"	53"
(I) Compt Depth**	20"	20"
(J) Door Opening	17" x 41"	20" x 41"
(K) Door Opening	17" x 41"	17" x 41"
(L) Door Opening	17" x 41"	17" x 41"

Body sizes available from 96 inches long to 250 inches long.
 **Compartment Depths available from 15 inches to 24 inches.

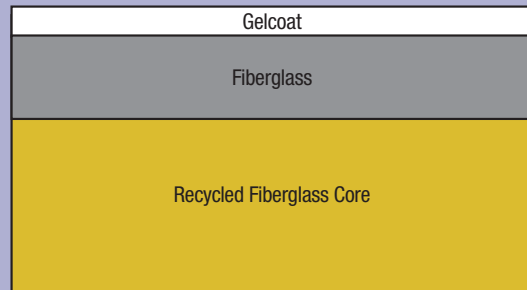

Astoria's gel coated exterior surfaces are easy to clean, resistant to chipping, and can be color matched to all your truck colors. The recycled fiberglass core panels replace wood and foam core materials.

ASTORIA FIBERGLASS CONSTRUCTION

Astoria uses only high-quality laminates in the construction of its fiberglass bodies. We start by using ISO-NPG gel coats to make sure your body has the highest protection against moisture absorption and weathering that can occur when using lower-grade gel coats. Behind the gelcoat is a $\frac{3}{16}$ -inch layer of high-strength composite fiberglass. This thickness makes sure you are getting the strongest laminates possible without added weight.

Astoria uses recycled fiberglass coring in its body construction (patent pending). Astoria has the new state-of-the-art ability to grind up high-strength fiberglass laminates into $\frac{3}{4}$ -inch fibrous strands. These strands are molded into $\frac{3}{8}$ -inch thick composite core panels. This core is then bonded to the initial fiberglass layer, giving you more than $\frac{9}{16}$ -inch total fiberglass construction—the closest thing available on the market today to a 100% fiberglass truck body.

Some of the benefits to using the recycled fiberglass core include smooth white interior compartments, complete resistance to water damage, and improved mechanical properties over other cores traditionally used. Independent university testing showed some properties of the recycled fiberglass core were 90% higher!

FACTS:

1

Astoria fiberglass utility trucks are stronger than steel and offer considerable weight savings, in some instances exceeding 30%.

2

Astoria bodies will last three times as long as a steel body, and will keep their sleek, stylish appearance with little maintenance.

3

Astoria uses materials and construction to make them the most durable bodies in the field. Materials and construction are tested both in our plant and by independent testing facilities.

Our New Corporate Headquarters



Osceola, Iowa, facility 148,000 square feet



Chariton, Iowa, facility 54,000 square feet

Astoria Fiberglass— the affordable choice!

In today's competitive market Astoria offers:

Weight Savings

- Reduced maintenance
- Increased payload capacity
- Less weight = less DOT restrictions

Design Flexibility

- Maximize your efficiency
- Configure interior and exterior features to meet your needs
- In-house mold design and fabrication allows for variable design
- Computer-aided design drawings

Recycled Materials

- Reuse existing body materials
- Avoid landfill disposal
- Gain customer appreciation for environmental production
- Stronger, lighter, better body

ASTORIA:
the first to offer
recycling!

Customers Agree

Astoria is far superior. The Astoria appearance and quality is unmatched. Your new design with recessed doors proves to me that **Astoria is continuing to look for improvements**, regardless of their obvious product success.

-Joe Cimino, Vehicle Fleet
Manager, Frontier Citizens
Communication

The workmanship in our Astoria body is second to none. Even though we are a small company, the folks at Astoria took the time to sit down with us and design a unit to meet our specific dimensions. **It is a pleasure doing business with people who are dedicated to quality and customer satisfaction.**

-Rudy Wollenweber, Owner
Wollenweber Electric

I have had a working relationship with Astoria Industries for many years and have found them to be competitive in the marketplace. **They accommodate our special needs by offering a wide range of body configuration and compartment sizes.** I have found Astoria fiberglass bodies to be low maintenance and they remain new looking after years of service.

- Keith Stubbe, Shop
Foreman, Metropolitan
Utilities District