



**Inaugurated:** 1999 | **Remodeled:** 2010 | **Length:** 361 ft | **Width:** 37.5 ft | **Voltage:** 110/220 volts | **Guests:** 128 | **Staff:** 41

#### PUBLIC AREAS & AMENITIES

- Main lounge with full-service bar and fireplace
- Captain's Lounge and Library
- Restaurant
- Sun Deck with life-sized chessboard
- Well-equipped fitness center
- Serenity River Spa™
- Guest laundry
- Elevator
- 24-hour specialty coffee and tea station
- Free Internet and Wi-Fi access



#### STATEROOMS & SUITES

**Lavishly appointed riverview staterooms and suites** have handcrafted Savoir® of England beds draped in the finest linens and a menu of pillow choices.

**Stateroom and suite amenities include:** generous built-in closets, individual climate-control thermostat, flatscreen TV with infotainment center and safe.

**Marble bathrooms include:** L'Occitane en Provence and Hermès products, plush towels, backlit magnifying mirror, cozy bathrobes and slippers.

**All suites are uniquely decorated and have additional amenities and services, including:** in-suite butler service; packing and unpacking assistance; in-room breakfast; daily fruit and cookie plate, and an elegant evening snack; Nespresso coffee machine and fine teas; fully stocked minibar; bottle of wine upon arrival; shoe shine; and free laundry service.



Suites: 4 (215 sq ft)  
French Balcony



Category 1 Staterooms: 16 (151 sq ft)  
French Balcony

Category 2 Staterooms: 20 (151 sq ft)

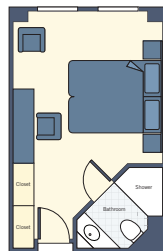

Category 3 Staterooms: 17 (151 sq ft)

Categories 4 & 5 Staterooms: 7 (151 sq ft)

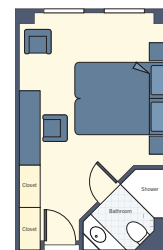
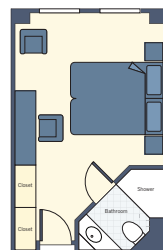

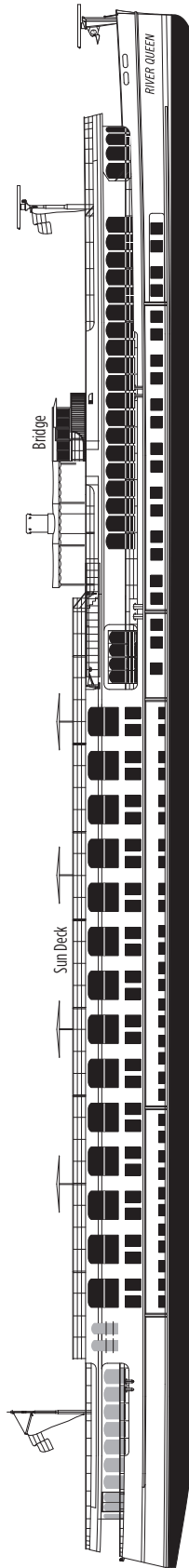

**Rhine Deck**

Staterooms and suites on this deck have French balconies

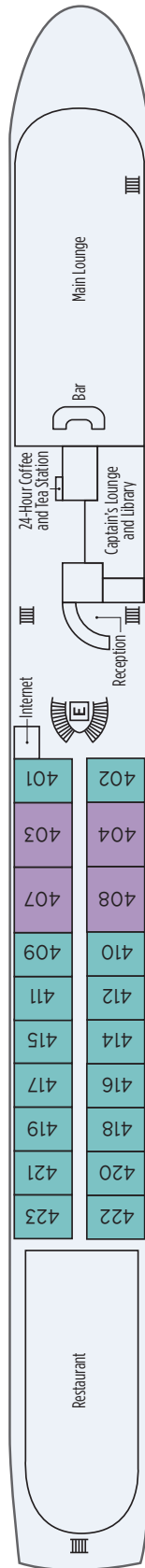

**Danube Deck**

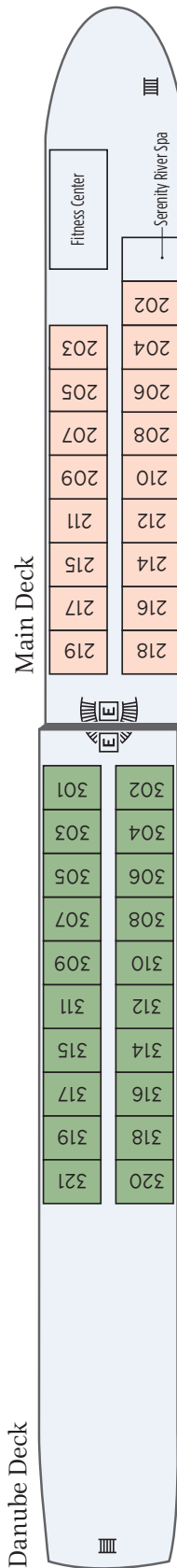

**Moselle Deck**

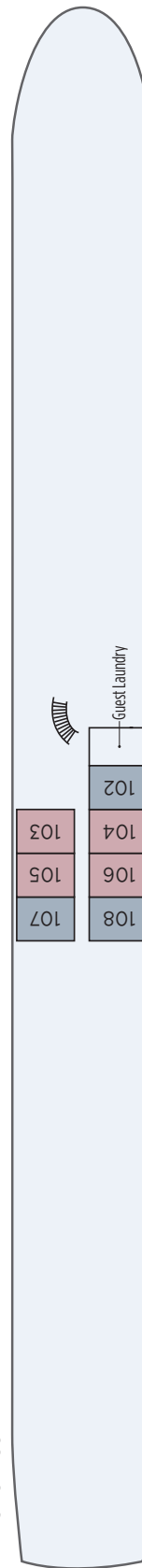

- Suite
- Category 1
- Category 2
- Category 3
- Category 4
- Category 5
- Elevator

Note: Adjoining staterooms are available; please inquire at time of booking.