

NOTE: All dimensions are approximate.

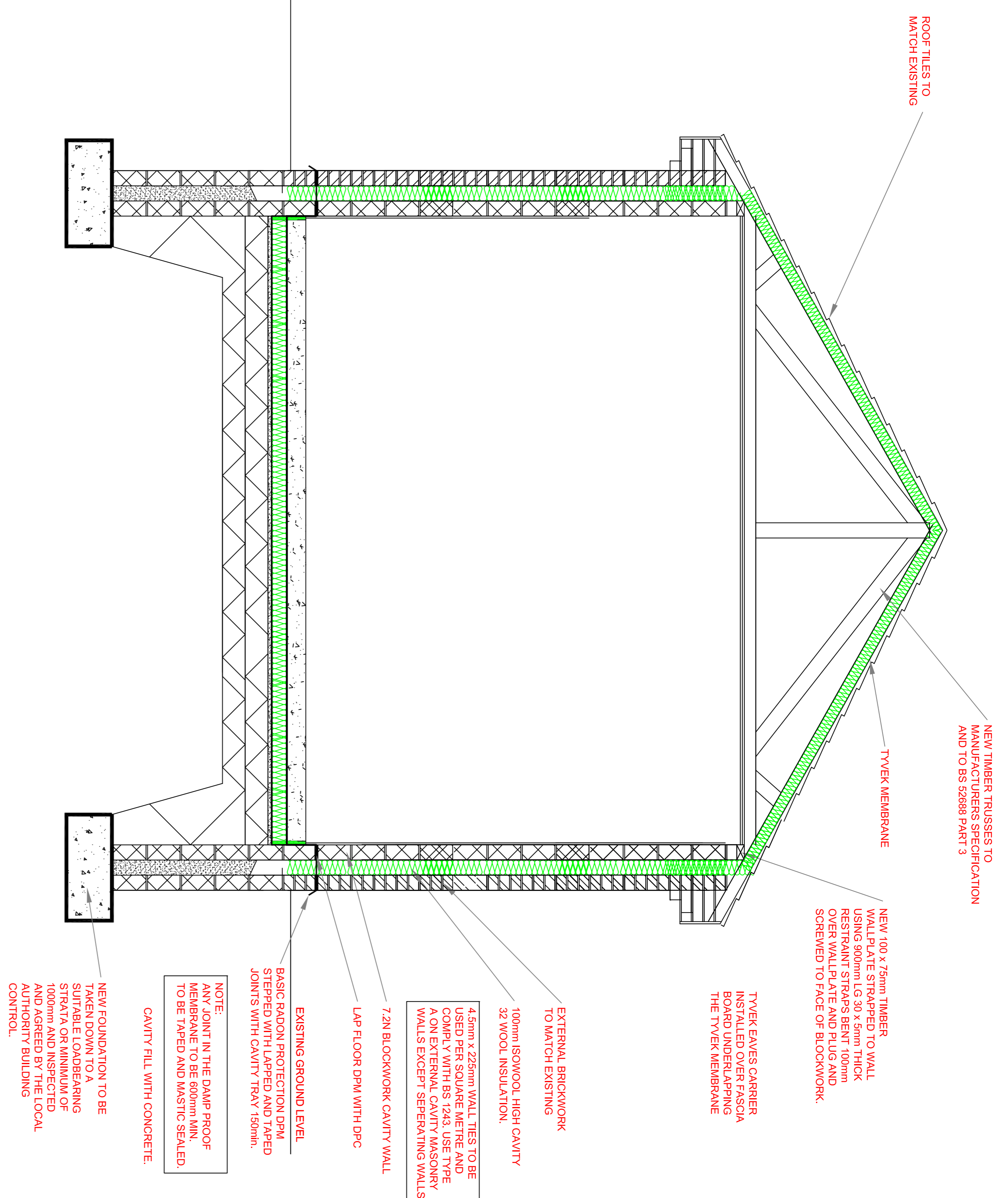

SECTION A'A

SCALE 1:20 @ A1

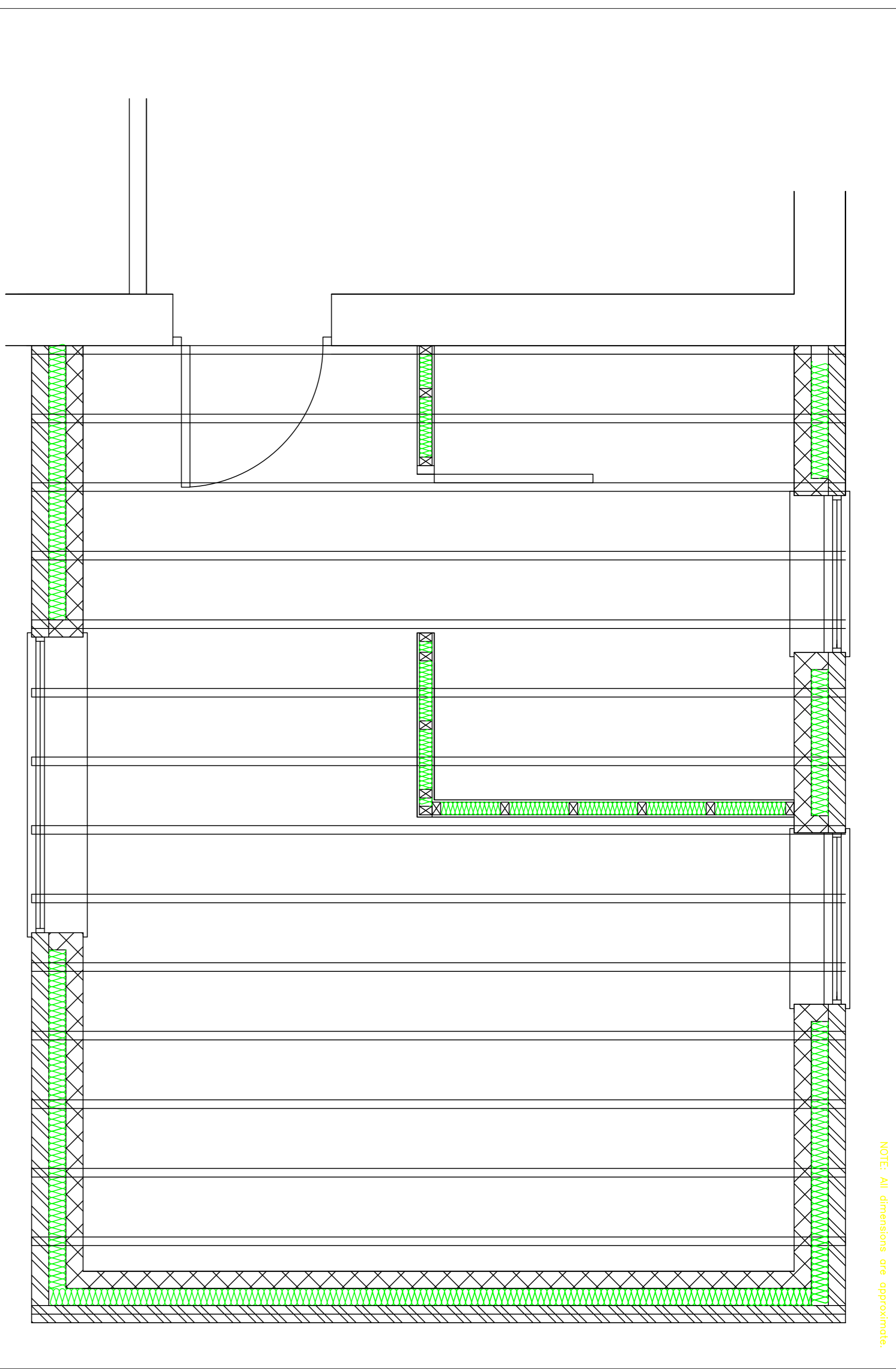

| Window no. | Window type | Width | Height | Component detail no. | l.h. jamb detail no. | r.h. jamb detail no. | cill detail no. | head detail no. | etc |
|------------|-------------|--------|--------|----------------------|----------------------|----------------------|-----------------|-----------------|-----|
| W001 | UPVC | 915mm | 1360mm | | | | | | |
| W002 | UPVC | 1000mm | 1360mm | | | | | | |
| W003 | UPVC | 1725mm | 1360mm | | | | | | |
| | | | | | | | | | |
| | | | | | | | | | |

WINDOW SCHEDULE

AS Architectural Services
 2 QUARTONS COTTAGES, CENTURION WAY
 CROSSGATES, SCARBOROUGH, N. YORKS
 TEL. 07590475612

Client:
 MR & MRS MARTINDALE
 6 KINGFISHER CLOSE, CROSSGATES
 SCARBOROUGH, YO12 4TZ

Project:
 PROPOSED DOMESTIC EXTENSION ONTO
 EXISTING PROPERTY

Drawing:
 SITE LOCATION AND BLOCK PLAN

Status of Drawing:
 THIS DRAWING HAS BEEN PRODUCED FOR THE CLIENT ABOVE FOR THE PROJECT ABOVE AND IS SUBMITTED AS PART OF BUILDING REGULATION APPLICATION AND IS NOT INTENDED FOR USE BY ANY OTHER PERSON OR FOR ANY OTHER PURPOSE

| Date | Scale | Drawing Number | Rev. |
|------------|---------------|----------------|------|
| 05/07/2015 | AS SHOWN @ A1 | 0154/008 | |

© AS Architectural Services 05/07/2015

08 PLANS AND CONSTRUCTION DETAILS

SCALE 1:20 AND 1:50 @ A1