

Soldering - Solderen - Soudage - Lötten - Soldadura - Lötning - Juottaminen - Saldatura - Solda

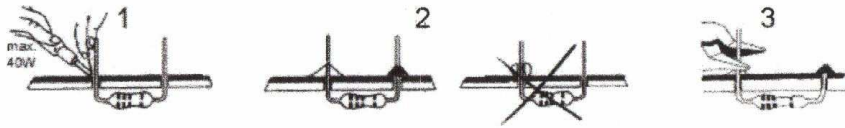

1 **START** Resistor - Weerstand - Résistance - Widerstand - Resistencia - Motstand - Vastus - Resistenze

$\diamond R1: 1K$
 $\diamond R2: 1K$
 $\diamond R3: 1K$

Brown, Black, Red) -(Bruin, Zwart, Rood) -(Brun, Noir, Rouge) -(Braun, Schwarz, Rot) -(Brun, Svart, Röd) -(Ruskea, Musta, Punainen) -(Marrón, Negro, Rojo) -(Castanho, Preto, Encarnado) -(Marrone, Nero, Rosso)

2 DIODE

$\diamond D1: 1N4148$
 $\diamond D2: 1N4148$
 $\diamond D3: 1N4007$

CATHODE

3 -Trim potentiometer -Potentiomètre de réglage - Potentiómetro de regulación - Trimmerpotentiometri -Trimme-potentiometer - Trimmen potenzioetri

$\diamond RV1: 1M PAUSE$

4 Capacitor - Condensateur

$\diamond C1: 100nF (104, \mu 1)$

5 LED

$\diamond LD1: 3mm$

COLOR= 2... Watch the polarity!

CATHODE

6 IC Socket - IC voet - Support de CI - IC Fuß - Soporto del CI - IC Sokkel - Mikroplirkanta - IC sokkel - Zoccolo IC

7 $\diamond J1 + J2$

8 ELCO

$\diamond C2: 100\mu F$
 $\diamond C3: 100\mu F$
 Watch the polarity!

9 RELAY
RELAIS
RELE

$\diamond RY1: 1C$

10 IC - CI $\diamond IC1: 555$

