

# RONDO

## Profile system Gealan S8000 with 6 chambers Profilsystem Gealan S8000 mit 6 Kammer Sistema di profili Gealan S8000 con 6 camere Sistemul de profile cu 6 camere Gealan S8000

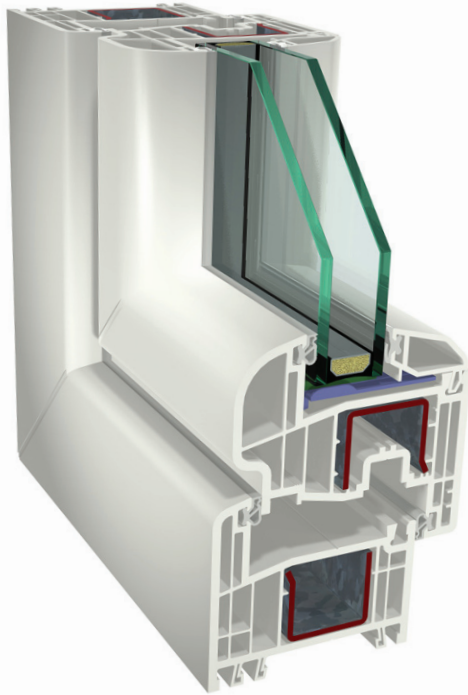

Profile System Manufacturer  
Gealan Fenster-Systeme GmbH  
Hofer Strasse 80, Oberkotzau  
Deutschland



**Heat transfer coefficient**  
Wärmedurchgangskoeffizient  
*Trasmittanza termica*  
Transmitanta termica

up to  
bis  
*fino a*  
pana la  $U_f = 1,2 \text{ W/(m}^2\text{K)}$



**Resistance to wind load**  
Widerstandsfähigkeit  
gegen Windlast  
*Resistenza ai carichi di vento*  
Rezistentă la încărcarea din vant

up to  
bis  
*fino a*  
pana la Clasa C5/B5



**Tightness against driving rain -  
unprotected (A)**  
Schlagregendichtheit - Ungeschützt (A)  
*Tenuta all'acqua metodo di prova A*  
Etanșeitatea la apă  
expunere directă

up to  
bis  
*fino a*  
pana la 9A



**Air permeability**  
Luftdurchlässigkeit  
*Tenuta all'aria*  
Permeabilitatea aerului

up to  
bis  
*fino a*  
pana la Clasa 4



**Sound insulation**  
Schallschutz  
*L'isolamento acustico*  
Izolarea acustică

up to  
bis  
*fino a*  
pana la 47 dB



**Burglar-resistant**  
Einbruchhemmung  
*Resistenza antieffrazione*  
Rezistentă antiefracție

up to  
bis  
*fino a*  
pana la RC 2 (WK 2)

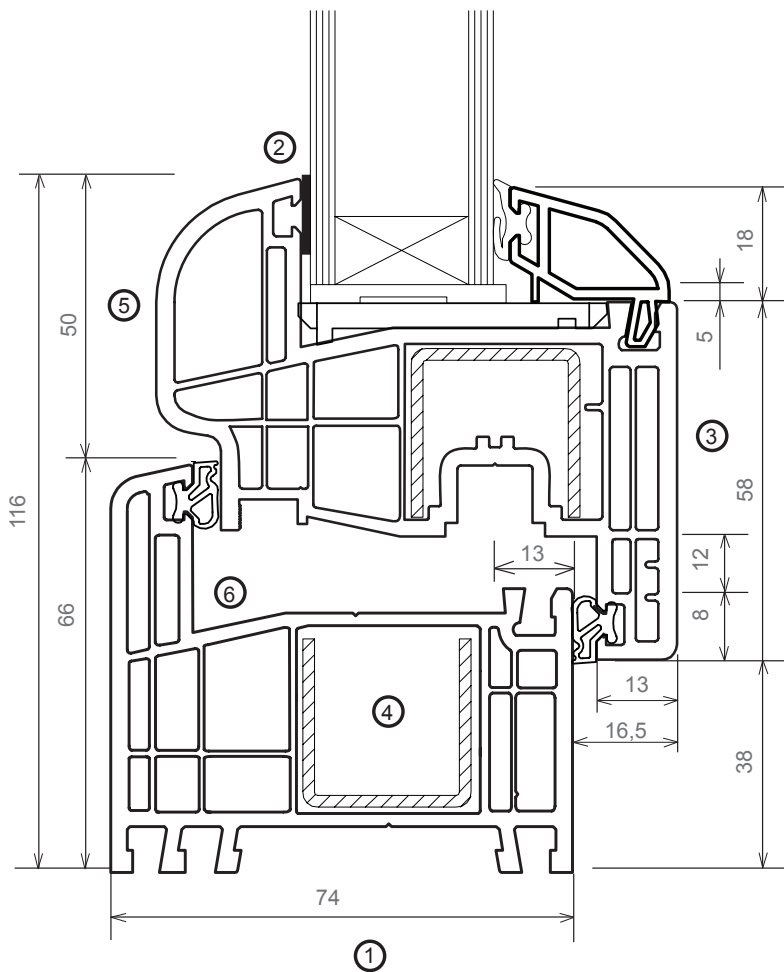
**System features** / Systemmerkmale / *Caratteristiche del sistema* / Caracteristici Sistem

1. A construction depth of 74 mm ensures excellent heat and sound insulation
2. GEALAN-STV® is the ground-breaking system for bonding panes and casement, that delivers decisive benefits
3. Efficient use of material in the profile design saves resources and thus helps the environment
4. Very good rigidity due to large steel stiffeners in the frame and sash
5. Available in either flat profile with a bevelled glazing bead, or semiflush with round glazing beads
6. Easy to clean, thanks to a generously large sash rebate

**GER**

1. 74 mm Bautiefe sorgen für gute Wärme- und Schalldämmung
2. GEALAN-STV® ist das bahnbrechende System, um Scheibe und Flügelüberschlag trocken zu verkleben
3. Materialoptimierte Profilgeometrie schont Ressourcen und damit die Umwelt
4. Gute Stabilität durch große Stahlaussteifungen in Blendrahmen und Flügel
5. Klassische Linienführung der harmonisch abgestuften Außenansicht
6. Hohe Reinigungsfreundlichkeit durch groß dimensionierten Blendrahmenfalz

**ITL**

1. *Profondità di costruzione del telaio 74 mm che assicura un'eccellente isolamento termico e acustico*
2. *STV® - GEALAN è il sistema rivoluzionario, di incollaggio a secco tra vetro e la battuta dell'anta che fornisce dei vantaggi notevoli*
3. *Uso efficiente dei materiali nella progettazione profilo consente di risparmiare risorse e, quindi, aiuta l'ambiente*
4. *Straordinaria stabilità grazie ai rinforzi utilizzati nel telaio e nell'anta*
5. *All'esterno del nodo ci sono due possibilità di scelta tra anta a sezione quadra o tonda*
6. *Facile da pulire con battuta battente di grandi dimensioni*

**ROM**

1. Adancime de constructie de 74 mm pentru proprietati deosebite de izolare termica
2. Sistemul inovator GEALAN-STV® de lipire uscata a sticlei ofera multiple avantaje
3. Utilizare eficienta a materialelor in proiectarea profilului conserva resursele contribuind la protectia mediului
4. Stabilitate foarte buna datorita armaturii de otel groase din toc si cercevea
5. Design clasic fara varsta, cu baghete si cercevele rotunjite sau drepte
6. Usor de curatat datorita canalului de mari dimensiuni a tocului

**Color program / Dekorübersicht / Programma Colori / Program culori**

Dekore Pellicola Folie	Color shades  Farbbezeichnung Colore Denumire culoare	Laminated		Suport material  Trägermaterial Colore Massa Material Bază	Renolit code  Renolit Code Codice Renolit Cod Renolit	Gasket  Dichtung Guarnizione Garnitura
		ext	int			
Wood grain / Holzdekore / Effetto Legno / Imitatie Lemn	Sheffield Oak Light	x	x	braun	F456-3081	gray
	Sheffield Oak Grey	x	x	braun	F436-3086	gray
	Eiche Natur	x	x	braun	9.03118076-116800	gray
	Bergkiefer	x	x	braun	9.3069041-116700	gray
	Oregon	x	x	braun	9.1192001-116700	gray
	Streifen-Douglasie	x	x	braun	9.3152009-116700	gray
	Winchester XA	x	x	braun	9.0049240-114800	gray
	Golden Oak	x	x	braun	9.2178001-116700	black
	Soft Cherry	x	x	braun	9.3214009-119500	gray
	Siena PR	x	x	braun	9.0049233-114800	gray
	Siena PN	x	x	braun	9.0049237-114800	black
	Nussbaum V	x	x	braun	9.2178007-116700	black
	Eiche Dunkel FL-F1	x	x	braun	9.2052089-116700	black
	Mooreiche ST-F	x	x	braun	9.3167004-116700	black
	Macore	x	x	braun	9.3162002-116700	black
	Sapeli	x	x	braun	9.2065021-116700	black
	Black Cherry	x	x	braun	9.3202001-116700	black
	Desert Oak	x	x	braun	2.0057.004-130300	black
Mountain Oak	x	x	braun	2.0057.006-130300	black	
Single Colors / Uni-Farben / Uni-colore / Culori Uni	Crystal White Ash	x	x	white	47 852-117900	gray
	Cremeweiss	x	x	white	02.20.11.000001-116700	gray
	Lichtgrau 7251	x	x	white	725105-116700	gray
	Grau 7155	x	x	white	715505-116700	gray
	Basaltgrau 7012	x	x	white	701205-116700	gray
	Anthrazitgrau	x	x	white	701605-116700	black
	Anthrazitgrau 7016 Glatt	x	x	white	701605-808300	black
	Dunkelrot 3081	x	x	white	308105-116700	black
	Winerot 3005	x	x	white	300505-116700	black
	Moosgrun 6005	x	x	white	600505-116700	black
	Dunkelgrun 6125	x	x	white	612505-116700	black
	Schwarzbraun 8518	x	x	white	851805-116700	black
	Metbrush Aluminium	x	x	white	F436-1001	gray
	Metbrush Messing	x	x	white	F436-1007	gray

**Nachweis**  
Energieeinsparung und Wärmeschutz

Prüfbericht 402 29298/2



Auftraggeber **GEALAN Fenster-  
Systeme GmbH**  
Hofer Straße 80  
  
95145 Oberkotzau

**Grundlagen**

EN 12412-2 :2003-07  
Bestimmung des  
Wärmedurchgangskoeffizienten  
mittels des  
Heizkastenverfahrens, Teil 2:  
Rahmen  
Entspricht der nationalen  
Fassung DIN EN .

Produkt	Flügel- / Blendrahmen - Profilkombination
Bezeichnung	S8000IQ
Bautiefe	Bautiefe Blendrahmen 74 mm Bautiefe Flügelrahmen 84,5 mm
Ansichtsbreite	124 mm
Rahmenmaterial	PVC-U/weiß
Aussteifung	Stahl/verzinkt
Besonderheiten	--

**Darstellung**

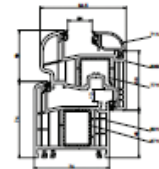

**Verwendungshinweise**

Dieser Prüfbericht dient zum  
Nachweis des Wärmedurch-  
gangskoeffizienten  $U_f$

**Gültigkeit**

Die genannten Daten und  
Ergebnisse beziehen sich  
ausschließlich auf den  
geprüften und beschriebenen  
Gegenstand.

Die Prüfung des  
Wärmedurchgangskoeffizienten  
ermöglicht keine Aussage über  
weitere leistungs- und  
qualitätsbestimmenden  
Eigenschaften der vorliegenden  
Konstruktion.

**Wärmedurchgangskoeffizient**



$$U_f = 1,2 \text{ W/(m}^2 \cdot \text{K)}$$



ift Rosenheim  
8. Februar 2005

*Ulrich Sieberath*  
Ulrich Sieberath  
Institutsleiter

*Konrad Huber*  
i. A. Konrad Huber  
Prüffeld Wärmeschutz &  
Energietechnik

**Veröffentlichungshinweise**

Es gilt das ift-Merkblatt  
„Hinweise zur Benutzung von  
ift-Prüfberichten“.

Das Deckblatt kann als  
Kurzfassung verwendet  
werden.

**Inhalt**

Der Nachweis umfasst  
insgesamt 5 Seiten

- 1 Gegenstand
- 2 Durchführung
- 3 Einzelergebnisse



## Zusammenfassender Prüfbericht

Widerstandsfähigkeit bei Windlast,  
Schlagregendichtheit, Luftdurchlässigkeit,  
Bedienkräfte, Mechanische Beanspruchung,  
Dauerfunktion, Tragfähigkeit von  
Sicherheitsvorrichtungen, Stoßfestigkeit  
Nr. 101 32802/Z



Auftraggeber **GEALAN**  
**Fenster-Systeme GmbH**  
Hofer Str. 80

### Grundlagen

EN 14351-1 : 2006-03, Fenster  
und Außentüren – Produktnorm

### Prüfnormen:

EN 1026 : 2000-06  
EN 1027 : 2000-06  
EN 12211 : 2000-06  
EN 12046-1 : 2003-11  
EN 14608 : 2004-03  
EN 14609 : 2004-03  
EN 1191 : 2000-02  
RAL-RG 607/3  
EN 13049 : 2003-08

	95145 Oberkotzau
Bauteil	Fenster und Fenstertüren mit den Öffnungsarten: Dreh, Drehkipp, Fest und zweiflügelig mit aufgehendem Mittelstück
Bezeichnung des Systems	S8000IQ
Rahmenmaterial	PVC-U/weiß
Systembeschreibung	Auszug siehe Anlage 3 Profile gem. EN 12608, Klasse B (Wandstärke der Sicht flächen $\geq 2,5$ mm, der nicht sichtbaren Flächen $\geq 2,0$ mm)
Besonderheiten	

### Darstellung

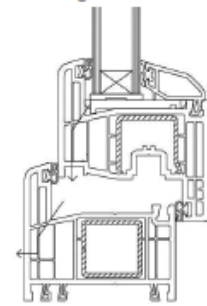

Probekörper	1	2	3
Darstellung			
Fenstergröße in mm	1396 x 2376	1032 x 2376	1864 x 1576
Prüfung	Klassifizierung		
Widerstandsfähigkeit bei Windlast EN 12210	C5 / B5	C3 / B3	C4 / B4
Schlagregendichtheit EN 12208	9A	7A	8A
Luftdurchlässigkeit EN 12207	4	4	4
Bedienkräfte EN 13115	1	1	1
Mechanische Beanspruchung EN 13115	4	4	4
Dauerfunktion EN 12400	2	2	2
Stoßfestigkeit EN 13049	2* * Diese Eigenschaft wurde exemplarisch an Probekörper 2 geprüft		
Tragfähigkeit von Sicherheitsvorrichtungen	Schwellenwert erfüllt	Schwellenwert erfüllt	Schwellenwert erfüllt
Falzhindernistest und Laibungstest nach RAL-RG 607/3 : 1995-02 Güte- und Prüfbestimmungen für Drehbeschläge und Drehkippbeschläge			Anforderung erfüllt

### Verwendungshinweise

Dieser Prüfbericht dient zum Nachweis der obengenannten Eigenschaften für Fenster nach EN 14351-1: 2006-3

### Gültigkeit

Die Prüfergebnisse können gemäß Übertragungsmatrix (Punkt 2) übertragen werden. Witterungs- und Alterungsercheinungen wurden nicht berücksichtigt.

### Veröffentlichungshinweise

Es gilt das ift-Merkblatt „Bedingungen und Hinweise zur Benutzung von ift-Prüfdokumentationen“.

### Inhalt

Der zusammenfassende Prüfbericht umfasst insgesamt 29 Seiten.

- Anlage 1: Zugrundeliegende Nachweise
- Anlage 2: Übertragungsmatrix
- Anlage 3: Auszug aus der Systembeschreibung
- Anlage 4: Wichtige Systemmerkmale

ift Rosenheim  
14. Juni 2007

Jörn Peter Lass, Dipl.-Ing. (FH)  
Prüfstellenleiter  
ift Zentrum Fenster & Fassaden



ift Rosenheim GmbH  
Geschäftsführer  
Dipl.-Ing. (FH) Ulrich Sieberath  
Dr. Jochen Peichl

Theodor-Gietl-Str. 7 - 9  
D-83026 Rosenheim  
Tel.: +49 (0)8031/281-0  
Fax: +49 (0)8031/281-290  
www.ift-rosenheim.de

Robert Kolaony, Dipl.-Ing. (FH)  
Prüfingenieur  
ift Zentrum Fenster & Fassaden

Sitz: 83026 Rosenheim  
AG Traunstein, HRB 14763  
Sparkasse Rosenheim  
Kto. 3832  
BLZ 711 500 00

Notified Body Nr.: 0757  
Anerkante PUZ-Stelle: BAY 18  
 DAK-PL 0910-00  
DAK-DE 2388-00  
TGA 24-18-08-00  
TGA 24-18-08-00

**Sound insulation test reports / Übersicht Schallprüfzeugnisse / Certificati d'isolamento acustico /**  
 Certificate izolare fonica

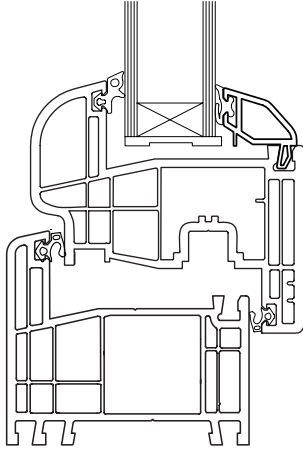
<b>Element description</b> Elementbeschreibung Descrizione elemento Descriere element	<b>Pane structure (mm)</b> Scheibenaufbau (mm) Struttura vetro (mm) Structura geam (mm)	<b>Obtained values Rw.P=dB</b> Erreichte Werte Rw.P=dB Valori raggiunti Rw.P=dB Valori obtinute Rw.P=dB
	4-16-4	34
	4-14-4-14-4	35
	6-16-4	38
	8-16-4	39
	6-14-4-14-4	40
	VSG 8-16-4	40
	VSG 10-16-4 (P4A)	40
	10-12-4-12-6	42
	VSG SI 6-16-6	43
	VSG SI 8-14-4-14-6	43
	VSG 10-12-4-16-6 (P4A)	43
	VSG SI 8-24-8	46
	VSG SI 8-12-4-12-8	45
	VSG SI 8-16-VSG SI 8	47
	VSG SI 10-16-VSG SI 8	47
	VSG SI 8-12-4-12- VSG SI 8	47

**\*VSG - Laminated glass / Verbundsicherheitsglas / Vetro stratificato / Sticla laminata**

**\*VSG SI - Acoustic laminated glass / Schallschutz-Verbundsicherheitsglas / Vetro stratificato acustico /**  
 Sticla laminata cu control acustic

Symbol Legend / Symbol Legende / Legenda Simboli / Legenda simboluri



**Window** / Fenster /  
*Finestra / Fereastra*



**Window with mullion** /  
Fenster mit Pfosten /  
*Finestra con montante /*  
Fereastra cu montant



**Terrace door** / Balkontüre  
*Porta balcone / Usa balcon*



**Door with sash rail** /  
Tür mit Flügelsprosse /  
*Porta con traversa /*  
Usa cu traversa



**Residential Door** / Haustüre  
*Portoncino / Usa intrare*



**Outswing door**  
Außenöffnende Türen  
*Porta con apertura verso l'esterno*  
Usa cu deschidere exterioara



**Renovation profile** /  
Renovierungs-Blendrahmen /  
*Telaio ristrutturazione / Toc de*  
renovare

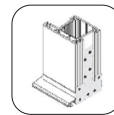

**Threshold** /  
Haustürschwelle /  
*Sotto soglia /*  
Prag aluminiu



**Window handle** / Fenstergriff  
*Maniglia finestra / Maner fereastra*

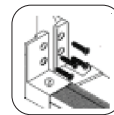

**Threshold SLM** /  
Haustürschwelle LFM /  
*Soglia in luce telaio /*  
Prag montat in flat



**Double side door handle** /  
Fenstergriffe mit Arretierung  
*Maniglia passante / Maner dublu*

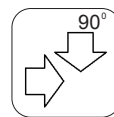

**Coupling profiles 90** /  
Kopplungsprofile 90 /  
*Profili di accoppiamento 90 /*  
Profile de cuplare 90



**Door Handle** / Drückergarnitur /  
*Maniglione / Maner usa*



**Variable bay pole** /  
Variable Eckkopplung /  
*Giunto angolare variabile /*  
Profile de cuplare unghi variabil



**Flag door hinge** / Haustürband /  
*Cerniera a bandiera / Balama usa*

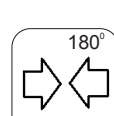

**H coupler** /  
H Schieber /  
*Profilo di accoppiamento /*  
Profil cuplare



**Door hinge RB** / Haustürband RB /  
*Cerniera tubolare /*  
Balama tubulara usa



**Outer frame extension** /  
Blendrahmen Verbreiterung /  
*Allargatore Telaio /*  
Profile extensie toc



**Double hung window** /  
Stulpfenster / *Finestra a due ante /*  
Fereastra in doua canate



**Bank connection profile** /  
Sohlbankprofile /  
*Profilo di appoggio inferiore /*  
Profile suprainaltare pervaz



**Extention profile** /  
Höhenausgleichsprofil /  
*Zoccolo porta / Bandou usa*

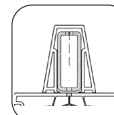

**Reinforcing plant-on profile** /  
Statik-Aufsatz /  
*Rinforzo /*  
Ranforsare aplicată

**Frame profiles / Rahmenprofile / Profili Telaio / Profile Toc**

**Profile: 8001**  
Steel 8727  
28.5x28.5 - 2 mm

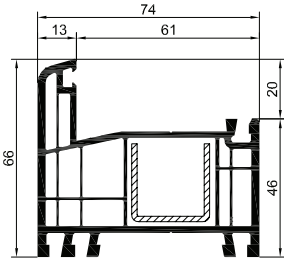

**Profile: 8033**  
Steel 8727  
28.5x28.5 - 2 mm

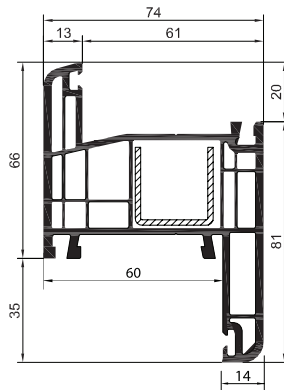
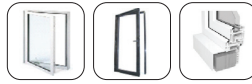

**Profile: 8034**  
Steel 6744  
28x17.5 - 1.5 mm

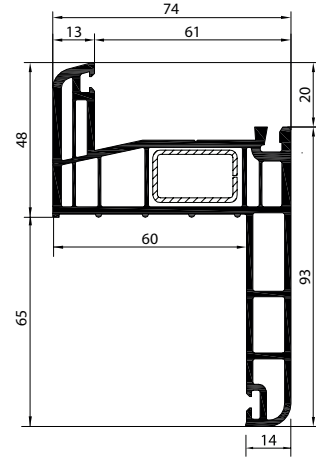

**Profile: 8010**  
Steel 8710  
27.5x35.5 - 2 mm

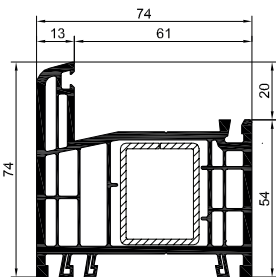

**Profile: 8015**  
Steel 8701  
43x27.5 - 2 mm

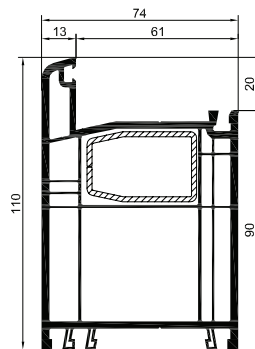

Software interface showing a profile selection table and a technical drawing.

Profilo	Forma irregolare	
8001	Alb	8001-Telaio a L 66mm
8011	Alb	8010-Telaio a L 74mm
8015	Alb	8015-Telaio a L 110mm Bianco
8027	Alb	8027-Telaio a Z 50
8030	Alb	8030-Telaio a Z 30



**Sash profiles / Flügelprofile / Profili Anta / Profile Cercevea**

**Profile: 8095**  
Steel 8727  
28.5x28.5 - 2 mm

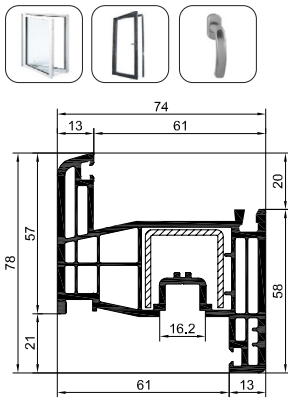

**Profile: 8096**  
Steel 8727  
28.5x28.5 - 2 mm

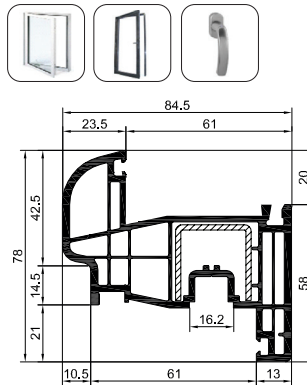

**Profile: 8081**  
Steel 8706  
48.5x46 - 2 mm

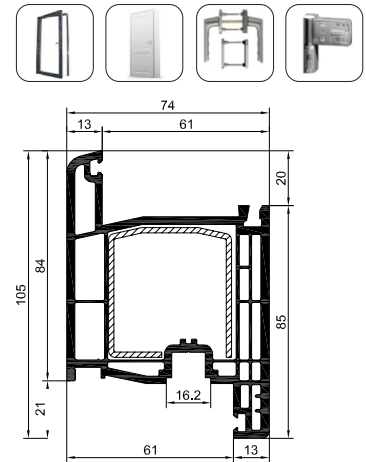

**Profile: 8078**  
Steel 8706  
48.5x46 - 2 mm

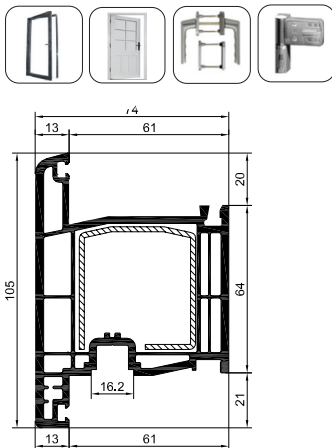

**Profile: 8076**  
Steel 8736  
46x60 - 2 mm

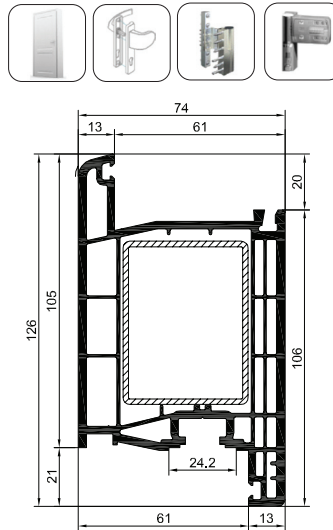

**Profile: 8042**  
Steel 8736  
46x60 - 2 mm

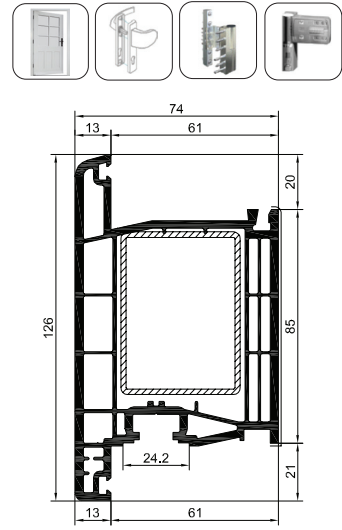

Software interface showing a toolbar with icons for file operations, zooming, and selection. A dropdown menu is open, displaying a list of profiles:

8076	Alb	8076-Anta porta int. 126mm
8081	Alb	8081-Anta porta int. 105mm
8095	Alb	8095-Anta D finestra 78mm
8095A	Alb	8095-Anta D finestra 78mm STV
8096	Alb	8096-Anta R finestra 78mm
8096A	Alb	8096-Anta R finestra 78mm STV

Below the list, there are options for 'Colore' (Color) with a dropdown set to 'Bianco' and a checkbox for 'Stipite lato inferiore' (Seal bottom side).

**Sash rails & Floating mullion profiles / Pfosten & Stulpprofile / Profili per traverso & Profili per battuta centrale / Profile montant si Profile Stulp**

**Profile: 8080**  
Steel 8701  
43x27.5 - 2 mm

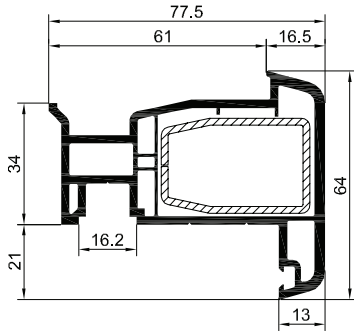

**Profile: 8039**  
Steel 8701  
43x27.5 - 2 mm

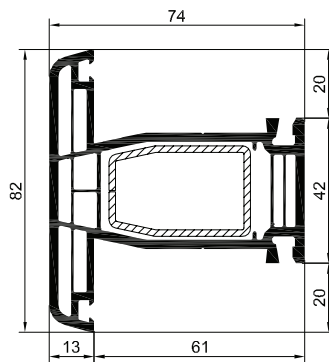

**Profile: 8040**  
Steel 8713  
49x34 - 2 mm

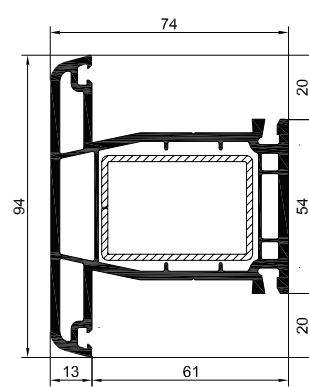

**Profile: 8273**  
Steel 8736

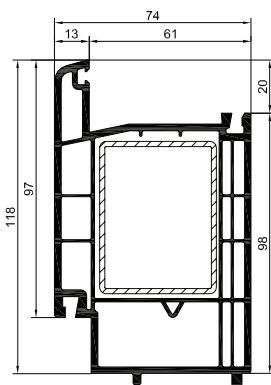

**Threshold & Weather bar / Schwelle & Wetter Schenkel / Soglia & Profilo Gocciolatoio /**  
Praguri & Lacrimare

**Profile: 6861501**

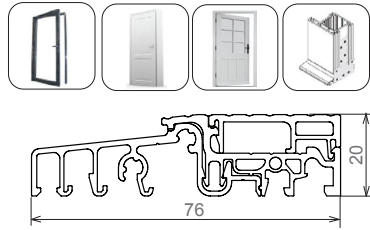

**Profile: 259599**

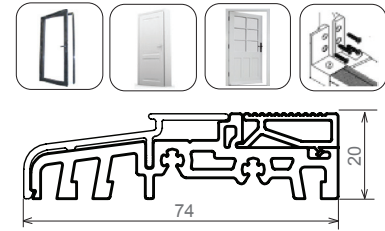

6861501	6861501 Soglia TT 20mm
6861501	6861501 Soglia TT 20mm con Guarnizione
8001	8001-Telaio a L 66mm
8001	8001-Telaio a L 66mm
8011	8010-Telaio a L 74mm
8011	8010-Telaio a L 74mm
8015	8015-Telaio a L 110mm Bianco
8015	8015-Telaio a L 110mm Bianco
8027	8027-Telaio a Z 50
8027	8027-Telaio a Z 50
8030	8030-Telaio a Z 30
8030	8030-Telaio a Z 30
FaraPrag	Senza Soglia

**Profile: LC01**



**Gasket: 6802101**



LC01	LC01
6802101	6802101

**Coupling Profiles** / Kopplungsprofile / Profili di accoppiamento / Profile cuplare

**Profile: 500730**

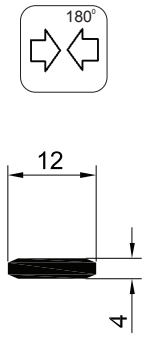

**Profile: 7281**

Steel 7796  
 $I_x=9,19\text{cm}^4$

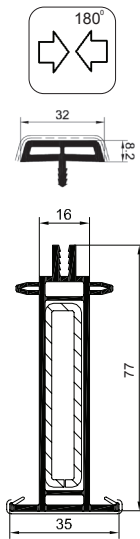

**Profile: 2304**

Steel 7718  
 $I_x=7,11\text{cm}^4$

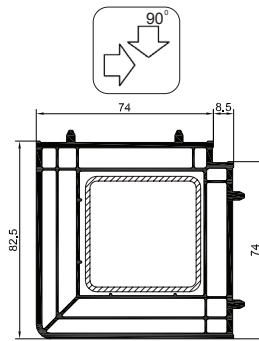

**Profile: 2233**

Steel 7711  
 $I_x=7,54\text{cm}^4$

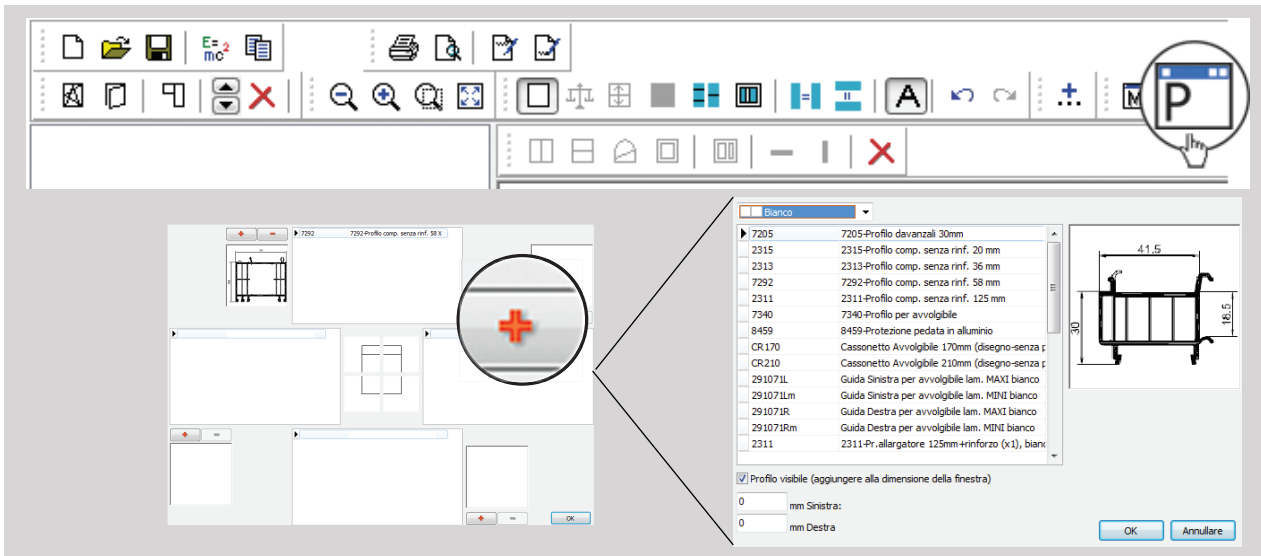
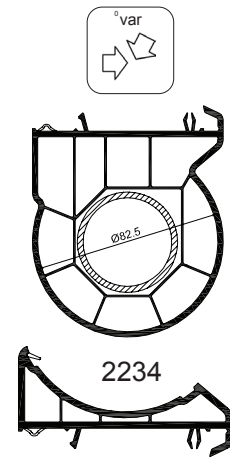

**Bank connection profile** / Bankanschluss profile / Profili di appoggio inferiore /  
Profile suprainaltare

**Profile: 3217**

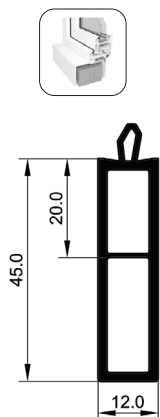

**Profile: 7310**

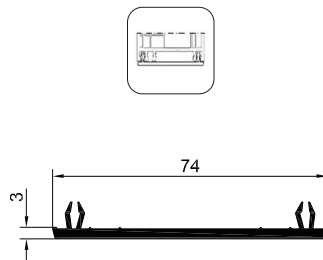

**Profile: 7205**

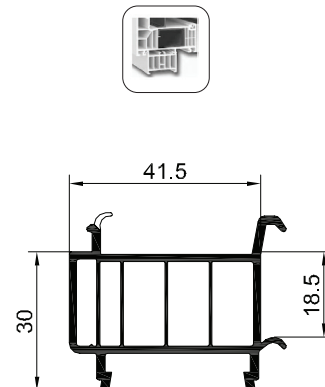

**Extension profile / Verbreiterung profile / Allargatori / Extensii toc**

**Profile: 2315**

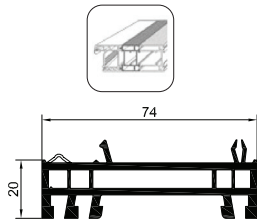

**Profile: 2313**  
Steel 2724\*  
\*Optional

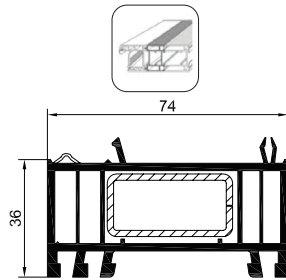

**Profile: 7292**  
Steel 2724\*  
\*Optional

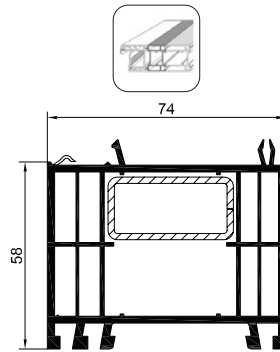

**Profile: 2311**  
Steel 2724\*  
\*Optional

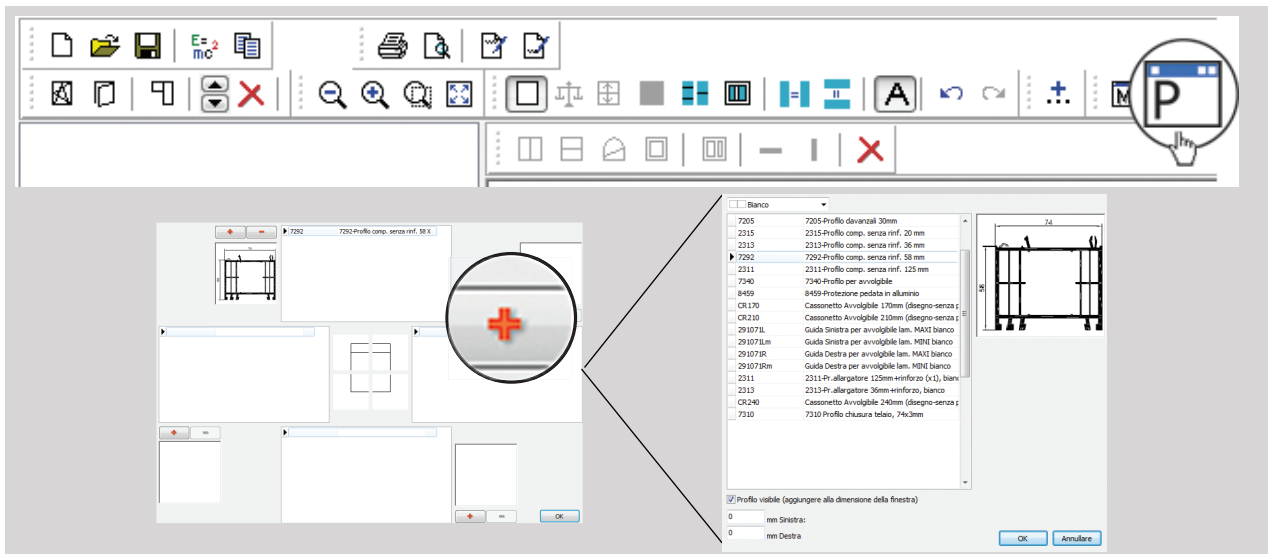
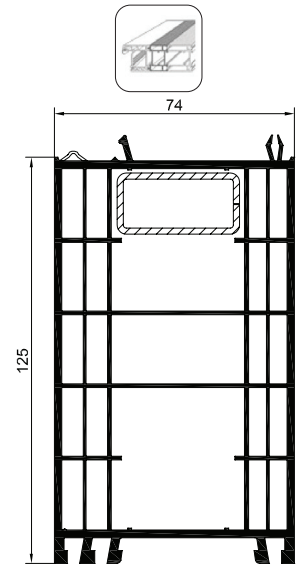

**Gasket / Dichtung / Guarnizione / Garnitură**

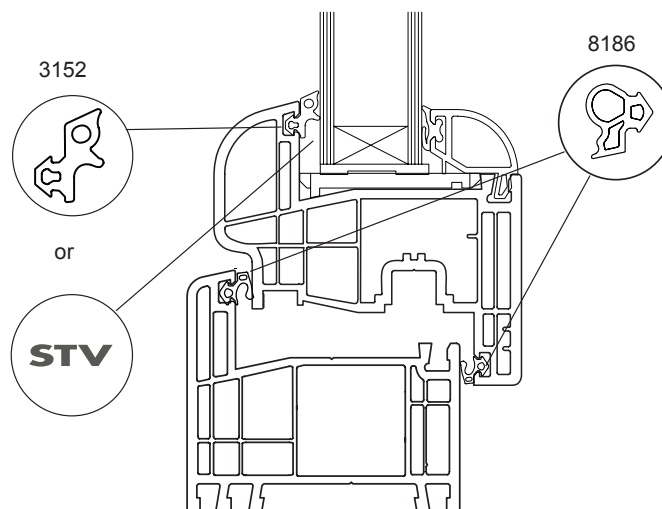

**Fixed light / Festfeld / Fissa / Fix**

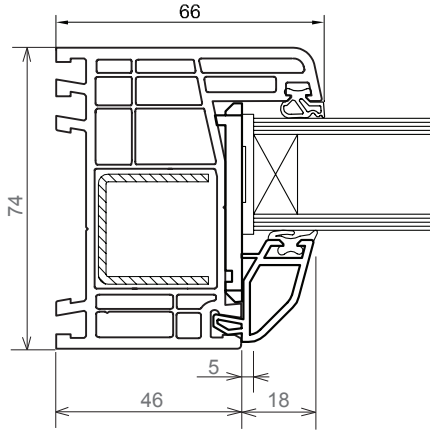
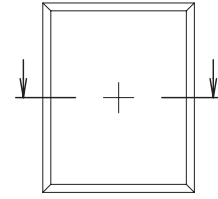

Frame	8001	 $I_x=2,20 \text{ cm}^4$ $I_y=1,35 \text{ cm}^4$
Steel	8727	
	28.5x28.5	
	t=2mm	

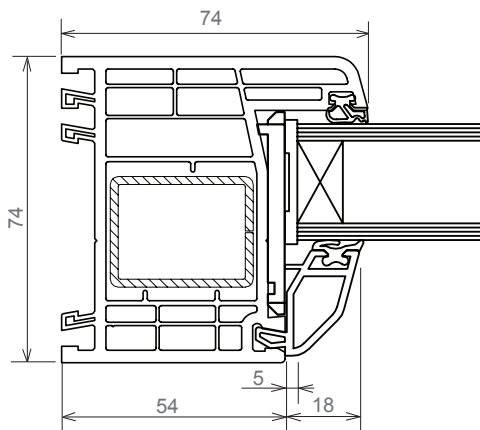

Frame	8010	 $I_x=2,65 \text{ cm}^4$ $I_y=3,95 \text{ cm}^4$
Steel	8710	
	27.5x35.5	
	t=2 mm	

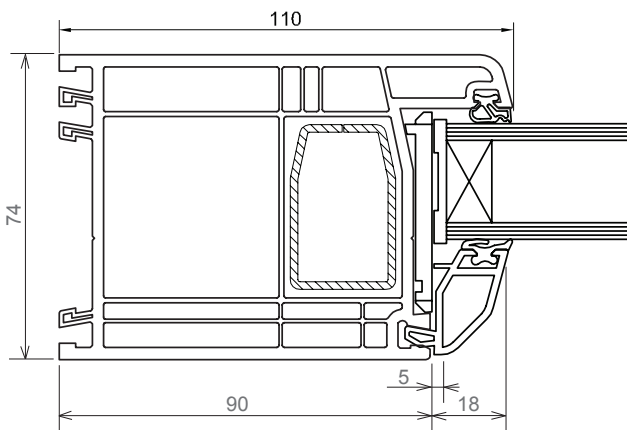

Frame	8015	 $I_x=5,92 \text{ cm}^4$ $I_y=2,87 \text{ cm}^4$
Steel	8701	
	43x27.5	
	t=2 mm	

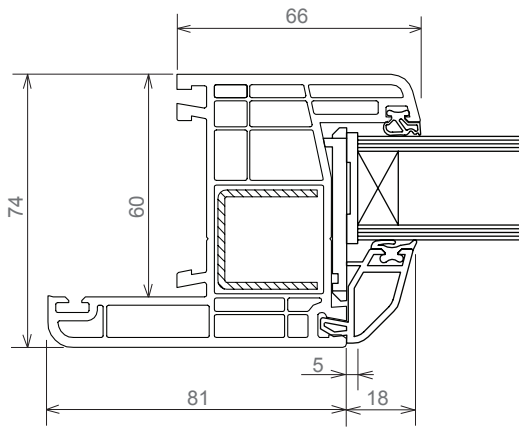

Frame	8033	$I_x=2,20 \text{ cm}^4$ $I_y=1,35 \text{ cm}^4$
Steel	8727	
	28.5x28.5 t=2mm	

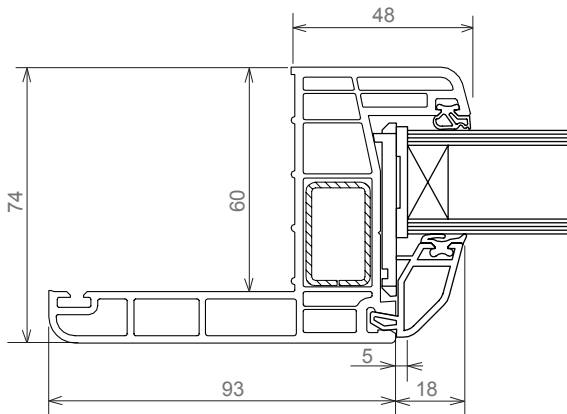

Frame	8034	$I_x=1,24 \text{ cm}^4$ $I_y=0,95 \text{ cm}^4$
Steel	6744	
	28x17.5 t=1.5 mm	

**Fixed light with transom / Festfeld Pfosten /**  
*Fissa con montate / Fix cu montant*

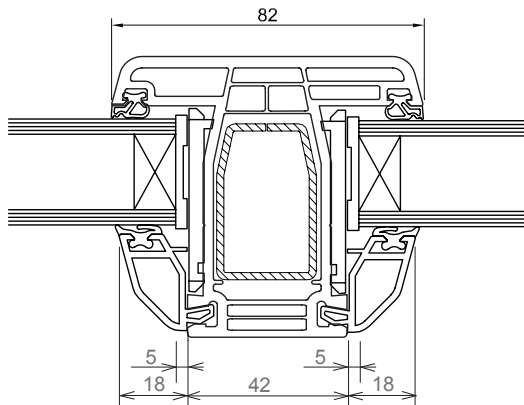
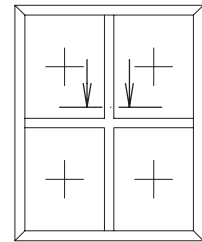

Transom	8039	$I_x=5,92 \text{ cm}^4$ $I_y=2,87 \text{ cm}^4$
Steel	8701	
	43x27.5 t = 2 mm	

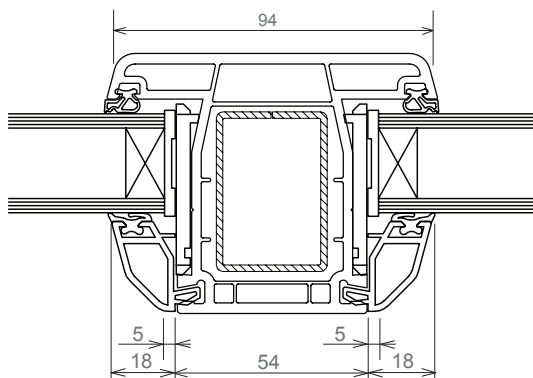

Transom	8040	$I_x=10,20 \text{ cm}^4$ $I_y=5,78 \text{ cm}^4$
Steel	8713	
	49x34 t = 2 mm	

**Frame - Sash / Blendrahmen - Flügel /**  
**Telaio - Anta / Toc - Cercevea**

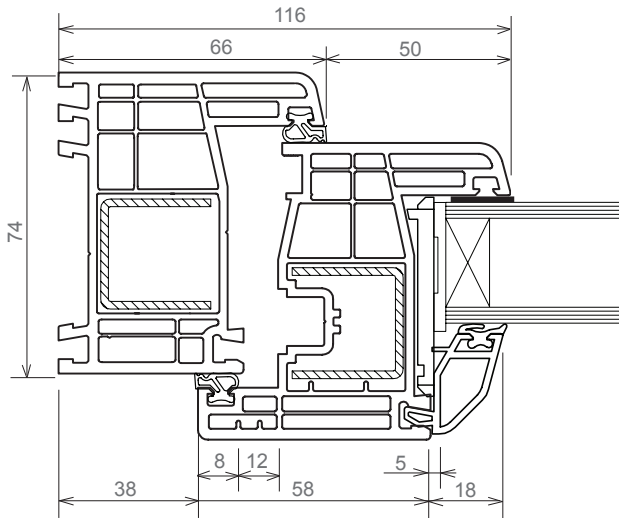
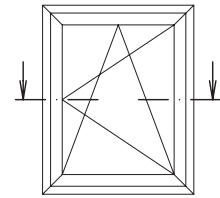

Frame	8001	$I_x=2,20 \text{ cm}^4$ $I_y=1,35 \text{ cm}^4$
Steel	8727 28.5x28.5 t=2mm	
Sash or Sash Steel	8095A  8096A 8727 28.5x28.5 t=2mm	$I_x=2,20 \text{ cm}^4$ $I_y=1,35 \text{ cm}^4$

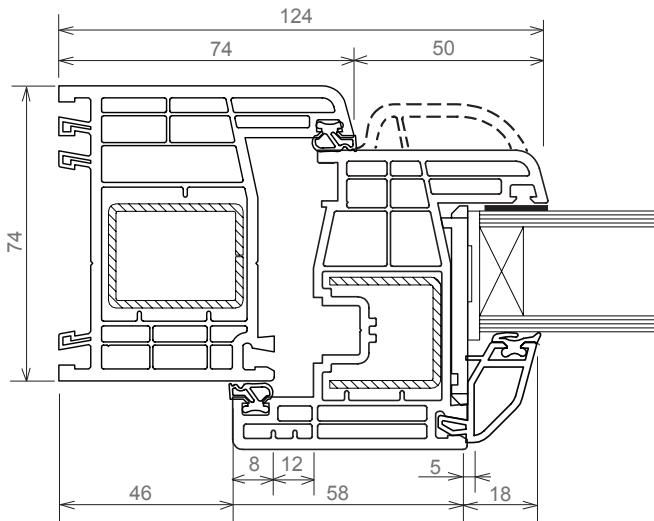

Frame	8010	$I_x=2,65 \text{ cm}^4$ $I_y=3,95 \text{ cm}^4$
Steel	8710 27.5x35.5 t=2 mm	
Sash or Sash Steel	8095A  8096A 8727 28.5x28.5 t=2mm	$I_x=2,20 \text{ cm}^4$ $I_y=1,35 \text{ cm}^4$

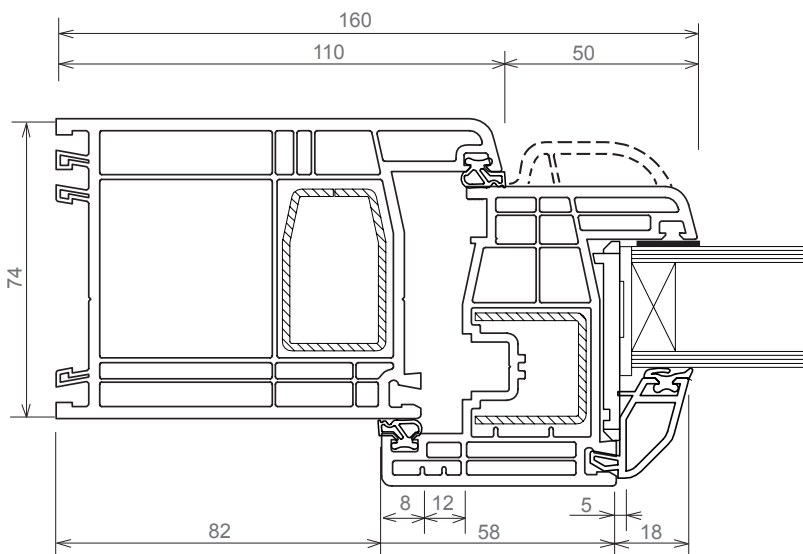

Frame	8015	$I_x=5,92 \text{ cm}^4$ $I_y=2,87 \text{ cm}^4$
Steel	8701 43x27.5 t=2 mm	
Sash or Sash Steel	8095A  8096A 8727 28.5x28.5 t=2mm	$I_x=2,20 \text{ cm}^4$ $I_y=1,35 \text{ cm}^4$



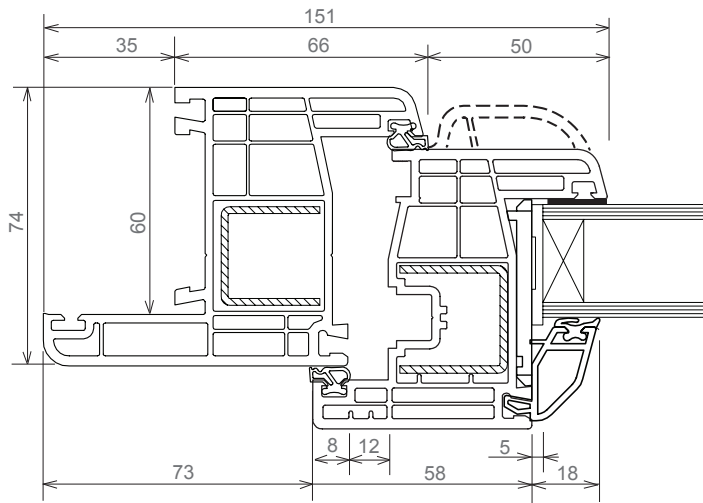

Frame	8033	
Steel	8727	$I_x=2,20 \text{ cm}^4$
	28.5x28.5	$I_y=1,35 \text{ cm}^4$
	t=2mm	
Sash	8095A	
or		
Sash	8096A	
Steel	8727	$I_x=2,20 \text{ cm}^4$
	28.5x28.5	$I_y=1,35 \text{ cm}^4$
	t=2mm	

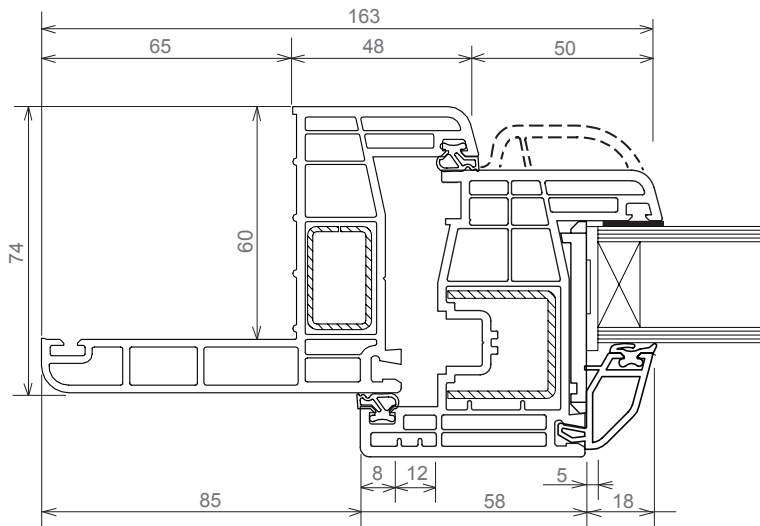

Frame	8034	
Steel	6744	$I_x=1,24 \text{ cm}^4$
	28x17.5	$I_y=0,95 \text{ cm}^4$
	t=1.5 mm	
Sash	8095A	
or		
Sash	8096A	
Steel	8727	$I_x=2,20 \text{ cm}^4$
	28.5x28.5	$I_y=1,35 \text{ cm}^4$
	t=2mm	

**Fixed light - Transom - Sash** / Festfeld - Pfosten - Flügel /  
Fisso - Montante - Anta / Fix - Montant - Cercevea

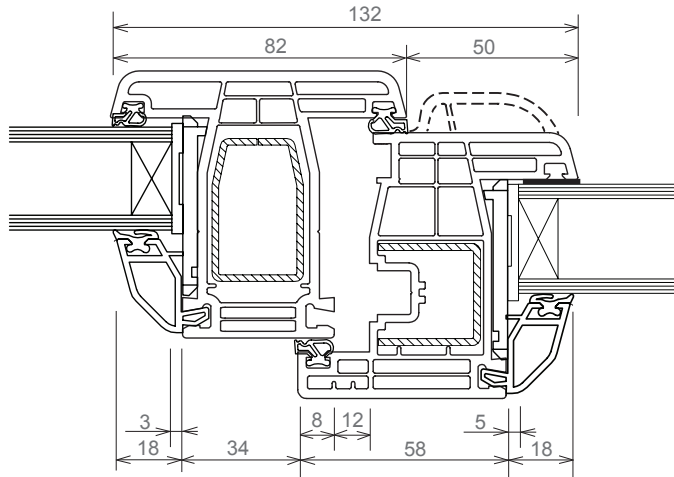
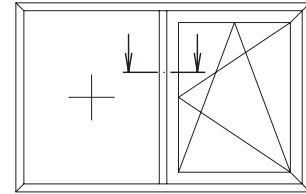

Transom	8039	
Steel	8701	$I_x=5,92 \text{ cm}^4$ $I_y=2,87 \text{ cm}^4$
	43x27.5	
	t=2 mm	
Sash	8095A	
or		
Sash	8096A	
Steel	8727	$I_x=2,20 \text{ cm}^4$ $I_y=1,35 \text{ cm}^4$
	28.5x28.5	
	t=2mm	

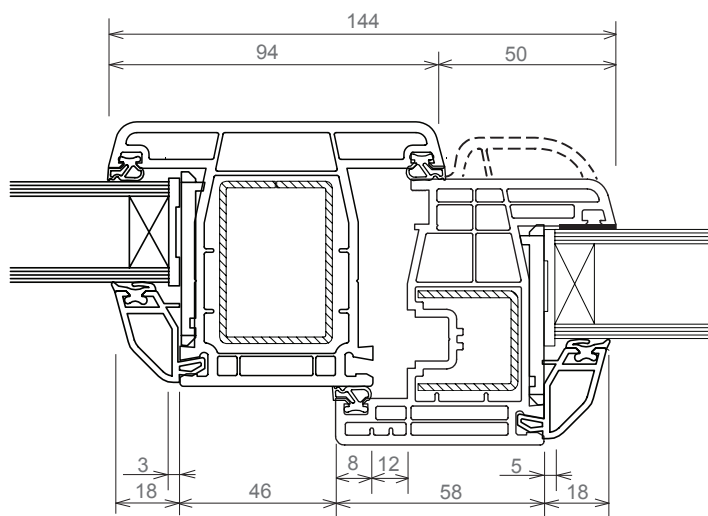

Transom	8040	
Steel	8713	$I_x=10,20 \text{ cm}^4$ $I_y=5,78 \text{ cm}^4$
	49x34	
	t = 2 mm	
Sash	8095A	
or		
Sash	8096A	
Steel	8727	$I_x=2,20 \text{ cm}^4$ $I_y=1,35 \text{ cm}^4$
	28.5x28.5	
	t=2mm	

**Sash - Transom - Sash / Flügel Pfosten Flügel /  
Anta - Montante Anta / Cercevea - Montant - Cercevea**

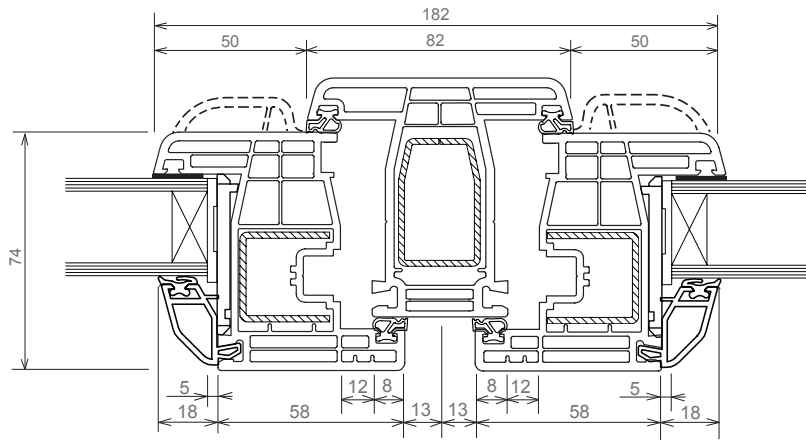
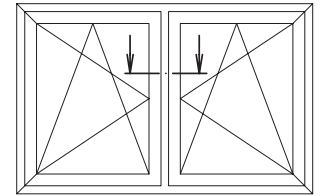

Sash or Sash Steel	8095A  8096A 8727 28.5x28.5 t=2mm	$I_x=2,20 \text{ cm}^4$ $I_y=1,35 \text{ cm}^4$
Transom Steel	8039 8701 43x27.5 t=2 mm	$I_x=5,92 \text{ cm}^4$ $I_y=2,87 \text{ cm}^4$
Sash or Sash Steel	8095A  8096A 8727 28.5x28.5 t=2mm	$I_x=2,20 \text{ cm}^4$ $I_y=1,35 \text{ cm}^4$

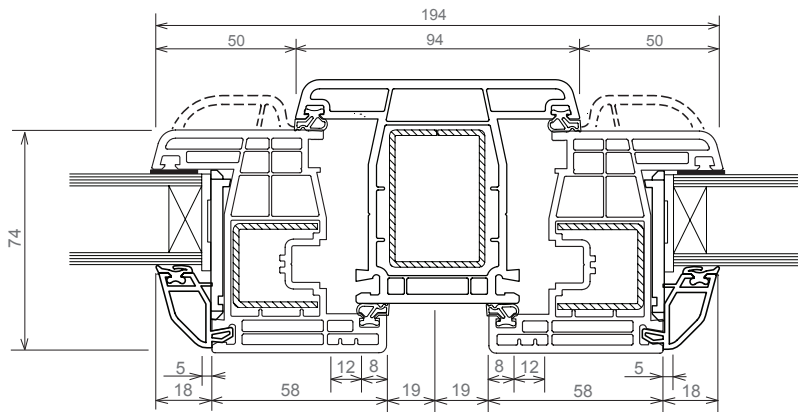

Sash or Sash Steel	8095A  8096A 8727 28.5x28.5 t=2mm	$I_x=2,20 \text{ cm}^4$ $I_y=1,35 \text{ cm}^4$
Transom Steel	8040 8713 49x34 t = 2 mm	$I_x=10,20 \text{ cm}^4$ $I_y=5,78 \text{ cm}^4$
Sash or Sash Steel	8095A  8096A 8727 28.5x28.5 t=2mm	$I_x=2,20 \text{ cm}^4$ $I_y=1,35 \text{ cm}^4$

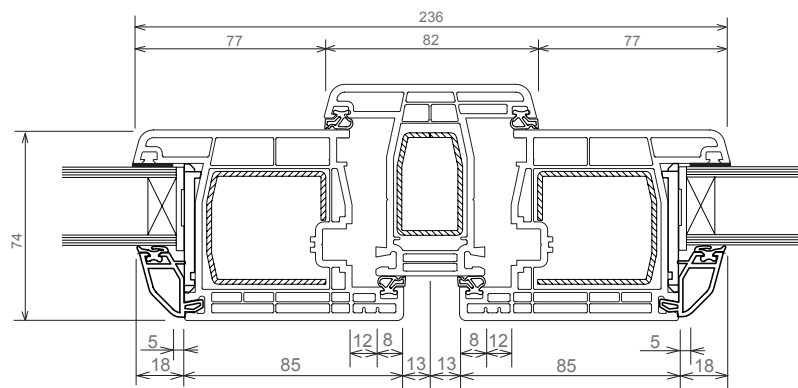

Sash Steel	8081 8706 48.5x46 t=2 mm	$I_x=10,60 \text{ cm}^4$ $I_y=9,22 \text{ cm}^4$
Transom Steel	8039 8701 43x27.5 t=2 mm	$I_x=5,92 \text{ cm}^4$ $I_y=2,87 \text{ cm}^4$
Sash Steel	8081 8706 48.5x46 t=2 mm	$I_x=10,60 \text{ cm}^4$ $I_y=9,22 \text{ cm}^4$

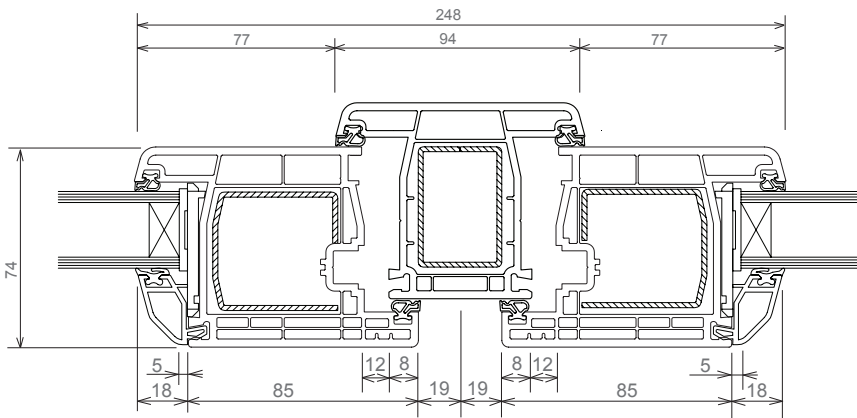

Sash	8081	
Steel	8706	$I_x=10,60 \text{ cm}^4$
	48.5x46	$I_y=9,22 \text{ cm}^4$
	t=2 mm	
Transom	8040	
Steel	8713	$I_x=10,20 \text{ cm}^4$
	49x34	$I_y=5,78 \text{ cm}^4$
	t = 2 mm	
Sash	8081	
Steel	8706	$I_x=10,60 \text{ cm}^4$
	48.5x46	$I_y=9,22 \text{ cm}^4$
	t=2 mm	

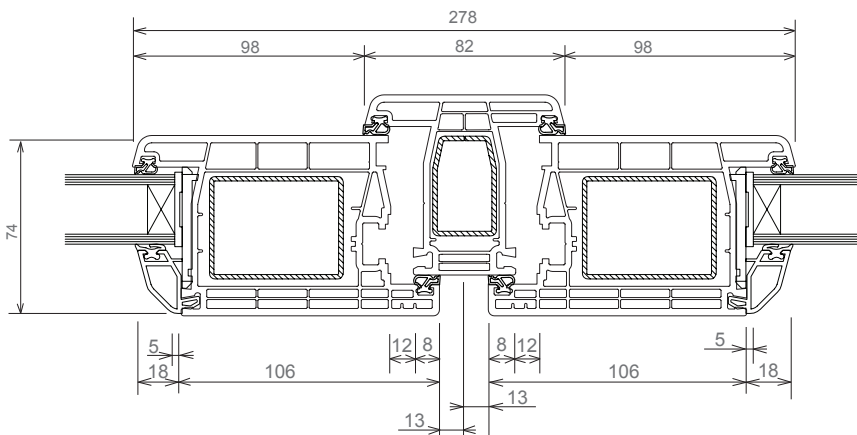

Sash	8076	
Steel	8736	$I_x=13,83 \text{ cm}^4$
	40x60	$I_y=20,88 \text{ cm}^4$
	t=2 mm	
Transom	8039	
Steel	8701	$I_x=5,92 \text{ cm}^4$
	43x27.5	$I_y=2,87 \text{ cm}^4$
	t=2 mm	
Sash	8076	
Steel	8736	$I_x=13,83 \text{ cm}^4$
	40x60	$I_y=20,88 \text{ cm}^4$
	t=2 mm	

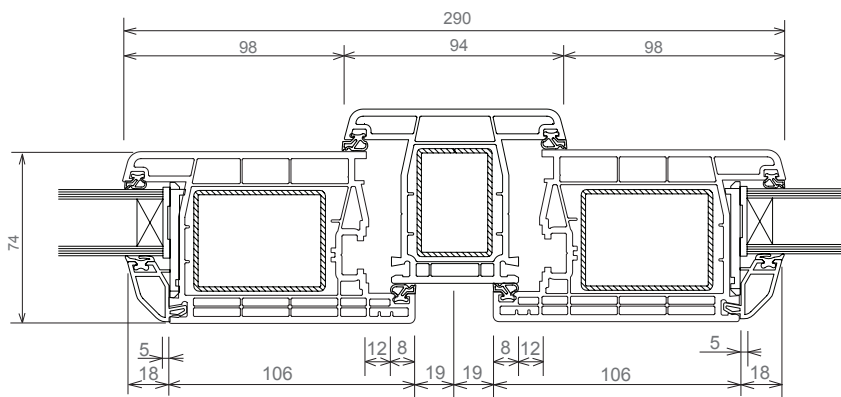

Sash	8076	
Steel	8736	$I_x=13,83 \text{ cm}^4$
	40x60	$I_y=20,88 \text{ cm}^4$
	t=2 mm	
Transom	8040	
Steel	8713	$I_x=10,20 \text{ cm}^4$
	49x34	$I_y=5,78 \text{ cm}^4$
	t = 2 mm	
Sash	8076	
Steel	8736	$I_x=13,83 \text{ cm}^4$
	40x60	$I_y=20,88 \text{ cm}^4$
	t=2 mm	

**Sash - Floating Mullion - Sash / Flügel - Stulp - Flügel /  
Anta - Profilo Riporto - Anta / Cercevea - Ștulp - Cercevea**

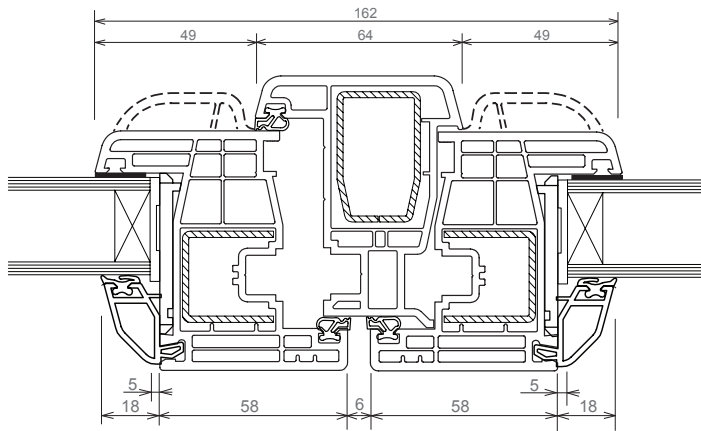
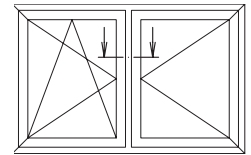

Sash	8095A	$I_x=2,20 \text{ cm}^4$ $I_y=1,35 \text{ cm}^4$
or		
Sash	8096A	
Steel	8727 28.5x28.5 t=2mm	
Floating	8080	$I_x=5,92 \text{ cm}^4$ $I_y=2,87 \text{ cm}^4$
Mullion		
Steel	8701 43x27.5 t=2 mm	
Sash	8095A	$I_x=2,20 \text{ cm}^4$ $I_y=1,35 \text{ cm}^4$
or		
Sash	8096A	
Steel	8727 28.5x28.5 t=2mm	

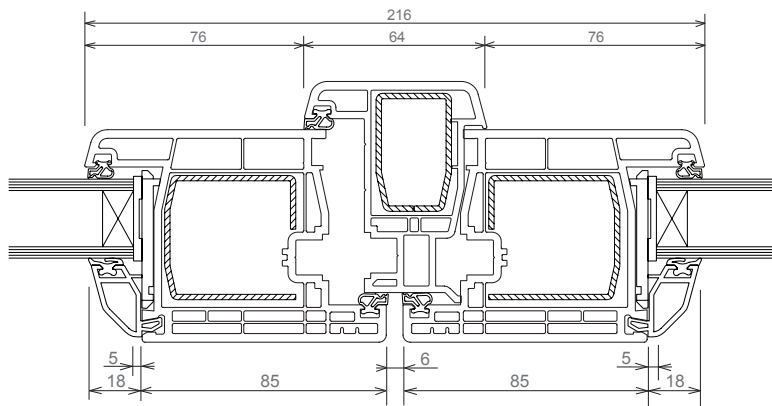

Sash	8081	$I_x=10,60 \text{ cm}^4$ $I_y=9,22 \text{ cm}^4$
Steel	8706 48.5x46 t=2 mm	
Floating	8080	$I_x=5,92 \text{ cm}^4$ $I_y=2,87 \text{ cm}^4$
Mullion		
Steel	8701 43x27.5 t=2 mm	
Sash	8081	$I_x=10,60 \text{ cm}^4$ $I_y=9,22 \text{ cm}^4$
Steel	8706 48.5x46 t=2 mm	

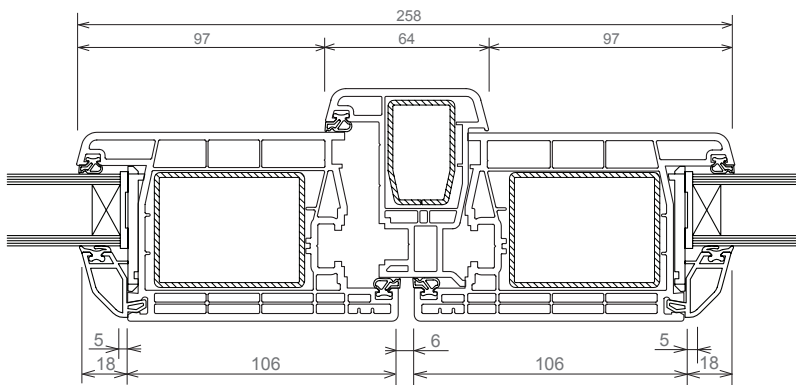

Sash	8076	$I_x=13,83 \text{ cm}^4$ $I_y=20,88 \text{ cm}^4$
Steel	8736 40x60 t=2 mm	
Floating	8080	$I_x=5,92 \text{ cm}^4$ $I_y=2,87 \text{ cm}^4$
Mullion		
Steel	8701 43x27.5 t=2 mm	
Sash	8076	$I_x=13,83 \text{ cm}^4$ $I_y=20,88 \text{ cm}^4$
Steel	8736 40x60 t=2 mm	

**Frame - Sash / Blendrahmen Flügel /  
Telaio - Anta / Toc - Cercevea**

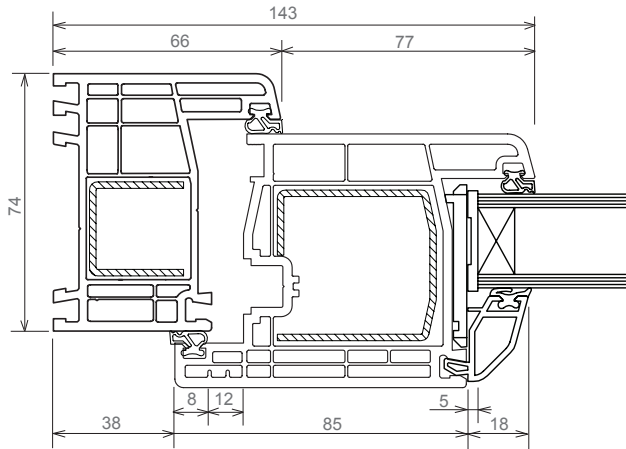
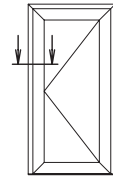

Frame	8001	
Steel	8727	$I_x=2,20 \text{ cm}^4$
	28.5x28.5	$I_y=1,35 \text{ cm}^4$
	t=2mm	
Sash	8081	
Steel	8706	$I_x=10,60 \text{ cm}^4$
	48.5x46	$I_y=9,22 \text{ cm}^4$
	t=2 mm	

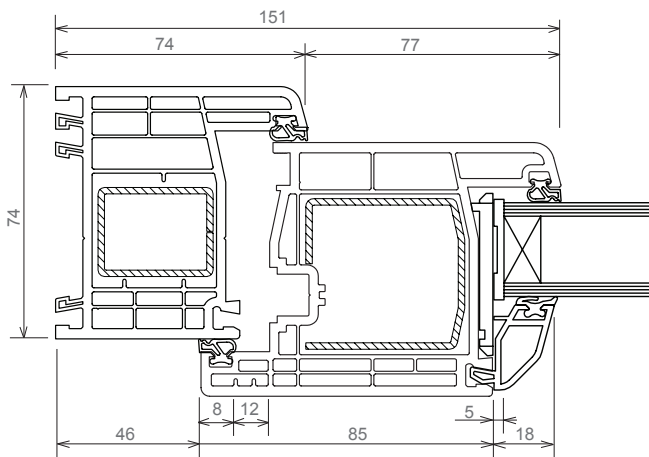

Frame	8010	
Steel	8710	$I_x=2,65 \text{ cm}^4$
	27.5x35.5	$I_y=3,95 \text{ cm}^4$
	t=2 mm	
Sash	8081	
Steel	8706	$I_x=10,60 \text{ cm}^4$
	48.5x46	$I_y=9,22 \text{ cm}^4$
	t=2 mm	

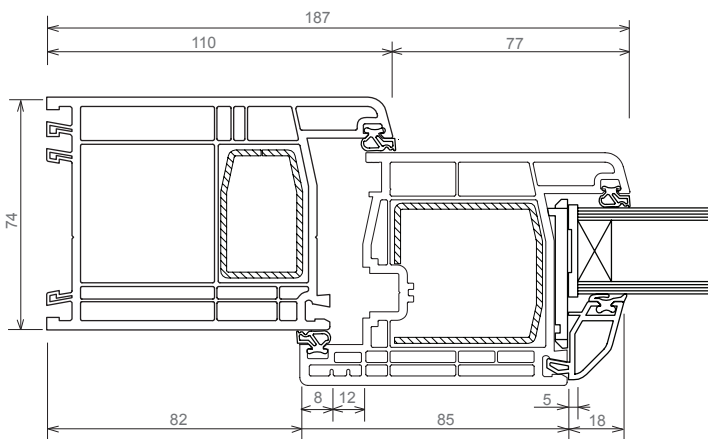

Frame	8015	
Steel	8701	$I_x=5,92 \text{ cm}^4$
	43x27.5	$I_y=2,87 \text{ cm}^4$
	t=2 mm	
Sash	8081	
Steel	8706	$I_x=10,60 \text{ cm}^4$
	48.5x46	$I_y=9,22 \text{ cm}^4$
	t=2 mm	

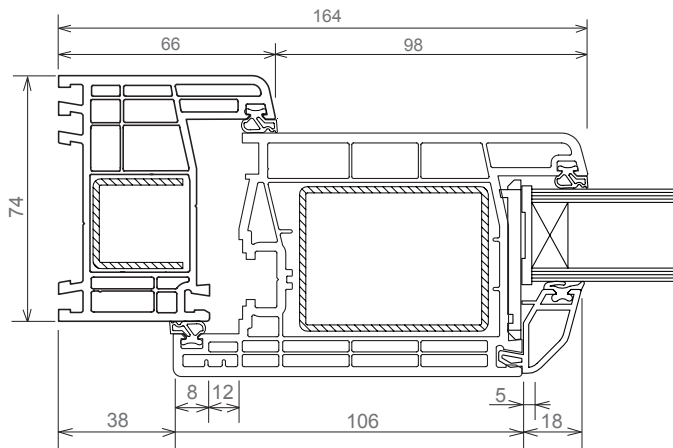

Frame	8001	$I_x=2,20 \text{ cm}^4$ $I_y=1,35 \text{ cm}^4$
Steel	8727 28.5x28.5 t=2mm	
Sash	8076	
Steel	8736 40x60 t=2 mm	$I_x=13,83 \text{ cm}^4$ $I_y=20,88 \text{ cm}^4$

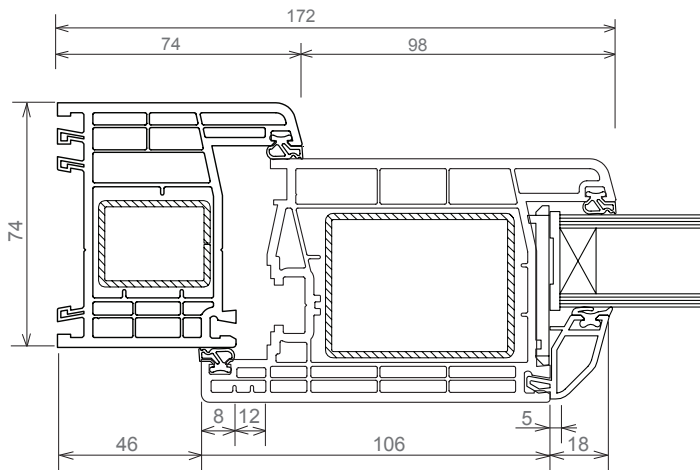

Frame	8010	$I_x=2,65 \text{ cm}^4$ $I_y=3,95 \text{ cm}^4$
Steel	8710 27.5x35.5 t=2 mm	
Sash	8076	
Steel	8736 40x60 t=2 mm	$I_x=13,83 \text{ cm}^4$ $I_y=20,88 \text{ cm}^4$

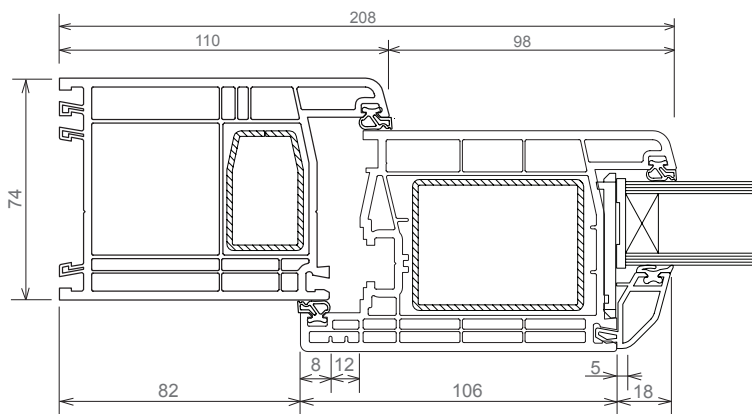

Frame	8015	$I_x=5,92 \text{ cm}^4$ $I_y=2,87 \text{ cm}^4$
Steel	8701 43x27.5 t=2 mm	
Sash	8076	
Steel	8736 40x60 t=2 mm	$I_x=13,83 \text{ cm}^4$ $I_y=20,88 \text{ cm}^4$

**Threshold - Sash / Schwellenprofil - Flügel /  
Soglia - Anta / Prag - Cercevea**

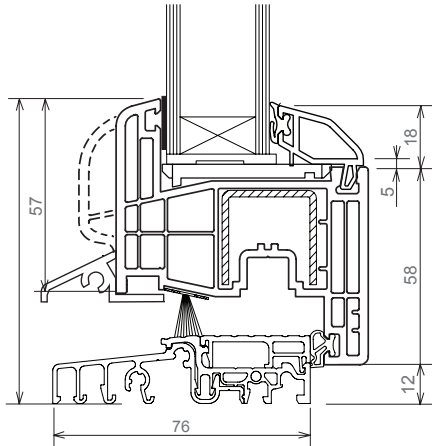
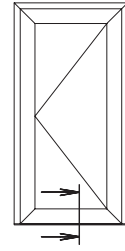

Threshold	6861501	
Sash	8095A	
or		
Sash	8096A	$I_x=2,20 \text{ cm}^4$ $I_y=1,35 \text{ cm}^4$
Steel	8727	
	28.5x28.5 t=2mm	

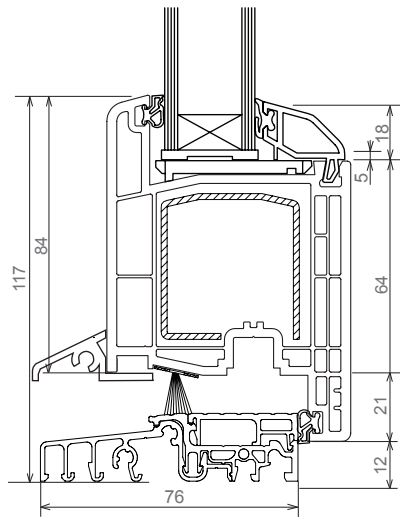

Threshold	6861501	
Sash	8081	
Steel	8706	$I_x=10,60 \text{ cm}^4$ $I_y=9,22 \text{ cm}^4$
	48.5x46	
	t=2 mm	

**Weather bar** - elox  
Wetterschenkel - elox  
*Profilo gocciolatoio* - elox  
Lăcrimar - elox

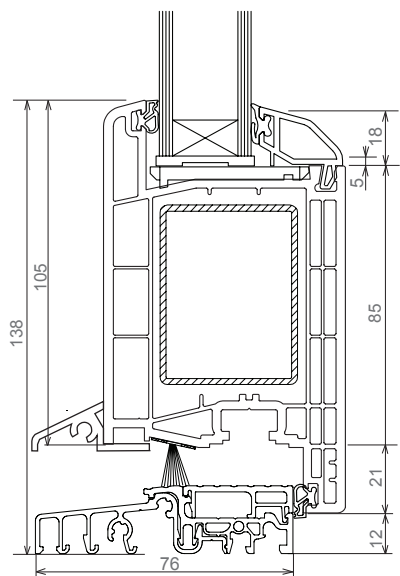

Threshold	6861501	
Sash	8076	
Steel	8736	$I_x=13,83 \text{ cm}^4$ $I_y=20,88 \text{ cm}^4$
	40x60	
	t=2 mm	

**Weather bar** - elox  
Wetterschenkel - elox  
*Profilo gocciolatoio* - elox  
Lăcrimar - elox



**Frame - Sash outside opening / Blendrahmen - Flügel außen öffnend /**  
*Telaio - Anta apertura esterna / Toc - Cercevea deschidere exterioară*

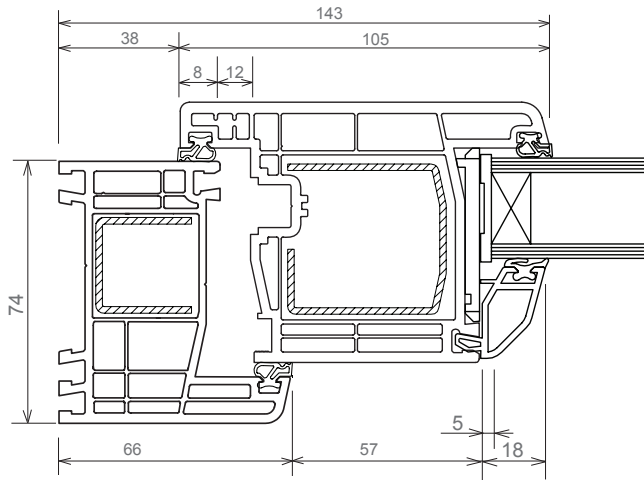
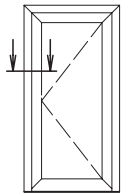

Frame	8001	
Steel	8727	$I_x=2,20 \text{ cm}^4$
	28.5x28.5	$I_y=1,35 \text{ cm}^4$
	t=2mm	
Sash	8078	
Steel	8706	$I_x=10,60 \text{ cm}^4$
	48.5x46	$I_y=9,22 \text{ cm}^4$
	t=2 mm	

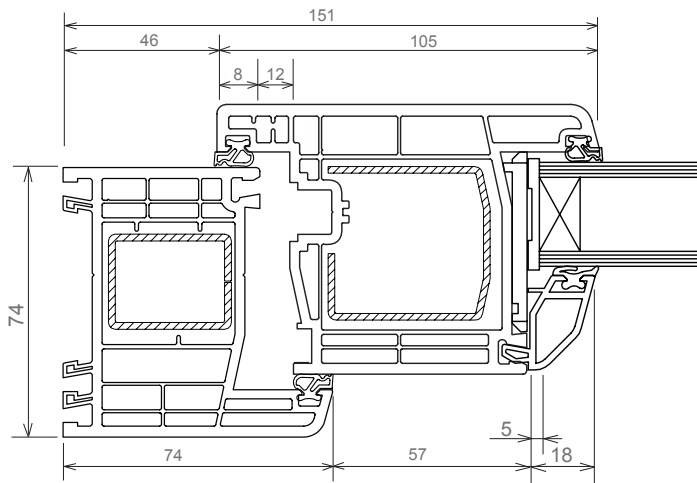

Frame	8010	
Steel	8710	$I_x=2,65 \text{ cm}^4$
	27.5x35.5	$I_y=3,95 \text{ cm}^4$
	t=2 mm	
Sash	8078	
Steel	8706	$I_x=10,60 \text{ cm}^4$
	48.5x46	$I_y=9,22 \text{ cm}^4$
	t=2 mm	

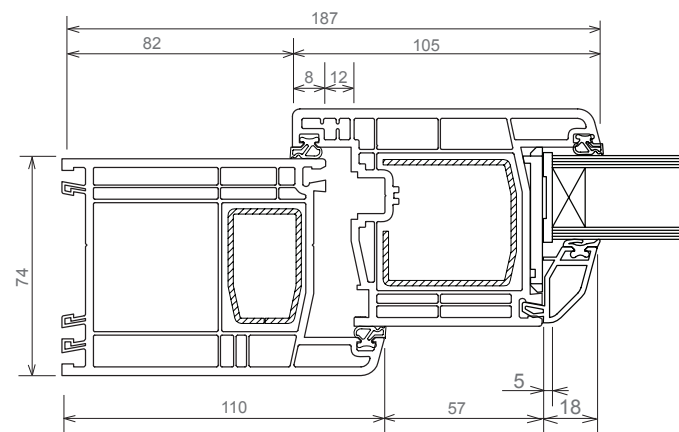

Frame	8015	
Steel	8701	$I_x=5,92 \text{ cm}^4$
	43x27.5	$I_y=2,87 \text{ cm}^4$
	t=2 mm	
Sash	8078	
Steel	8706	$I_x=10,60 \text{ cm}^4$
	48.5x46	$I_y=9,22 \text{ cm}^4$
	t=2 mm	

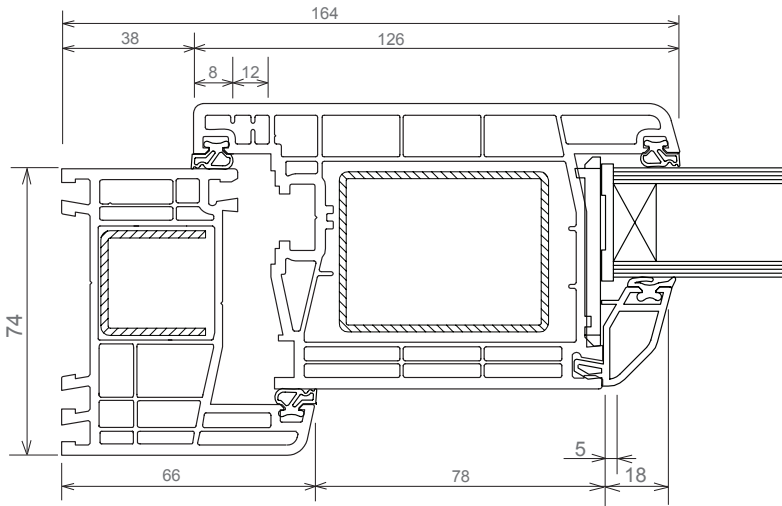

Frame	8001	
Steel	8727	$I_x=2,20 \text{ cm}^4$
	28.5x28.5	$I_y=1,35 \text{ cm}^4$
	t=2mm	
Sash	8042	
Steel	8736	$I_x=13,83 \text{ cm}^4$
	40x60	$I_y=20,88 \text{ cm}^4$
	t=2 mm	

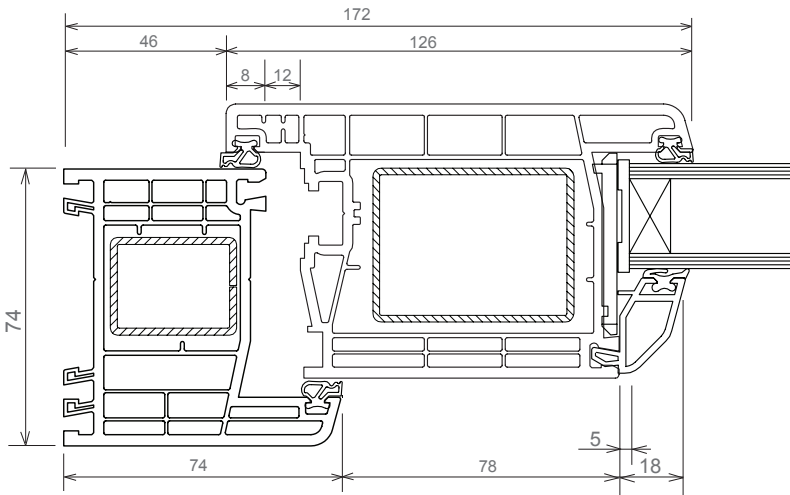

Frame	8010	
Steel	8710	$I_x=2,65 \text{ cm}^4$
	27.5x35.5	$I_y=3,95 \text{ cm}^4$
	t=2 mm	
Sash	8042	
Steel	8736	$I_x=13,83 \text{ cm}^4$
	40x60	$I_y=20,88 \text{ cm}^4$
	t=2 mm	

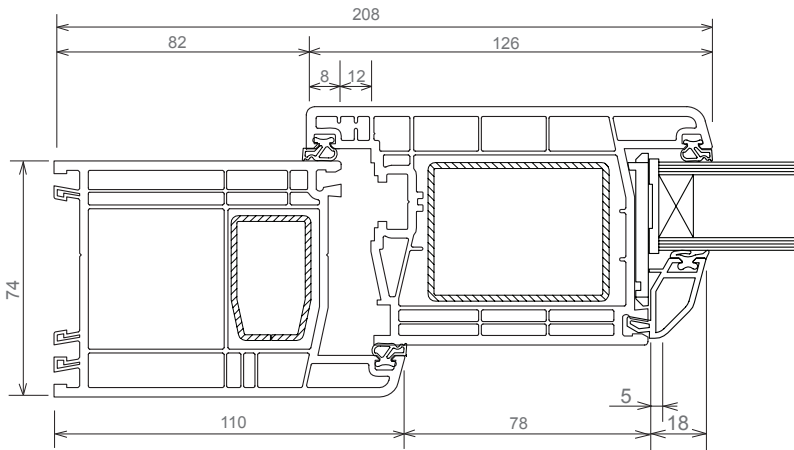

Frame	8015	
Steel	8701	$I_x=5,92 \text{ cm}^4$
	43x27.5	$I_y=2,87 \text{ cm}^4$
	t=2 mm	
Sash	8042	
Steel	8736	$I_x=13,83 \text{ cm}^4$
	40x60	$I_y=20,88 \text{ cm}^4$
	t=2 mm	

**Threshold - Sash outside opening / Schwellenprofil - Flügel außen öffnend /**  
**Soglia - Anta apertura esterna / Prag - Cercevea deschidere exterioară**

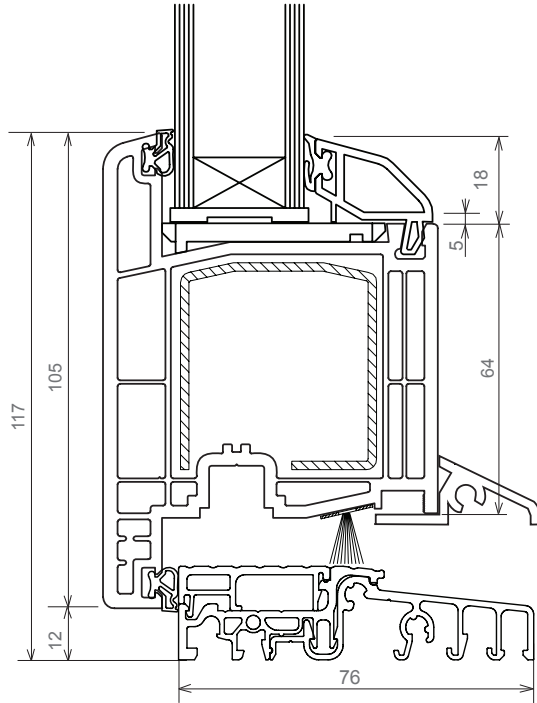
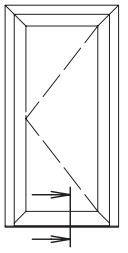

Threshold	6861501	$I_x=10,60 \text{ cm}^4$ $I_y=9,22 \text{ cm}^4$
Sash	8078	
Steel	8706	
	48.5x46 t=2 mm	

**Weather bar** - elox  
Wetterschenkel - elox  
*Profilo gocciolatoio* - elox  
Lăcrimar - elox

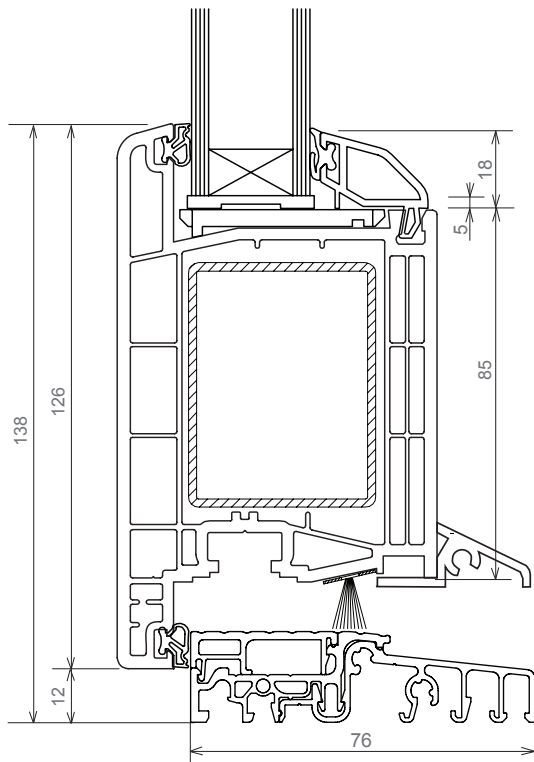

Threshold	6861501	$I_x=13,83 \text{ cm}^4$ $I_y=20,88 \text{ cm}^4$
Sash	8042	
Steel	8736	
	40x60 t=2 mm	

**Weather bar** - elox  
Wetterschenkel - elox  
*Profilo gocciolatoio* - elox  
Lăcrimar - elox

**Coupling profiles / Kopplungsprofile /  
Profili di accoppiamento / Profile de cuplare**

**Coupling profile gasket / Kopplungsdichtung /  
Guarnizione giunto / Garnitură de cuplare**

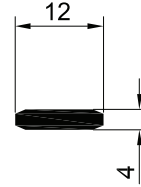
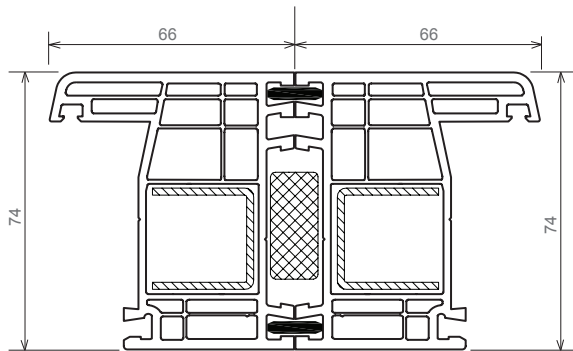

500730

**H coupler / H Kopplung / Profilo di accoppiamento /  
Profil cuplare ranforsat**

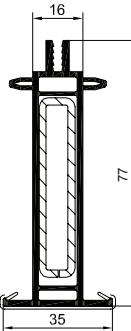
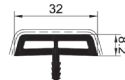
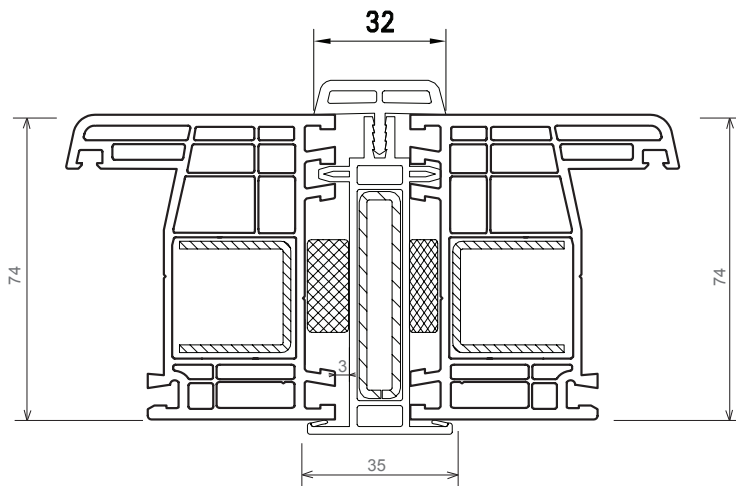

7281

Steel 7796

$I_x=9,19\text{cm}^4$

**Corner coupling 90° / Eckkopplung 90° /  
Giunto angolare 90° / Profil cuplare 90°**

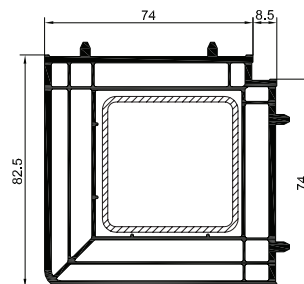
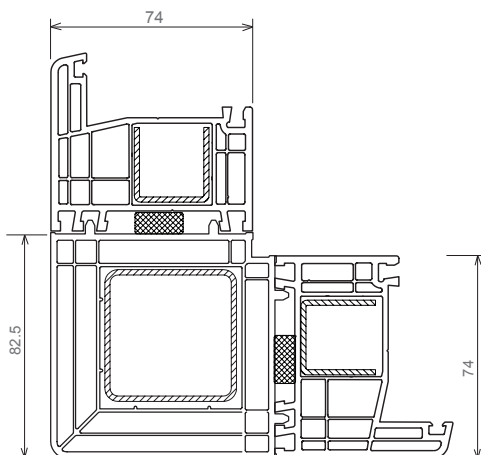

2304

Steel 7718

$I_x=7,11\text{cm}^4$

**Bay pole** / Eckkopplung variabel / *Giunto angolare variabile* / Profil cuplare unghi variabil

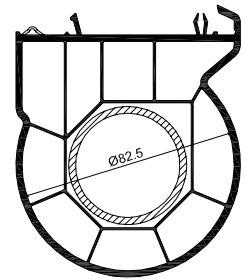
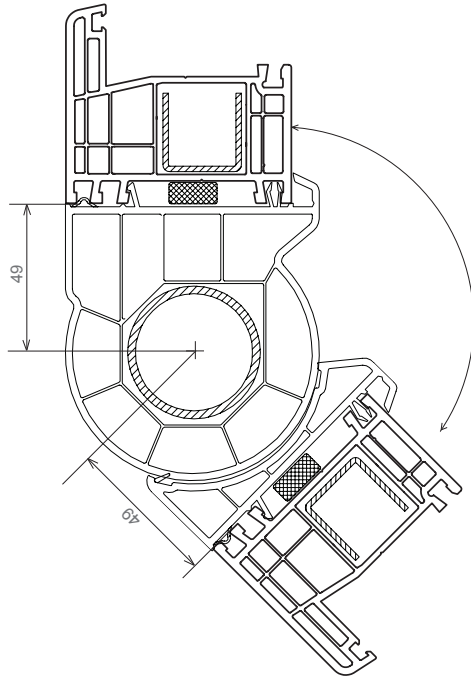

2233  
Steel 7711  
 $I_x = 7,54 \text{ cm}^4$

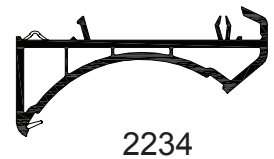

2234

**Base profiles** / Sohlbankprofile /  
*Profilo appoggio inferiore* / Profile supraînălțare pervaz

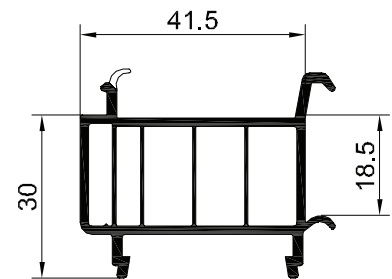
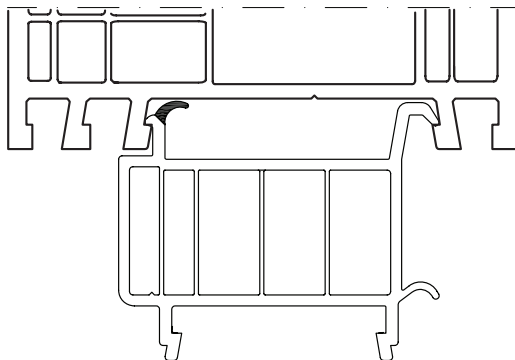

7205

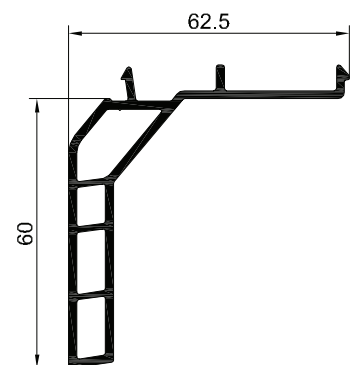
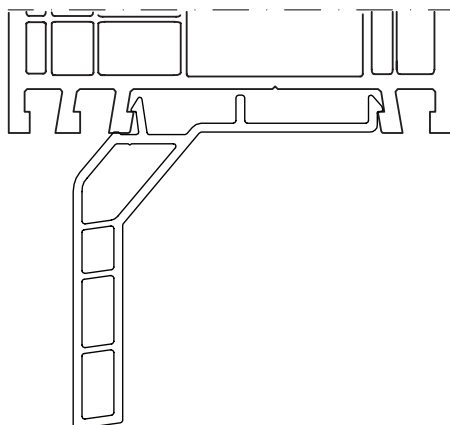

7209

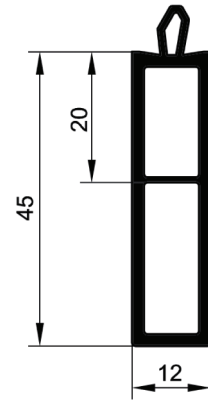
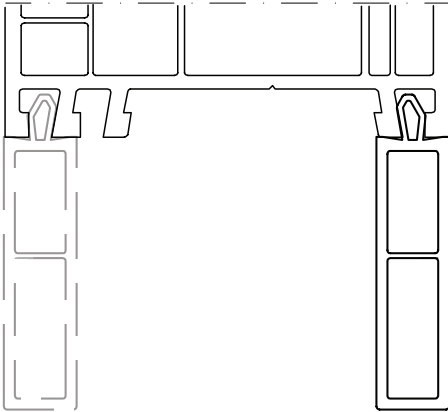

3217

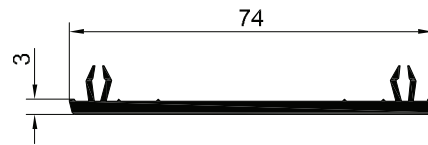
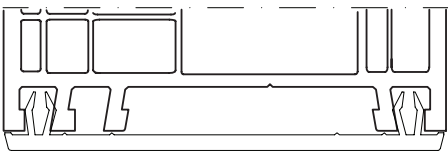

7310

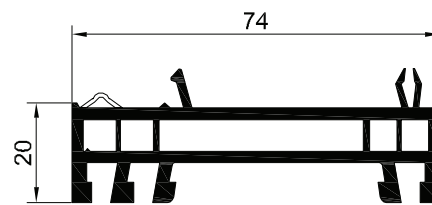
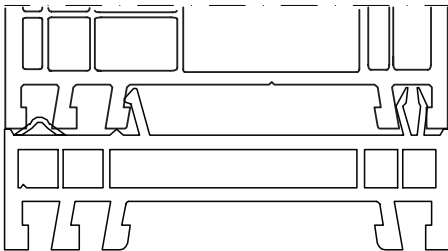

2315

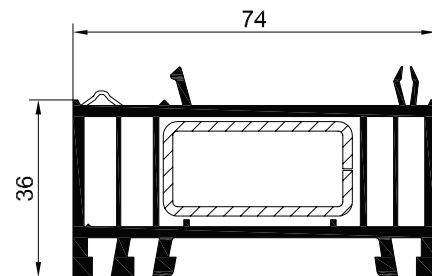
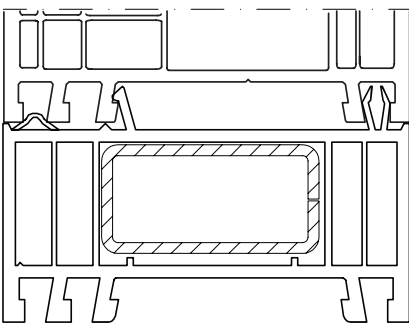

2313  
Steel 2724\*  
\*Optional

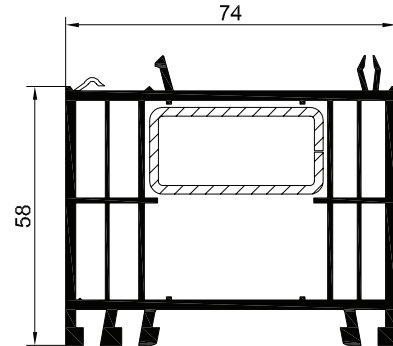
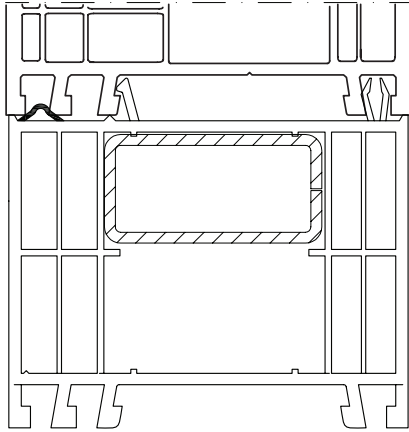

7292  
Steel 2724\*  
\*Optional

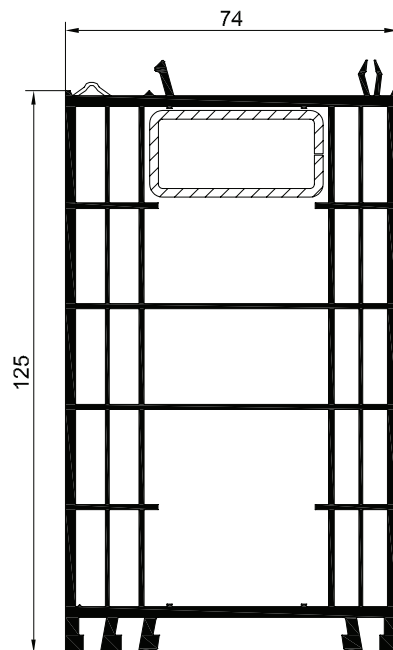
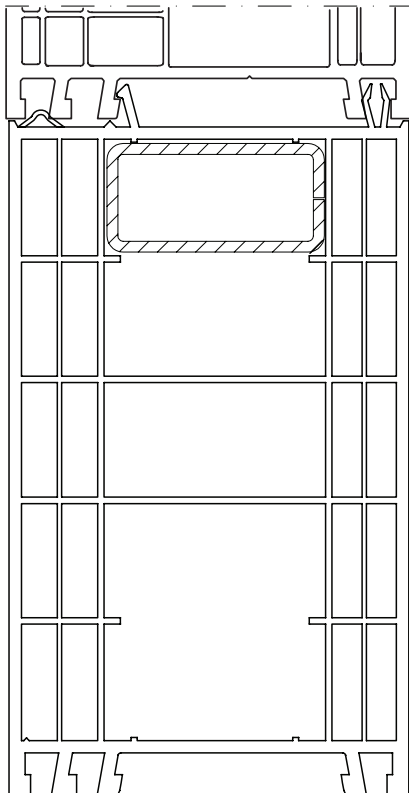

2311  
Steel 2724\*  
\*Optional

**Auxiliary profiles / Zusatzprofile / Profili aggiuntivi / Profile auxiliare**

**Aluminum foot-step angle / Alu-Trittwinkel / Protezione pedata in alluminio / Protecție aluminiu toc**

**Cover profile / Abdeck Profil / Profilo chiudi-cava / Profil închidere nut**

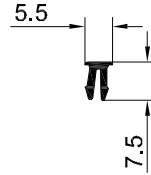
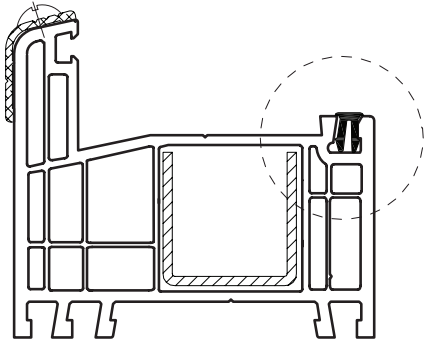

230600

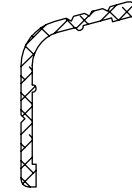

8459

**Weather bar / Wetterschenkel / Profilo gocciolatoio / Lăcrimar**

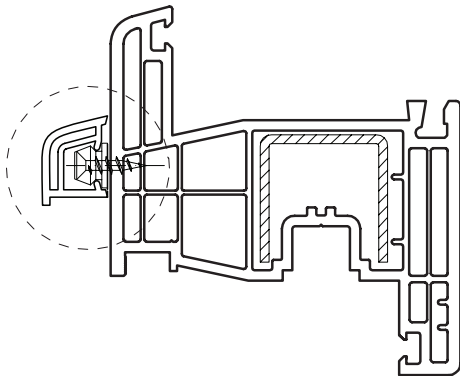

3325



3327

**Extension profile / Verbreiterung / Profilo zoccolo porta / Profil bandou ușă**

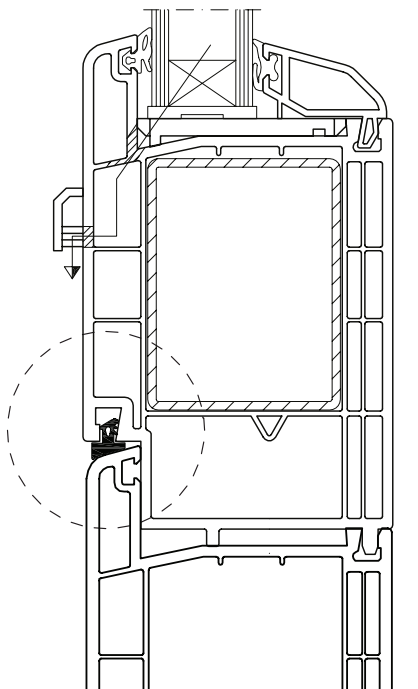

8177

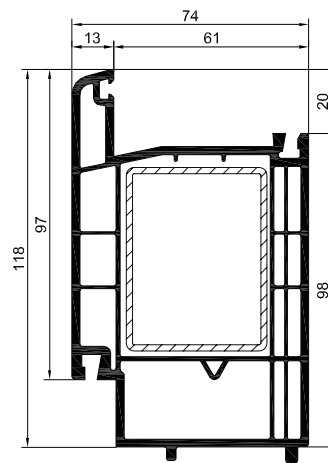

8273  
Steel 8736



**Roller shutter profiles / Rollladen Zusatzprofile / Profili aggiuntivi per avvolgibile / Profile rulouri**

**Roller shutter guide profile / Rollladen Ablaufprofil / Profilo guida tapparelle / Profil ghidaj cover lamele rulou**

**Roller shutter feeding form / Rollladeneinlauftrichter / Convogliatore avvolgibile / Ghidaj șină rulou**

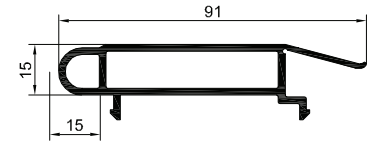
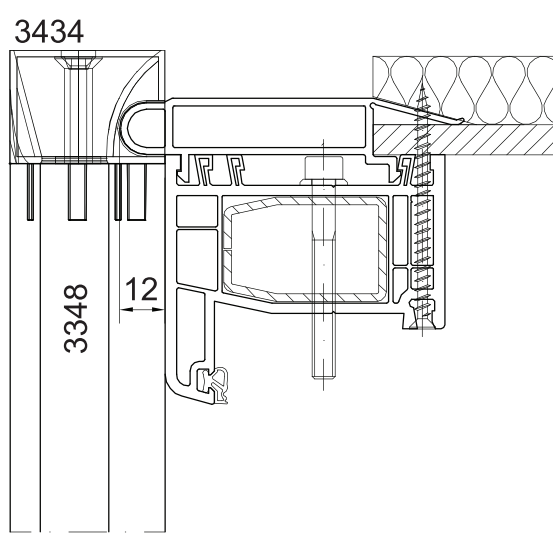

7340

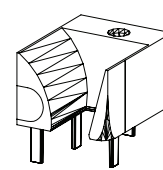

3434

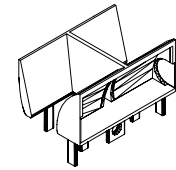

3429

**Roller shutter guide / Rollladenführung / Guida per avvolgibile / Șină rulou**

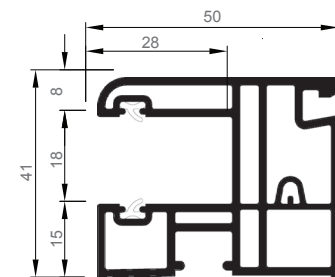
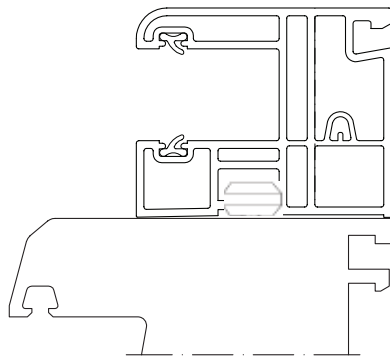

3348

**Roller shutter guide / Rollladenführung / Guida per avvolgibile / Șină rulou**

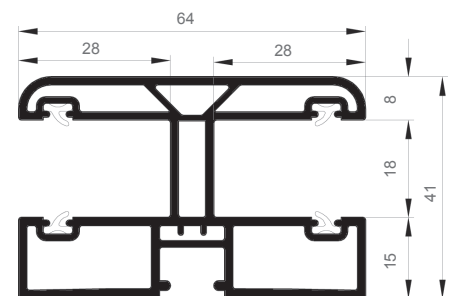
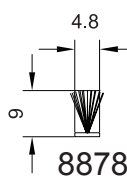
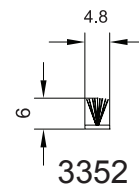
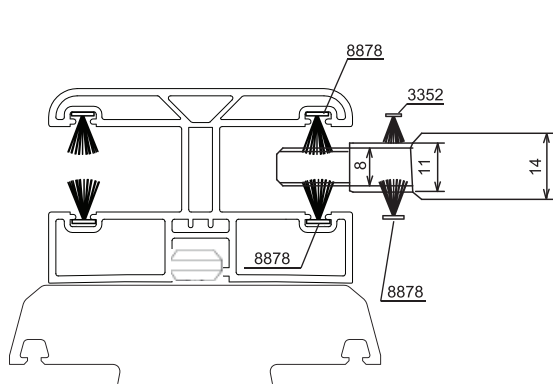

3347

**Window Sash Maximum Sizes / Fenster Flügelgrößen Diagramme /**  
*Campi d'applicazione Anta Finestra / Dimensiuni maxime cercevea fereastră*

Opening types

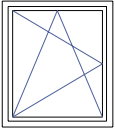

Profile: **WHITE** / WEISS / BIANCO / ALB

Glass:  $\leq 30 \text{ kg/m}^2$

Sash: Standard

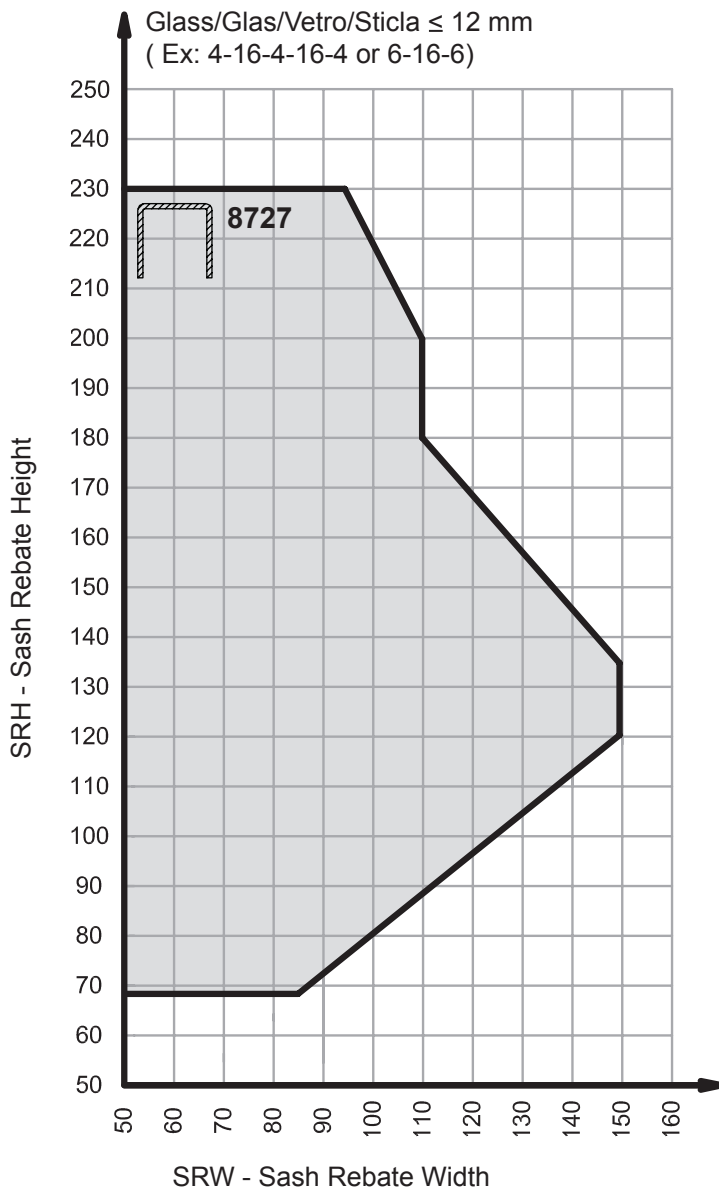

Steel

8727

28,5x28,5  $I_x=2,20 \text{ cm}^4$   
t=2mm

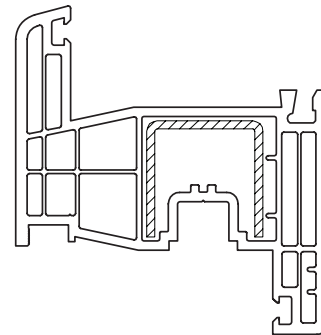
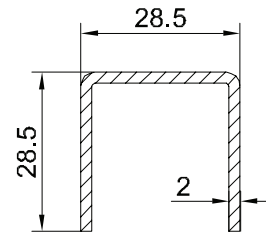

Sash 8095

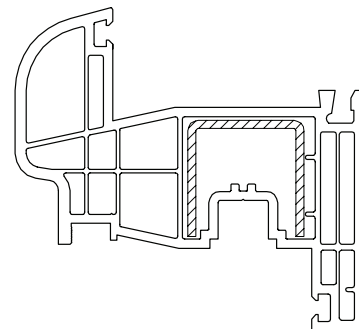

Sash 8096

**The sash width must not be greater than the sash height by more than 25%**

Die Flügelbreite darf die Flügelhöhe um nicht um mehr als 25% überschreiten.

*La larghezza dell'anta non deve superare l'altezza della medesima di oltre il 25%*

Lățimea cercevelei nu trebuie să depășească înălțimea acesteia cu mai mult de 25%

**Window Sash Maximum Sizes / Fenster Flügelgrößen Diagramme /**  
Campi d'applicazione Anta Finestra / Dimensiuni maxime cercevea fereastră

Opening types

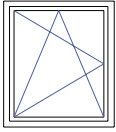

Profile: **WHITE / WEISS / BIANCO / ALB**

Glass:  $\leq 30 \text{ kg/m}^2$

Sash: STV

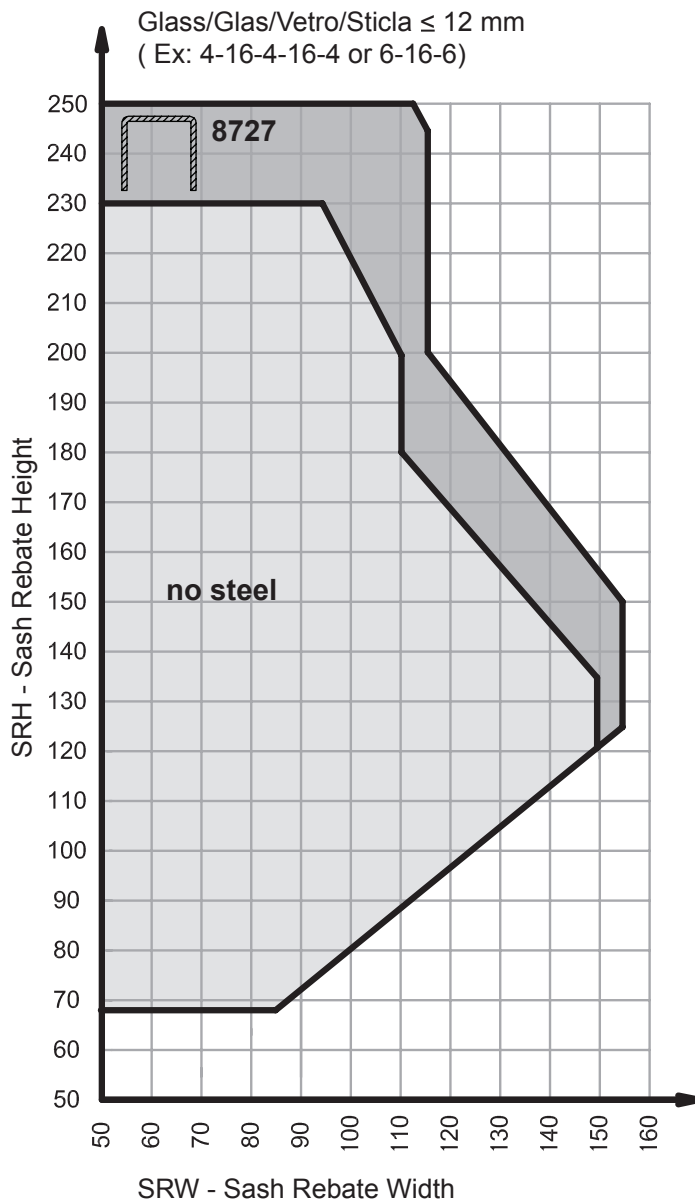

Steel

8727

28,5x28,5  $I_x=2,20 \text{ cm}^4$   
t=2mm

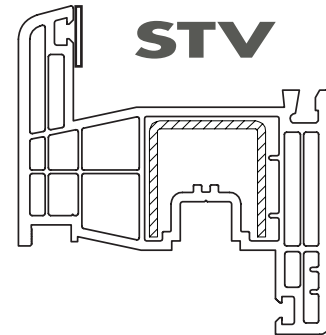
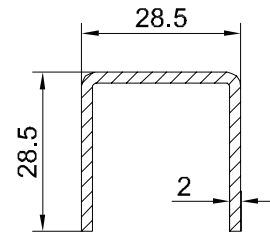

Sash 8095A

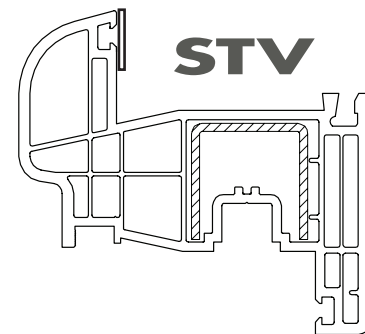

Sash 8096A

**The sash width must not be greater than the sash height by more than 25%**

Die Flügelbreite darf die Flügelhöhe um nicht um mehr als 25% überschreiten.

La larghezza dell'anta non deve superare l'altezza della medesima di oltre il 25%

Lățimea cercevelei nu trebuie să depășească înălțimea acesteia cu mai mult de 25%

**Window Sash Maximum Sizes / Fenster Flügelgrößen Diagramme /**  
Campi d'applicazione Anta Finestra / Dimensiuni maxime cercevea fereastră

Opening types

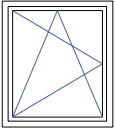

Profile: **COLOR / FARBE / PELLICOLATO / COLOR**

Glass:  $\leq 30 \text{ kg/m}^2$

Sash: Standard

Steel

8727

28,5x28,5  $I_x=2,20 \text{ cm}^4$   
t=2mm

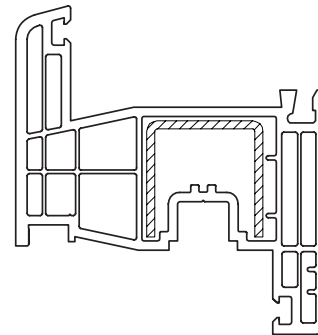
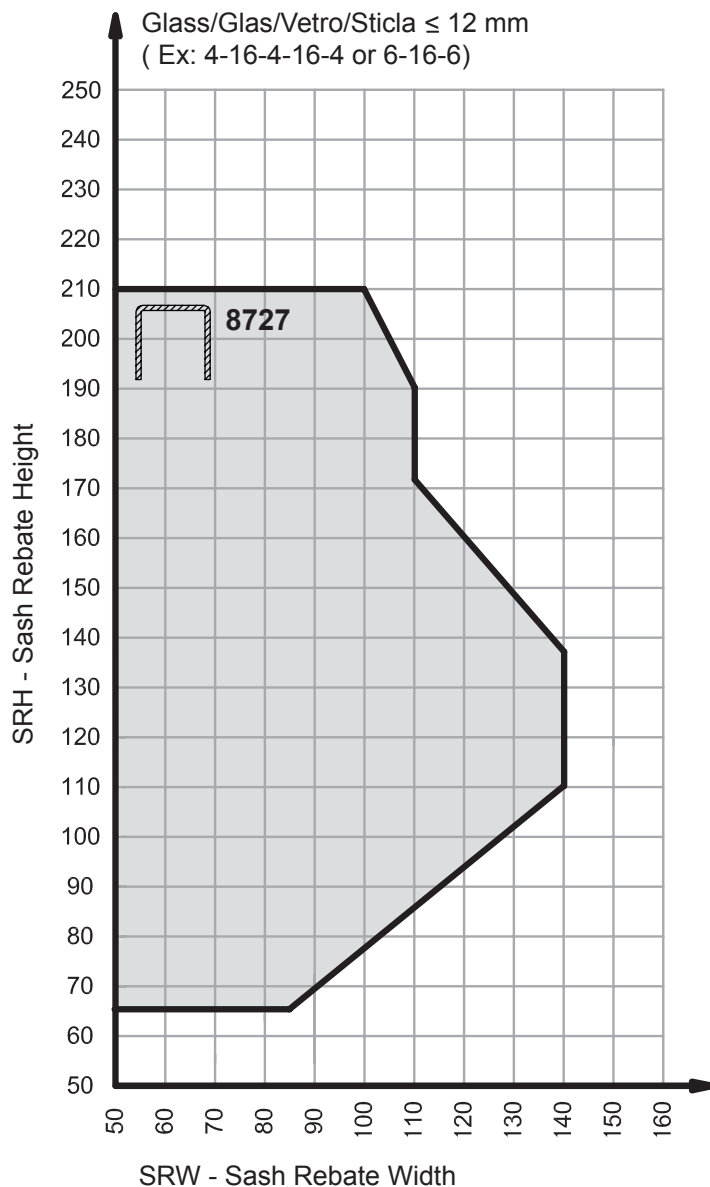
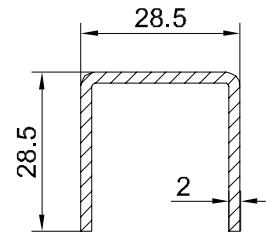

Sash 8095

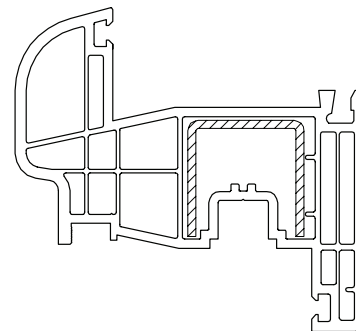

Sash 8096

**The sash width must not be greater than the sash height by more than 25%**

Die Flügelbreite darf die Flügelhöhe um nicht um mehr als 25% überschreiten.

La larghezza dell'anta non deve superare l'altezza della medesima di oltre il 25%

Lățimea cercevelei nu trebuie să depășească înălțimea acesteia cu mai mult de 25%

**Window Sash Maximum Sizes / Fenster Flügelgrößen Diagramme /**  
*Campi d'applicazione Anta Finestra / Dimensiuni maxime cercevea fereastră*

Opening types

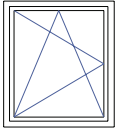

Profile: **COLOR / FARBE / PELLICOLATO / COLOR**

Glass:  $\leq 30 \text{ kg/m}^2$

Sash: STV

Steel

**8727**

28,5x28,5  $I_x=2,20 \text{ cm}^4$   
t=2mm

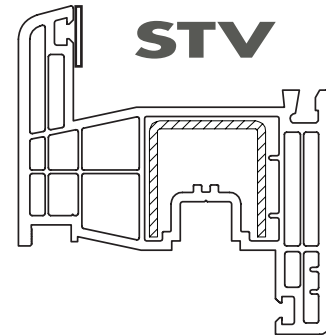
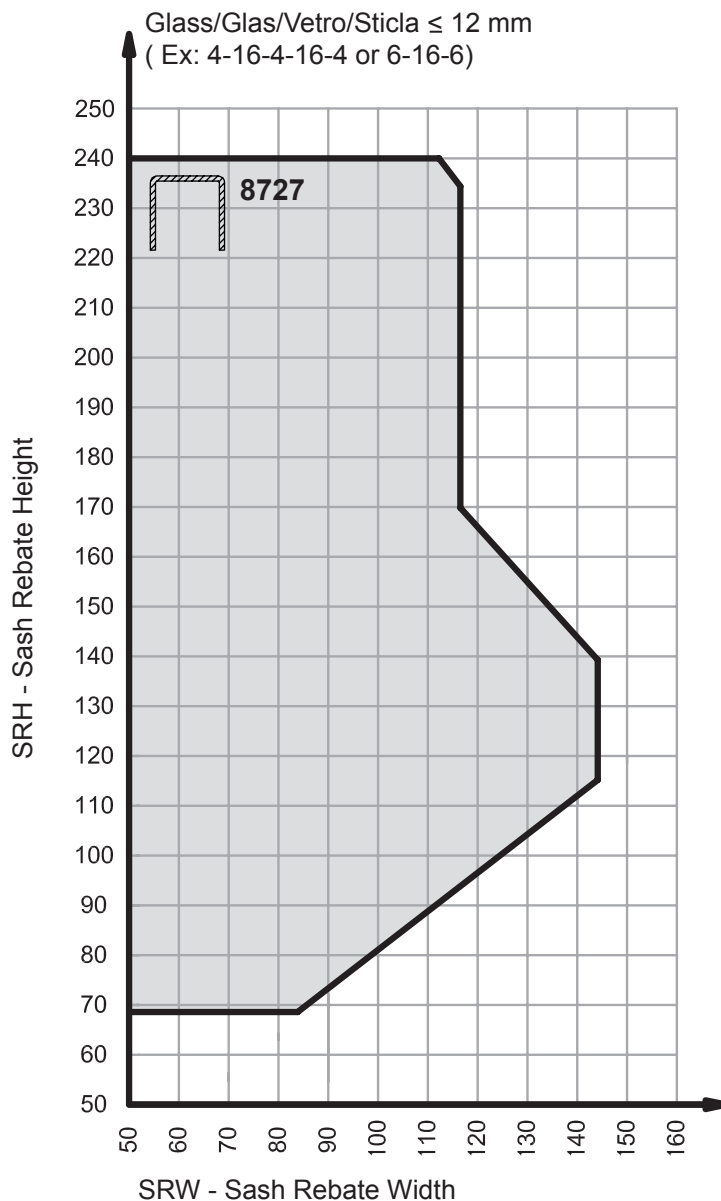
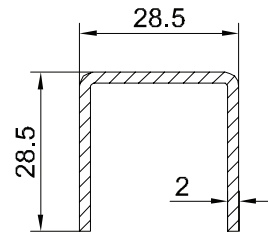

Sash 8095A

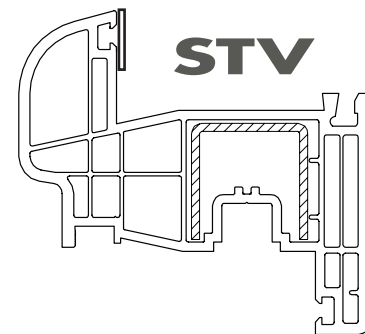

Sash 8096A

**The sash width must not be greater than the sash height by more than 25%**

Die Flügelbreite darf die Flügelhöhe um nicht um mehr als 25% überschreiten.

*La larghezza dell'anta non deve superare l'altezza della medesima di oltre il 25%*

Lățimea cercevelei nu trebuie să depășească înălțimea acesteia cu mai mult de 25%

**Window Sash Maximum Sizes / Fenster Flügelgrößen Diagramme /**  
*Campi d'applicazione Anta Finestra / Dimensiuni maxime cercevea fereastră*

Opening types

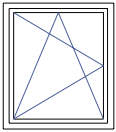

Profile: **WHITE and COLOR** / WEISS und FARBE /  
*BIANCO e PELLICOLATO* / ALB și COLOR  
Glass:  $\leq 50 \text{ kg/m}^2$   
Sash: Standard

Steel

8727  
28,5x28,5  $I_x=2,20 \text{ cm}^4$   
t=2mm

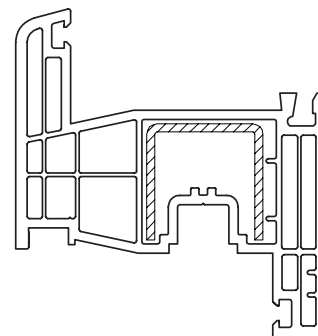
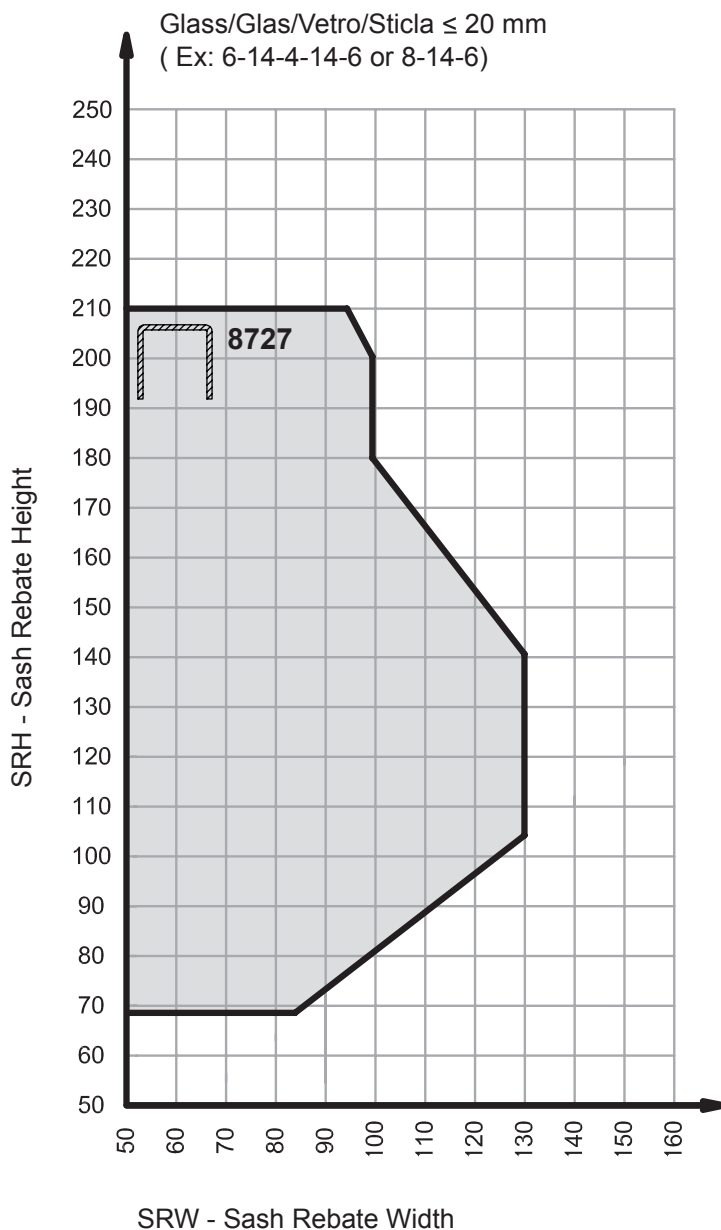
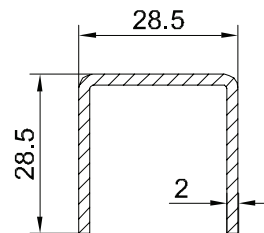

Sash 8095

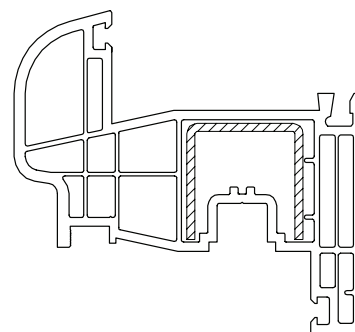

Sash 8096

**The sash width must not be greater than the sash height by more than 25%**

Die Flügelbreite darf die Flügelhöhe um nicht um mehr als 25% überschreiten.

*La larghezza dell'anta non deve superare l'altezza della medesima di oltre il 25%*

Lățimea cercevelei nu trebuie să depășească înălțimea acesteia cu mai mult de 25%

**Window Sash Maximum Sizes / Fenster Flügelgrößen Diagramme /**  
*Campi d'applicazione Anta Finestra / Dimensiuni maxime cercevea fereastră*

Opening types

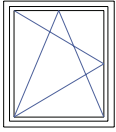

Profile: **WHITE** and **COLOR** / WEISS und FARBE /  
*BIANCO e PELLICOLATO / ALB si COLOR*  
Glass:  $\leq 50 \text{ kg/m}^2$   
Sash: STV

Steel

**8727**  
28,5x28,5  $I_x=2,20 \text{ cm}^4$   
t=2mm

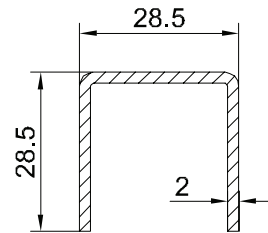

Glass/Glas/Vetro/Sticla  $\leq 20 \text{ mm}$   
( Ex: 6-14-4-14-6 or 8-14-6)

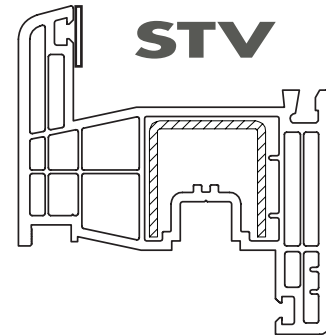
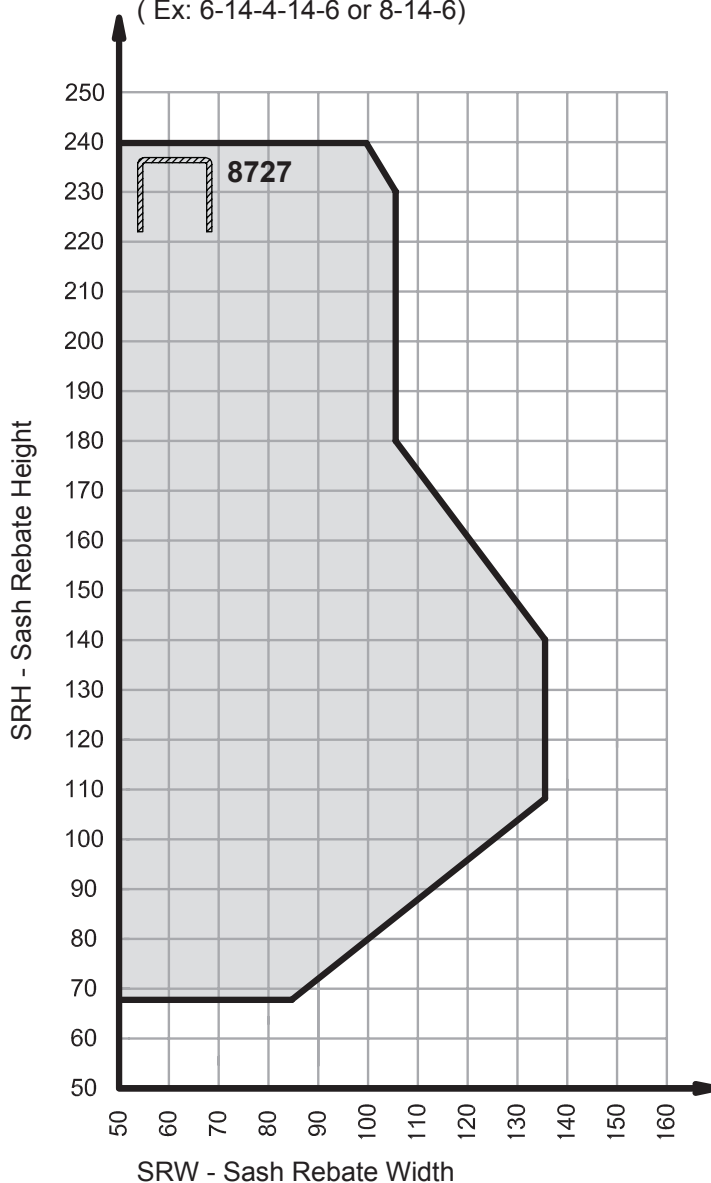

Sash 8095A

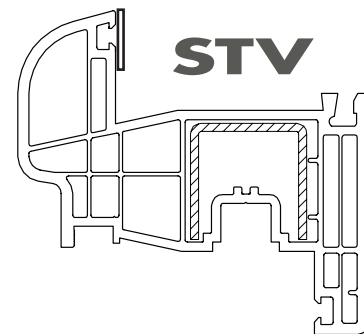

Sash 8096A

**The sash width must not be greater than the sash height by more than 25%**

Die Flügelbreite darf die Flügelhöhe um nicht um mehr als 25% überschreiten.

*La larghezza dell'anta non deve superare l'altezza della medesima di oltre il 25%*

Lățimea cercevelei nu trebuie să depășească înălțimea acesteia cu mai mult de 25%

**Window Sash Maximum Sizes / Fenster Flügelgrößen Diagramme /**  
*Campi d'applicazione Anta Finestra / Dimensiuni maxime cercevea fereastră*

Opening types

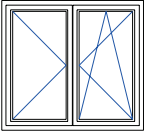

Profile: **WHITE** / WEISS / BIANCO / ALB

Glass:  $\leq 30 \text{ kg/m}^2$

Sash: Standard

Steel

8727

28,5x28,5  $I_x=2,20 \text{ cm}^4$   
t=2mm

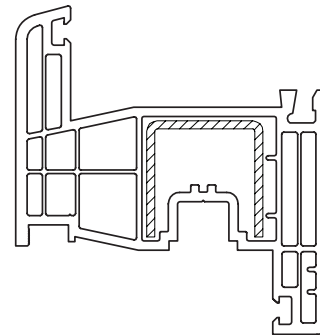
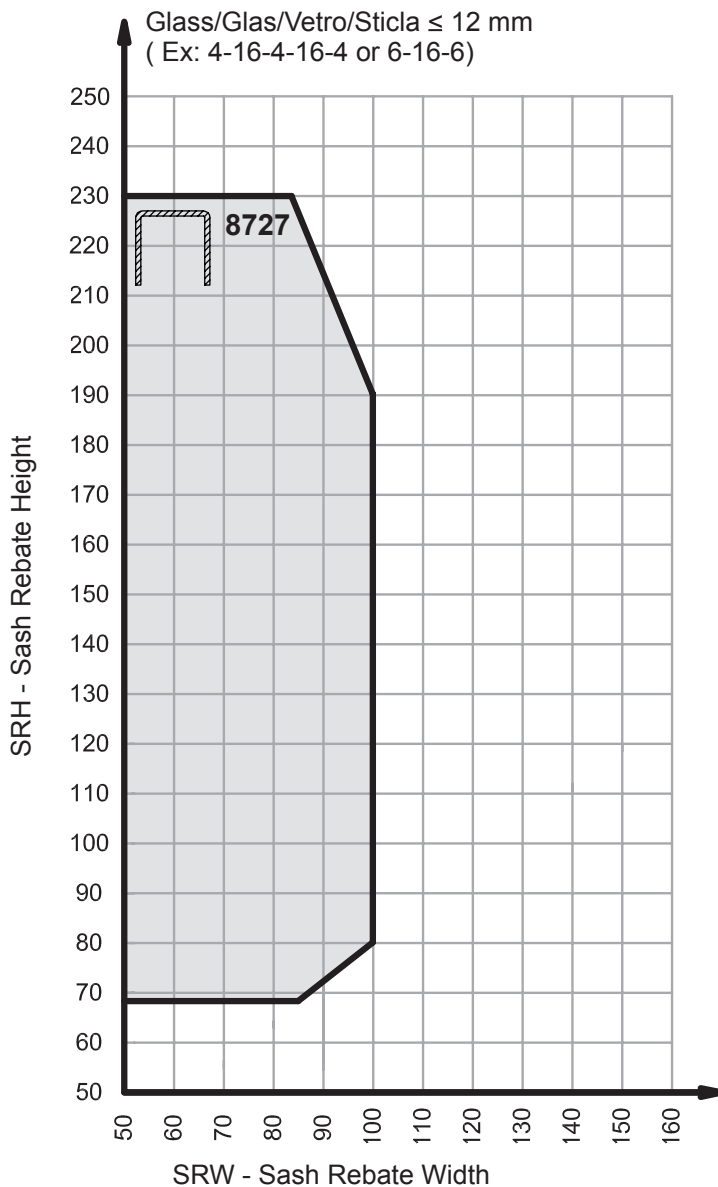
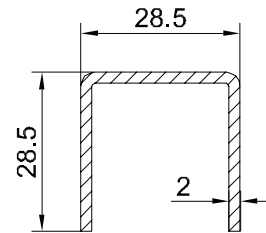

Sash 8095

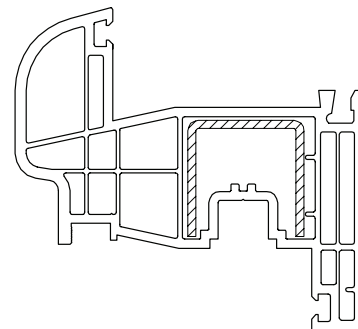

Sash 8096

**The sash width must not be greater than the sash height by more than 25%**

Die Flügelbreite darf die Flügelhöhe um nicht um mehr als 25% überschreiten.

*La larghezza dell'anta non deve superare l'altezza della medesima di oltre il 25%*

Lățimea cercevelei nu trebuie să depășească înălțimea acesteia cu mai mult de 25%



**Window Sash Maximum Sizes / Fenster Flügelgrößen Diagramme /**  
*Campi d'applicazione Anta Finestra / Dimensiuni maxime cercevea fereastră*

Opening types

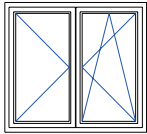

Profile: **WHITE / WEISS / BIANCO / ALB**

Glass:  $\leq 30 \text{ kg/m}^2$

Sash: STV

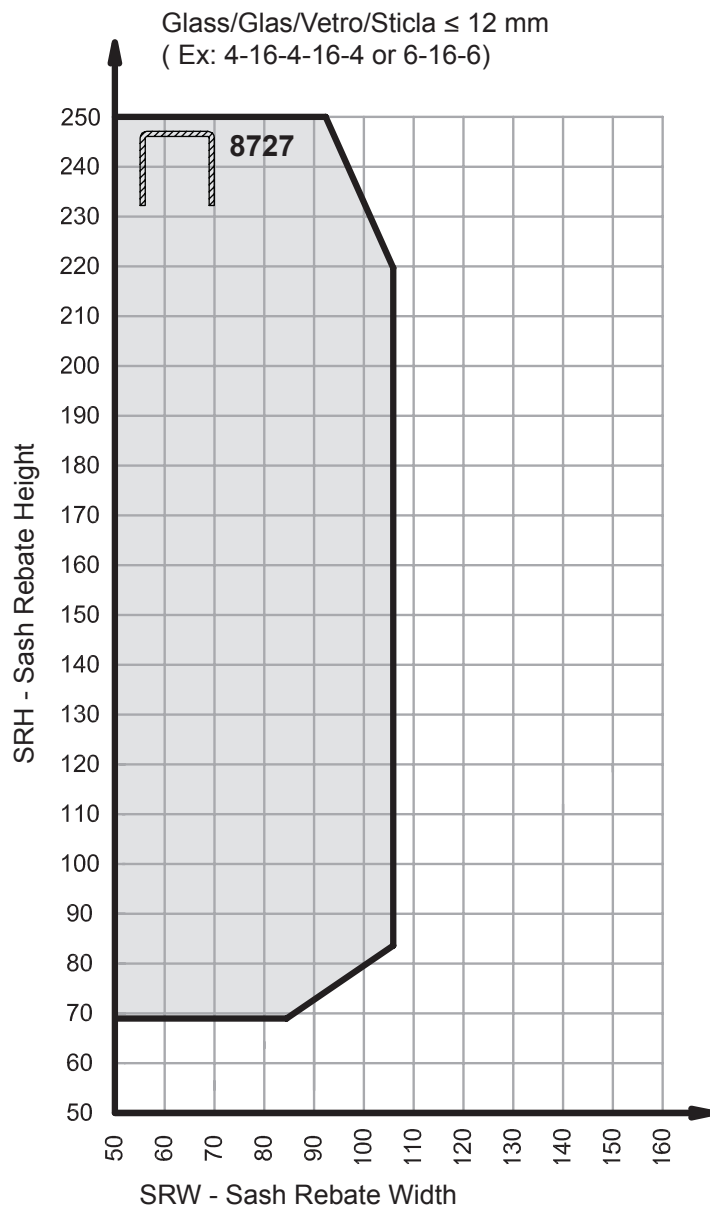

Steel

8727

28,5x28,5  $I_x=2,20 \text{ cm}^4$   
t=2mm

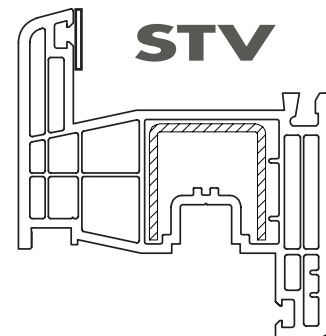
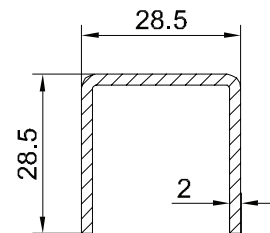

Sash 8095A

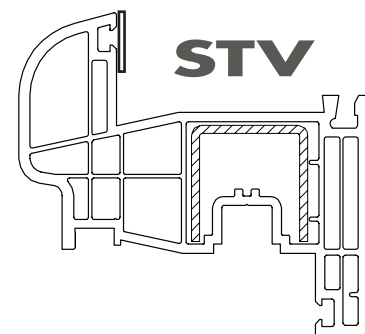

Sash 8096A

**The sash width must not be greater than the sash height by more than 25%**

Die Flügelbreite darf die Flügelhöhe um nicht um mehr als 25% überschreiten.

La larghezza dell'anta non deve superare l'altezza della medesima di oltre il 25%

Lățimea cercevelei nu trebuie să depășească înălțimea acesteia cu mai mult de 25%

**Window Sash Maximum Sizes / Fenster Flügelgrößen Diagramme /**  
*Campi d'applicazione Anta Finestra / Dimensiuni maxime cercevea fereastră*

Opening types

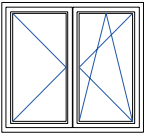

Profile: **COLOR / FARBE / PELLICOLATO / COLOR**

Glass:  $\leq 30 \text{ kg/m}^2$

Sash: Standard

Steel

8727

28,5x28,5  $I_x=2,20 \text{ cm}^4$   
t=2mm

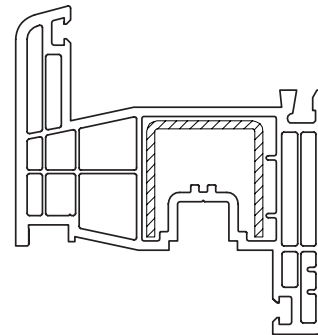
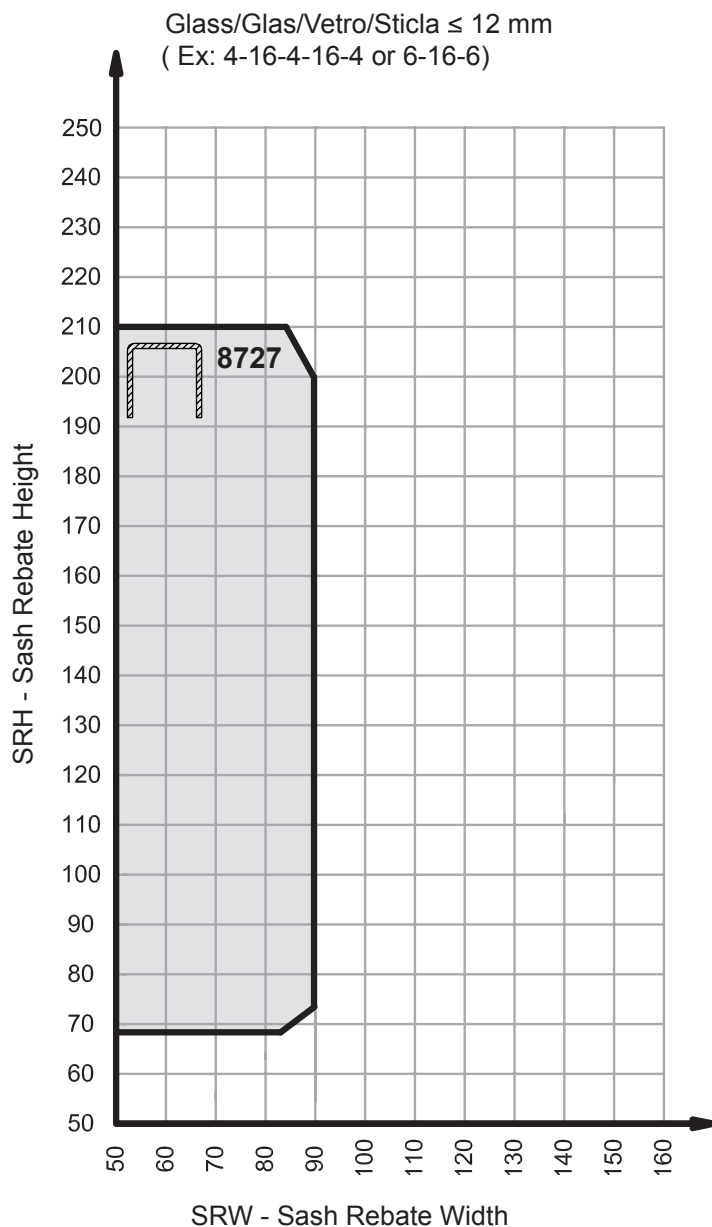
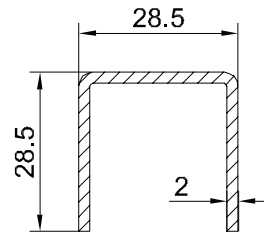

Sash 8095

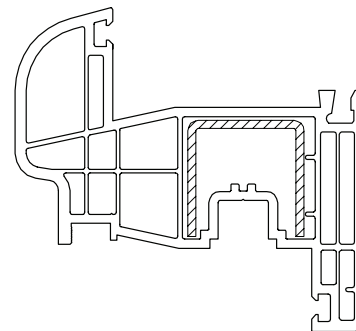

Sash 8096

**The sash width must not be greater than the sash height by more than 25%**

Die Flügelbreite darf die Flügelhöhe um nicht um mehr als 25% überschreiten.

La larghezza dell'anta non deve superare l'altezza della medesima di oltre il 25%

Lățimea cercevelei nu trebuie să depășească înălțimea acesteia cu mai mult de 25%

**Window Sash Maximum Sizes / Fenster Flügelgrößen Diagramme /**  
*Campi d'applicazione Anta Finestra / Dimensiuni maxime cercevea fereastră*

Opening types

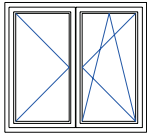

Profile: **COLOR / FARBE / PELLICOLATO / COLOR**

Glass: ≤ 30 kg/m<sup>2</sup>

Sash: STV

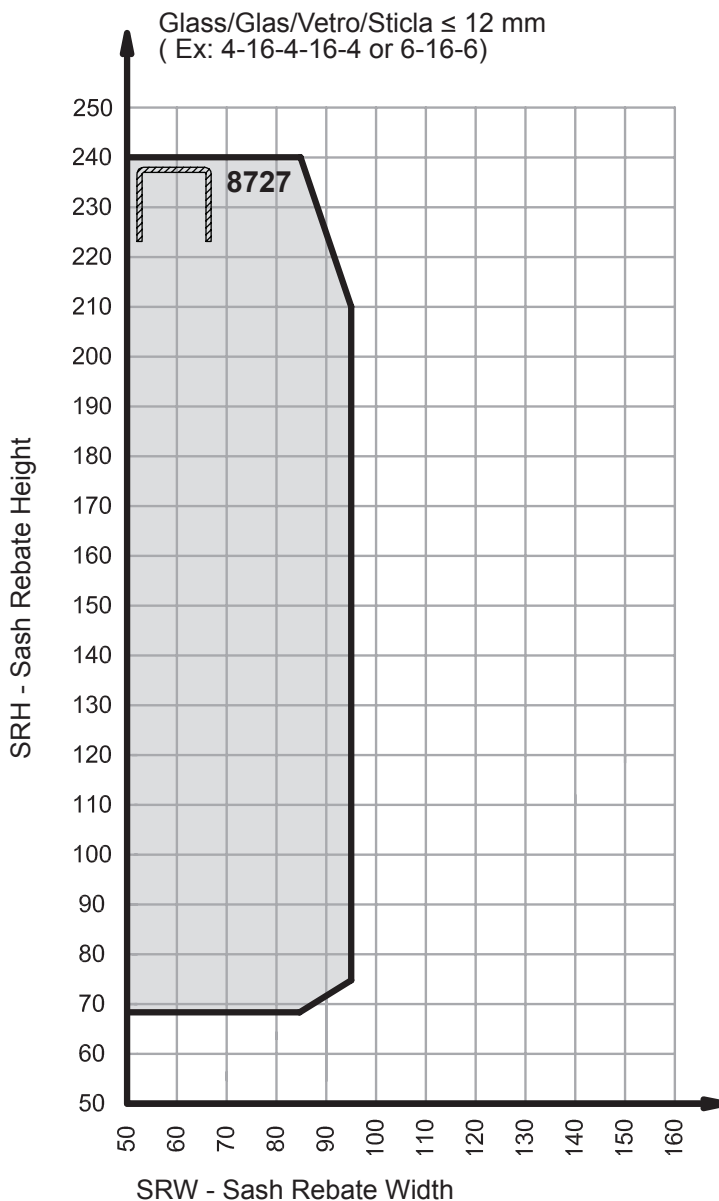

Steel

8727

28,5x28,5 I<sub>x</sub>=2,20 cm<sup>4</sup>  
t=2mm

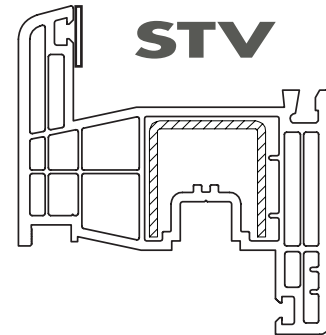
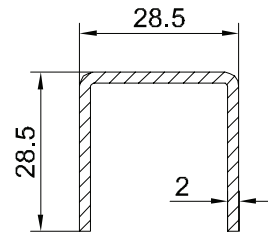

Sash 8095A

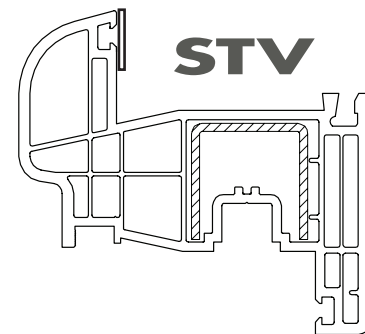

Sash 8096A

**The sash width must not be greater than the sash height by more than 25%**

Die Flügelbreite darf die Flügelhöhe um nicht um mehr als 25% überschreiten.

*La larghezza dell'anta non deve superare l'altezza della medesima di oltre il 25%*

Lățimea cercevelei nu trebuie să depășească înălțimea acesteia cu mai mult de 25%

**Window Sash Maximum Sizes / Fenster Flügelgrößen Diagramme /**  
*Campi d'applicazione Anta Finestra / Dimensiuni maxime cercevea fereastră*

Opening types

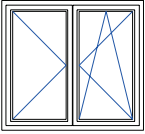

Profile: **WHITE and COLOR** / WEISS und FARBE /  
*BIANCO e PELLICOLATO / ALB si COLOR*  
Glass:  $\leq 50 \text{ kg/m}^2$   
Sash: Standard

Steel

8727  
28,5x28,5  $I_x=2,20 \text{ cm}^4$   
t=2mm

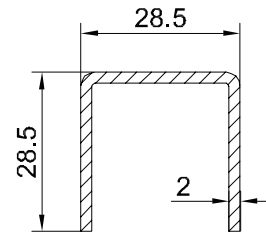

Glass/Glas/Vetro/Sticla  $\leq 20 \text{ mm}$   
( Ex: 6-14-4-14-6 or 8-14-6)

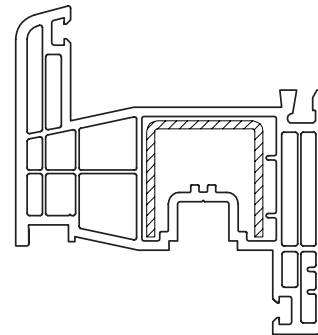
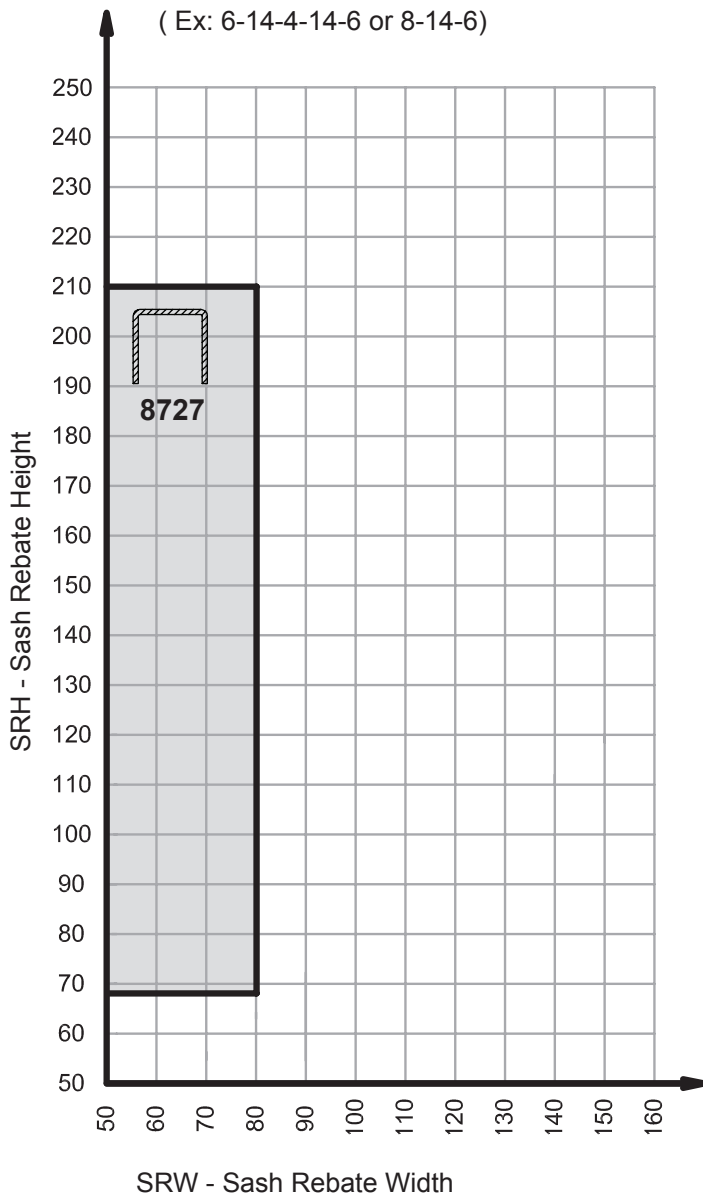

Sash 8095

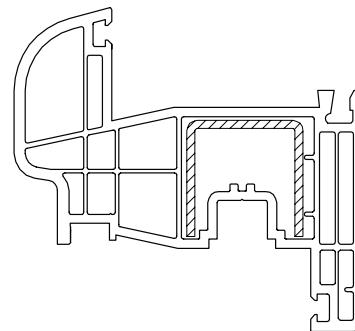

Sash 8096

**The sash width must not be greater than the sash height by more than 25%**

Die Flügelbreite darf die Flügelhöhe um nicht um mehr als 25% überschreiten.

*La larghezza dell'anta non deve superare l'altezza della medesima di oltre il 25%*

Lățimea cercevelei nu trebuie să depășească înălțimea acesteia cu mai mult de 25%

**Window Sash Maximum Sizes / Fenster Flügelgrößen Diagramme /**  
*Campi d'applicazione Anta Finestra / Dimensiuni maxime cercevea fereastră*

Opening types

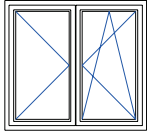

Profile: **WHITE** and **COLOR** / WEISS und FARBE /  
*BIANCO e PELLICOLATO / ALB si COLOR*  
Glass:  $\leq 50 \text{ kg/m}^2$   
Sash: STV

Steel

**8727**  
28,5x28,5  $I_x=2,20 \text{ cm}^4$   
t=2mm

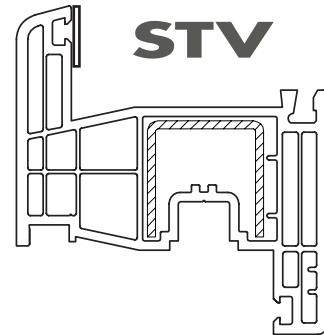
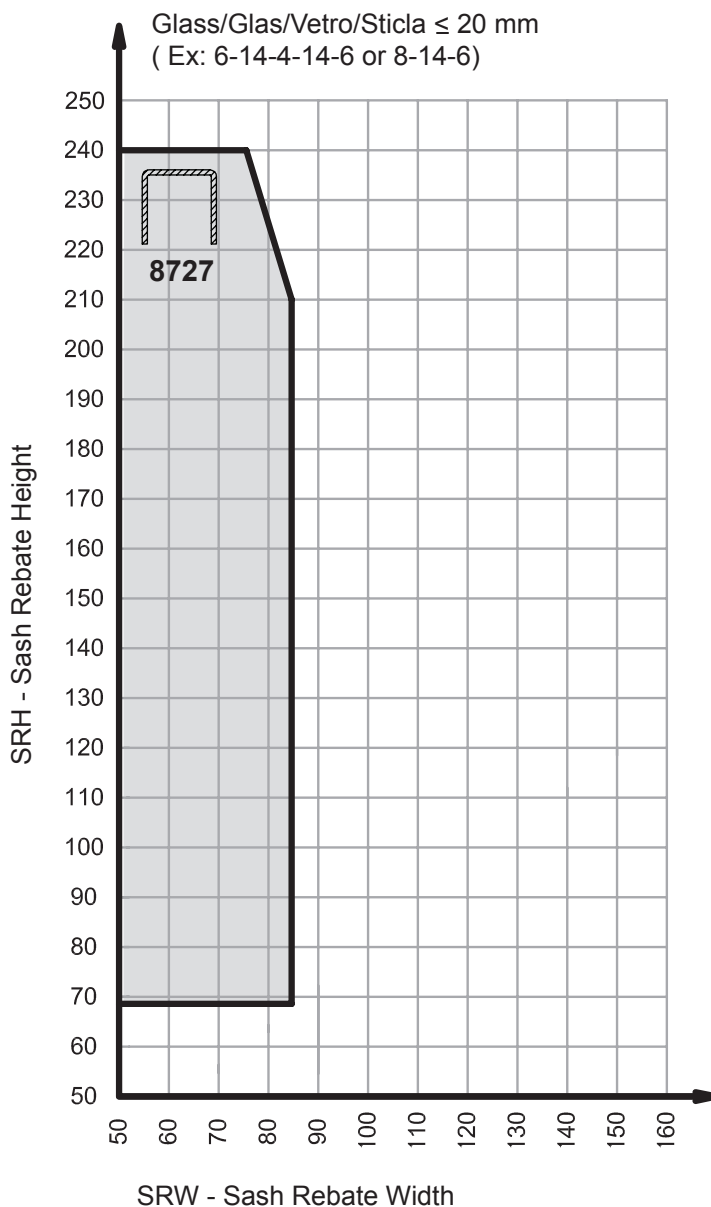
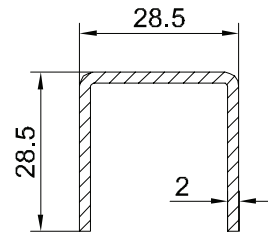

Sash 8095A

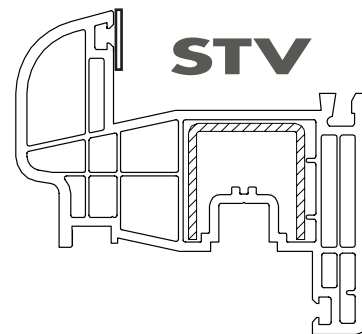

Sash 8096A

**The sash width must not be greater than the sash height by more than 25%**

Die Flügelbreite darf die Flügelhöhe um nicht um mehr als 25% überschreiten.

*La larghezza dell'anta non deve superare l'altezza della medesima di oltre il 25%*

Lățimea cercevelei nu trebuie să depășească înălțimea acesteia cu mai mult de 25%

**Door Sash Maximum Sizes** / Türen Flügelgrößen Diagramme / *Campi d'applicazione*  
*Anta Porta* / Dimensiuni maxime cercevea ușă

Opening types

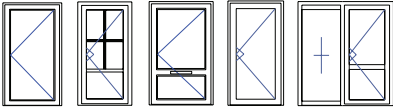

Profile: **WHITE** and **COLOR** / WEISS und FARBE /  
*BIANCO e PELLICOLATO* / ALB și COLOR  
Glass:  $\leq 50 \text{ kg/m}^2$   
Sash: Standard

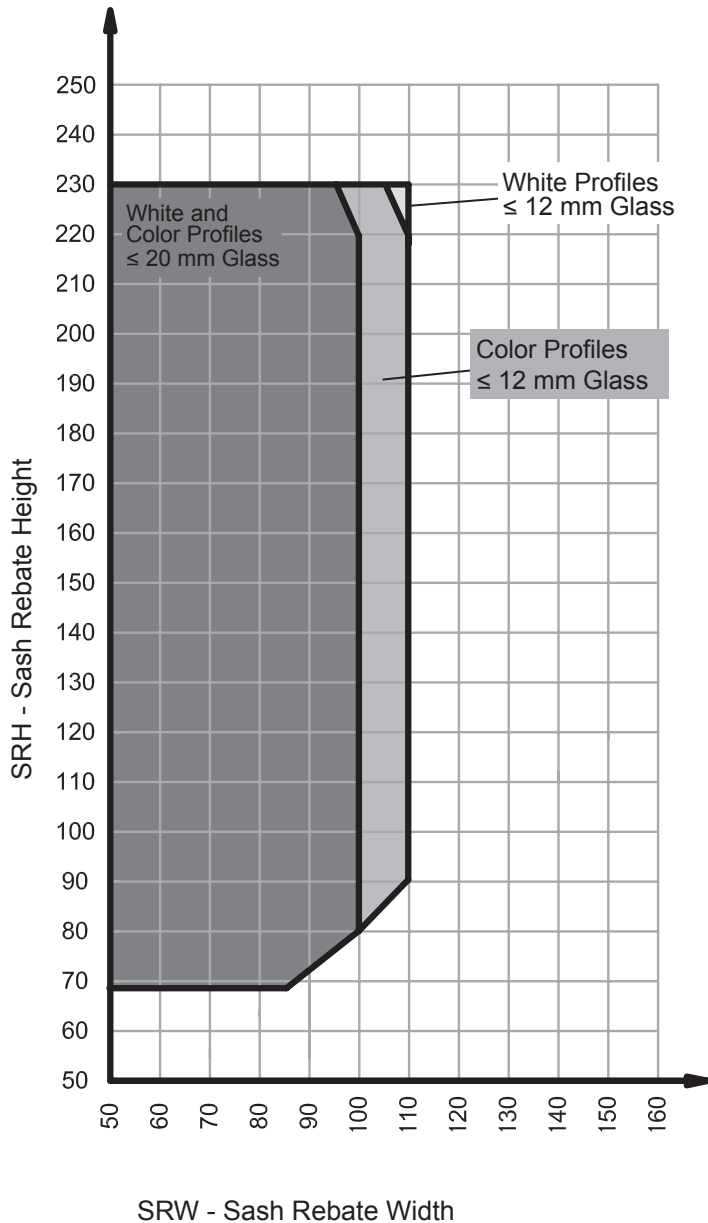

Steel

8706  
46X48.5  $I_x=10,60 \text{ cm}^4$   
t=2 mm

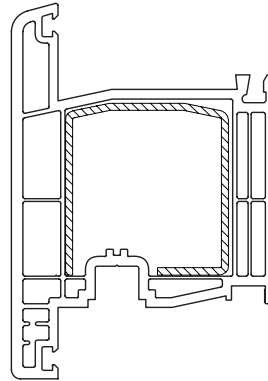
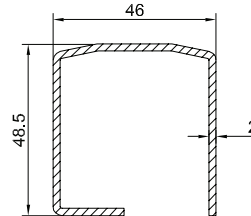

Sash 8078

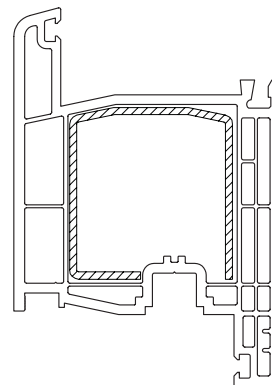

Sash 8081

**The sash width must not be greater than the sash height by more than 25%**

Die Flügelbreite darf die Flügelhöhe um nicht um mehr als 25% überschreiten.

*La larghezza dell'anta non deve superare l'altezza della medesima di oltre il 25%*

Lățimea cercevelei nu trebuie să depășească înălțimea acesteia cu mai mult de 25%

**Door Sash Maximum Sizes / Türen Flügelgrößen Diagramme / Campi d'applicazione**  
*Anta Porta / Dimensiuni maxime cercevea ușă*

Opening types

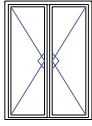

Profile: **WHITE** and **COLOR** / WEISS und FARBE /  
*BIANCO e PELLICOLATO / ALB și COLOR*  
Glass:  $\leq 50 \text{ kg/m}^2$   
Sash: Standard

Steel

8706  
46X48.5  $I_x=10,60 \text{ cm}^4$   
t=2 mm

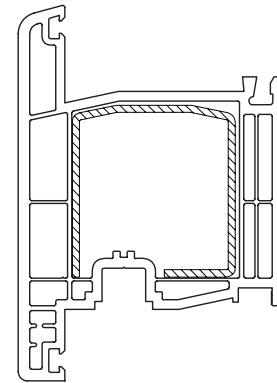
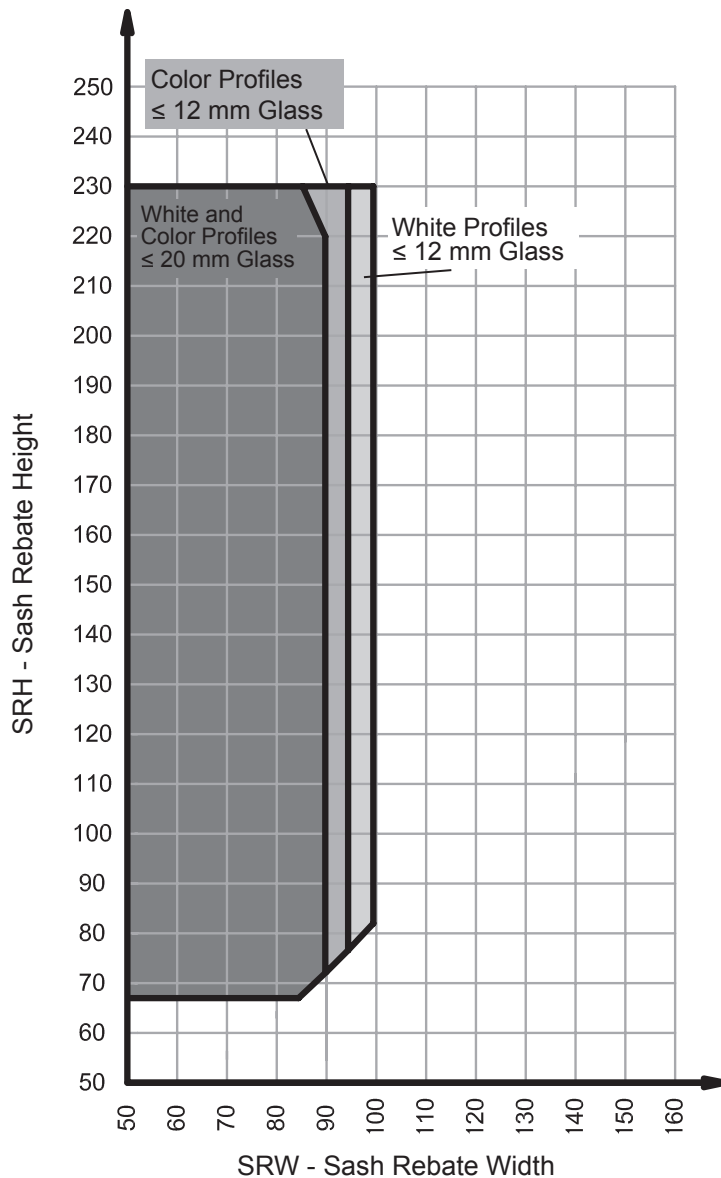
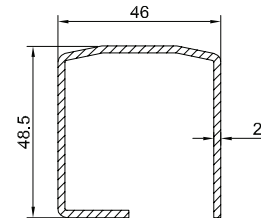

Sash 8078

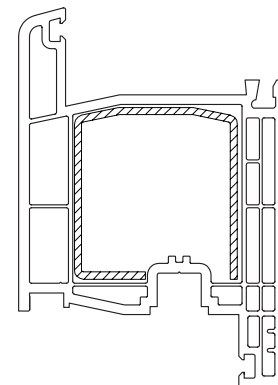

Sash 8081

**The sash width must not be greater than the sash height by more than 25%**

Die Flügelbreite darf die Flügelhöhe um nicht um mehr als 25% überschreiten.

*La larghezza dell'anta non deve superare l'altezza della medesima di oltre il 25%*

Lățimea cercevelei nu trebuie să depășească înălțimea acesteia cu mai mult de 25%

**Window Sash Maximum Sizes / Fenster Flügelgrößen Diagramme /**  
Campi d'applicazione Anta Finestra / Dimensiuni maxime cercevea fereastră

Opening types

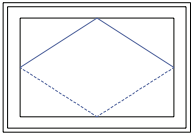

Profile: **WHITE** and **COLOR** / WEISS und FARBE /  
BIANCO e PELLICOLATO / ALB si COLOR  
Glass:  $\leq 50 \text{ kg/m}^2$   
Sash: Standard

Steel

8706  
46X48.5  $I_x=10,60 \text{ cm}^4$   
t=2 mm

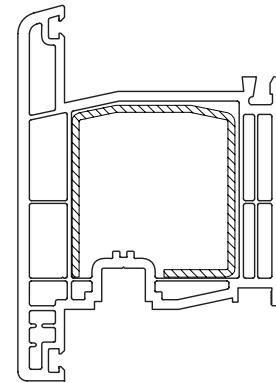
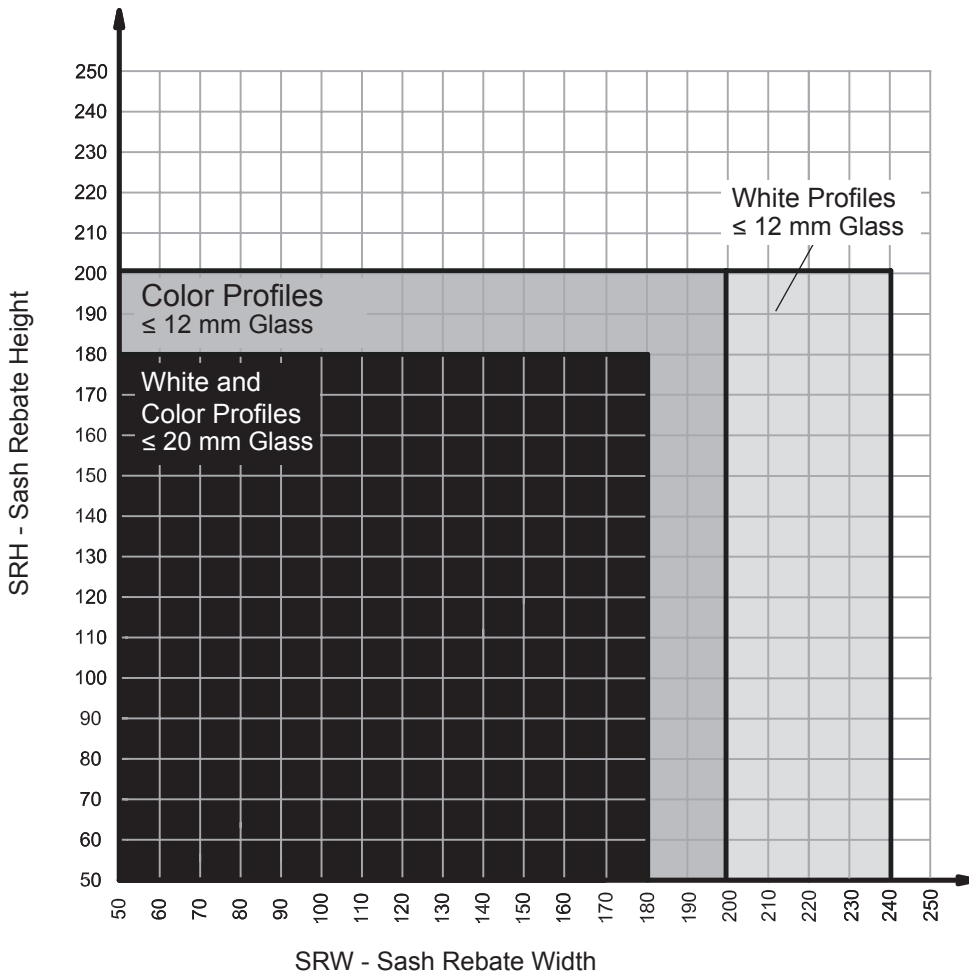
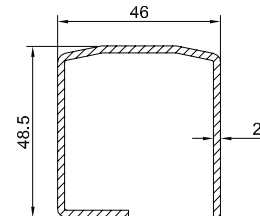

Sash 8078

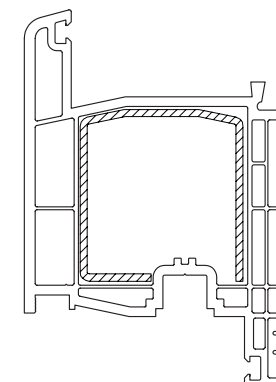

Sash 8081

**The sash width must not be greater than the sash height by more than 25%**

Die Flügelbreite darf die Flügelhöhe um nicht um mehr als 25% überschreiten.

La larghezza dell'anta non deve superare l'altezza della medesima di oltre il 25%

Lățimea cercevelei nu trebuie să depășească înălțimea acesteia cu mai mult de 25%



**Window Frame Maximum Sizes / Fenster Blendrahmengrößen Diagramme /**  
*Campi d'applicazione Telaio Finestra / Dimensiuni maxime toc fereastră*

Opening types

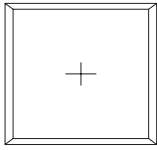



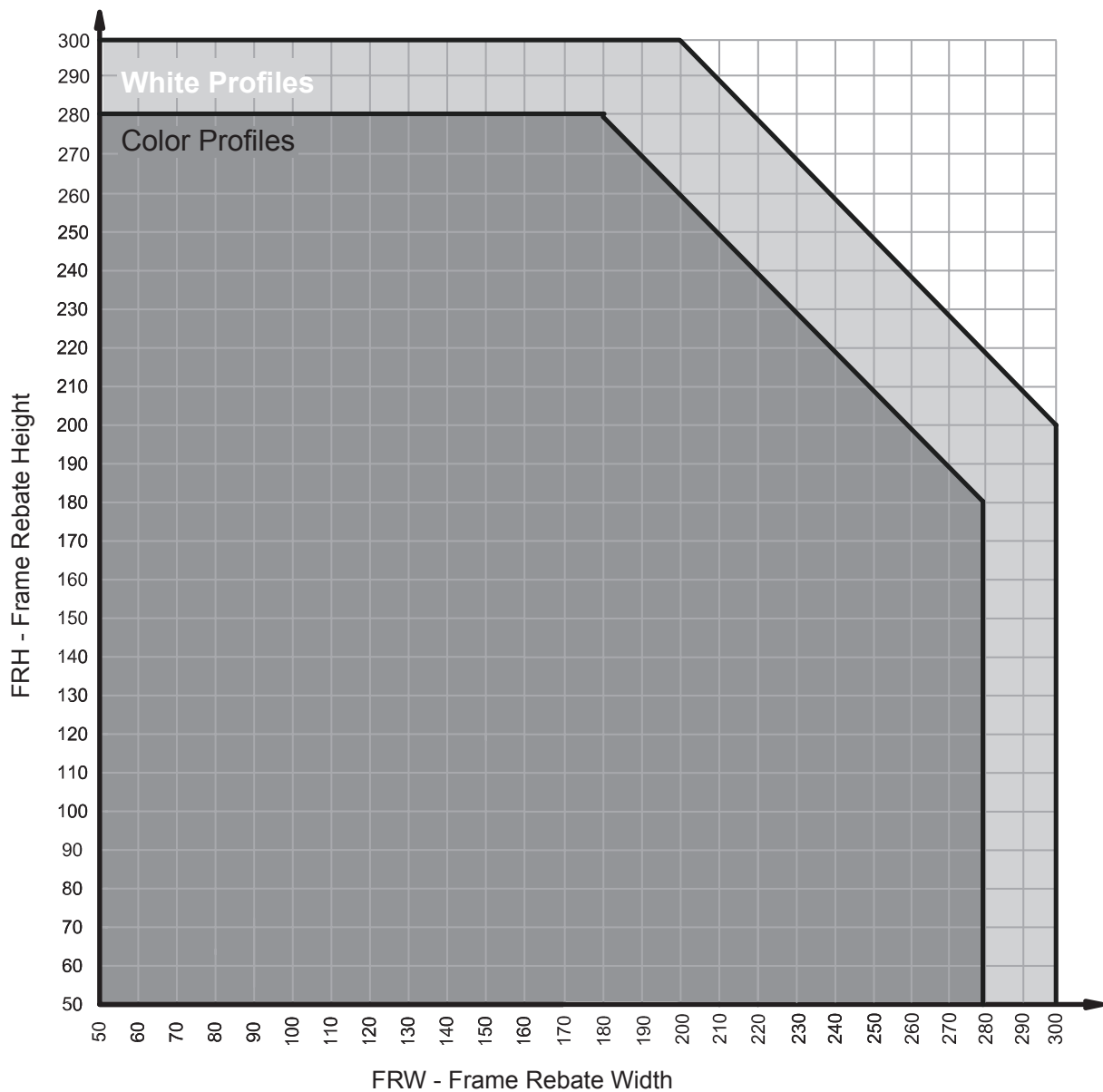



Profile: **WHITE** and **COLOR** / WEISS und FARBE /  
BIANCO e PELLICOLATO / ALB și COLOR

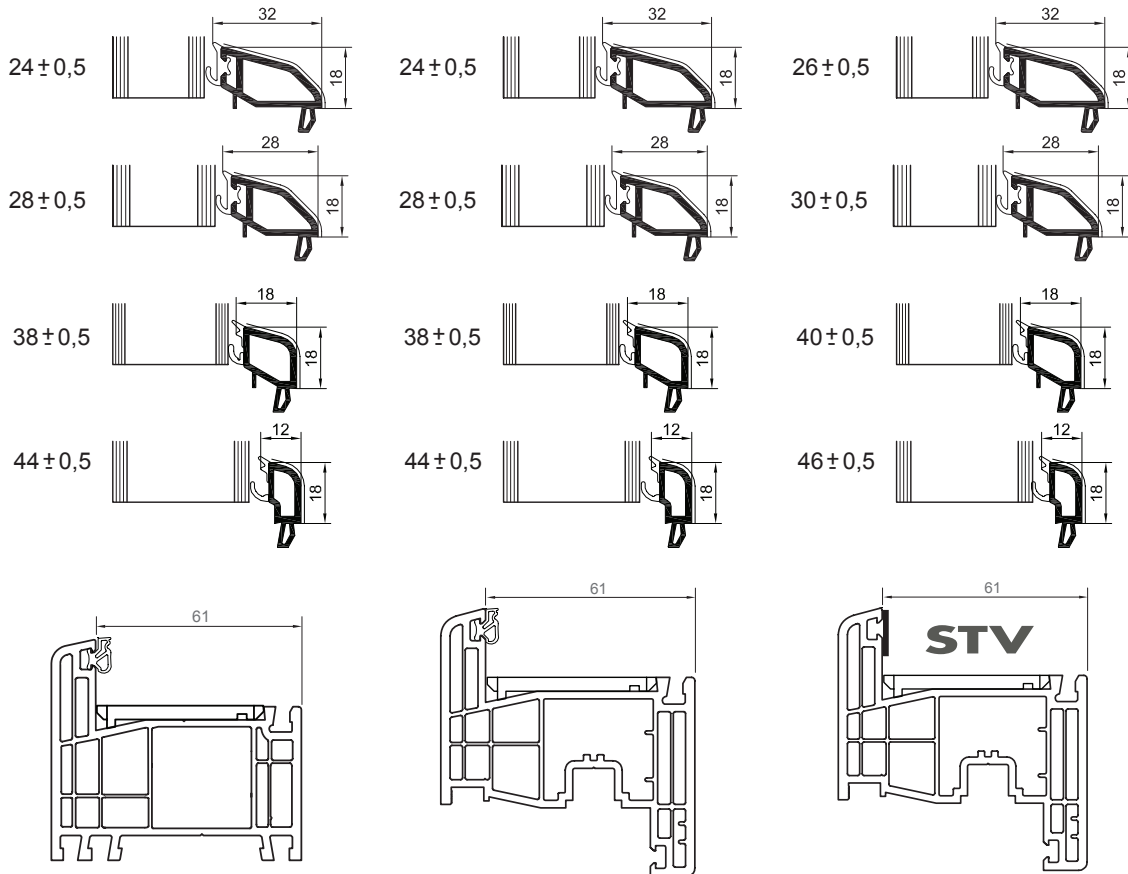

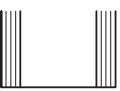
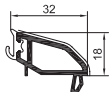
PERFORMER 74  
RONDO  
STYLE 76  
PASIV 82  
KUBUS  
PREMIDOOR 76  
PREMIDOOR 88  
PREMILINE  
BESCHLÄG  
HARDWARE  
GLASS  
ROLLO TOP  
ROLLO FRONT  
BORA  
HERCULES 70

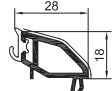
**Glazing Beads / Glasleiste / Fermavetri / Baghete de fixare geam**

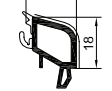

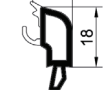
Profile	Glass / Glas / Vetro / Sticlă	Glazing bead / Glasleiste Fermavetro / Baghetă	Gasket / Dichtung Guarnizione / Garnitură
Frame 8001, 8010, 8015, 8030, 8027 Sash 8095, 8081, 8078, 8096, 8076, 8042 Mullion 8080, 8040	 24 mm	7124 	black or gray
Frame 8001, 8010, 8015, 8030, 8027 Sash 8095, 8081, 8078, 8096, 8076, 8042 Mullion 8080	 28 mm	7128 	black or gray
Frame 8001, 8010, 8015, 8030, 8027 Sash 8095, 8081, 8078, 8096, 8076, 8042 Mullion 8080	 38 mm	7138 	black or gray
Frame 8001, 8010, 8015, 8030, 8027 Sash 8095, 8081, 8078, 8096, 8076, 8042 Mullion 8080	 44 mm	7144 	black or gray

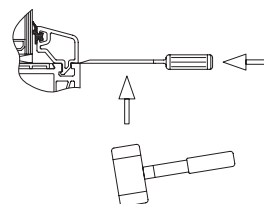
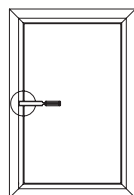
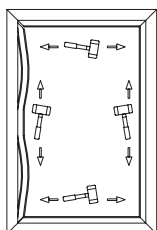

**Drainage / Entwässerung / Drenaggio / Drenajul**

**Front drainage / Entwässerung nach vorne / Drenaggio frontale / Drenaj frontal**

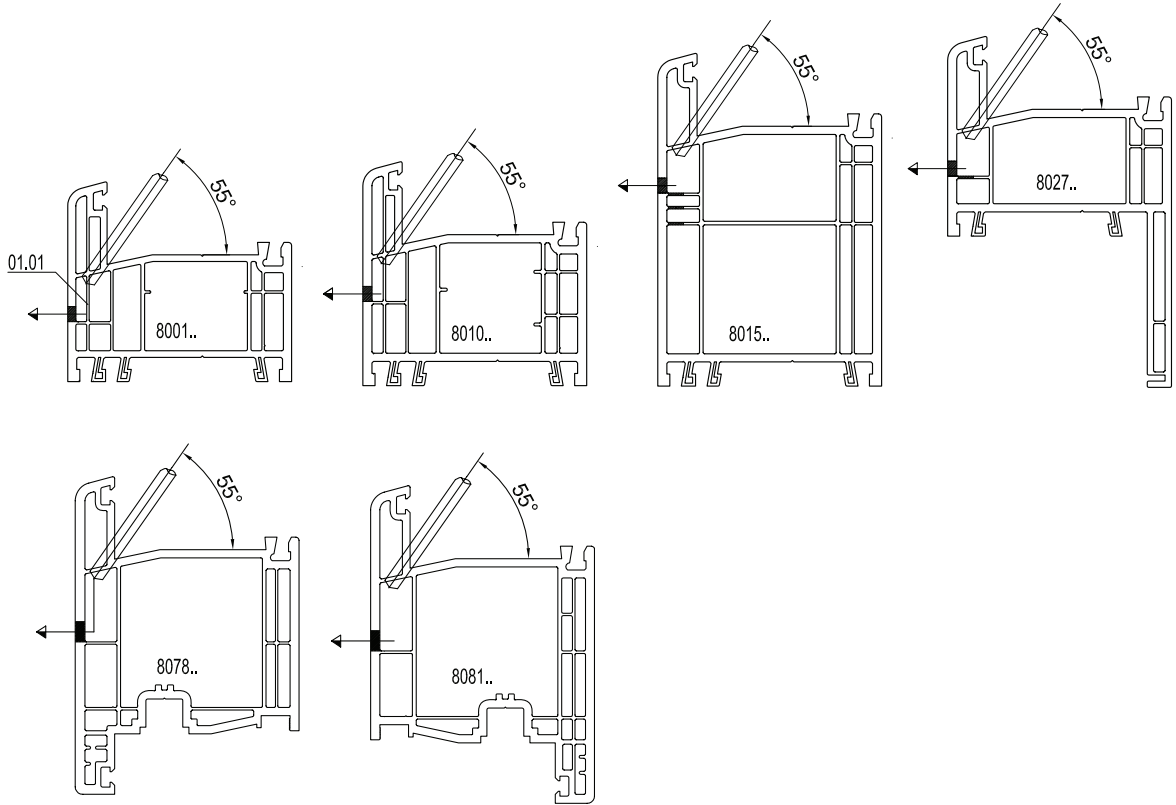

**Hidden drainage / Entwässerung nach unten / Drenaggio nascosto / Drenaj inferior**

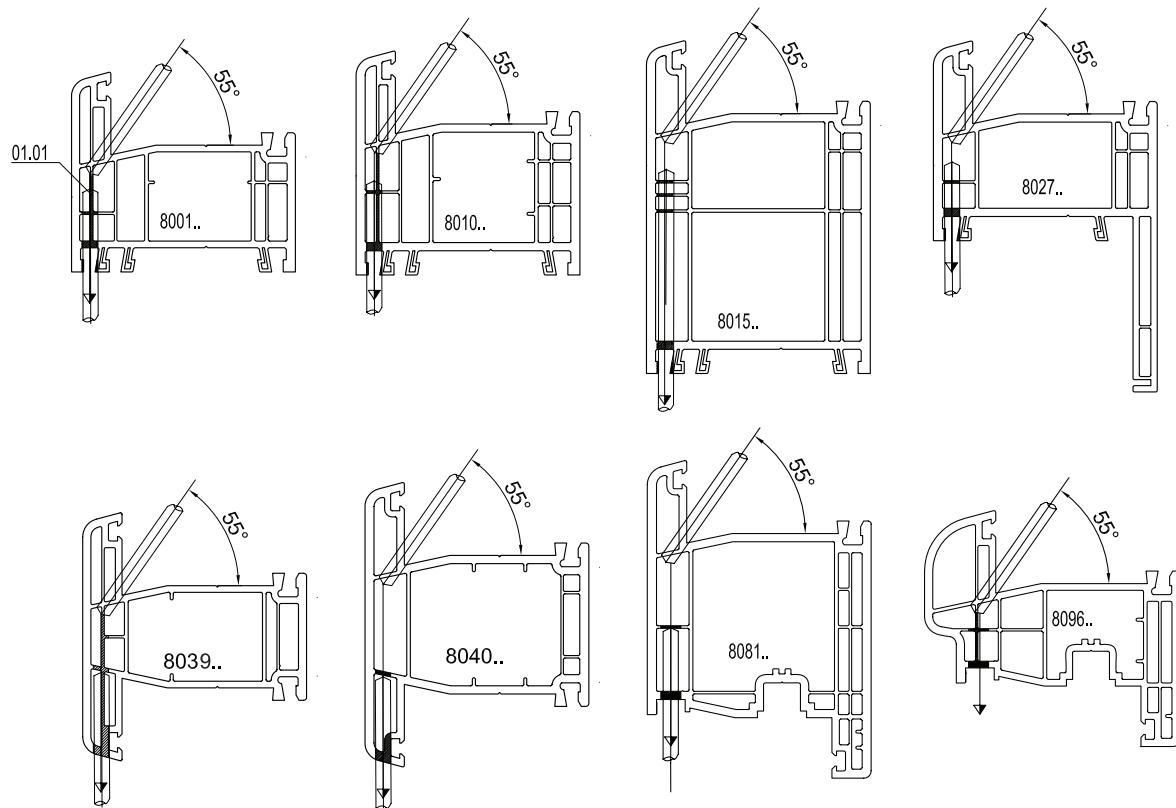

Ventilation / Entlüftung / Ventilazione / Ventilarea

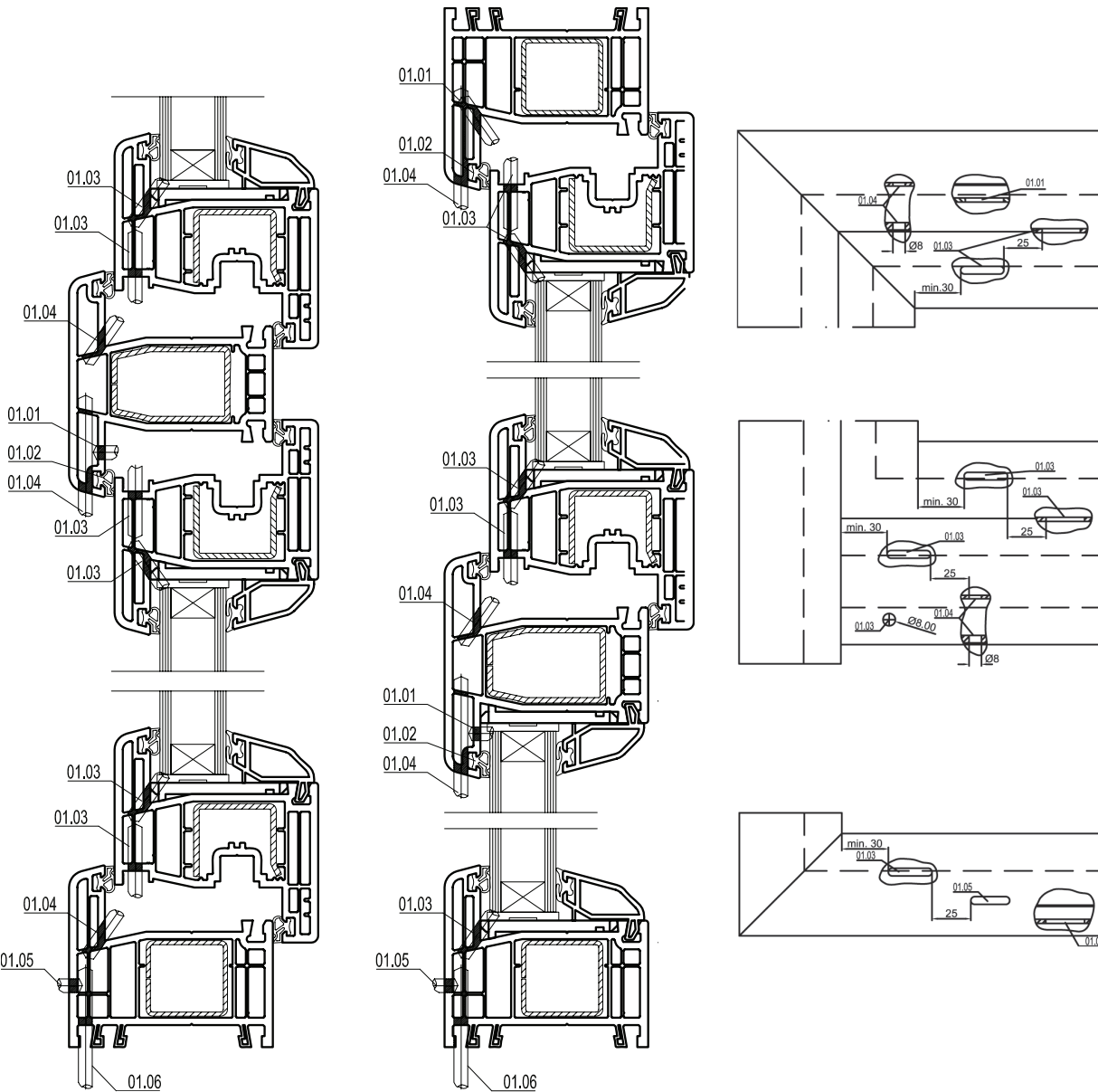
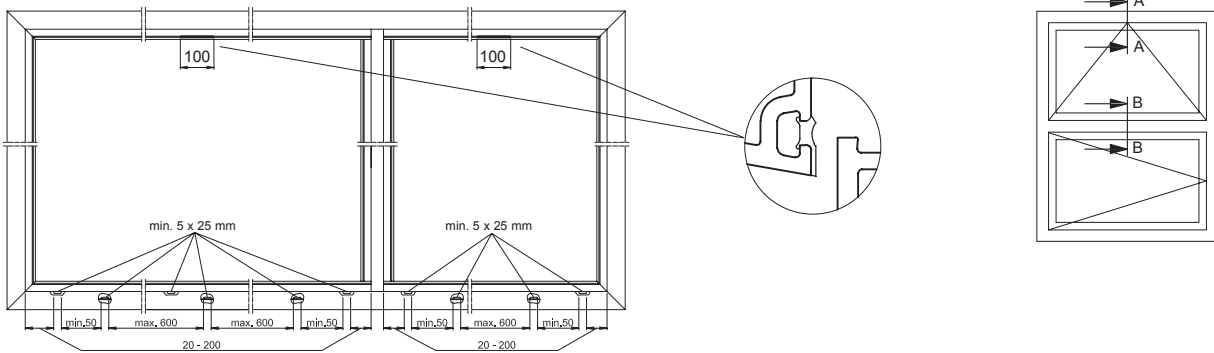

\* The antechamber must be ventilated if heat is to be prevented from accumulating in non-white profiles.

\* Um einen Hitzestau zu vermeiden, belüften Sie bei nicht weißen rofilen die Vorkammern.

\* Per evitare un ristagno di calore la precamera dei profili non bianchi deve essere ventilata

\* Pentru a evita acumularea de caldura, precamerele profilelor non-albe trebuiesc ventilate.

**Ventilation system / Lüftungssystem / Sistema di areazione / Sistem de ventilatie**

**GECCO 4 is the latest GEALAN ventilation system option. It is suitable for all GEALAN window systems. GECCO 4 is equipped with pollen and dust filters, protection screen against insects as well as sound insulation and rain protection profiles. The air flux measures approximately 11 m<sup>3</sup> per hour at a pressure difference of 10 Pascal and can go up to over 19 m<sup>3</sup> per hour near the closing point (wich is at approximately 30 Pascal pressure difference). The device can also be manually-operated.**

Im geöffneten Zustand schließt der GECCO 4 automatisch bei einer Druckdifferenz von ca. 30 Pa, so dass Zugscheinungen erst gar nicht auftreten können. Lässt der Winddruck nach, öffnet sich die Klappe von selbst und die Luftzirkulation findet wieder ungehindert statt. Bei Bedarf kann das Lüftungssystem aber auch manuell verschlossen werden. Auch der Luftdurchsatz des GECCO 4 kann sich sehen lassen. Er beträgt bei einer Druckdifferenz von 10 Pa ca. 11 m<sup>3</sup> pro Stunde. Bis zum Schließpunkt von ca. 30 Pa steigt der Luftdurchsatz auf mehr als 19 m<sup>3</sup> pro Stunde an.

*Grazie a GECCO 4, GEALAN è in grado di garantire un'aerazione autonoma dei locali decisamente maggiore rispetto alle altre versioni. Il montaggio avviene per mezzo degli allargatori del telaio o nel telaio fisso se dotato di profili più larghi. GECCO 4 è adatto per profondità costruttive tra 62 mm e 90 mm. Questa versione è sempre provvista di un apposito filtro antipollini. È notevole il flusso d'aria che è di cca. 11 m<sup>3</sup> all'ora ad una differenza di pressione di 10 Pascal, e fino al punto di chiusura di cca. 30 Pascal ammonta a più di 19 m<sup>3</sup> all'ora. Il dispositivo permette anche l'azionamento meccanico.*

Principalul avantaj al dispozitivului GECCO 4 este reprezentat de utilizarea universala a acestuia, pentru toate sistemele de profile (atat din PVC, cat si din lemn) cu adancimi de constructie cuprinse intre 62 mm si 90 mm. Acesta ofera si avantaje suplimentare precum filtru de polen si de praf si protectie impotriva insectelor. In plus, GECCO 4 este prevazut si cu un accesoriu de protectie contra ploii. Remarcabil este fluxul de aer care insumeaza aproximativ 11 m<sup>3</sup> pe ora la o diferenta de presiune de 10 Pascal, iar pana la punctul de inchidere de aproximativ 30 Pascal urca la peste 19 m<sup>3</sup> pe ora. Dispozitivul permite si actiunea manuala.

**GECCO 4**

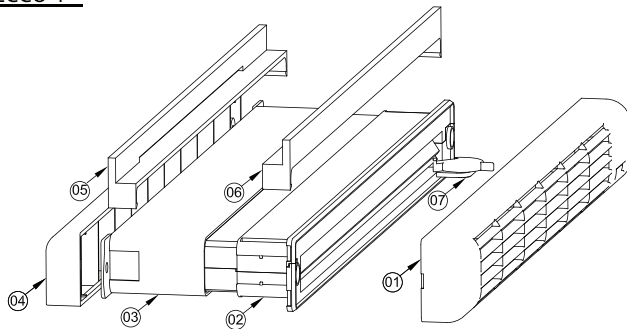

01=	Inside grid with a filter	05=	Front covering stripe
02=	Case	06=	Rear covering stripe
03=	Outside grid	07=	Switch
04=	Outside grid cover		

