

HERCULES 70



MILLENNIUM PLUS



Heat transfer coefficient
Wärmedurchgangskoeffizient
Transmittanza termica
Transmitanta termica

up to
bis
fino a
pana la Uf = 1,9 W/(m2K)



Resistance to wind load
Widerstandsfähigkeit
gegen Windlast
Resistenza ai carichi di vento
Rezistentă la încărcarea din vant

up to
bis
fino a
pana la Clasa C5



Tightness against driving rain - unprotected (A)
Schlagregendichtheit - Ungeschützt (A)
Tenuta all'acqua metodo di prova A
Etanșeitatea la apă expunere directă

up to
bis
fino a
pana la E1200



Air permeability
Luftdurchlässigkeit
Tenuta all'aria
Permeabilitatea aerului

up to
bis
fino a
pana la Clasa 4



Sound insulation
Schallschutz
L'isolamento acustico
Izolarea acustica

up to
bis
fino a
pana la 44 dB



Burglar-resistant
Einbruchhemmung
Resistenza antieffrazione
Rezistentă antiefracție

up to
bis
fino a
pana la RC 2 (WK 2)



Heat transfer coefficient
Wärmedurchgangskoeffizient
Transmittanza termica
Transmitanta termica

up to
bis
fino a
pana la Uf = 1,9 W/(m2K)



Resistance to wind load
Widerstandsfähigkeit
gegen Windlast
Resistenza ai carichi di vento
Rezistentă la încărcarea din vant

up to
bis
fino a
pana la Clasa C4



Tightness against driving rain - unprotected (A)
Schlagregendichtheit - Ungeschützt (A)
Tenuta all'acqua metodo di prova A
Etanșeitatea la apă expunere directă

up to
bis
fino a
pana la 6A



Air permeability
Luftdurchlässigkeit
Tenuta all'aria
Permeabilitatea aerului

up to
bis
fino a
pana la Clasa 4



Sound insulation
Schallschutz
L'isolamento acustico
Izolarea acustica

up to
bis
fino a
pana la 38 dB



Burglar-resistant
Einbruchhemmung
Resistenza antieffrazione
Rezistentă antiefracție

up to
bis
fino a
pana la RC 2 (WK 2)

BESCHLÄG
HARDWARE
GLASS
GLASS
ROLLO TOP
ROLLO FRONT
BORA
HERCULES 70

PERFORMER 74
RONDO
STYLE 76
PASIV 82
KUBUS
PREMIDOOOR 76
PREMIDOOOR 88
PREMILINE

System features / Systemmerkmale / Caratteristiche del sistema / Caracteristici Sistem

COR 70

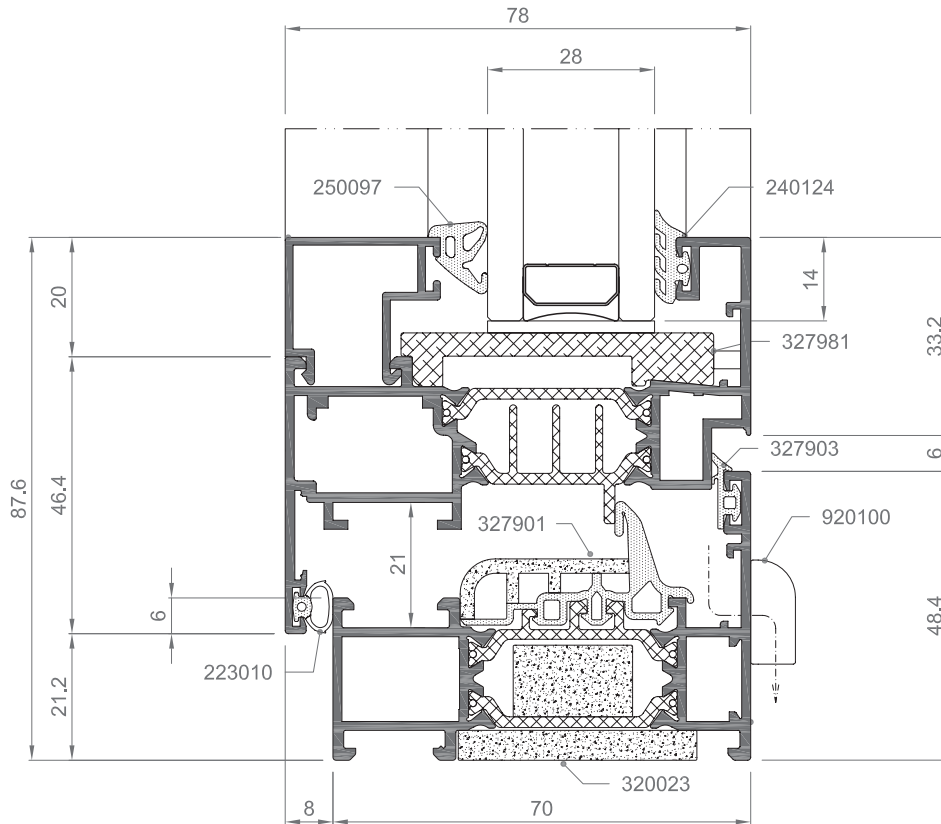

1. Sistem de fereastră cu balamale dezvoltată cu scopul de a satisface necesitățile unui anumit segment de piață cu o tamplarie economică, simplă și versatilă cu prestații ridicate.
2. Având 70 mm. grosime toc și feronerie de Canal European această inovație a Departamentului de I+D+I cu un coeficient de transfer termic al tocului de doar 1,8 W/m²K pentru a se putea adapta la diferite condiții climatice și necesităților în materie de eficiență energetică.
3. Datorită modului simplu de montare și necesitatea redusă de mână de lucru permite producția industrializată de economie de timp și cost.
4. Foaie dreaptă, bagheta dreaptă sau rotundă
5. Posibilitatea de vitrare până la 55 mm care permite utilizarea sticlelor economice energetic și grosimi mari, oferind acestui sistem prestații acustice și termice excelente

1. A hinged window system that was conceived with the object of satisfying the needs of a determined market segment for an economical window system, simple but versatile with many features.
2. With a 70 mm frame depth and Euro Groove opening gearing, this innovation from the R&D Department has thermal transmission from only 0.9 W/m²K in order to adapt to distinct climatic severities and material demands on energy efficiency.
3. Its simplicity in fitting and reduced need for labour allows for a more industrialised manufacture resulting with time and cost savings at the end.
4. It features a straight style in both sash and bead.
5. A glazing capacity of up to 65.5 mm that allows the use of energy efficient glazing and compositions with large thicknesses and affords this system excellent acoustic and thermal features

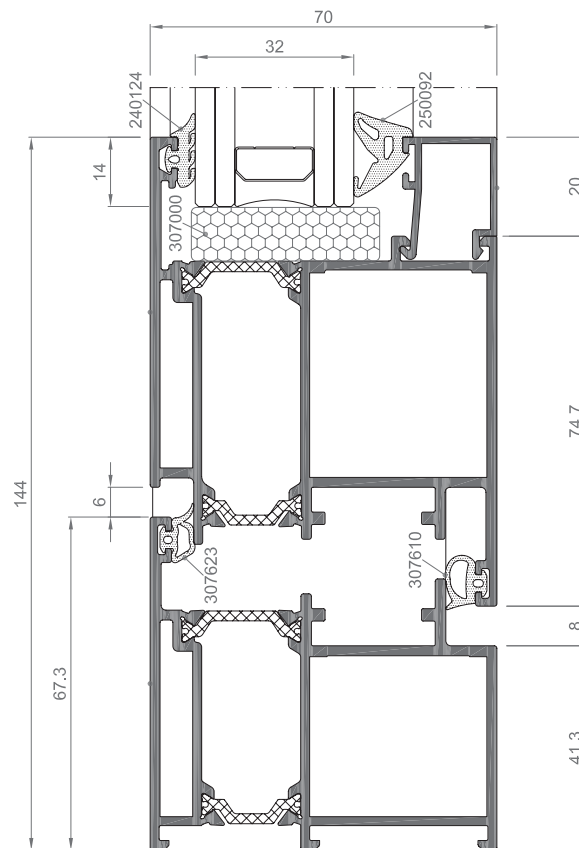
System features / Systemmerkmale / Caratteristiche del sistema / Caracteristici Sistem
MILLENNIUM PLUS

1. Sistem de usa pietonal drept de 70 mm cu Bariera Termica pentru localuri comerciale si cladiri.
2. Cu o valoare de transfer termic a tocului de la 1,8 W/m²K, atinge unele prestatii termice foarte bune si posibilitatea de vitrare ii ofera o izolare acustica maxima.
3. Posibilitatea folosirii balamalelor cu rezistenta mare (aplicate sau balamale pe canal refortate) capabile sa suporte pana la 220 Kg. greutate pe foaie.
4. Posibilitatea folosirii balamalelor ascunse cu dimensiuni si greutati maxime pe foaie de 2.700 mm. inaltime, 1.500 mm. latime si 120 Kg. si cu deschidere maxima a foii de 100 °.
5. Prezinta solutii de finisare la sol si imbinari compatibile cu sistemele noastre actuale.
6. Se poate folosi ca iesire de urgenta cu dispozitiv antipanica dupa normativa EN 179 si EN 1125

1. Coplanar door entry system with straight 70 mm and thermally broken for commercial premises and buildings.
2. With a frame transmission value from 0.9 W/m²K, it reaches unbeatable thermal features and its great glazing capacity guarantees a maximum acoustic insulation.
3. Possibility of high resistance hinges (face fix or re-inforced in to the channel) capable of supporting up to 220 kgs in weight per sash.
4. Possibility of hidden hinges with maximum dimensions and weight per sash of 2700 mm in height, 1500 mm in width and 120 kgs. and with a maximum sash opening of 100°.
5. It presents solutions of finishing to the floor and compatible meeting styles with our actual systems.
It is valid as a configuration for an emergency exit with anti-panic devices according to EN 179 & EN 1125 norms.

Frame profiles / Rahmenprofile / Profili Telaio / Profile Toc

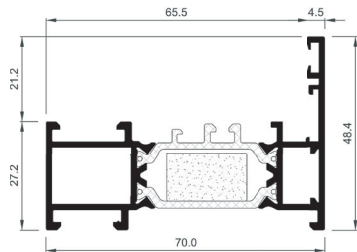

COR 7931

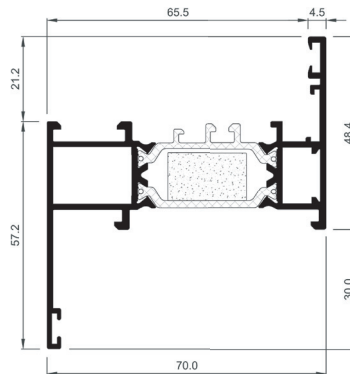

COR 7933

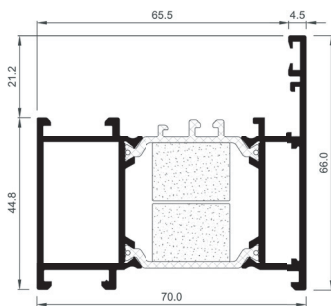

COR 7937

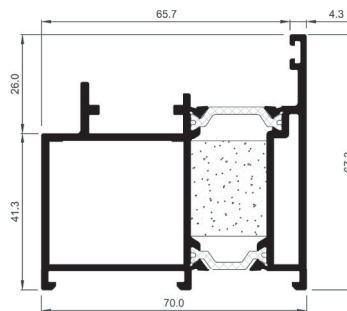

COR 7680

Sash profiles / Flügelprofile / Profili Anta / Profile Cercevea

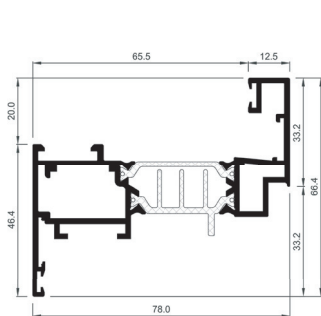

COR 7920

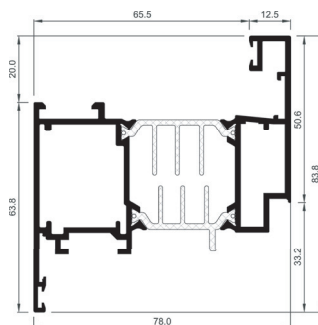

COR 7921

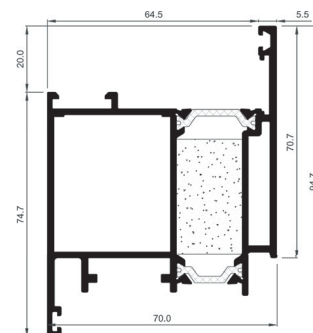

COR 7685

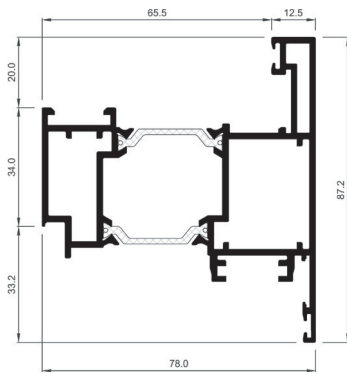

COR 7922

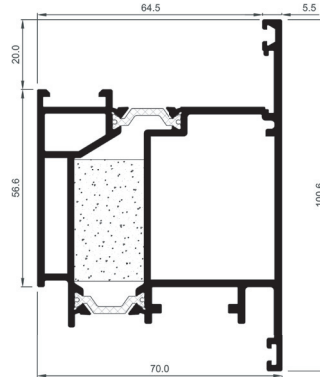

COR 7686

Floating mullion profiles / Stulpprofile / Profili per battuta centrale / Profile Stulp

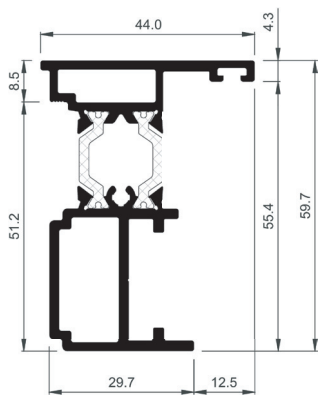

COR 7640

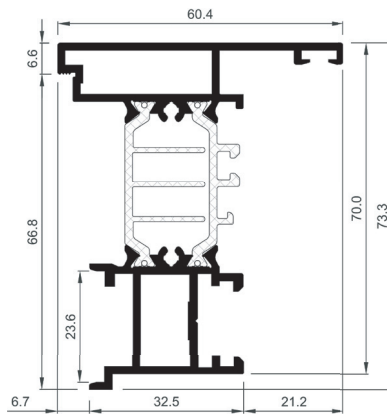

COR 7940

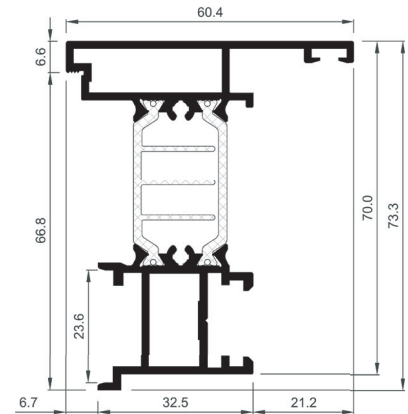

COR 7942

HERCULES 70 BORA ROLLO FRONT ROLLO TOP GLASS GLASS HARDWARE BESCHLÄG PREMILINE PREMIDOOR 88 PREMIDOOR 76 KUBUS PASIV 82 STYLE 76 RONDO PERFORMER 74

Sash rails / Pfosten / Profili per traverso / Profile montant

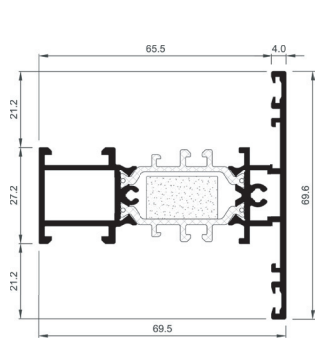

COR 7971

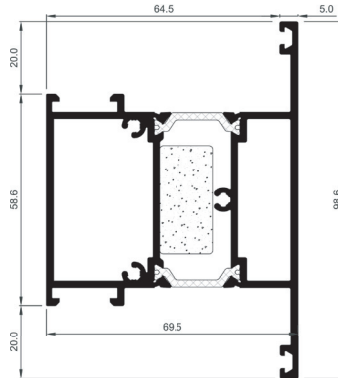

COR 7690

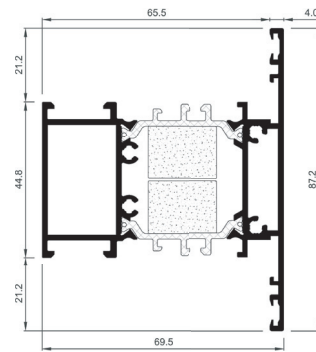

COR 7976

Extension profile / Verbreiterung / Profilo zoccolo porta / Profil bandou ușă

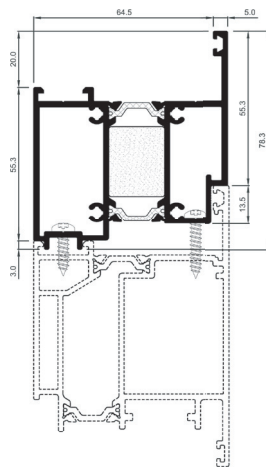

COR 7688

Threshold & Weather bar / Schwelle & Wetter Schenkel / Soglia & Profilo Gocciolatoio / Praguri & Lacrimare

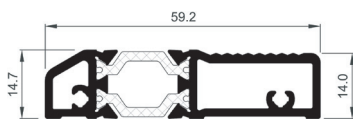

COR 7660

Coupling Profiles / Kopplungsprofile / Profili di accoppiamento / Profile cuplare

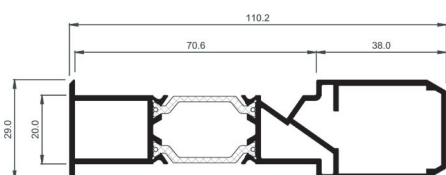

COR 7355

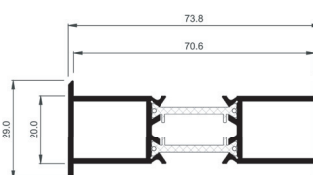

COR 7354

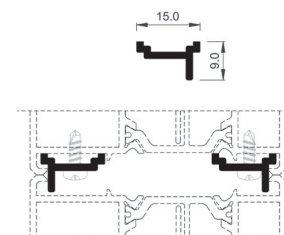

COR 7251

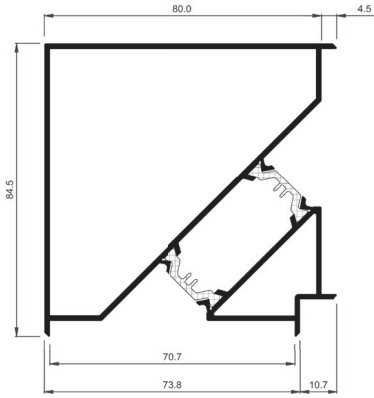

COR 7359

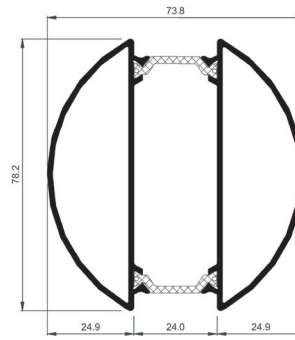

COR 7980

Bank connection profile / Bankanschluss profile / *Profili di appoggio inferiore* /
Profile suprainaltare

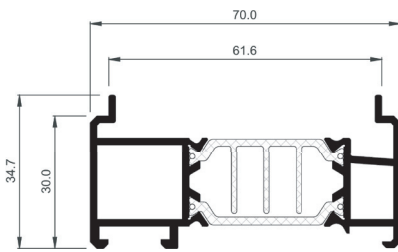

COR 7390

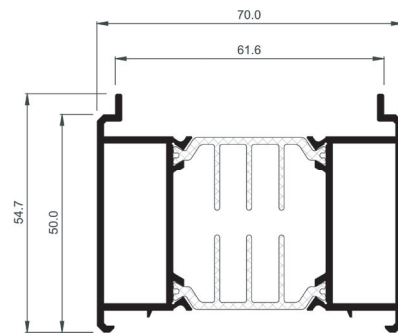

COR 7391

Gasket / Dichtung / *Guarnizione* / Garnitură

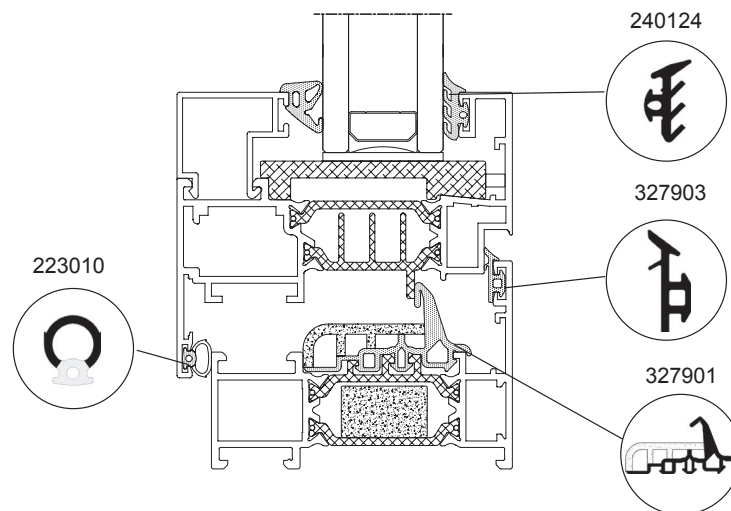

Fixed light / Festfeld / Fissa / Fix

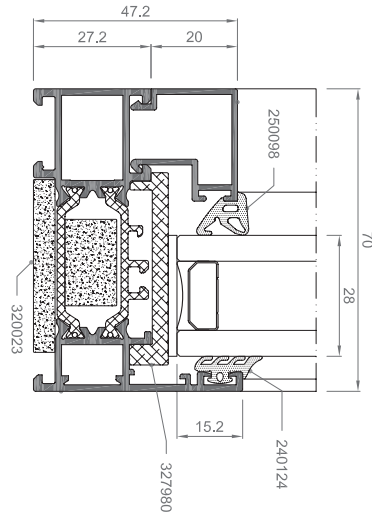
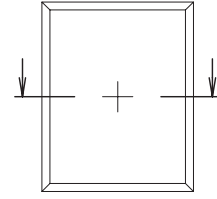

Frame 7931

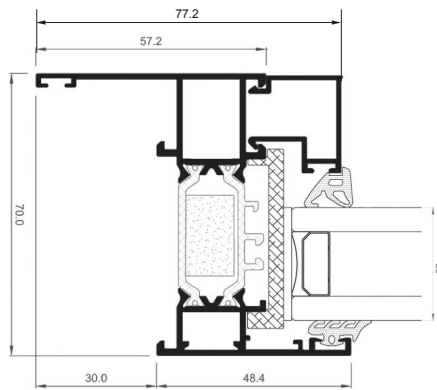

Frame 7933

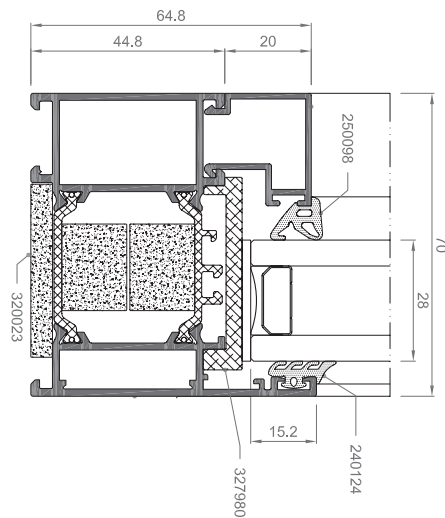

Frame 7937

Fixed light with transom / Festfeld Pfosten /
Fissa con montate / Fix cu montant

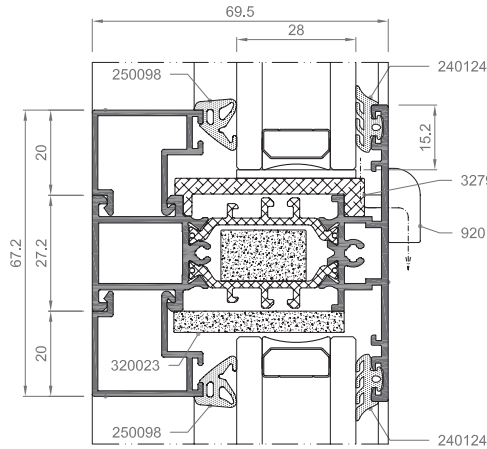
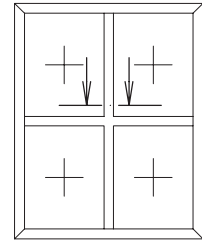

Transom 7971

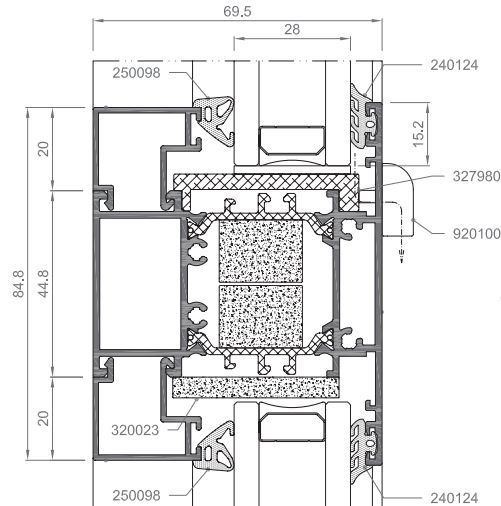

Transom 7976

Frame - Sash / Blendrahmen - Flügel /
Telaio - Anta / Toc - Cercevea

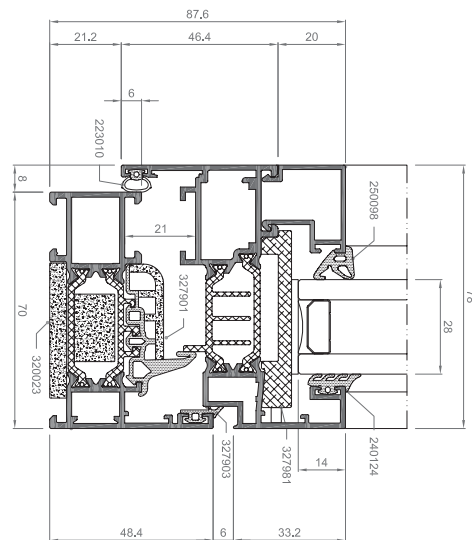
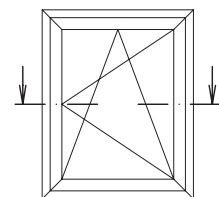

Frame Sash 7931 7920

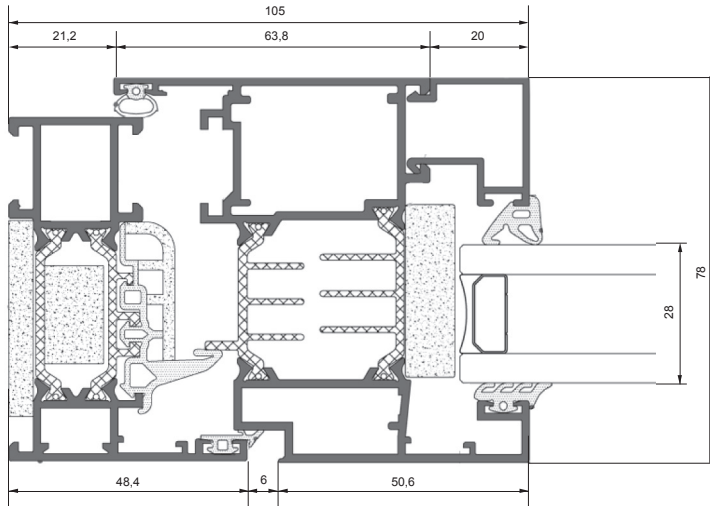

Frame 7931
Sash 7921

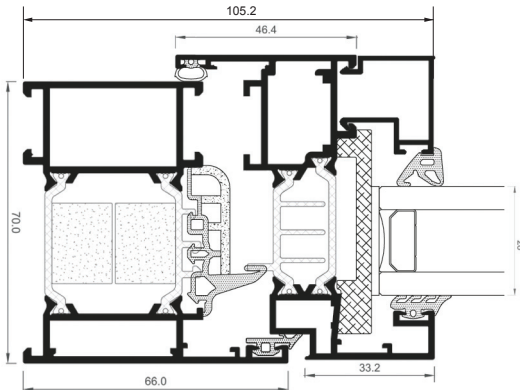

Frame 7937
Sash 7920

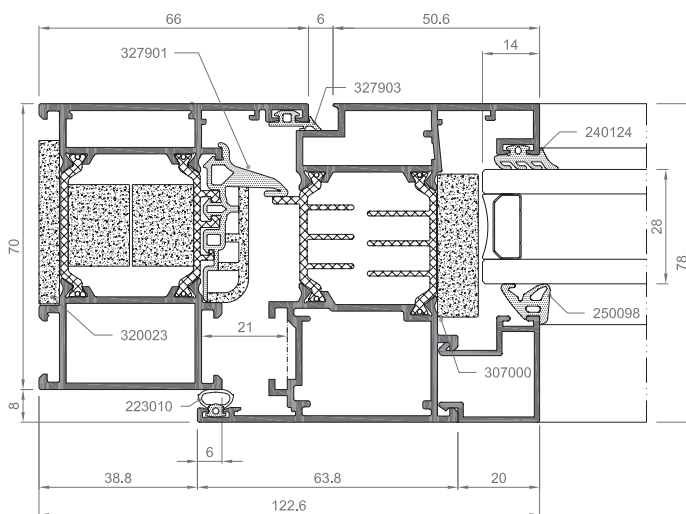

Frame 7937
Sash 7921

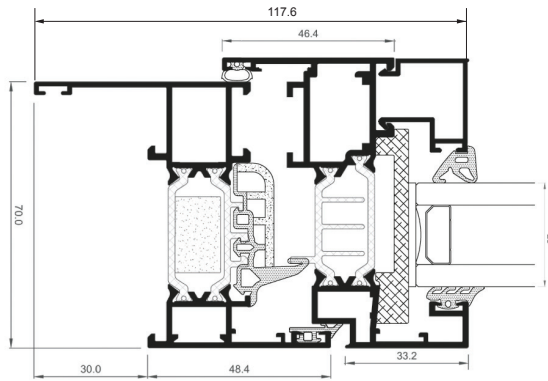

Frame 7933
Sash 7920

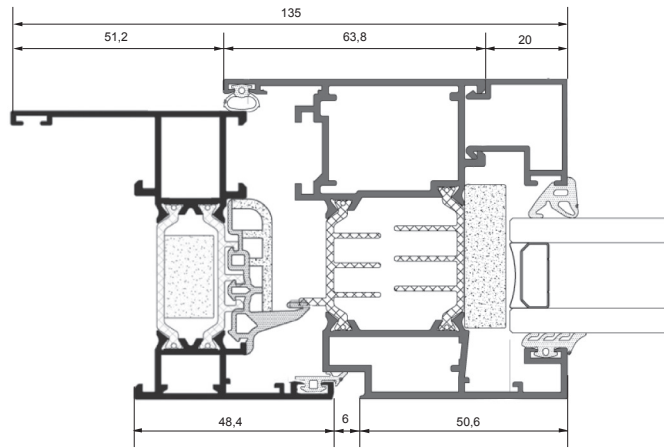

Frame 7933
Sash 7921

HERCULES 70 BORA ROLLO FRONT ROLLO TOP GLASS GLASS BESCHLÄG HARDWARE PREMILINE PREMIDOOR 88 PREMIDOOR 76 KUBUS PASIV 82 STYLE 76 RONDO PERFORMER 74

**Fixed light - Transom - Sash / Festfeld - Pfosten - Flügel /
Fisso - Montante - Anta / Fix - Montant - Cercevea**

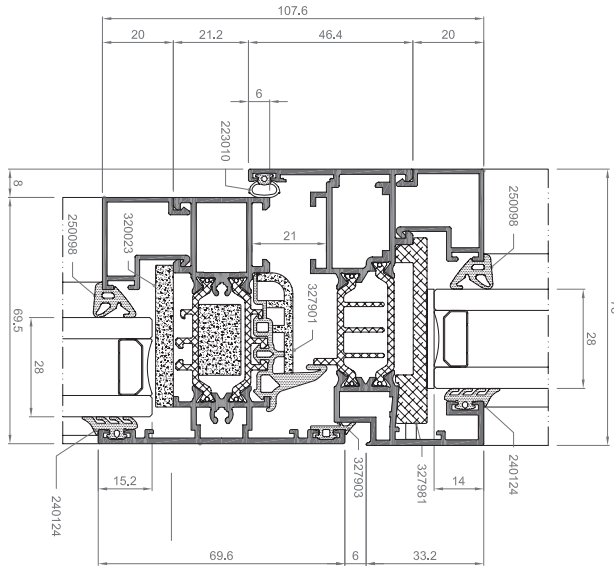
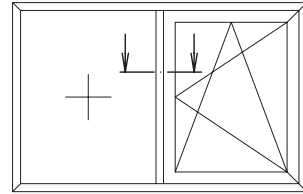

Transom 7971
Sash 7920

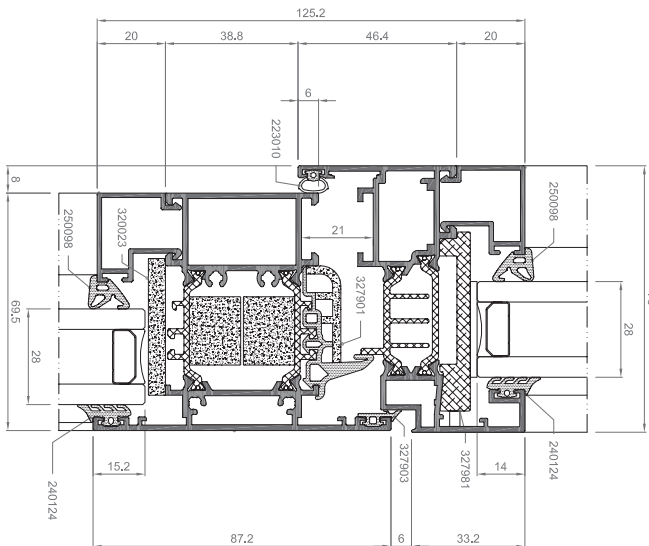

Transom 7976
Sash 7920

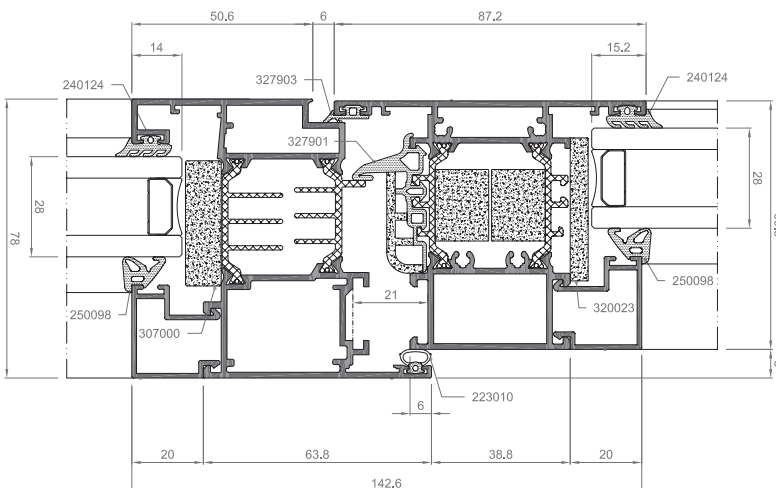

Transom 7976
Sash 7921

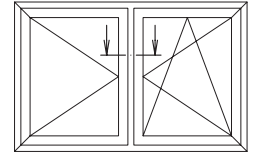
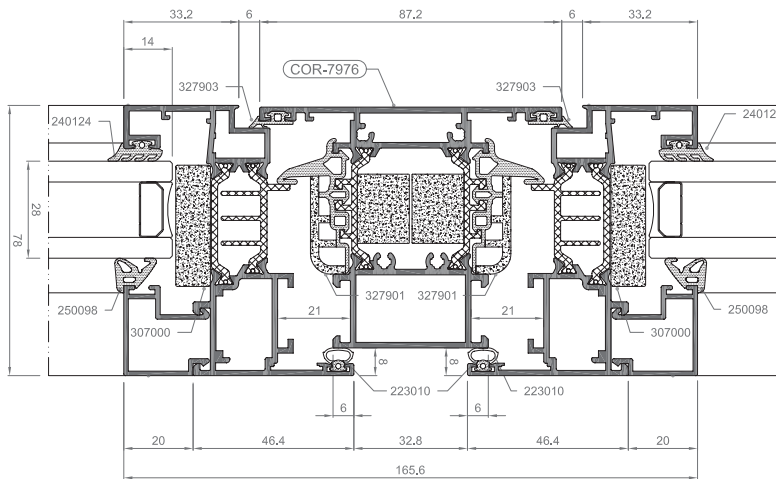

Sash 7920
Transom 7976
Sash 7920

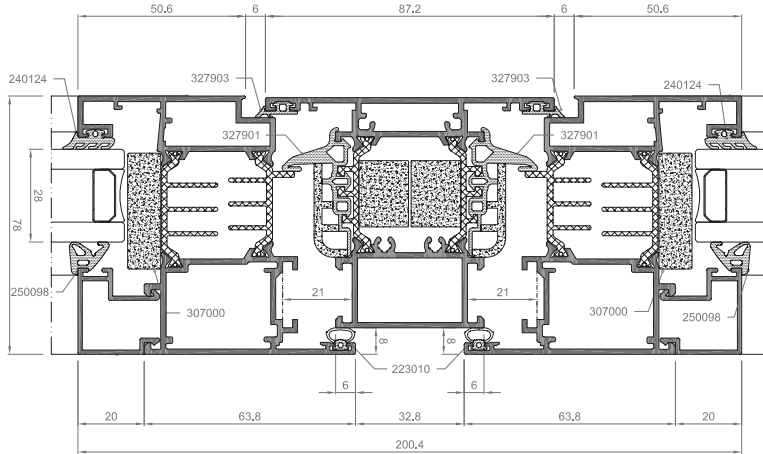

Sash 7921
Transom 7976
Sash 7921

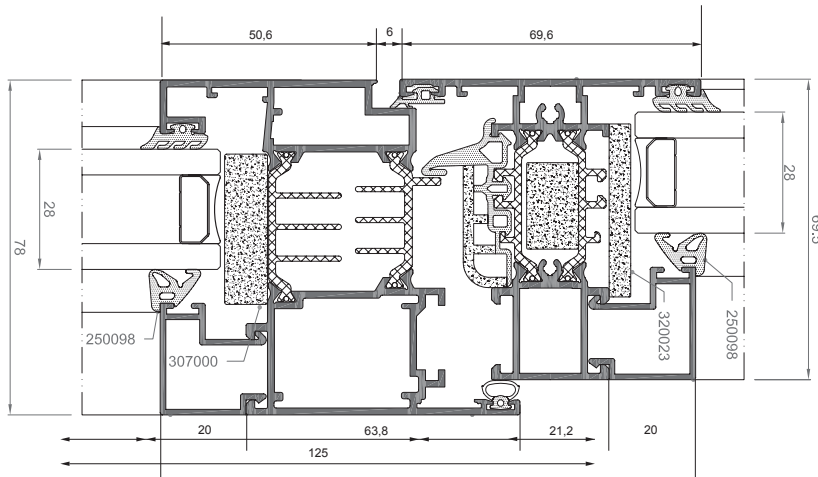

Transom 7971
Sash 7921

PERFORMER 74
RONDO
STYLE 76
PASIV 82
KUBUS
PREMIDOOR 76
PREMIDOOR 88
PREMILINE
BESCHLAG
HARDWARE
GLASS
GLASS
ROLLO TOP
ROLLO FRONT
BORA
HERCULES 70

**Sash - Floating Mullion - Sash / Flügel - Stulp - Flügel /
Anta - Profil Riporto - Anta / Cercevea - Ștulp - Cercevea**

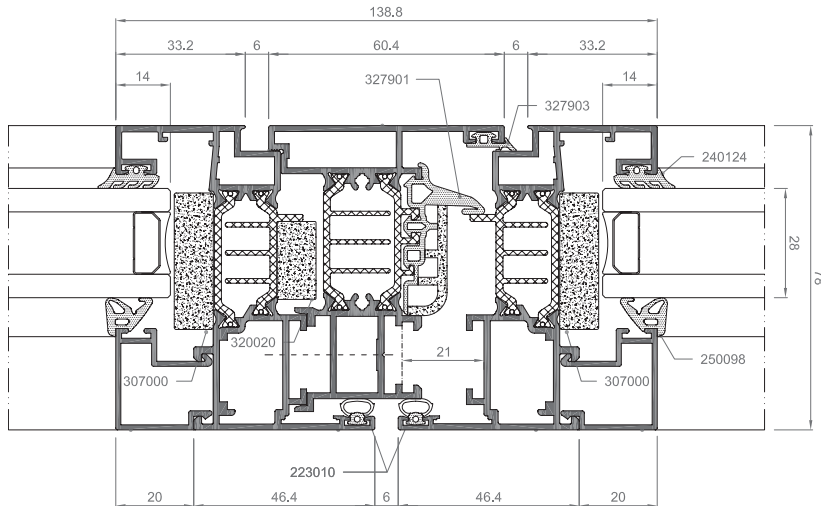
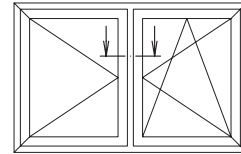

Sash 7920
Floating Mullion 7940
Sash 7920

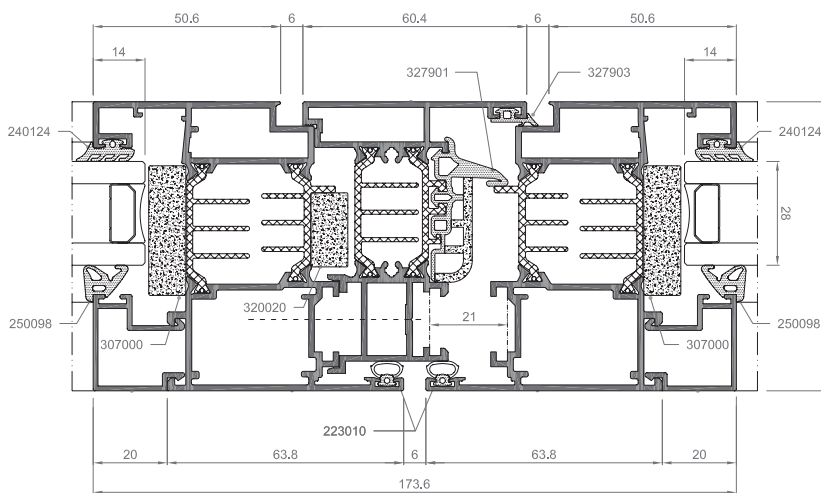

Sash 7921
Floating Mullion 7940
Sash 7921

Frame - Sash / Blendrahmen Flügel /
Telaio - Anta / Toc - Cercevea

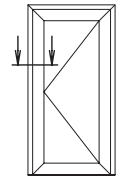
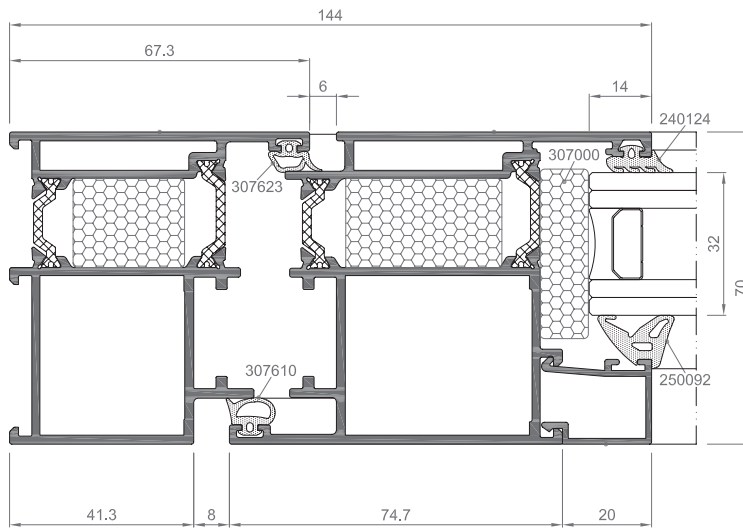

Frame 7680
Sash 7685

Threshold - Sash / Schwellenprofil - Flügel /
Soglia - Anta / Prag - Cercevea

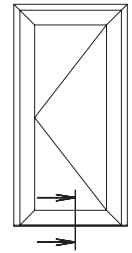
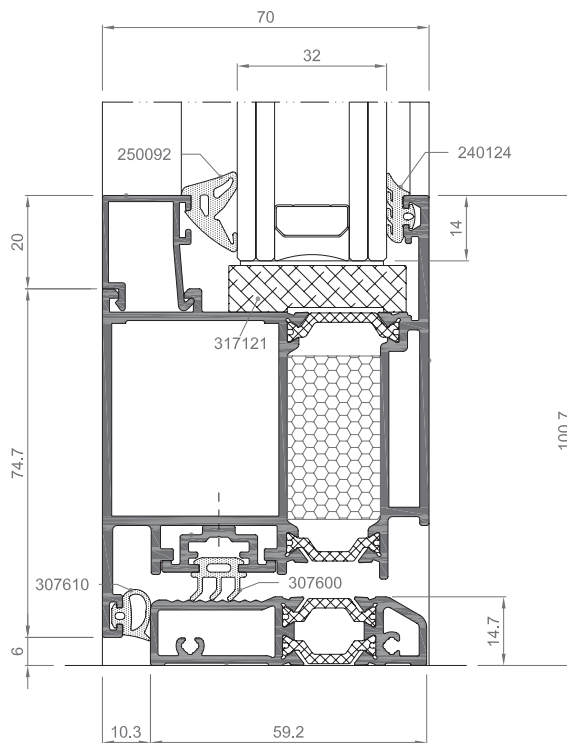

Threshold 7660
Sash 7685

PERFORMER 74
RONDO
STYLE 76
PASIV 82
KUBUS
PREMIDOOR 76
PREMIDOOR 88
PREMILINE
BESCHLÄG
HARDWARE
GLAS
GLASS
ROLLO TOP
ROLLO FRONT
BORA
HERCULES 70

Threshold - Sash outside opening / Schwellenprofil - Flügel außen öffnend /
Soglia - Anta apertura esterna / Prag - Cercevea deschidere exterioară

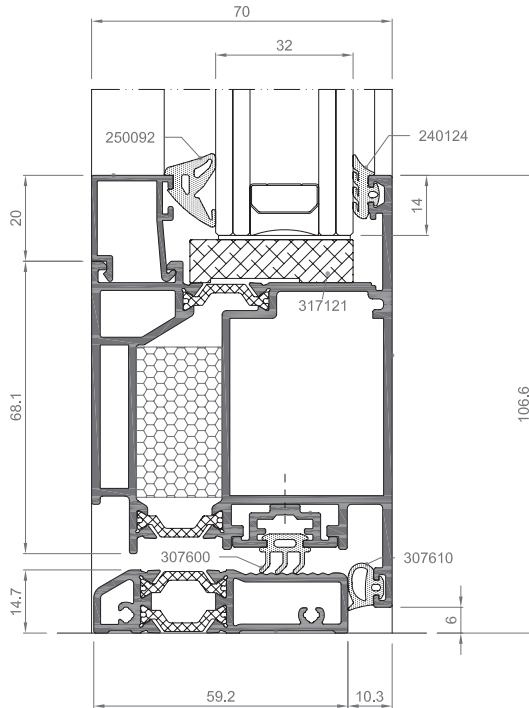
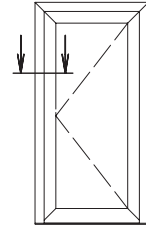

Threshold 7660
Sash 7686

Coupling profiles / Kopplungsprofile /
Profili di accoppiamento / Profile de cuplare

H coupler / H Kopplung / Profilo di accoppiamento / Profil cuplare ranforsat

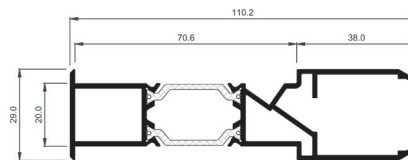
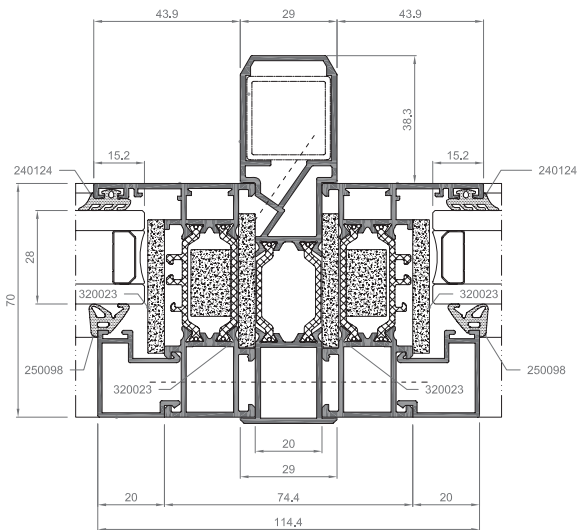

COR 7355

$I_x=4,47 \text{ cm}^4$
 $I_y=61,78 \text{ cm}^4$

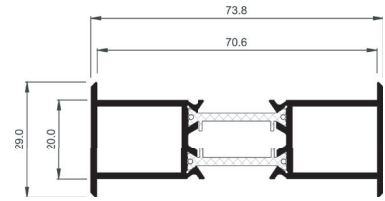
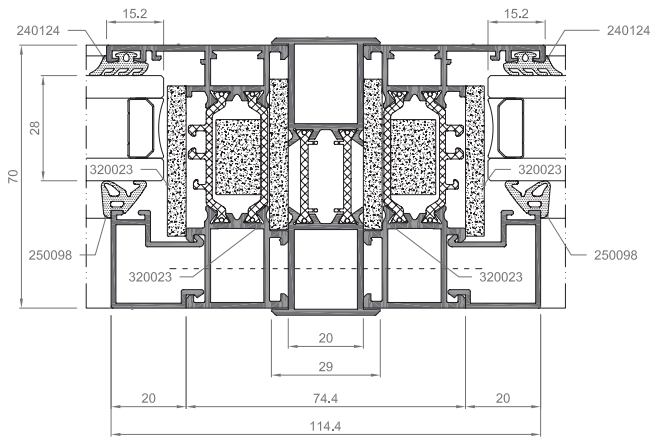

COR 7354

$I_x=2,17 \text{ cm}^4$
 $I_y=22,14 \text{ cm}^4$

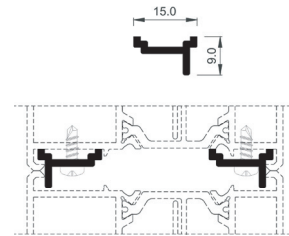
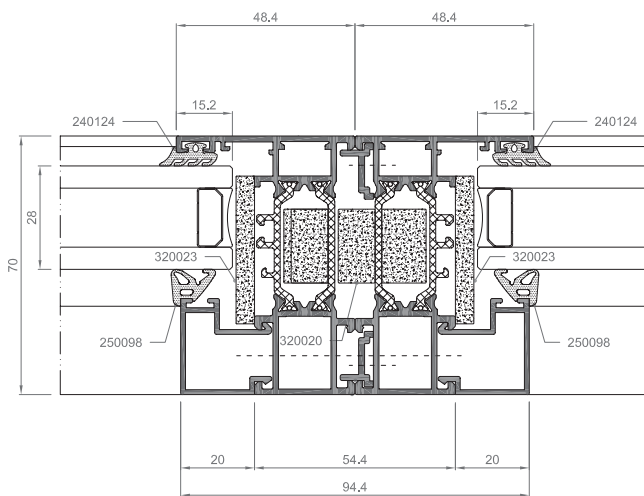

COR 7251

**Corner coupling 90° / Eckkopplung 90° /
Giunto angolare 90° / Profil cuplare 90°**

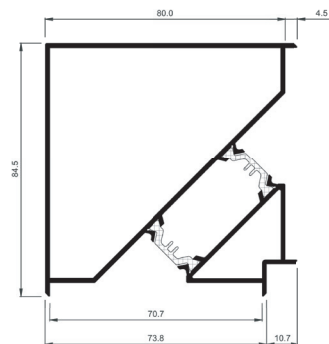
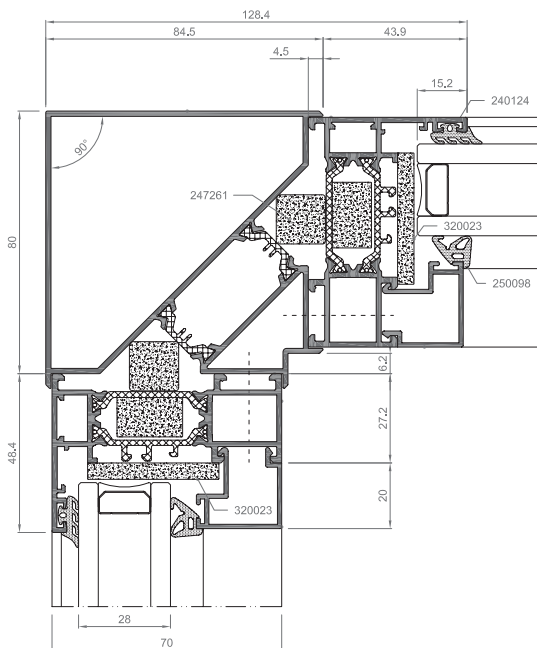

COR 7359

$I_x=56,75 \text{ cm}^4$
 $I_y=56,75 \text{ cm}^4$

Bay pole / Eckkopplung variabel / Giunto angolare variabile / Profil cuplare unghi variabil

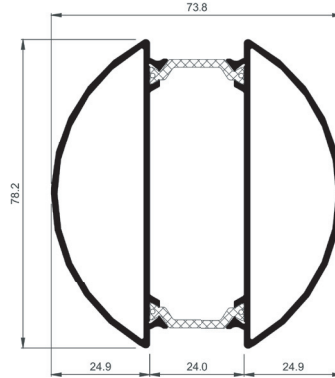
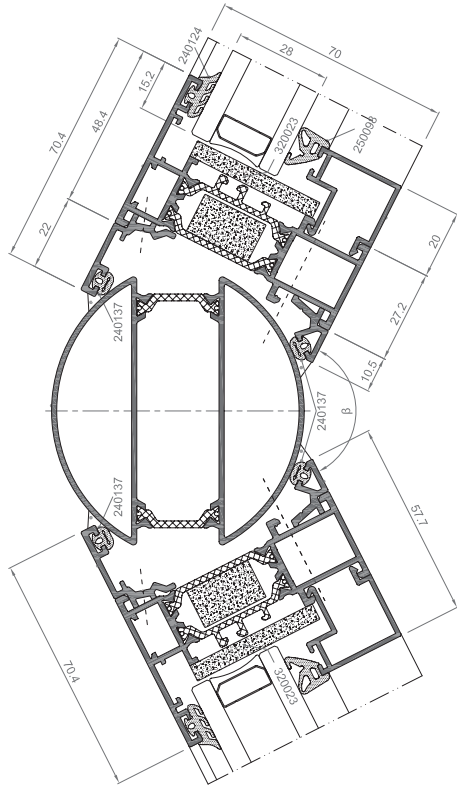

COR 7980
 $I_x=32,41 \text{ cm}^4$
 $I_y=27,95 \text{ cm}^4$

**Base profiles / Sohlbankprofile /
Profilo appoggio inferiore / Profile supraînălțare pervaz**

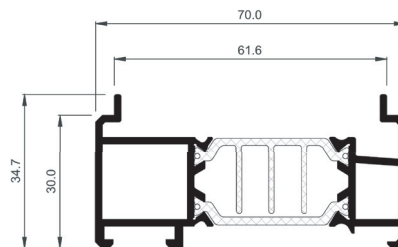
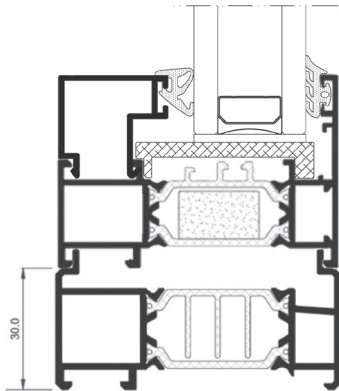

COR 7390
 $I_x=2,74 \text{ cm}^4$
 $I_y=23,26 \text{ cm}^4$

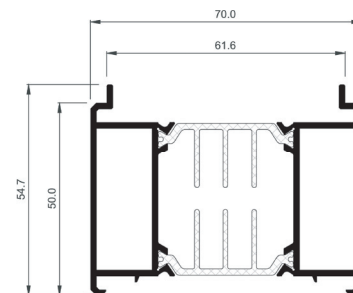
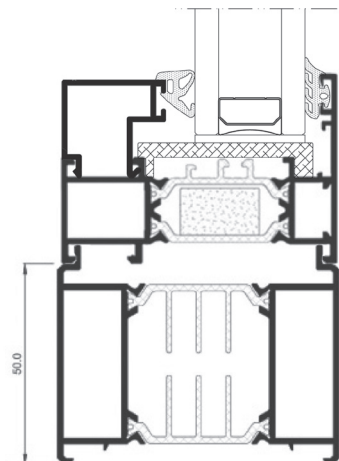

COR 7391
 $I_x=11,69 \text{ cm}^4$
 $I_y=33,53 \text{ cm}^4$

Max. Weight per sash in accordance to dimensions

With 2 hinges: 60 kg MAX WEIGHT

H

	60 Kg													
	L	400	500	600	700	800	900	1000	1100	1200	1300	1400	1500	
BALCONY SASH	2600											53	47	
	2500											56	49	45
	2400											52	47	43
	2300									55	49	44	41	
	2200									51	46	42	39	
	2100								55	48	43	40	38	
	2000								51	45	41	38	36	
	1900							55	47	42	39	37	35	
	1800							50	44	40	37	35	33	
WINDOW SASH	1700					54	46	41	38	35	34	32		
	1600					49	43	39	36	34	32	31		
	1500				53	45	40	37	34	33	31	30		
	1400				48	42	38	35	33	31	30	29		
	1300			53	44	39	35	33	31	30	29	28		
	1200			47	40	36	33	31	30	29	28	27		
	1100		51	42	37	34	32	30	29	28	27	26		
	1000		45	38	34	32	30	29	28	27	26	26		
	900	50	40	35	32	30	29	28	27	26	25	25		
	800	43	36	32	30	28	27	26	26	25	25	24		
	700	48	38	33	30	28	27	26	25	25	24	24		
	600	40	33	30	28	27	26	25	24	24	24	--	--	
500	34	30	28	26	25	25	24	--	--	--	--	--		
400	30	27	26	25	--	--	--	--	--	--	--	--		

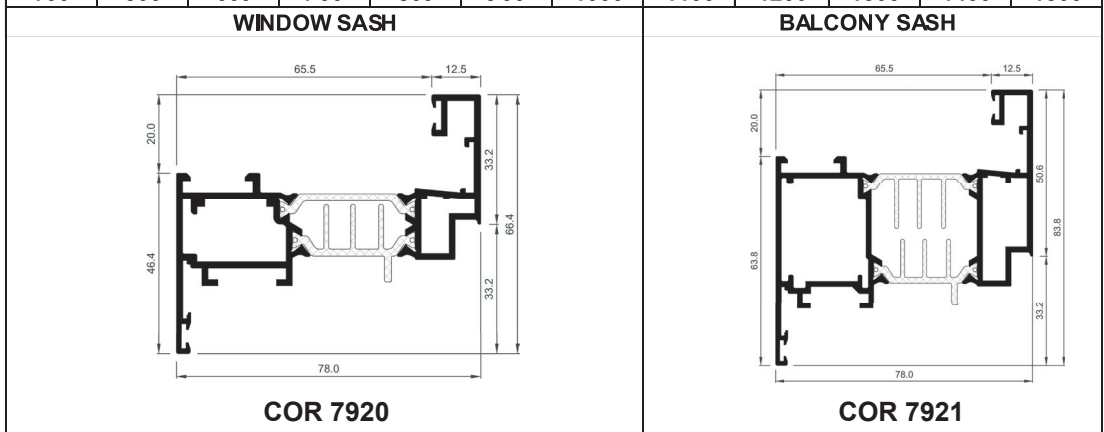

- Configuration with max. Weight
- 3 or more hinges recommended
- Configurations not possible

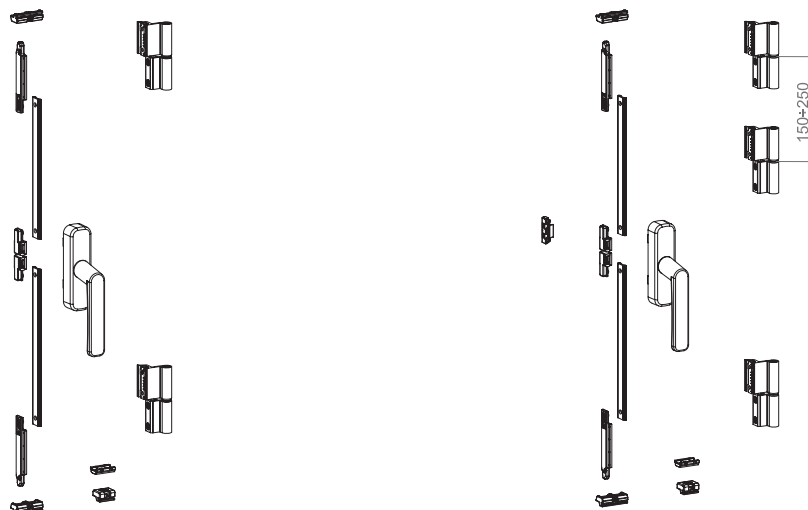

Max. Weight per sash in accordance to dimensions

With 3 hinges **MAX. WEIGHT**

		H												
BALCONY SASH	2600												66	59
	2500												70	56
	2400												65	54
	2300												69	51
	2200												64	49
	2100												69	47
	2000												63	45
	1900												68	43
	1800												63	42
	WINDOW SASH	1700												68
1600													61	39
1500													67	38
1400													60	36
1300													66	35
1200													58	34
1100													64	33
1000													56	32
900													63	32
800													54	32
700													47	33
600													42	33
500												38	33	
400												38	33	
L		400	500	600	700	800	900	1000	1100	1200	1300	1400	1500	

75 Kg

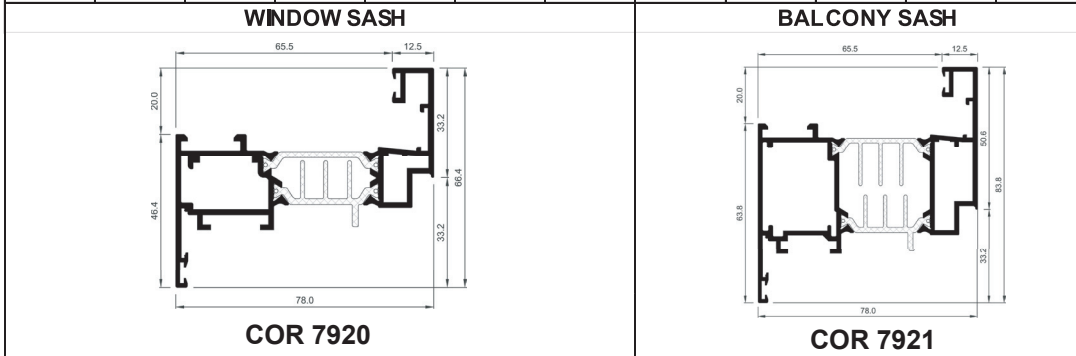

- Configuration with max. weight
- 4 hinges recommended
- Configurations not possible

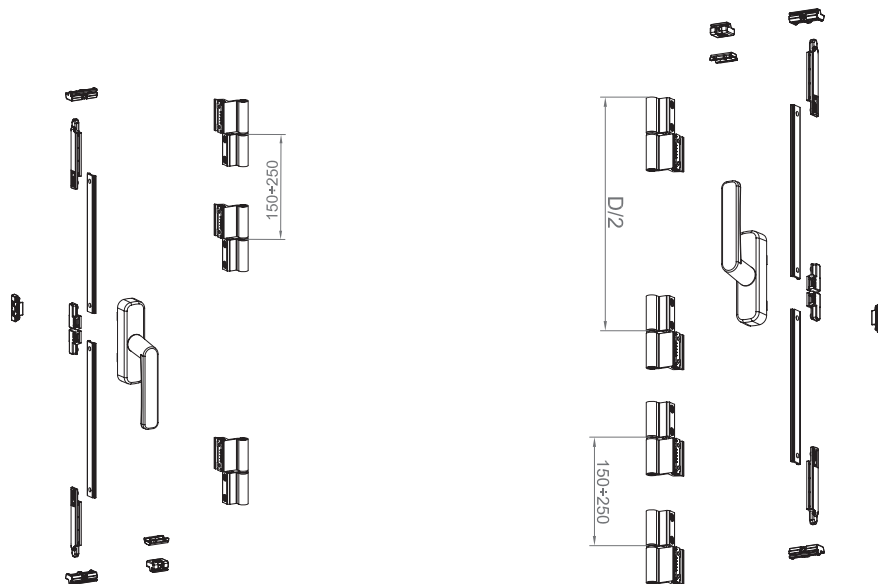

Max. Weight per sash in accordance to dimensions

With 3 hinges **MAX. WEIGHT**

		H																				
BALCONY SASH	2600											66	59									
	2500											70	62	56								
	2400											65	58	54								
	2300											69	61	55	51							
	2200											64	57	53	49							
	2100											69	60	54	50	47						
	2000											63	56	51	48	45						
	1900											68	59	53	49	46	43					
	1800											63	55	50	46	44	42					
WINDOW SASH	1700											68	58	52	47	44	42	40				
	1600											61	54	49	45	42	40	39				
	1500											67	56	50	46	43	41	39	38			
	1400											60	52	47	43	41	39	38	36			
	1300											66	55	48	44	41	39	38	36	35		
	1200											58	50	45	42	39	38	36	35	34		
	1100											64	53	46	42	39	38	36	35	34	33	
	1000											56	48	43	40	38	36	35	34	33	32	
	900											63	50	44	40	38	36	34	33	33	32	--
	800											54	45	40	38	36	34	33	32	--	--	--
	700	60	47	41	38	35	34	33	--	--	--	--	--	--	--	--						
	600	50	42	38	35	33	--	--	--	--	--	--	--	--	--							
500	43	38	35	--	--	--	--	--	--	--	--	--	--	--								
400	38	--	--	--	--	--	--	--	--	--	--	--	--	--								

75 Kg

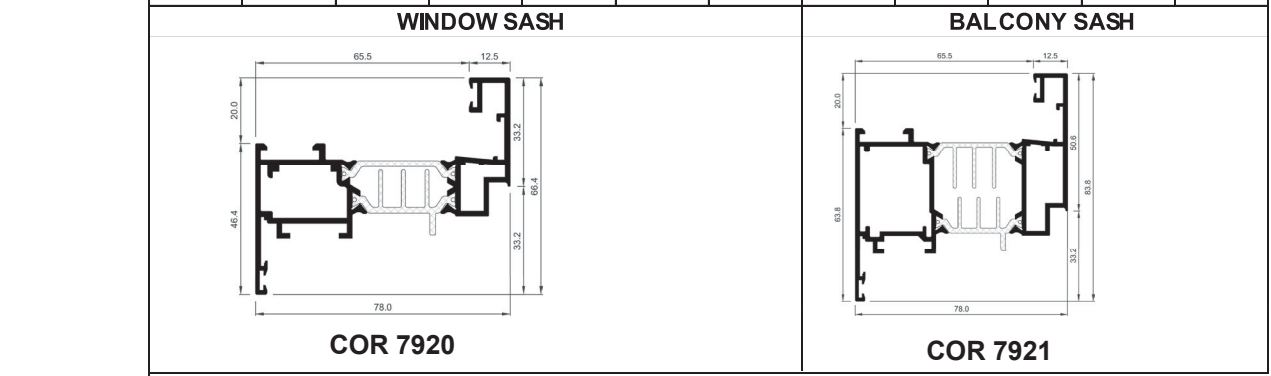

Configuration with max. weight
 4 hinges recommended
 Configurations not possible

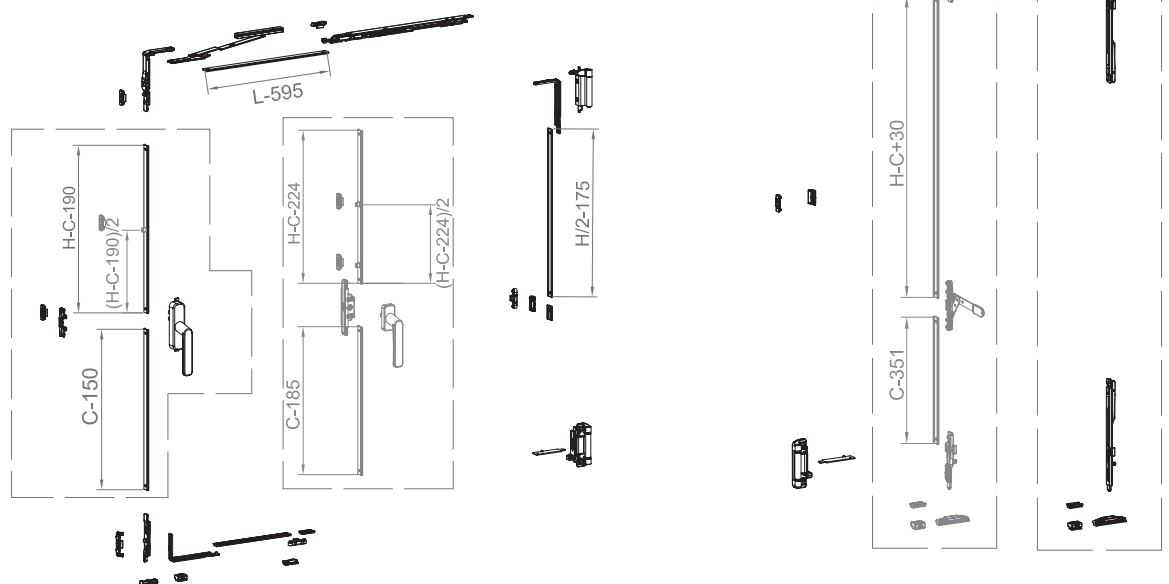

HERCULES 70 BORA ROLLO FRONT ROLLO TOP GLASS GLASS HARDWARE BESCHLÄG
 PREMIDOOR 76 KUBUS PASIV 82 STYLE 76 RONDO PERFORMER 74

Max. Weight per sash in accordance to dimensions

	SASH SIZE			Max weight (kg)
		Width (mm)	Height (mm)	
Door private use	min	650	2000	Up to 220 kg
	max	1800	3000	
Door public use  (aces people with reduced mobility)	min	840	2030	
	max	1800	3000	
Door sanitar use	min	1090	2030	
	max	1800	3000	
Door with antipanic	min	840	2030	
	max	1320	2500	

Door with antipanic (EN1125)





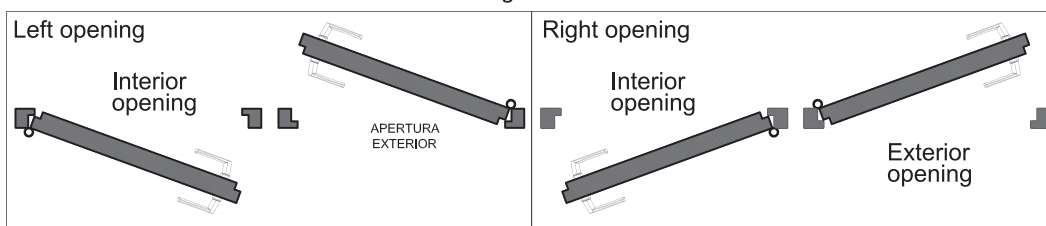

Door handle according to DIN 107
Choosing the hardware

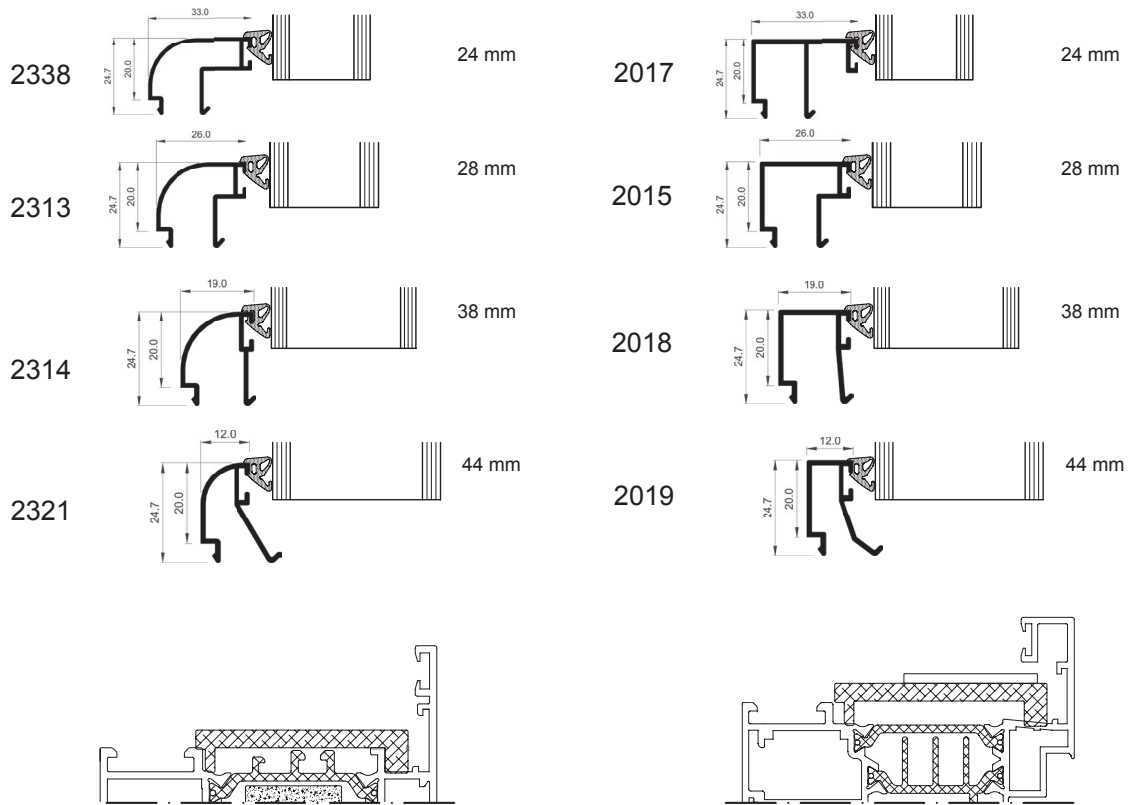

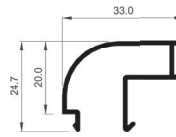
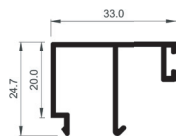
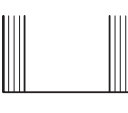
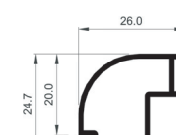
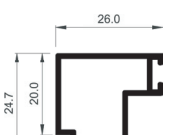
Glazing Beads / Glasleiste / Fermavetri / Baghete de fixare geam

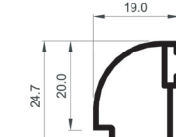
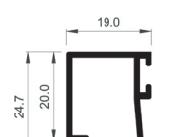

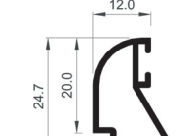
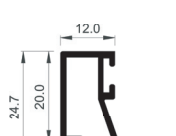
Glass / Glas / Vetro / Sticlă	Glazing bead / Glasleiste Fermavetro / Baghetă		Gasket / Dichtung Guarnizione / Garnitură
 24 mm	2338 	2017 	black
 28 mm	2313 	2015 	black
 38 mm	2314 	2018 	black
 44 mm	2321 	2019 	black