

INTERIOR WALL FRAMING CRITERIA NOTES

- ALL DIMENSIONS ARE TAKEN TO CENTERLINE OF COLUMN, FACE OF STUD, OR FACE OF CONCRETE, UNLESS OTHERWISE NOTED.
- CONTRACTOR SHALL VERIFY AND COORDINATE WALLS AND FRAMING THAT REQUIRE A NON-TYPICAL WALL THICKNESS DUE TO STRUCTURAL, ELECTRICAL, MECHANICAL, EQUIPMENT, OR OTHER REQUIREMENTS.
- WHERE EQUIPMENT OR CABINETS ARE SHOWN TO BE RECESSED IN, OR MOUNTED ON A 1-HOUR OR 2-HOUR RATED PARTITION, THE RATED ENCLOSURE SHALL BE CONSTRUCTED TO RUN CONTINUOUSLY BEHIND AND AROUND SUCH EQUIPMENT TO MAINTAIN THE REQUIRED FIRE RATING AND CAVITY DEPTH.
- PROTECT ALL PANELS, FIXTURES, AND OTHER PENETRATIONS IN RATED ASSEMBLIES TO MAINTAIN THE REQUIRED SEPARATION.
- PROVIDE CASING BEAD AT GYPSUM WALL BOARD EDGES WHEREVER GYPSUM BOARD ABUTS A DIFFERENT MATERIAL.
- PROVIDE BACKING PLATES FOR ALL WALL MOUNTED EQUIPMENT. VERIFY SPECIAL SUPPORT REQUIREMENTS WITH EQUIPMENT MANUFACTURER BEFORE INSTALLATION. VERIFY ALL MOUNTING HEIGHTS FOR BACKING PLATES AND SUPPORTS. WHERE BACKING PLATES ARE INSTALLED, FEATHER GYPSUM BOARD FINISH TO PROVIDE A SMOOTH, CONTINUOUS SURFACE.
- STEEL COLUMNS ENGAGED BY PARTITIONS SHALL BE FURRED WITH THE SAME MATERIAL AS THE ADJACENT WALLS UNLESS OTHERWISE NOTED.
- CURVED WALLS SHALL BE FRAMED WITH STUDS AT 12" O.C. MAX.
- PROVIDED BACKER ROD AND SEALANT AT ALL VERTICAL AND HORIZONTAL PRECAST JOINTS.

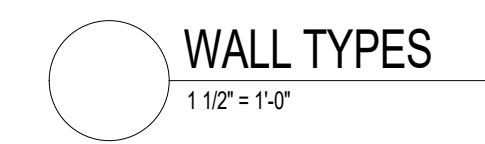

MARK	DATE	DESCRIPTION
SD	June 17, 2016	SCHEMATIC DESIGN
CD	November 20, 2016	PERMITS
CD	September 5, 2017	CONSTRUCTION DOCUMENTS (75%)
CD		OFFICIAL BID DOCUMENTS

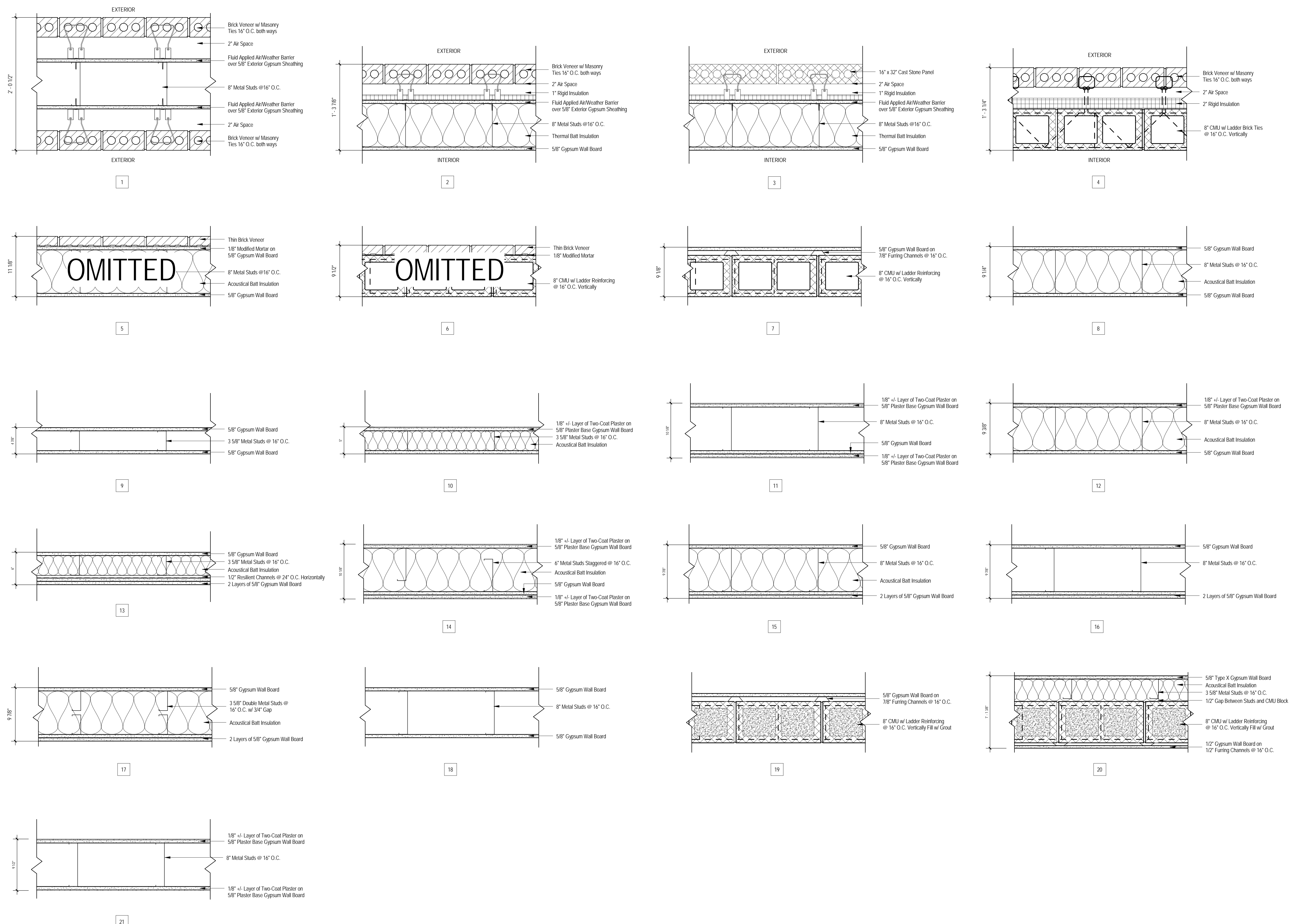

PROJECT NO. 2016111
 DRAWN BY: LAS
 CHECKED BY: MWT

Copyright © 2017
 PryorMorrow PC

WALL TYPES + FRAMING
 NOTES

A1.0
 SCALE: As indicated