

C330 Quick Setup Guide

1. Download App

1. Download "Doby" from App store for iPhone or Play store for Android phone.

- Make sure your smartphone is connected to the Wi-Fi router.
- Register to create an account and log in.
- Open the app and "Click "+" button on the bottom right corner to add camera."

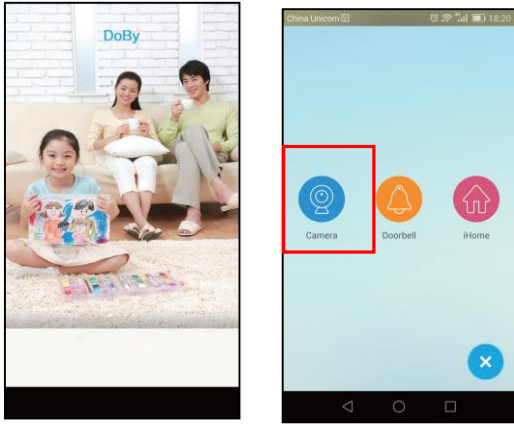

2. Turn on the Power

2. Turn on the power switch after removing the safety cover.

- Blue LED light should be blinking.
- If not, press and hold the WiFi key for about 5 seconds until the WiFi indicator blue light is blinking.

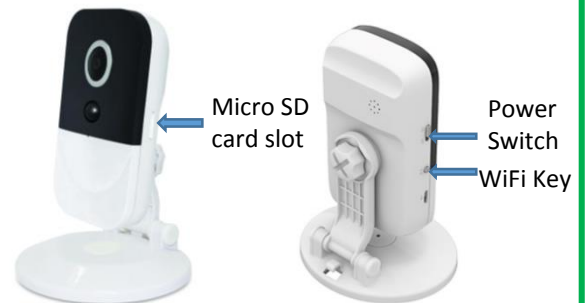

3. One Key WiFi Setup

3. While WiFi LED is blinking.

- Tap [Yes] to enter WiFi setup page.
- Tap on the searched camera.
- Enter WIFI Password.

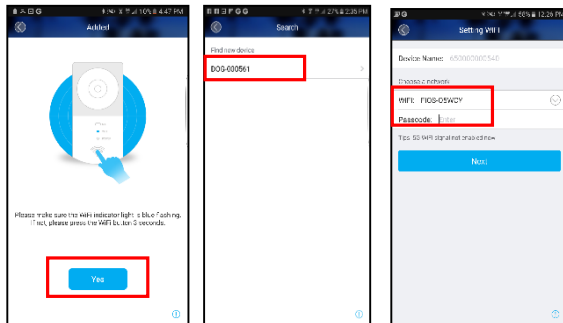

4. Live View

4. Tap on the camera from the list.

- Tap ▶ to play live view.
- Tap on Protection for alarm setting
- Tap on Playback to see recorded video.

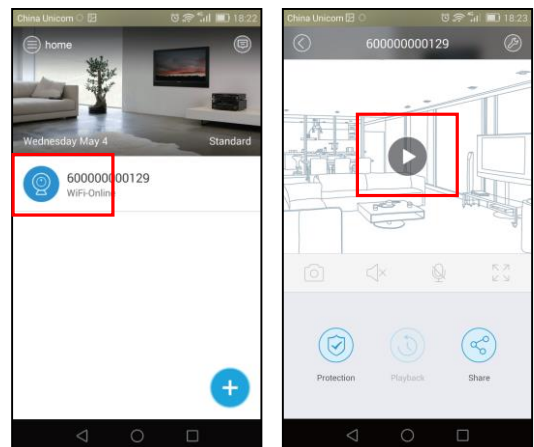

C330 Installation Guide

1. Content & Parts

1. Please make sure all parts are included.

- WiFi Camera with built-in battery
- Mounting Wall Bracket
- 3 x wall screws & 3 x expansion screw set
- USB Cable & Power Adapter
- 1 x mounting screw & 1 x plastic gasket



Parts & Description

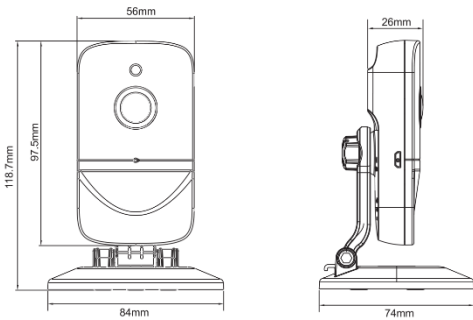

2. Charging Camera

2. Fully charge your camera before use.

- Connect the power cable to camera.
- For initial charging, the camera must be fully charged which takes about 4 hours.
- Turn on the power switch.
- The yellow LED light will be on to indicate that the battery is charged.



3. Bracket Assembly

3.1. Insert the clear plastic washer into camera mounting screw.



3.2. Set the mounting screw into bracket.



3.3. Tighten the mounting screw and adjust bracket angle to finish bracket assembly



3.4. If necessary, peel off the sticker from bottom of the mounting bracket to stabilize the camera.

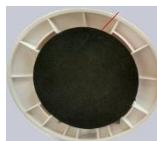

4. Wall Mount Installation

4.1. Drill holes on the wall and insert green expansion screws into the holes.

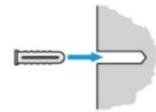

4.2. Remove screw cover and unscrew to detach the camera mounting base.

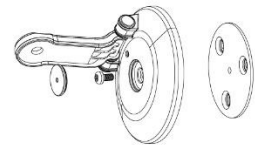

4.3. Align the holes of the mounting bracket with the expansion screws and secure the bracket.



4.4. Screw back the camera base. Adjust bracket angle to a desired position.

