

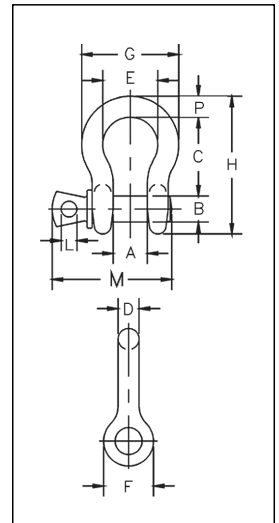

**S-209T
THEATRICAL
SHACKLE**

- Sizes: 3/8" through 3/4"
- Capacities: 1 through 4-3/4 metric tonnes.
- Forged - Quenched and Tempered, with alloy pins.
- Working Load Limit permanently shown on every shackle.
- Flat black baked on power coat finish.
- Fatigue Rated.
- Industry leading 6 to 1 design factor.
- Screw pin anchor shackles meet the performance requirement of Federal Specification RR-C-271F Type A, Grade A, Class 2, except for those provisions required of the contractor.
- Meets the performance requirements of EN 13889:2003.
- Meets or exceeds all requirements of ASME B30.26 including identification, ductility, design factor, proof load and temperature requirements. Importantly, these shackles meet other critical performance requirements including fatigue life, impact properties and material traceability, not addressed by ASME B30.26.



Load Rated®

Fatigue Rated®

"QT"
QUENCHED & TEMPERED

MAXTOUGH®

QUIC-CHECK®

SEE APPLICATION INFORMATION
On Page 92 of the Genral Catalog
Para Español: www.thecrosbygroup.com

S-209T Theatrical Shackles

Nominal Size (in.)	Working Load Limit (t)*	S-209T Stock No.	Weight Each (lbs.)	Dimensions (in.)											Tolerance +/-	
				A	B	C	D	E	F	G	H	L	M	P	C	A
3/8	1	1018706	.31	.66	.44	1.44	.38	1.03	.91	1.78	2.49	.25	2.02	.38	.13	.06
7/16	1-1/2	1018724	.38	.75	.50	1.69	.40	1.16	1.06	2.03	2.91	.31	2.37	.44	.13	.06
1/2	2	1018742	.72	.81	.63	.188	.50	1.31	1.19	2.31	3.28	.38	2.69	.50	.13	.06
5/8	3-1/4	1018760	1.37	1.06	.75	2.38	.63	1.69	1.50	2.94	4.19	.44	3.34	.69	.13	.06
3/4	4-3/4	1018778	2.35	1.25	.88	2.81	.75	2.00	1.81	3.50	4.97	.50	3.97	.81	.25	.06

* Minimum Ultimate Load is 5 times the Working Load Limit. Maximum Proof Load is 2.0 times the Working Load Limit.

S-209T... The "Crosby"

When you're looking for the top-named shackle used for theatrical and stage rigging applications, ask for a "Crosby"—the name synonymous with quality, safety and heavy lifting. The S-209T shackle is enhanced with a flat black baked-on power coat finish that causes the shackle to blend in with stage surroundings. This guarantees "behind-the-scene" strength and dependability without detracting the eye from on-stage action.

