



**G-209RP
ROV SHACKLE**
with "D" Style Handle
Shown



Scan our QR Code
with your smart
device to visit the
online flyer.

- Capacities from 8-1/2t through 55t.
- Forged Steel, Quenched & Tempered, with alloy pins.
- Handles are stainless steel.
- Shackles and bolts are available in both "D" and "F" designs.
- Working Load Limit permanently shown on every shackle.
- **QUIC-CHECK®** deformation and angle indicators forged on the bow.
- All ROV shackle bows are galvanized, then painted fluorescent yellow.
- Handles are painted fluorescent orange.
- New Interchangeable handles on ROV shackle bolts.
- "D" and "F" handle kits available containing handle, retaining bolts and individual packet of Loctite® for easy installation.
- Handles are **RFID EQUIPPED**.
- Look for the Red Pin® . . . the mark of genuine Crosby quality.

NOTE: ROV Hooks available on page 130 and 131.

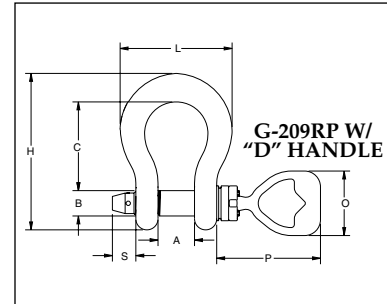
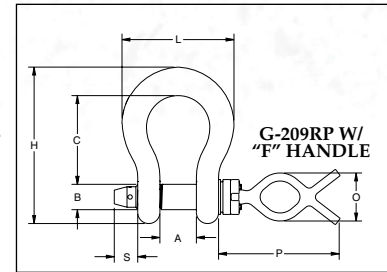

Load Rated®

"QT"
QUENCHED & TEMPERED

CE



QUIC-CHECK®

SEE APPLICATION INFORMATION

On Page 92 of the General Catalog
Para Español: www.thecrosbygroup.com

G-209RP ROV Shackles with "D" or "F" Style Handle

Working Load Limit (t)*	G-209RP with "F" Style Handle Dimensions (in.)										G-209RP with "D" Style Handle Dimensions (in.)									
	Weight Each (lbs.)	A +/-	B	C +/-	H	L	O	P	S	T	Weight Each (lbs.)	A +/-	B	C +/-	H	L	O	P	S	T
8-1/2	7.7	.06	1.13	.25	6.56	4.69	3.79	8.66	1.23	0.63	8.3	.06	1.13	.25	6.56	4.69	5.09	7.25	1.23	0.63
9-1/2	9.8	.06	1.25	.25	7.47	5.16	3.79	8.66	1.23	0.63	10.4	.06	1.25	.25	7.47	5.16	5.09	7.25	1.23	0.63
12	12.4	.06	1.38	.25	8.25	5.75	3.79	8.66	1.30	0.63	12.9	.06	1.38	.25	8.25	5.75	5.09	7.25	1.30	0.63
13-1/2	15.6	.13	1.50	.25	9.16	6.38	3.79	8.66	1.40	0.63	16.2	.13	1.50	.25	9.16	6.38	5.09	7.25	1.40	0.63
17	18.5	.13	1.63	.25	10.00	6.88	3.79	9.60	1.79	0.63	19.1	.13	1.63	.25	10.00	6.88	5.09	8.19	1.79	0.63
25	34.1	.13	2.00	.25	12.34	8.80	3.79	9.60	1.85	0.63	34.7	.13	2.00	.25	12.34	8.80	5.09	8.19	1.85	0.63
35	48.5	.13	2.25	.25	13.68	10.15	3.79	9.78	1.94	0.63	49.1	.13	2.25	.25	13.68	10.15	5.09	8.37	1.94	0.63
55	95.2	.25	2.75	.25	17.90	12.74	3.79	10.16	2.06	0.63	95.8	.25	2.75	.25	17.90	12.74	5.09	8.75	2.06	0.63

* Minimum Ultimate Load is 5 times the Working Load Limit. * NOTE: Maximum Proof Load is 2.0 times the Working Load Limit.



WLL: 8.5-13.5t

WLL: 17-55t



G-4209R-"F" Handle

G-4209R-"D" Handle



G-4209RFB



G-4209RDB

G-209RP Bows with Pin. G-4209 Handles and Pin Assemblies

Working Load Limit (t)*	G-209RP Bow with Pin (less Handle)		G-4209R Handle Only				G-4209RFB "F" Pin Assembly		G-4209RDB "D" Pin Assembly	
	Stock No.	Weight Each (lbs)	"F" Handle Stock No.	Weight Each (lbs.)	"D" Handle Stock No.	Weight Each (lbs.)	Stock No.	Weight Each (lbs.)	Stock No.	Weight Each (lbs.)
8-1/2	1021200	1.2	1021085	2.8	1021094	3.5	1020638	4.0	1020816	4.7
9-1/2	1021208	1.7					1020647	4.5	1020825	5.2
12	1021217	2.2					1020656	5.0	1020834	5.7
13-1/2	1021226	2.9					1020665	5.7	1020843	6.4
17	1021235	5.1					1020674	7.9	1020852	8.6
25	1021244	8.0					1020683	10.8	1020861	11.4
35	1021253	11.2					1020692	14.0	1020870	14.6
55	1021262	21.2					1020709	24.0	1020889	24.6

* Minimum Ultimate Load is 5 times the Working Load Limit. * NOTE: Maximum Proof Load is 2.0 times the Working Load Limit.

HOW TO ORDER: Crosby ROV shackles are designed in a way to allow multiple handle styles to be used with each size of shackles bow. To ensure the proper components are selected, please use the following steps.

STEP 1 - Determine the Working Load Limit (WLL) of the desired shackle.

STEP 2 - Select the G-209RP bow with pin (less handle) that corresponds to the desired WLL.

STEP 3 - Select the G-4209R handle that best meets your requirements.

STEP 4 - When placing the order through your local authorized Crosby dealer, reference the corresponding stock numbers associated with the items selected in Steps 2 and 3 above.