



A-1360B
Bail

A-1360B Bail

Chain Size		Frame Size	A-1360B Stock No.	Weight Each (lbs.)	Dimensions (in.)				S-4103 Replacement Hinge Pin Kit Stock No.
(in.)	(mm)				Inside Length	Inside Width	Jaw Width	Deformation Indicator	
1/4 - 5/16	7 - 8	2	1049626	2.1	3.88	3.00	.94	3.50	1092916
3/8	10	3	1049635	3.7	4.81	3.50	1.13	4.00	1092925
1/2	13	4	1049644	7.4	6.00	4.13	1.31	5.00	1092934
5/8	16	5	1049653	13.0	6.88	4.75	1.63	6.00	1092943



A-1360S
Single Hook

A-1360S Single Hook (Shown with optional S-4104 Latch Pin)

Chain Size		Frame Size	Working Load Limit (lbs.)*	A-1360S Stock No.	L-1360S Stock No.	Weight Each (lbs.)	S-4100 Replacement Load Pin Kit Stock No.
(in.)	(mm)						
1/4	7	2	4300	1049671	1049790	1.8	1091801
5/16	8	2	5700	1049680	1049799	1.8	1091810
3/8	10	3	8800	1049699	1049808	2.8	1091829
1/2	13	4	15000	1049706	1049817	6.1	1091838
5/8	16	5	22600	1049715	1049826	11.1	1091847

* Ultimate Load is 4 times the Working Load Limit.



A-1360D
Double Hook

A-1360D Double Hook (Shown with optional S-4104 Latch Pin)

Chain Size		Frame Size	Working Load Limit (lbs.)*	A-1360D Stock No.	L-1360D Stock No.	Weight Each (lbs.)	S-4102 Replacement Load Pin Kit Stock No.
(in.)	(mm)						
1/4	7	2	8600	1049733	1049838	2.6	1092713
5/16	8	2	11400	1049742	1049847	2.6	1092722
3/8	10	3	17600	1049751	1049856	4.4	1092731
1/2	13	4	30000	1049760	1049865	9.9	1092740
5/8	16	5	45200	1049779	1049874	18.5	1092759

* Ultimate Load is 4 times the Working Load Limit.

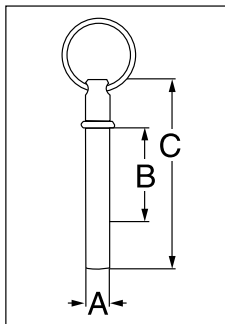

S-4104N
Latch Pin

S-4104N Latch Pin • The new style S-4104N latch pin is colored yellow zinc. • The old style S-4104 latch pin is colored silver zinc.

Chain Size		Frame Size	S-4104N Stock No.	Weight Each (lbs.)	Dimensions (in.)		
(in.)	(mm)				A	B	C
1/4 - 5/16	7 - 8	2	1092983	.06	.313	1.36	2.58
3/8	10	3	1092992	.10	.313	1.62	3.08
1/2	13	4	1093001	.12	.313	1.83	3.83
5/8	16	5	1093010	.15	.313	2.21	4.59