

Grade 100 Alloy Master Links

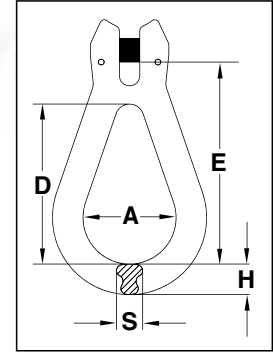

A-1370
Reeving Link

- Alloy Steel - Quenched and Tempered.
- Individually proof tested to 2.5 times the Working Load Limit.
- Proof test certification shipped with each link.
- Each link has a Product Identification Code (PIC) for material traceability, along with the size and the name Crosby in raised letters.
- Suitable for use with Grade 100 and Grade 80 chain.
- “Look for the Platinum Color - Crosby Grade 100 Alloy Products.”



A-1370 Reeving Link

Chain Size		Working Load Limit (t)	A-1370 Stock No.	Weight Each (kg)	Dimensions (mm)				
(in.)	(mm)				A	D	E	H	S
1/4-5/16	7-8	2.5	1012000	.26	39.0	67.5	90.0	16.0	10.0
3/8	10	4.0	1012009	.50	49.0	85.5	108	17.0	14.0
1/2	13	6.8	1012018	1.10	62.5	108	138	21.0	18.0
5/8	16	10.3	1012027	2.55	79.0	139	180	30.5	25.5



A-1348
Eye Cradle
Grab Hook

- Alloy Steel - Quenched and Tempered.
- Forged Alloy Steel - Quenched and Tempered.
- Innovative cradle design allows for 100% efficiency of Grade 100 chain.
- Individually Proof Tested to 2-1/2 times the Working Load Limit with certification.
- Each hook has a Product Identification Code (PIC) for material traceability, along with the size and the name Crosby in raised letters.
- Suitable for use with Grade 100 and Grade 80 chain.
- The use of A-1348 Cradle Grab Hook will allow 100% percent of the chain sling capacity. When used to hook back to chain leg to form a choker, the angle of the choke must be 120 degrees or greater. When used as a chain shortener, minimize twist of chain and ensure chain is fully engaged in hook.
- Fatigue rated at 1-1/2 times the Working Load Limit at 20,000 cycles.
- “Look for the Platinum Color - Crosby Grade 100 Alloy Products.”

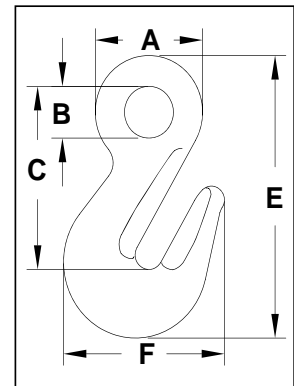

A-1348 Eye Cradle Grab Hook

Chain Size		Working Load Limit (t)*	A-1348 Stock No.	Weight Each (kg)	Dimensions (mm)				
(in.)	(mm)				A	B	C	E	F
1/4-5/16	7-8	2.5	1026200	.35	36.3	16.5	64.0	98.2	58.2
3/8	10	4.0	1026209	.64	49.5	26.0	78.0	120	68.8
1/2	13	6.8	1026218	.87	62.0	29.0	97.0	146	82.4
5/8	16	10.3	1026227	2.83	79.0	36.0	126.5	196	111.8

* Minimum Ultimate Load is 4 times the Working Load Limit based on single leg sling.