

Crosby®/ Bullard® Golden Gate® Hooks

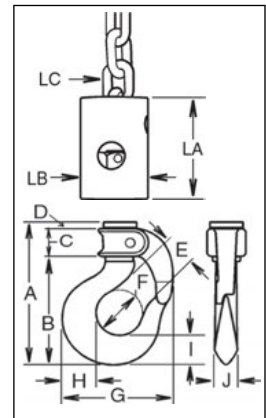

Link Chain Nest

- With ball bearing swivel; attaches to chain by an alloy pin.
 - **BL-O** - with Self-Closing Gate
 - **BL-P** - with Manual Closing Gate
- Suitable for frequent rotation under load.
- Use in corrosive environment requires shank and nut inspection in accordance with ASME B30.9-1.10.4(b)(5)(c)2014.
- Crosby®/Bullard® Hooks incorporate two types of strategically placed markings forged into the product which address two (2) **QUIC-CHECK®** features:
 - Angle Indicators and Deformation Indicators (see the Bullard® **QUIC-CHECK®** table at bottom of page 129 for detailed definition).



Link Chain Nest

Hook Size	BL-O Stock No.	BL-P Stock No.	Gate Type	Working Load Limit (t)*	Weight Each (kg)	Dimensions (mm)												
						A	B	C	D	E	F	G	H	I	J	LA	LB	LC
4:1/4-9/32	1051409	1051508	PIN-LOK	1.5	1.13	124	92.2	25.4	5.58	28.7	38.1	92.0	29.5	25.4	19.1	67.0	44.5	6.35-7.15
5:5/16-3/8	1051442	1051541	ROLLOX	2.1	2.04	143	105	31.2	6.35	31.8	41.7	104	33.3	28.4	21.3	76.0	57.0	7.95-9.50
7:3/8-7/16	1051464	1051563	ROLLOX	3.8	5.0	168	132	28.4	6.35	38.1	51.0	125	41.4	36.6	28.7	111	76.0	9.50-11.1
7:1/2-9/16	1051486	1051585	ROLLOX	3.8	5.0	168	132	28.4	6.35	38.1	51.0	125	41.4	36.6	28.7	111	76.0	12.7-14.3

*Ultimate Load is 4 times the Working Load Limit.



Roller Chain Nest

- Attachment with ball-bearing swivel and full-floating connector.
 - **BL-S** - with Self-Closing Gate
 - **BL-R** - with Manual Closing Gate
- Suitable for frequent rotation under load.
- Use in corrosive environment requires shank and nut inspection in accordance with ASME B30.9-1.10.4(b)(5)(c)2014.
- Crosby®/Bullard® Hooks incorporate two types of strategically placed markings forged into the product which address two (2) **QUIC-CHECK®** features:
 - Angle Indicators and Deformation Indicators (see the Bullard® **QUIC-CHECK®** table at bottom of page 129 for detailed definition).

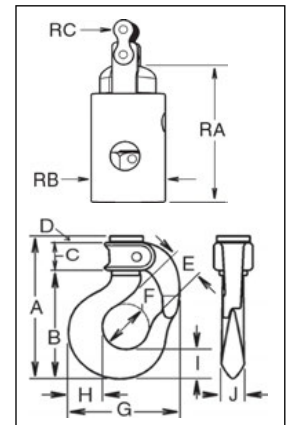

Roller Chain Nest

Hook Size	BL-S Stock No.	BL-R Stock No.	Gate Type	Working Load Limit (t)*	Weight Each (kg)	Dimensions (mm)												
						A	B	C	D	E	F	G	H	I	J	RA	RB	RC
4 :#50	1051310	1051200	PIN-LOK	.68	1.32	124	92.2	25.4	5.58	28.7	38.1	92.0	29.5	25.4	19.1	89.5	44.5	15.9
5 :#60	1051321	1051211	ROLLOX	1.13	2.36	143	105	31.2	6.35	31.8	41.7	104	33.3	28.4	21.3	108	54.0	19.1
6 :#60	1051332	1051222	ROLLOX	1.13	2.81	158	119	31.8	6.35	35.3	41.7	116	39.9	34.0	24.6	108	54.0	19.1

*Ultimate Load is 4 times the Working Load Limit.