

Horizontal Clamps

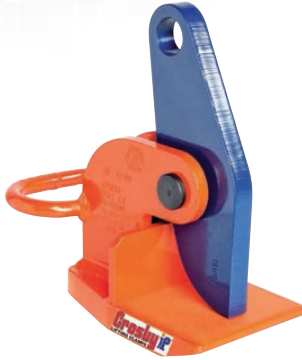

IPH10E

The IPH10E / IPH10JE horizontal lifting clamps are for use in the lifting and transfer in horizontal position of non-sagging materials or of bundles of non-sagging material. These clamps must be used in pairs or more.

For Horizontal Lifting and Transfer

- Available in capacities of .75 thru 25 metric tons.
- Wide variety of jaw openings available: 0" to 4.73"
- Welded alloy steel body for strength and smaller size. Forged alloy, components where required.
- Equipped with handle for easy placement.
- Individually Proof Tested to 2 times the Working Load Limit with certification.
- Company name (CrosbyIP), logo, Working Load Limit and jaw opening permanently stamped on body.
- Each product is individually serialized, with the serial number and Proof Load test date stamped on body. User manual with test certificate is included with each clamp.
- Maintenance replacement parts are available.
- Manufactured by an ISO 9001 facility.
- All sizes are **RFID EQUIPPED**.

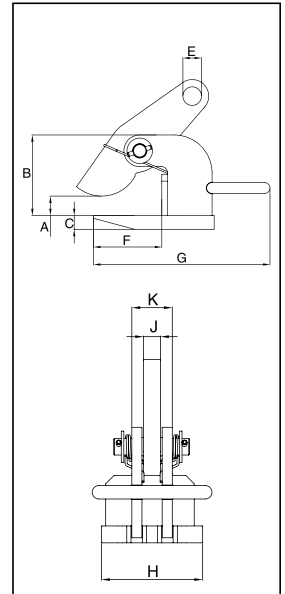

Model IPH10E: Jaw opening range 0 to 2.36"

| Model | Working Load Limit (Per Pair) (t)* | IPH10E Stock No. | Weight Each (lbs.) | Dimensions (in) | | | | | | | | |
|----------|------------------------------------|------------------|--------------------|-----------------|------|------|------|------|-------|------|------|------|
| | | | | Jaw A | B | C | E | F | G | H | J | K |
| IPH10E | 2 | 2703542 | 12.1 | 0 - 2.36 | 4.61 | .63 | .87 | 4.29 | 10.1 | 4.33 | .79 | 1.58 |
| IPH10E | 3 | 2703543 | 16.5 | 0 - 2.36 | 4.61 | .79 | 1.02 | 4.29 | 10.5 | 4.73 | .79 | 1.89 |
| IPH10E | 4.5 | 2703544 | 23.2 | 0 - 2.36 | 5.20 | .99 | 1.18 | 4.10 | 11.0 | 5.12 | .79 | 1.89 |
| IPH10E | 6 | 2703545 | 28.7 | 0 - 2.36 | 5.63 | .99 | 1.42 | 4.85 | 12.6 | 5.12 | .79 | 1.89 |
| IPH10E | 9 | 2703546 | 40.8 | 0 - 2.36 | 6.19 | 1.18 | 1.69 | 5.24 | 13.0 | 5.52 | .99 | 2.44 |
| IPH10E | 12 | 2703547 | 47.4 | 0 - 2.36 | 6.78 | 1.18 | 1.85 | 5.56 | 13.9 | 5.91 | .99 | 2.44 |
| **IPH10Z | 25 | 2705119 | 86.0 | 0 - 2.38 | 6.65 | 1.57 | 1.85 | 6.69 | 11.81 | 8.66 | 1.26 | .87 |

* Design Factor based on EN 13155 and ASME B30.20. **Without handle.

Model IPH10JE: Jaw opening range 2.36 to 4.73"

| Model | Working Load Limit (Per Pair) (t)* | IPH10JE Stock No. | Weight Each (lbs.) | Dimensions (in) | | | | | | | | | |
|---------|------------------------------------|-------------------|--------------------|-----------------|------|------|------|------|------|------|-----|------|-----|
| | | | | Jaw A | B | C | E | F | G | H | J | K | L |
| IPH10JE | 3 | 2703553 | 19.8 | 2.36 - 4.73 | 6.97 | .79 | 1.02 | 4.29 | 10.5 | 4.73 | .79 | 1.89 | .43 |
| IPH10JE | 4.5 | 2703554 | 26.5 | 2.36 - 4.73 | 7.56 | .99 | 1.18 | 4.10 | 11.0 | 5.12 | .79 | 1.89 | .47 |
| IPH10JE | 6 | 2703555 | 33.0 | 2.36 - 4.73 | 8.00 | .99 | 1.42 | 4.85 | 12.6 | 5.12 | .79 | 1.89 | .55 |
| IPH10JE | 9 | 2703556 | 45.2 | 2.36 - 4.73 | 8.55 | 1.18 | 1.69 | 5.24 | 13.0 | 5.52 | .99 | 2.44 | .63 |
| IPH10JE | 12 | 2703557 | 25.9 | 2.36 - 4.73 | 9.14 | 1.18 | 1.85 | 5.56 | 13.9 | 5.91 | .99 | 2.44 | .67 |

* Design Factor based on EN 13155 and ASME B30.20.

