



TRAFFIC CRASH REPORT

LOCAL REPORT NUMBER *

162416

CRASH SEVERITY
1 - FATAL
2 - INJURY
3 - PDOHIT/SKIP
1 - SOLVED
2 - UNSOLVED

LOCAL INFORMATION

☐ PHOTOS TAKEN
☐ OH-2 ☐ OH-1P
☐ OH-3 ☐ OTHER☐ PDO UNDER STATE REPORTABLE DOLLAR AMOUNT☐ PRIVATE PROPERTYREPORTING AGENCY NCIC *
06703REPORTING AGENCY NAME *
KENT POLICENUMBER OF UNITS
01UNIT IN ERROR
98 - ANIMAL
99 - UNKNOWNCOUNTY *
67CITY *
☐ VILLAGE *
☐ TOWNSHIP *CITY, VILLAGE, TOWNSHIP *
KENT

CRASH DATE *

01292016

TIME OF CRASH

0830

DAY OF WEEK

FRI

DEGREES / MINUTES / SECONDS

LATITUDE
40° 0' 0" N

LONGITUDE

DECIMAL DEGREES

LATITUDE
41.42864

LONGITUDE

-81.384319

ROADWAY DIVISION
☐ DIVIDED
☐ UNDIVIDEDDIVIDED LANE DIRECTION OF TRAVEL
N - NORTHBOUND E - EASTBOUND
S - SOUTHBOUND W - WESTBOUNDNUMBER OF THRU LANES
02ROAD TYPES OR MILEPOST²
AL - ALLEY CR - CIRCLE
AV - AVENUE CT - COURT
BL - BOULEVARD DR - DRIVEHE - HEIGHTS MP - MILEPOST PL - PLACE ST - STREET WA - WAY
HW - HIGHWAY PK - PARKWAY RD - ROAD TE - TERRACE
LA - LANE PI - PIKE SQ - SQUARE TL - TRAILLOCATION ROUTE TYPE¹
LOCATION ROUTE NUMBER
LOC PREFIX
N, S, E, WLOCATION ROAD NAME
MUNROE FALLS KENTLOCATION ROAD TYPE²
RDROUTE TYPES¹
IR - INTERSTATE ROUTE (INC. TURNPIKE) CR - NUMBERED COUNTY ROUTE
US - US ROUTE TR - NUMBERED TOWNSHIP ROUTE
SR - STATE ROUTEDISTANCE FROM REFERENCE
50
☐ MILES
☐ FEET
☐ YARDSDIR FROM REF
N, S, E, W
EREFERENCE ROUTE TYPE¹
REFERENCE ROUTE NUMBERREFERENCE NAME (ROAD, MILEPOST, HOUSE #)
YACAVONA RREFERENCE ROAD TYPE²
DRREFERENCE POINT USED
1 - INTERSECTION
2 - MILE POST
3 - HOUSE NUMBERCRASH LOCATION
0101 - NOT AN INTERSECTION 06 - FIVE-POINT, OR MORE 11 - RAILWAY GRADE CROSSING
02 - FOUR-WAY INTERSECTION 07 - ON RAMP 12 - SHARED-USE PATHS OR TRAILS
03 - T-INTERSECTION 08 - OFF RAMP 99 - UNKNOWN
04 - Y-INTERSECTION 09 - CROSSOVER
05 - TRAFFIC CIRCLE/ROUNDBOAT 10 - DRIVEWAY/ALLEY ACCESS☐ INTERSECTION RELATED

LOCATION OF FIRST HARMFUL EVENT

2 1 - ON ROADWAY 5 - ON GORE
2 - ON SHOULDER 6 - OUTSIDE TRAFFICWAY
3 - IN MEDIAN 9 - UNKNOWN
4 - ON ROADSIDEROAD CONTOUR
3 1 - STRAIGHT LEVEL 4 - CURVE GRADE
2 - STRAIGHT GRADE 9 - UNKNOWN
3 - CURVE LEVELROAD CONDITIONS
PRIMARY
03

SECONDARY

01 - DRY 05 - SAND, MUD, DIRT, OIL, GRAVEL 09 - RUT, HOLES, BUMPS, UNEVEN PAVEMENT*
02 - WET 06 - WATER (STANDING, MOVING) 10 - OTHER
03 - SNOW 07 - SLUSH 99 - UNKNOWN
04 - ICE 08 - DEBRIS*

* SECONDARY CONDITION ONLY

MANNER OF CRASH COLLISION/IMPACT

1 1 - NOT COLLISION BETWEEN TWO MOTOR VEHICLES IN TRANSPORT 2 - REAR-END 5 - BACKING 8 - SIDESWIPE, OPPOSITE DIRECTION
3 - HEAD-ON 6 - ANGLE 9 - UNKNOWN
4 - REAR-TO-REAR 7 - SIDESWIPE, SAME DIRECTION

WEATHER

6 1 - CLEAR 4 - RAIN 7 - SEVERE CROSSWINDS
2 - CLOUDY 5 - SLEET, HAIL 8 - BLOWING SAND, SOIL, DIRT, SNOW
3 - FOG, SMOG, SMOKE 6 - SNOW 9 - OTHER/UNKNOWNROAD SURFACE
2 1 - CONCRETE 4 - SLAG, GRAVEL, STONE
2 - BLACKTOP, BITUMINOUS, ASPHALT 5 - DIRT
3 - BRICK/BLOCK 6 - OTHERLIGHT CONDITIONS
1 PRIMARYSECONDARY
1 - DAYLIGHT 2 - DAWN 3 - DUSK 4 - DARK - LIGHTED ROADWAY 5 - DARK - ROADWAY NOT LIGHTED 9 - UNKNOWN
6 - DARK - UNKNOWN ROADWAY LIGHTING 7 - GLARE* 8 - OTHER

* SECONDARY CONDITION ONLY

☐ SCHOOL ZONE RELATEDSCHOOL BUS RELATED
☐ YES, SCHOOL BUS DIRECTLY INVOLVED
☐ YES, SCHOOL BUS INDIRECTLY INVOLVED☐ WORK ZONE RELATED
☐ WORKERS PRESENT
☐ LAW ENFORCEMENT PRESENT (OFFICER/VEHICLE)
☐ LAW ENFORCEMENT PRESENT (VEHICLE ONLY)

TYPE OF WORK ZONE

1 - LANE CLOSURE 2 - LANE SHIFT/CROSSOVER 3 - WORK ON SHOULDER OR MEDIAN
4 - INTERMITTENT OR MOVING WORK 5 - OTHER

LOCATION OF CRASH IN WORK ZONE

1 - BEFORE THE FIRST WORK ZONE WARNING SIGN 4 - ACTIVITY AREA
2 - ADVANCE WARNING AREA 5 - TERMINATION AREA
3 - TRANSITION AREA

NARRATIVE

UNIT 1 WAS EAST ON MUNROE FALLS DRIVER OF KENT RD. UNIT 1 FAILED TO CONTROL UNIT 1 AND DROVE OFF THE RIGHT SIDE OF THE ROAD INTO A TREE. DRIVER OF UNIT 1 STATED SHE WAS UNFAMILIAR WITH THE ROAD AND TOOK THIS ROUTE AS AN ALTERNATIVE ROUTE TO KENT STATE UNIVERSITY. THE ROAD WAS SNOW COVERED. UNIT 1 TRAVELED AT A SPEED THAT DID NOT ALLOW CONTROL TO BE MAINTAINED.

REPORT TAKEN BY
☐ POLICE AGENCY ☐ MOTORIST☐ SUPPLEMENT (CORRECTION OR ADDITION TO AN EXISTING REPORT SENT TO ODPs)DATE CRASH REPORTED
01292016TIME CRASH REPORTED
0832DISPATCH TIME
0835ARRIVAL TIME
0840TIME CLEARED
0922OTHER INVESTIGATION TIME
20T
67

OFFICER'S NAME *

Wheeler

OFFICER'S BADGE NUMBER

243

CHECKED BY

243

PAGE 1 OF 3

Diagram

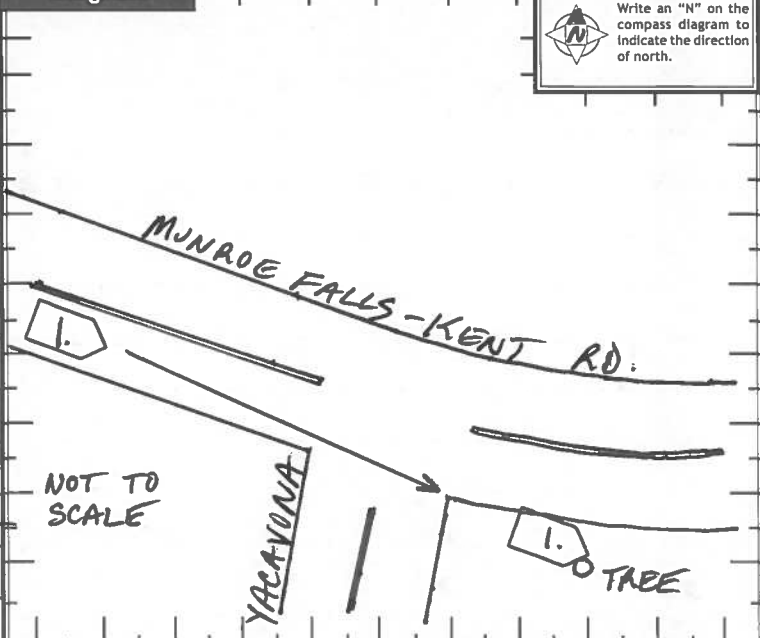

Write an "N" on the compass diagram to indicate the direction of north.



Unit

Local Report Number

162416

Unit Number 01	Owner Name: Last, First, Middle (<input type="checkbox"/> Same As Driver) BRADY DOUGLAS E	Owner Phone Number - inc. area code (<input type="checkbox"/> Same As Driver) 330 808 4553	Damage Scale 4	Damaged Area
Owner Address: City, State, Zip (<input type="checkbox"/> Same As Driver) 4553 BLISS DR. NORTON OH 44203			1 - None	
LP State OH	License Plate Number DFE2859	Vehicle Identification Number 1C3EL46U61N669879	2 - Minor	
Vehicle Year 2001	Vehicle Make CAR	Vehicle Model SEBRING	3 - Functional	
Vehicle Color BLUE	Proof of Insurance Shown <input type="checkbox"/>	Insurance Company STATE FARM	4 - Disabling	
Policy Number 1703690E2835L	Towed By PLAZA	9 - Unknown		
Carrier Name, Address, City, State, Zip			Carrier Phone- include area code	
US DOT	Vehicle Weight GVWR/GCWR 1 1 - Less Than or Equal to 10k Lbs. 2 - 10,001 to 26,000 Lbs. 3 - More Than 26,000 Lbs.	Cargo Body Type 01 01 - No Cargo Body Type/Not Applicable 02 - Bus/Van (9-15 Seats, Inc Driver) 03 - Bus (16+ Seats, Inc Driver) 04 - Vehicle Towing Another Vehicle 05 - Logging 06 - Intermodal Container Chassis 07 - Cargo Van/Enclosed Box 08 - Grain, Chips, Gravel	Trafficway Description 1 1 - Two-Way, Not Divided 2 - Two-Way, Not Divided, Continuous Left Turn Lane 3 - Two-Way, Divided, Unprotected (Painted or Grass > 4 Ft.) Median 4 - Two-Way, Divided, Positive Median Barrier 5 - One-Way Trafficway	
HM Placard ID No.	HM Class Number	Hazardous Material Released <input type="checkbox"/>	<input type="checkbox"/> Hit / Skip Unit	
Non-Motorist Location Prior to Impact 01 01 - Intersection - Marked Crosswalk 02 - Intersection - No Crosswalk 03 - Intersection - Other 04 - Midblock - Marked Crosswalk 05 - Travel Lane - Other Location 06 - Bicycle Lane 07 - Shoulder/Roadside 08 - Sidewalk 09 - Median/Crossing Island 10 - Driveway Access 11 - Shared-Use Path or Trail 12 - Non-Trafficway Area 99 - Other/Unknown		Type of Use 1 1 - Personal 2 - Commercial 3 - Government <input type="checkbox"/> In Emergency Response	Unit Type 04 99 - Unknown or Hit / Skip Passenger Vehicles (less than 9 passengers) 01 - Sub-Compact 02 - Compact 03 - Mid Size 04 - Full Size 05 - Minivan 06 - Sport Utility Vehicle 07 - Pickup 08 - Van 09 - Motorcycle 10 - Motorized Bicycle 11 - Snowmobile/ATV 12 - Other Passenger Vehicle Med/Heavy Trucks or Combo Units > 10k lbs 13 - Single Unit Truck or Van 2axle, 6 tires 14 - Single Unit Truck; 3+ axles 15 - Single Unit Truck / Trailer 16 - Truck/Tractor (Bobtail) 17 - Tractor/Semi-Trailer 18 - Tractor/Double 19 - Tractor/Triples 20 - Other Med/Heavy Vehicle Bus/Van/Limo (9 or More Including Driver) 21 - Bus/Van (9-15 Seats, Inc Driver) 22 - Bus (16+ Seats, Inc Driver) Non-Motorist 23 - Animal with Rider 24 - Animal with Buggy, Wagon, Surrey 25 - Bicycle/Pedacyclist 26 - Pedestrian/Skater 27 - Other Non-Motorist	
Special Function 01 01 - None 02 - Taxi 03 - Rental Truck (Over 10k Lbs) 04 - Bus - School (Public or Private) 05 - Bus - Transit 06 - Bus - Charter 07 - Bus - Shuttle 08 - Bus - Other	09 - Ambulance 10 - Fire 11 - Highway/Maintenance 12 - Military 13 - Police 14 - Public Utility 15 - Other Government 16 - Construction Equip.	17 - Farm Vehicle 18 - Farm Equipment 19 - Motorhome 20 - Golf Cart 21 - Train 22 - Other (Explain in Narrative)	Most Damaged Area 02 Impact Area 02	Action 3 1 - Non-Contact 2 - Non-Collision 3 - Striking 4 - Struck 5 - Striking/Struck 9 - Unknown
Pre-Crash Actions 13 99 - Unknown Motorist 01 - Straight Ahead 02 - Backing 03 - Changing Lanes 04 - Overtaking/Passing 05 - Making Right Turn 06 - Making Left Turn 07 - Making U-Turn 08 - Entering Traffic Lane 09 - Leaving Traffic Lane 10 - Parked 11 - Slowing or Stopped in Traffic 12 - Driverless 13 - Negotiating a Curve 14 - Other Motorist Action Non-Motorist 15 - Entering or Crossing Specified Location 16 - Walking, Running, Jogging, Playing, Cycling 17 - Working 18 - Pushing Vehicle 19 - Approaching or Leaving Vehicle 20 - Standing 21 - Other Non-Motorist Action				
Contributing Circumstances Primary 17 01 - None 02 - Failure to Yield 03 - Ran Red Light 04 - Ran Stop Sign 05 - Exceeded Speed Limit 06 - Unsafe Speed 07 - Improper Turn 08 - Left of Center 09 - Followed Too Closely/ACDA 10 - Improper Lane Change /Passing/Off Road 11 - Improper Backing 12 - Improper Start From Parked Position 13 - Stopped or Parked Illegally 14 - Operating Vehicle in Negligent Manner 15 - Swerving to Avoid (Due to External Conditions) 16 - Wrong Side/Wrong Way 17 - Failure to Control 18 - Vision Obstruction 19 - Operating Defective Equipment 20 - Load Shifting/Falling/Spilling 21 - Other Improper Action Non-Motorist 22 - None 23 - Improper Crossing 24 - Darting 25 - Lying and/or Illegally in Roadway 26 - Failure to Yield Right of Way 27 - Not Visible (Dark Clothing) 28 - Inattentive 29 - Failure to Obey Traffic Signs /Signals/Officer 30 - Wrong Side of the Road 31 - Other Non-Motorist Action			Vehicle Defects 01 01 - Turn Signals 02 - Head Lamps 03 - Tail Lamps 04 - Brakes 05 - Steering 06 - Tire Blowout 07 - Worn or Slick tires 08 - Trailer Equipment Defective 09 - Motor Trouble 10 - Disabled From Prior Accident 11 - Other Defects	
Sequence of Events 1 08 2 48 3 01 4 01 5 01 6 01 First Harmful Event 1 Most Harmful Event 2 99 - Unknown Collision with Person, Vehicle or Object Not Fixed 14 - Pedestrian 15 - Pedalcycle 16 - Railway Vehicle (Train, Engine) 17 - Animal - Farm 18 - Animal - Deer 19 - Animal - Other 20 - Motor Vehicle in Transport 21 - Parked Motor Vehicle 22 - Work Zone Maintenance Equipment 23 - Struck by Falling, Shifting Cargo or Anything Set in Motion by a Motor Vehicle 24 - Other Movable Object Collision With Fixed Object 25 - Impact Attenuator/Crash Cushion 26 - Bridge Overhead Structure 27 - Bridge Pier or Abutment 28 - Bridge Parapet 29 - Bridge Rail 30 - Guardrail Face 31 - Guardrail End 32 - Portable Barrier 33 - Median Cable Barrier 34 - Median Guardrail Barrier 35 - Median Concrete Barrier 36 - Median Other Barrier 37 - Traffic Sign Post 38 - Overhead Sign Post 39 - Light/Luminaries Support 40 - Utility Pole 41 - Other Post, Pole or Support 42 - Culvert 43 - Curb 44 - Ditch 45 - Embankment 46 - Fence 47 - Mailbox 48 - Tree 49 - Fire Hydrant 50 - Work Zone Maintenance Equipment 51 - Wall, Building, Tunnel 52 - Other Fixed Object 10 - Cross Median 11 - Cross Center Line Opposite Direction of Travel 12 - Downhill Runaway 13 - Other Non-Collision				
Unit Speed 25	Posted Speed 25	Traffic Control 12 01 - No Controls 02 - Stop Sign 03 - Yield Sign 04 - Traffic Signal 05 - Traffic Flashes 06 - School Zone 07 - Railroad Crossbucks 08 - Railroad Flashers 09 - Railroad Gates 10 - Construction Barricade 11 - Person (Flagger, Officer) 12 - Pavement Markings 13 - Crosswalk Lines 14 - Walk/Don't Walk 15 - Other 16 - Not Reported	Unit Direction From 4 To 3 1 - North 2 - South 3 - East 4 - West 5 - Northeast 6 - Northwest 7 - Southeast 8 - Southwest 9 - Unknown	



MOTORIST / Non-MOTORIST / OCCUPANT

LOCAL REPORT NUMBER

112416

UNIT NUMBER 01	NAME: LAST, FIRST, MIDDLE BRADY SARAH K	DATE OF BIRTH 12/11/1994	AGE 21	GENDER F - FEMALE M - MALE
ADDRESS, CITY, STATE, ZIP APT. 203 329 N. MAIN ST. MUNROE FALLS OH 44262			CONTACT PHONE- INCLUDE AREA CODE 330-808-4171	

INJURIES 1	INJURED TAKEN BY 1	EMS AGENCY	MEDICAL FACILITY INJURED TAKEN TO	SAFETY EQUIPMENT USED 04	DOT COMPLIANT MOTORCYCLE HELMET	SEATING POSITION 01	AIR BAG USAGE 1	EJECTION 1	TRAPPED 1		
OL STATE OH	OPERATOR LICENSE NUMBER TV443559	OL CLASS D	No VALID OL	M/C END.	CONDITION 1	ALCOHOL/DRUG SUSPECTED 1	ALCOHOL TEST STATUS 1	ALCOHOL TEST TYPE 1	ALCOHOL TEST VALUE .	DRUG TEST STATUS 1	DRUG TEST TYPE 1
OFFENSE CHARGED (Local Code) 331.34A		OFFENSE DESCRIPTION FAIL TO CONTROL				CITATION NUMBER 43993		HANDS-FREE DEVICE USED		DRIVER DISTRACTED BY	

UNIT NUMBER	NAME: LAST, FIRST, MIDDLE	DATE OF BIRTH	AGE	GENDER F - FEMALE M - MALE							
ADDRESS, CITY, STATE, ZIP		CONTACT PHONE- INCLUDE AREA CODE									
INJURIES	INJURED TAKEN BY	EMS AGENCY	MEDICAL FACILITY INJURED TAKEN TO	SAFETY EQUIPMENT USED	DOT COMPLIANT MOTORCYCLE HELMET	SEATING POSITION	AIR BAG USAGE	EJECTION	TRAPPED		
OL STATE	OPERATOR LICENSE NUMBER	OL CLASS	No VALID OL	M/C END.	CONDITION	ALCOHOL/DRUG SUSPECTED	ALCOHOL TEST STATUS	ALCOHOL TEST TYPE	ALCOHOL TEST VALUE	DRUG TEST STATUS	DRUG TEST TYPE
OFFENSE CHARGED (Local Code)		OFFENSE DESCRIPTION				CITATION NUMBER		HANDS-FREE DEVICE USED		DRIVER DISTRACTED BY	

INJURIES 1 - NO INJURY / NONE REPORTED 2 - POSSIBLE 3 - NON-INCAPACITATING 4 - INCAPACITATING 5 - FATAL	INJURED TAKEN BY 1 - NOT TRANSPORTED / TREATED AT SCENE 2 - EMS 3 - POLICE 4 - OTHER 9 - UNKNOWN	SAFETY EQUIPMENT USED MOTORIST 01 - NONE USED - VEHICLE OCCUPANT 02 - SHOULDER BELT ONLY USED 03 - LAP BELT ONLY USED 04 - SHOULDER AND LAP BELT USED 99 - UNKNOWN SAFETY EQUIPMENT 05 - CHILD RESTRAINT SYSTEM-FORWARD FACING 06 - CHILD RESTRAINT SYSTEM- REAR FACING 07 - BOOSTER SEAT 08 - HELMET USED Non-Motorist 09 - NONE USED 10 - HELMET USED 11 - PROTECTIVE PADS USED (ELBOWS, KNEES, ETC) 12 - REFLECTIVE CLOTHING 13 - LIGHTING 14 - OTHER	SEATING POSITION 01 - FRONT - LEFT SIDE (MOTORCYCLE DRIVER) 02 - FRONT - MIDDLE 03 - FRONT - RIGHT SIDE 04 - SECOND - LEFT SIDE (MOTORCYCLE PASSENGER) 05 - SECOND - MIDDLE 06 - SECOND - RIGHT SIDE 07 - THIRD - LEFT SIDE (MOTORCYCLE SIDE CAR) 08 - THIRD - MIDDLE 09 - THIRD - RIGHT SIDE 10 - SLEEPER SECTION OF CAB (TRUCK) 11 - PASSENGER IN OTHER ENCLOSED CARGO AREA (NON-TRAILING UNIT SUCH AS A BUS, PICK-UP WITH CAP) 12 - PASSENGER IN UNENCLOSED CARGO AREA 13 - TRAILING UNIT 14 - RIDING ON VEHICLE EXTERIOR (NON-TRAILING UNIT) 15 - NON-MOTORIST 16 - OTHER 99 - UNKNOWN	AIR BAG USAGE 1 - NOT DEPLOYED 2 - DEPLOYED FRONT 3 - DEPLOYED SIDE 4 - DEPLOYED BOTH FRONT/SIDE 5 - NOT APPLICABLE 9 - DEPLOYMENT UNKNOWN
EJECTION 1 - NOT EJECTED 2 - TOTALLY EJECTED 3 - PARTIALLY EJECTED 4 - NOT APPLICABLE	TRAPPED 1 - NOT TRAPPED 2 - EXTRICATED BY MECHANICAL MEANS 3 - EXTRICATED BY NON-MECHANICAL MEANS	OPERATOR LICENSE CLASS 1 - CLASS A 2 - CLASS B 3 - CLASS C 4 - REGULAR CLASS (OHIO IS "D") 5 - MC/MOPED ONLY	CONDITION 1 - APPARENTLY NORMAL 2 - PHYSICAL IMPAIRMENT 3 - EMOTIONAL (DEPRESSED, ANGRY, DISTURBED) 4 - ILLNESS 5 - FELL ASLEEP, FAINTED, FATIGUED 6 - UNDER THE INFLUENCE OF MEDICATIONS, DRUGS, ALCOHOL 7 - OTHER	ALCOHOL/DRUG SUSPECTED 1 - NONE 2 - YES - ALCOHOL SUSPECTED 3 - YES - HBD NOT IMPAIRED 4 - YES - DRUGS SUSPECTED 5 - YES - ALCOHOL AND DRUGS SUSPECTED
ALCOHOL TEST STATUS 1 - NONE GIVEN 2 - TEST REFUSED 3 - TEST GIVEN, CONTAMINATED SAMPLE/UNUSABLE 4 - TEST GIVEN, RESULTS KNOWN 5 - TEST GIVEN, RESULTS UNKNOWN	ALCOHOL TEST TYPE 1 - NONE 2 - BLOOD 3 - URINE 4 - BREATH 5 - OTHER	DRUG TEST STATUS 1 - NONE GIVEN 2 - TEST REFUSED 3 - TEST GIVEN, CONTAMINATED SAMPLE/UNUSABLE 4 - TEST GIVEN, RESULTS KNOWN 5 - TEST GIVEN, RESULTS UNKNOWN	DRUG TEST TYPE 1 - NONE 2 - BLOOD 3 - URINE 4 - OTHER	DRIVER DISTRACTED BY 1 - NO DISTRACTION REPORTED 2 - PHONE 3 - TEXTING/E-MAILING 4 - ELECTRONIC COMMUNICATION DEVICE 5 - OTHER ELECTRONIC DEVICE (NAVIGATION DEVICE, RADIO, DVD) 6 - OTHER INSIDE THE VEHICLE 7 - EXTERNAL DISTRACTION

UNIT NUMBER	NAME: LAST, FIRST, MIDDLE	DATE OF BIRTH	AGE	GENDER F - FEMALE M - MALE
ADDRESS, CITY, STATE, ZIP		CONTACT PHONE- INCLUDE AREA CODE		

INJURIES	INJURED TAKEN BY	EMS AGENCY	MEDICAL FACILITY INJURED TAKEN TO	SAFETY EQUIPMENT USED	DOT COMPLIANT MOTORCYCLE HELMET	SEATING POSITION	AIR BAG USAGE	EJECTION	TRAPPED
UNIT NUMBER	NAME: LAST, FIRST, MIDDLE	DATE OF BIRTH	AGE	GENDER F - FEMALE M - MALE					
ADDRESS, CITY, STATE, ZIP		CONTACT PHONE- INCLUDE AREA CODE							
INJURIES	INJURED TAKEN BY	EMS AGENCY	MEDICAL FACILITY INJURED TAKEN TO	SAFETY EQUIPMENT USED	DOT COMPLIANT MOTORCYCLE HELMET	SEATING POSITION	AIR BAG USAGE	EJECTION	TRAPPED