



# TRAFFIC CRASH REPORT

LOCAL REPORT NUMBER \*

11624358

CRASH SEVERITY

2 1 - FATAL  
2 - INJURY  
3 - PDO

HIT/SKIP

1 - SOLVED  
2 - UNSOLVED

## LOCAL INFORMATION

<input checked="" type="checkbox"/> PHOTOS TAKEN <input type="checkbox"/> OH-2 <input type="checkbox"/> OH-1P <input type="checkbox"/> OH-3 <input type="checkbox"/> OTHER	<input type="checkbox"/> PDO UNDER STATE REPORTABLE DOLLAR AMOUNT	<input type="checkbox"/> PRIVATE PROPERTY	REPORTING AGENCY NCIC * 06703	REPORTING AGENCY NAME * KENT POLICE DEPARTMENT	NUMBER OF UNITS 02	UNIT IN ERROR 02 98 - ANIMAL 99 - UNKNOWN
--	---	---	----------------------------------	---	-----------------------	---

COUNTY * 67	CITY * <input type="checkbox"/> VILLAGE * <input type="checkbox"/> TOWNSHIP *	CITY, VILLAGE, TOWNSHIP * KENT	CRASH DATE * 11/31/2016	TIME OF CRASH 1124Z	DAY OF WEEK MON
----------------	---	-----------------------------------	----------------------------	------------------------	--------------------

DEGREES / MINUTES / SECONDS LATITUDE 0 / 0 / 0	LONGITUDE 0 / 0 / 0	DECIMAL DEGREES LATITUDE 41.165050	LONGITUDE -81.386277
--	------------------------	--	-------------------------

ROADWAY DIVISION <input type="checkbox"/> DIVIDED <input checked="" type="checkbox"/> UNDIVIDED	DIVIDED LANE DIRECTION OF TRAVEL <input type="checkbox"/> N - NORTHBOUND E - EASTBOUND S - SOUTHBOUND W - WESTBOUND	NUMBER OF THRU LANES 02	ROAD TYPES OR MILEPOST <sup>2</sup> AL - ALLEY CR - CIRCLE AV - AVENUE CT - COURT BL - BOULEVARD DR - DRIVE HE - HEIGHTS MP - MILEPOST HW - HIGHWAY PK - PARKWAY LA - LANE PI - PIKE PL - PLACE RD - ROAD ST - STREET TE - TERRACE WA - WAY SQ - SQUARE TL - TRAIL
---	---	----------------------------	--

LOCATION ROUTE TYPE <sup>1</sup> 00	LOCATION ROUTE NUMBER 000000	LOC PREFIX N, S, E, W	LOCATION ROAD NAME FAIRCHILD	LOCATION ROAD TYPE <sup>2</sup> AV	ROUTE TYPES <sup>1</sup> IR - INTERSTATE ROUTE (INC. TURNPIKE) US - US ROUTE SR - STATE ROUTE	CR - NUMBERED COUNTY ROUTE TR - NUMBERED TOWNSHIP ROUTE
--	---------------------------------	--------------------------	---------------------------------	---------------------------------------	--	--

DISTANCE FROM REFERENCE 250	DIR FROM REF E, W	REFERENCE ROUTE TYPE <sup>1</sup> 00	REFERENCE ROUTE NUMBER 000000	REF PREFIX N, S, E, W	REFERENCE NAME (ROAD, MILEPOST, HOUSE #) SILVER MEADOWS	REFERENCE ROAD TYPE <sup>2</sup> BL
--------------------------------	----------------------	---	----------------------------------	--------------------------	--	--

REFERENCE POINT USED 1 - INTERSECTION 2 - MILE POST 3 - HOUSE NUMBER	CRASH LOCATION 01 01 - NOT AN INTERSECTION 02 - FOUR-WAY INTERSECTION 03 - T-INTERSECTION 04 - Y-INTERSECTION 05 - TRAFFIC CIRCLE/ROUNDOABOUT 06 - FIVE-POINT, OR MORE 07 - ON RAMP 08 - OFF RAMP 09 - CROSSOVER 10 - DRIVEWAY/ALLEY ACCESS 11 - RAILWAY GRADE CROSSING 12 - SHARED-USE PATHS OR TRAILS 99 - UNKNOWN	<input type="checkbox"/> INTERSECTION RELATED	LOCATION OF FIRST HARMFUL EVENT 1 - ON ROADWAY 2 - ON SHOULDER 3 - IN MEDIAN 4 - ON ROADSIDE 5 - ON GORE 6 - OUTSIDE TRAFFICWAY 9 - UNKNOWN
---	---	---	--

ROAD CONTOUR 1 - STRAIGHT LEVEL 2 - STRAIGHT GRADE 3 - CURVE LEVEL 4 - CURVE GRADE 9 - UNKNOWN	ROAD CONDITIONS PRIMARY 01 SECONDARY 00	01 - DRY 02 - WET 03 - SNOW 04 - ICE 05 - SAND, MUD, DIRT, OIL, GRAVEL 06 - WATER (STANDING, MOVING) 07 - SLUSH 08 - DEBRIS* 09 - RUT, HOLES, BUMPS, UNEVEN PAVEMENT* 10 - OTHER 99 - UNKNOWN	* SECONDARY CONDITION ONLY
---	---	---	----------------------------

MANNER OF CRASH COLLISION/IMPACT 1 - NOT COLLISION BETWEEN TWO MOTOR VEHICLES IN TRANSPORT 2 - REAR-END 3 - HEAD-ON 4 - REAR-TO-REAR 5 - BACKING 6 - ANGLE 7 - SIDESWIPE, SAME DIRECTION 8 - SIDESWIPE, OPPOSITE DIRECTION 9 - UNKNOWN	WEATHER 1 - CLEAR 2 - CLOUDY 3 - FOG, SMOG, SMOKE 4 - RAIN 5 - SLEET, HAIL 6 - SNOW 7 - SEVERE CROSSWINDS 8 - BLOWING SAND, SOIL, DIRT, SNOW 9 - OTHER/UNKNOWN
---	---

ROAD SURFACE 1 - CONCRETE 2 - BLACKTOP, BITUMINOUS, ASPHALT 3 - BRICK/BLOCK 4 - SLAG, GRAVEL, STONE 5 - DIRT 6 - OTHER	LIGHT CONDITIONS PRIMARY 01 SECONDARY 00 1 - DAYLIGHT 2 - DAWN 3 - DUSK 4 - DARK - LIGHTED ROADWAY 5 - DARK - ROADWAY NOT LIGHTED 6 - DARK - UNKNOWN ROADWAY LIGHTING 7 - GLARE* 8 - OTHER 9 - UNKNOWN	<input type="checkbox"/> SCHOOL ZONE RELATED	SCHOOL BUS RELATED <input type="checkbox"/> YES, SCHOOL BUS DIRECTLY INVOLVED <input type="checkbox"/> YES, SCHOOL BUS INDIRECTLY INVOLVED
--	---	--	--

<input type="checkbox"/> WORK ZONE RELATED	<input type="checkbox"/> WORKERS PRESENT <input type="checkbox"/> LAW ENFORCEMENT PRESENT (OFFICER/VEHICLE) <input type="checkbox"/> LAW ENFORCEMENT PRESENT (VEHICLE ONLY)	TYPE OF WORK ZONE 1 - LANE CLOSURE 2 - LANE SHIFT/CROSSOVER 3 - WORK ON SHOULDER OR MEDIAN 4 - INTERMITTENT OR MOVING WORK 5 - OTHER	LOCATION OF CRASH IN WORK ZONE 1 - BEFORE THE FIRST WORK ZONE WARNING SIGN 2 - ADVANCE WARNING AREA 3 - TRANSITION AREA 4 - ACTIVITY AREA 5 - TERMINATION AREA
--	---	---	---

NARRATIVE  
UNIT #1 AND UNIT #2 WERE WB ON FAIRCHILD AVE. UNIT #1 SLOWED FOR AVENUE IN FRONT OF IT. UNIT #2 REAR ENDED UNIT #1.

## Diagram

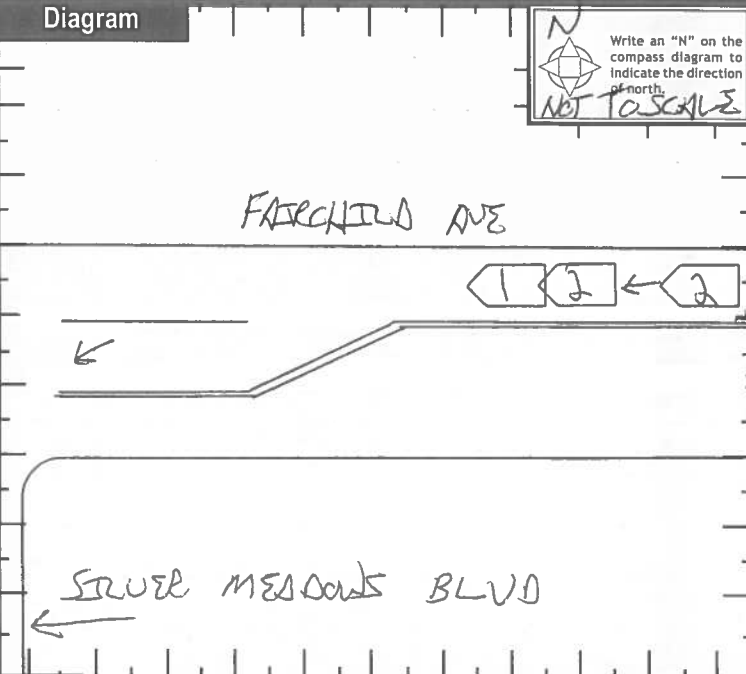

REPORT TAKEN BY <input checked="" type="checkbox"/> POLICE AGENCY <input type="checkbox"/> MOTORIST	<input type="checkbox"/> SUPPLEMENT (CORRECTION OR ADDITION TO AN EXISTING REPORT SENT TO ODPS)
---	---

DATE CRASH REPORTED 11/03/2016	TIME CRASH REPORTED 1124Z	DISPATCH TIME 1124Z	ARRIVAL TIME 1125Z	TIME CLEARED 1131Z	OTHER INVESTIGATION TIME H5	TOTAL MINUTES 72
-----------------------------------	------------------------------	------------------------	-----------------------	-----------------------	--------------------------------	---------------------

OFFICER'S NAME * A. HAM	OFFICER'S BADGE NUMBER 218	CHECKED BY A. HAM #228	PAGE 1 OF 4
----------------------------	-------------------------------	---------------------------	-------------



# MOTORIST / Non-MOTORIST / OCCUPANT

LOCAL REPORT NUMBER  
1624358

MOTORIST

MOTORIST/Non-MOTORIST

UNIT NUMBER 01	NAME: LAST, FIRST, MIDDLE CATALANO, COLLEEN M	DATE OF BIRTH 08/12/1950	AGE 66	GENDER <input checked="" type="checkbox"/> F - FEMALE <input type="checkbox"/> M - MALE							
ADDRESS, CITY, STATE, ZIP 1557 OVERLOOK RD KENT, OH 44240		CONTACT PHONE- INCLUDE AREA CODE 330-289-4186									
INJURIES <input type="checkbox"/>	INJURED TAKEN BY <input type="checkbox"/>	EMS AGENCY <input type="checkbox"/>	MEDICAL FACILITY INJURED TAKEN TO <input type="checkbox"/>	SAFETY EQUIPMENT USED 04	DOT COMPLIANT <input type="checkbox"/> MOTORCYCLE HELMET	SEATING POSITION 01	AIR BAG USAGE <input type="checkbox"/>	EJECTION <input type="checkbox"/>	TRAPPED <input type="checkbox"/>		
OL STATE OH	OPERATOR LICENSE NUMBER RT929082	OL CLASS 4	No <input type="checkbox"/> VALID OL	M/C <input type="checkbox"/> END.	CONDITION <input type="checkbox"/>	ALCOHOL/DRUG SUSPECTED <input type="checkbox"/>	ALCOHOL TEST STATUS <input type="checkbox"/>	ALCOHOL TEST TYPE <input type="checkbox"/>	ALCOHOL TEST VALUE .	DRUG TEST STATUS <input type="checkbox"/>	DRUG TEST TYPE <input type="checkbox"/>
OFFENSE CHARGED ( <input type="checkbox"/> LOCAL CODE )		OFFENSE DESCRIPTION		CITATION NUMBER		HANDS-FREE <input type="checkbox"/> DEVICE USED		DRIVER DISTRACTED BY <input type="checkbox"/>			

UNIT NUMBER 02	NAME: LAST, FIRST, MIDDLE BELL, CHRISTOPHER P	DATE OF BIRTH 03/11/1993	AGE 23	GENDER <input checked="" type="checkbox"/> M - MALE <input type="checkbox"/> F - FEMALE							
ADDRESS, CITY, STATE, ZIP 1125 PARK LEASE DR MACEDONIA, OH 44056		CONTACT PHONE- INCLUDE AREA CODE 330-348-7451									
INJURIES <input type="checkbox"/>	INJURED TAKEN BY <input type="checkbox"/>	EMS AGENCY <input type="checkbox"/>	MEDICAL FACILITY INJURED TAKEN TO <input type="checkbox"/>	SAFETY EQUIPMENT USED 04	DOT COMPLIANT <input type="checkbox"/> MOTORCYCLE HELMET	SEATING POSITION 01	AIR BAG USAGE <input type="checkbox"/>	EJECTION <input type="checkbox"/>	TRAPPED <input type="checkbox"/>		
OL STATE OH	OPERATOR LICENSE NUMBER TV075459	OL CLASS 4	No <input type="checkbox"/> VALID OL	M/C <input type="checkbox"/> END.	CONDITION <input type="checkbox"/>	ALCOHOL/DRUG SUSPECTED <input type="checkbox"/>	ALCOHOL TEST STATUS <input type="checkbox"/>	ALCOHOL TEST TYPE <input type="checkbox"/>	ALCOHOL TEST VALUE .	DRUG TEST STATUS <input type="checkbox"/>	DRUG TEST TYPE <input type="checkbox"/>
OFFENSE CHARGED ( <input type="checkbox"/> LOCAL CODE ) 333-03A		OFFENSE DESCRIPTION ACDA		CITATION NUMBER 52058		HANDS-FREE <input type="checkbox"/> DEVICE USED		DRIVER DISTRACTED BY <input type="checkbox"/>			

INJURIES 1 - NO INJURY / NONE REPORTED 2 - POSSIBLE 3 - NON-INCAPACITATING 4 - INCAPACITATING 5 - FATAL	INJURED TAKEN BY 1 - NOT TRANSPORTED / TREATED AT SCENE 2 - EMS 3 - POLICE 4 - OTHER 9 - UNKNOWN	SAFETY EQUIPMENT USED MOTORIST 01 - NONE USED - VEHICLE OCCUPANT 02 - SHOULDER BELT ONLY USED 03 - LAP BELT ONLY USED 04 - SHOULDER AND LAP BELT USED 99 - UNKNOWN SAFETY EQUIPMENT Non-MOTORIST 05 - CHILD RESTRAINT SYSTEM-FORWARD FACING 06 - CHILD RESTRAINT SYSTEM- REAR FACING 07 - BOOSTER SEAT 08 - HELMET USED 12 - REFLECTIVE CLOTHING 13 - LIGHTING 14 - OTHER	SEATING POSITION 01 - FRONT - LEFT SIDE (MOTORCYCLE DRIVER) 02 - FRONT - MIDDLE 03 - FRONT - RIGHT SIDE 04 - SECOND - LEFT SIDE (MOTORCYCLE PASSENGER) 05 - SECOND - MIDDLE 06 - SECOND - RIGHT SIDE 07 - THIRD - LEFT SIDE (MOTORCYCLE SIDE CAR) 08 - THIRD - MIDDLE 09 - THIRD - RIGHT SIDE 10 - SLEEPER SECTION OF CAB (TRUCK) 11 - PASSENGER IN OTHER ENCLOSED CARGO AREA (NON-TRAILING UNIT SUCH AS A BUS, PICK-UP WITH CAP) 12 - PASSENGER IN UNENCLOSED CARGO AREA 13 - TRAILING UNIT 14 - RIDING ON VEHICLE EXTERIOR (NON-TRAILING UNIT) 15 - NON-MOTORIST 16 - OTHER 99 - UNKNOWN	AIR BAG USAGE 1 - NOT DEPLOYED 2 - DEPLOYED FRONT 3 - DEPLOYED SIDE 4 - DEPLOYED BOTH FRONT/SIDE 5 - NOT APPLICABLE 9 - DEPLOYMENT UNKNOWN
EJECTION 1 - NOT EJECTED 2 - TOTALLY EJECTED 3 - PARTIALLY EJECTED 4 - NOT APPLICABLE	TRAPPED 1 - NOT TRAPPED 2 - EXTRICATED BY MECHANICAL MEANS 3 - EXTRICATED BY NON-MECHANICAL MEANS	OPERATOR LICENSE CLASS 1 - CLASS A 2 - CLASS B 3 - CLASS C 4 - REGULAR CLASS (OHIO IS "D") 5 - MC/MOPED ONLY	CONDITION 1 - APPARENTLY NORMAL 2 - PHYSICAL IMPAIRMENT 3 - EMOTIONAL (DEPRESSED, ANGRY, DISTURBED) 4 - ILLNESS 5 - FELL ASLEEP, FAINTED, FATIGUED 6 - UNDER THE INFLUENCE OF MEDICATIONS, DRUGS, ALCOHOL 7 - OTHER	ALCOHOL/DRUG SUSPECTED 1 - NONE 2 - YES - ALCOHOL SUSPECTED 3 - YES - HBD NOT IMPAIRED 4 - YES - DRUGS SUSPECTED 5 - YES - ALCOHOL AND DRUGS SUSPECTED
ALCOHOL TEST STATUS 1 - NONE GIVEN 2 - TEST REFUSED 3 - TEST GIVEN, CONTAMINATED SAMPLE/UNUSABLE 4 - TEST GIVEN, RESULTS KNOWN 5 - TEST GIVEN, RESULTS UNKNOWN	ALCOHOL TEST TYPE 1 - NONE 2 - BLOOD 3 - URINE 4 - BREATH 5 - OTHER	DRUG TEST STATUS 1 - NONE GIVEN 2 - TEST REFUSED 3 - TEST GIVEN, CONTAMINATED SAMPLE/UNUSABLE 4 - TEST GIVEN, RESULTS KNOWN 5 - TEST GIVEN, RESULTS UNKNOWN	DRUG TEST TYPE 1 - NONE 2 - BLOOD 3 - URINE 4 - OTHER	DRIVER DISTRACTED BY 1 - NO DISTRACTION REPORTED 2 - PHONE 3 - TEXTING/E-MAILING 4 - ELECTRONIC COMMUNICATION DEVICE 5 - OTHER ELECTRONIC DEVICE (NAVIGATION DEVICE, RADIO, DVD) 6 - OTHER INSIDE THE VEHICLE 7 - EXTERNAL DISTRACTION

OCCUPANT

OCCUPANT

UNIT NUMBER 01	NAME: LAST, FIRST, MIDDLE CATALANO, JAMES, D	DATE OF BIRTH 08/05/1987	AGE 29	GENDER <input checked="" type="checkbox"/> M - MALE <input type="checkbox"/> F - FEMALE					
ADDRESS, CITY, STATE, ZIP 1557 OVERLOOK RD KENT, OH 44240		CONTACT PHONE- INCLUDE AREA CODE 330-256-5973							
INJURIES <input type="checkbox"/>	INJURED TAKEN BY <input type="checkbox"/>	EMS AGENCY <input type="checkbox"/>	MEDICAL FACILITY INJURED TAKEN TO <input type="checkbox"/>	SAFETY EQUIPMENT USED 04	DOT COMPLIANT <input type="checkbox"/> MOTORCYCLE HELMET	SEATING POSITION 03	AIR BAG USAGE <input type="checkbox"/>	EJECTION <input type="checkbox"/>	TRAPPED <input type="checkbox"/>
UNIT NUMBER <input type="checkbox"/>	NAME: LAST, FIRST, MIDDLE	DATE OF BIRTH	AGE	GENDER <input type="checkbox"/> F - FEMALE <input type="checkbox"/> M - MALE					
ADDRESS, CITY, STATE, ZIP		CONTACT PHONE- INCLUDE AREA CODE							
INJURIES <input type="checkbox"/>	INJURED TAKEN BY <input type="checkbox"/>	EMS AGENCY <input type="checkbox"/>	MEDICAL FACILITY INJURED TAKEN TO <input type="checkbox"/>	SAFETY EQUIPMENT USED <input type="checkbox"/>	DOT COMPLIANT <input type="checkbox"/> MOTORCYCLE HELMET	SEATING POSITION <input type="checkbox"/>	AIR BAG USAGE <input type="checkbox"/>	EJECTION <input type="checkbox"/>	TRAPPED <input type="checkbox"/>

1624358

UNIT NUMBER 011	OWNER NAME: LAST, FIRST, MIDDLE ( <input type="checkbox"/> SAME AS DRIVER ) CATALANO DOMINIC R	OWNER PHONE NUMBER - INC. AREA CODE ( <input type="checkbox"/> SAME AS DRIVER ) 330-289-4189	DAMAGE SCALE 2	DAMAGED AREA FRONT 09 02 03 08 10 04 07 06 05 REAR	
OWNER ADDRESS: CITY, STATE, ZIP ( <input checked="" type="checkbox"/> SAME AS DRIVER )					
LP STATE OH	LICENSE PLATE NUMBER GCT 6029	VEHICLE IDENTIFICATION NUMBER 1FMHKA88XRG6A94788	# OCCUPANTS 02		
VEHICLE YEAR 2011	VEHICLE MAKE FORD	VEHICLE MODEL EXPLORER	VEHICLE COLOR WHITE		
<input checked="" type="checkbox"/> PROOF OF INSURANCE SHOWN	INSURANCE COMPANY GRANDE	POLICY NUMBER PA3970704	TOWED BY		
CARRIER NAME, ADDRESS, CITY, STATE, ZIP				CARRIER PHONE- INCLUDE AREA CODE	
US DOT	VEHICLE WEIGHT GVWR/GCWR 1 - LESS THAN OR EQUAL TO 10K LBS. 2 - 10,001 TO 26,000 LBS. 3 - MORE THAN 26,000 LBS. 01	CARGO BODY TYPE 01 - NO CARGO BODY TYPE/NOT APPLICABLE 02 - BUS/VAN (9-15 SEATS, INC DRIVER) 03 - BUS (16+ SEATS, INC DRIVER) 04 - VEHICLE TOWING ANOTHER VEHICLE 05 - LOGGING 06 - INTERMODAL CONTAINER CHASSIS 07 - CARGO VAN/ENCLOSED BOX 08 - GRAIN, CHIPS, GRAVEL 09 - POLE 10 - CARGO TANK 11 - FLAT BED 12 - DUMP 13 - CONCRETE MIXER 14 - AUTO TRANSPORTER 15 - GARBAGE/REFUSE 99 - OTHER/UNKNOWN	TRAFFICWAY DESCRIPTION 1 - TWO-WAY, NOT DIVIDED 2 - TWO-WAY, NOT DIVIDED, CONTINUOUS LEFT TURN LANE 3 - TWO-WAY, DIVIDED, UNPROTECTED (PAINTED OR GRASS > 4 FT.) MEDIAN 4 - TWO-WAY, DIVIDED, POSITIVE MEDIAN BARRIER 5 - ONE-WAY TRAFFICWAY <input type="checkbox"/> HIT / SKIP UNIT		
HM PLACARD ID No. 01	<input type="checkbox"/> HAZARDOUS MATERIAL RELEASED				
HM CLASS NUMBER 01					
Non-Motorist LOCATION PRIOR TO IMPACT 01 - INTERSECTION - MARKED CROSSWALK 02 - INTERSECTION - NO CROSSWALK 03 - INTERSECTION - OTHER 04 - MIDBLOCK - MARKED CROSSWALK 05 - TRAVEL LANE - OTHER LOCATION 06 - BICYCLE LANE 07 - SHOULDER/ROADSIDE 08 - SIDEWALK 09 - MEDIAN/CROSSING ISLAND 10 - DRIVEWAY ACCESS 11 - SHARED-USE PATH OR TRAIL 12 - Non-TRAFFICWAY AREA 99 - OTHER/UNKNOWN		TYPE OF USE 1 - PERSONAL 2 - COMMERCIAL 3 - GOVERNMENT <input type="checkbox"/> IN EMERGENCY RESPONSE	UNIT TYPE 01 - SUB-COMPACT 02 - COMPACT 03 - MID SIZE 04 - FULL SIZE 05 - MINIVAN 06 - SPORT UTILITY VEHICLE 07 - PICKUP 08 - VAN 09 - MOTORCYCLE 10 - MOTORIZED BICYCLE 11 - SNOWMOBILE/ATV 12 - OTHER PASSENGER VEHICLE PASSENGER VEHICLES (LESS THAN 9 PASSENGERS) MED/HEAVY TRUCKS OR COMBO UNITS > 10K LBS 13 - SINGLE UNIT TRUCK OR VAN 2AXLE, 6 TIRES 14 - SINGLE UNIT TRUCK; 3+ AXLES 15 - SINGLE UNIT TRUCK / TRAILER 16 - TRUCK/TRACTOR (BOBTAIL) 17 - TRACTOR/SEMI-TRAILER 18 - TRACTOR/DOUBLE 19 - TRACTOR/TRIPLES 20 - OTHER MED/HEAVY VEHICLE BUS/VAN/LIMO (9 OR MORE INCLUDING DRIVER) 21 - BUS/VAN (9-15 SEATS, INC DRIVER) 22 - BUS (16+ SEATS, INC DRIVER) Non-Motorist 23 - ANIMAL WITH RIDER 24 - ANIMAL WITH BUGGY, WAGON, SURREY 25 - BICYCLE/PEDACYCLIST 26 - PEDESTRIAN/SKATER 27 - OTHER Non-Motorist		
SPECIAL FUNCTION 01 - NONE 02 - TAXI 03 - RENTAL TRUCK (OVER 10K LBS) 04 - BUS - SCHOOL (PUBLIC OR PRIVATE) 05 - BUS - TRANSIT 06 - BUS - CHARTER 07 - BUS - SHUTTLE 08 - BUS - OTHER	09 - AMBULANCE 10 - FIRE 11 - HIGHWAY/MAINTENANCE 12 - MILITARY 13 - POLICE 14 - PUBLIC UTILITY 15 - OTHER GOVERNMENT 16 - CONSTRUCTION EQUIP.	17 - FARM VEHICLE 18 - FARM EQUIPMENT 19 - MOTORHOME 20 - GOLF CART 21 - TRAIN 22 - OTHER (EXPLAIN IN NARRATIVE)	MOST DAMAGED AREA 01 - NONE 02 - CENTER FRONT 03 - RIGHT FRONT 04 - RIGHT SIDE 05 - RIGHT REAR 06 - REAR CENTER 07 - LEFT REAR 08 - LEFT SIDE 09 - LEFT FRONT 10 - TOP AND WINDOWS 11 - UNDERCARRIAGE 12 - LOAD/TRAILER 13 - TOTAL(ALL AREAS) 14 - OTHER 99 - UNKNOWN		
PRE-CRASH ACTIONS MOTORIST 01 - STRAIGHT AHEAD 02 - BACKING 03 - CHANGING LANES 04 - OVERTAKING/PASSING 05 - MAKING RIGHT TURN 06 - MAKING LEFT TURN 99 - UNKNOWN			Non-Motorist 15 - ENTERING OR CROSSING SPECIFIED LOCATION 16 - WALKING, RUNNING, JOGGING, PLAYING, CYCLING 17 - WORKING 18 - PUSHING VEHICLE 19 - APPROACHING OR LEAVING VEHICLE 20 - STANDING 21 - OTHER Non-Motorist ACTION		
CONTRIBUTING CIRCUMSTANCES PRIMARY 01 - NONE 02 - FAILURE TO YIELD 03 - RAN RED LIGHT 04 - RAN STOP SIGN 05 - EXCEEDED SPEED LIMIT 06 - UNSAFE SPEED 07 - IMPROPER TURN 08 - LEFT OF CENTER 09 - FOLLOWED TOO CLOSELY/ACDA 10 - IMPROPER LANE CHANGE /PASSING/OFF ROAD SECONDARY 01 - NONE 02 - FAILURE TO YIELD 03 - RAN RED LIGHT 04 - RAN STOP SIGN 05 - EXCEEDED SPEED LIMIT 06 - UNSAFE SPEED 07 - IMPROPER TURN 08 - LEFT OF CENTER 09 - FOLLOWED TOO CLOSELY/ACDA 10 - IMPROPER LANE CHANGE /PASSING/OFF ROAD 99 - UNKNOWN			Non-Motorist 22 - NONE 23 - IMPROPER CROSSING 24 - DARTING 25 - LYING AND/OR ILLEGALLY IN ROADWAY 26 - FAILURE TO YIELD RIGHT OF WAY 27 - NOT VISIBLE (DARK CLOTHING) 28 - INATTENTIVE 29 - FAILURE TO OBEY TRAFFIC SIGNS /SIGNALS/OFFICER 30 - WRONG SIDE OF THE ROAD 31 - OTHER Non-Motorist ACTION		
VEHICLE DEFECTS 01 - TURN SIGNALS 02 - HEAD LAMPS 03 - TAIL LAMPS 04 - BRAKES 05 - STEERING 06 - TIRE BLOWOUT 07 - WORN OR SLICK TIRES 08 - TRAILER EQUIPMENT DEFECTIVE 09 - MOTOR TROUBLE 10 - DISABLED FROM PRIOR ACCIDENT 11 - OTHER DEFECTS					
SEQUENCE OF EVENTS 1 20 2 3 4 5 6 FIRST HARMFUL EVENT 1 MOST HARMFUL EVENT 1 99 - UNKNOWN			Non-Collision Events 01 - OVERTURN/ROLLOVER 02 - FIRE/EXPLOSION 03 - IMMERSION 04 - JACKKNIFE 05 - CARGO/EQUIPMENT LOSS OR SHIFT 06 - EQUIPMENT FAILURE (BLOWN TIRE, BRAKE FAILURE, ETC) 07 - SEPARATION OF UNITS 08 - RAN OFF ROAD RIGHT 09 - RAN OFF ROAD LEFT 10 - CROSS MEDIAN 11 - CROSS CENTER LINE OPPOSITE DIRECTION OF TRAVEL 12 - DOWNHILL RUNAWAY 13 - OTHER Non-Collision		
COLLISION WITH PERSON, VEHICLE OR OBJECT NOT FIXED 14 - PEDESTRIAN 15 - PEDALCYCLE 16 - RAILWAY VEHICLE (TRAIN, ENGINE) 17 - ANIMAL - FARM 18 - ANIMAL - DEER 19 - ANIMAL - OTHER 20 - MOTOR VEHICLE IN TRANSPORT 21 - PARKED MOTOR VEHICLE 22 - WORK ZONE MAINTENANCE EQUIPMENT 23 - STRUCK BY FALLING, SHIFTING CARGO OR ANYTHING SET IN MOTION BY A MOTOR VEHICLE 24 - OTHER MOVABLE OBJECT 25 - IMPACT ATTENUATOR/CRASH CUSHION 26 - BRIDGE OVERHEAD STRUCTURE 27 - BRIDGE PIER OR ABUTMENT 28 - BRIDGE PARAPET 29 - BRIDGE RAIL 30 - GUARDRAIL FACE 31 - GUARDRAIL END 32 - PORTABLE BARRIER 33 - MEDIAN CABLE BARRIER 34 - MEDIAN GUARDRAIL BARRIER 35 - MEDIAN CONCRETE BARRIER 36 - MEDIAN OTHER BARRIER 37 - TRAFFIC SIGN POST 38 - OVERHEAD SIGN POST 39 - LIGHT/LUMINARIES SUPPORT 40 - UTILITY POLE 41 - OTHER POST, POLE OR SUPPORT 42 - CULVERT 43 - CURB 44 - DITCH 45 - EMBANKMENT 46 - FENCE 47 - MAILBOX 48 - TREE 49 - FIRE HYDRANT 50 - WORK ZONE MAINTENANCE EQUIPMENT 51 - WALL, BUILDING, TUNNEL 52 - OTHER FIXED OBJECT					
UNIT SPEED 51 STATED ESTIMATED	POSTED SPEED 35	TRAFFIC CONTROL 01 - NO CONTROLS 02 - STOP SIGN 03 - YIELD SIGN 04 - TRAFFIC SIGNAL 05 - TRAFFIC FLASHERS 06 - SCHOOL ZONE 07 - RAILROAD CROSSINGS 08 - RAILROAD FLASHERS 09 - RAILROAD GATES 10 - CONSTRUCTION BARRICADE 11 - PERSON (FLAGGER, OFFICER) 12 - PAVEMENT MARKINGS 13 - CROSSWALK LINES 14 - WALK/DON'T WALK 15 - OTHER 16 - NOT REPORTED	UNIT DIRECTION FROM 3 TO 4 1 - NORTH 2 - SOUTH 3 - EAST 4 - WEST 5 - NORTHEAST 6 - NORTHWEST 7 - SOUTHEAST 8 - SOUTHWEST 9 - UNKNOWN		



# UNIT

LOCAL REPORT NUMBER

11624358

UNIT NUMBER 02	OWNER NAME: LAST, FIRST, MIDDLE (X) SAME AS DRIVER	OWNER PHONE NUMBER - INC. AREA CODE (X) SAME AS DRIVER	DAMAGE SCALE 2	DAMAGED AREA 
OWNER ADDRESS: CITY, STATE, ZIP (X) SAME AS DRIVER			1 - NONE	
LP STATE PA	LICENSE PLATE NUMBER GGC 7310	VEHICLE IDENTIFICATION NUMBER 1G6CS195018119942	2 - MINOR	
VEHICLE YEAR 2001	VEHICLE MAKE CHEVROLET	VEHICLE MODEL S10	3 - FUNCTIONAL	
VEHICLE COLOR RED	PROOF OF INSURANCE SHOWN FARMERS	POLICY NUMBER 184430832	4 - DISABLING	
CARRIER NAME, ADDRESS, CITY, STATE, ZIP			9 - UNKNOWN	
CARRIER PHONE - INCLUDE AREA CODE				
US DOT	VEHICLE WEIGHT GVWR/GCWR 1 - LESS THAN OR EQUAL TO 10K LBS. 2 - 10,001 TO 26,000 LBS. 3 - MORE THAN 26,000 LBS.	CARGO BODY TYPE 01 - NO CARGO BODY TYPE/NOT APPLICABLE 02 - BUS/VAN (9-15 SEATS, INC DRIVER) 03 - BUS (16+ SEATS, INC DRIVER) 04 - VEHICLE TOWING ANOTHER VEHICLE 05 - LOGGING 06 - INTERMODAL CONTAINER CHASSIS 07 - CARGO VAN/ENCLOSED BOX 08 - GRAIN, CHIPS, GRAVEL	TRAFFICWAY DESCRIPTION 1 - TWO-WAY, NOT DIVIDED 2 - TWO-WAY, NOT DIVIDED, CONTINUOUS LEFT TURN LANE 3 - TWO-WAY, DIVIDED, UNPROTECTED (PAINTED OR GRASS > 4 FT.) MEDIAN 4 - TWO-WAY, DIVIDED, POSITIVE MEDIAN BARRIER 5 - ONE-WAY TRAFFICWAY	
HM PLACARD ID NO.	HAZARDOUS MATERIAL RELEASED	09 - POLE 10 - CARGO TANK 11 - FLAT BED 12 - DUMP 13 - CONCRETE MIXER 14 - AUTO TRANSPORTER 15 - GARBAGE/REFUSE 99 - OTHER/UNKNOWN	<input type="checkbox"/> HIT / SKIP UNIT	
HM CLASS NUMBER	NON-MOTORIST LOCATION PRIOR TO IMPACT 01 - INTERSECTION - MARKED CROSSWALK 02 - INTERSECTION - NO CROSSWALK 03 - INTERSECTION - OTHER 04 - MIDBLOCK - MARKED CROSSWALK 05 - TRAVEL LANE - OTHER LOCATION 06 - BICYCLE LANE 07 - SHOULDER/ROADSIDE 08 - SIDEWALK 09 - MEDIAN/CROSSING ISLAND 10 - DRIVEWAY ACCESS 11 - SHARED-USE PATH OR TRAIL 12 - NON-TRAFFICWAY AREA 99 - OTHER/UNKNOWN	TYPE OF USE 1 - PERSONAL 2 - COMMERCIAL 3 - GOVERNMENT <input type="checkbox"/> IN EMERGENCY RESPONSE	UNIT TYPE 01 - SUB-COMPACT 02 - COMPACT 03 - MID SIZE 04 - FULL SIZE 05 - MINIVAN 06 - SPORT UTILITY VEHICLE 07 - PICKUP 08 - VAN 09 - MOTORCYCLE 10 - MOTORIZED BICYCLE 11 - SNOWMOBILE/ATV 12 - OTHER PASSENGER VEHICLE	PASSENGER VEHICLES (LESS THAN 9 PASSENGERS) MED/HEAVY TRUCKS OR COMBO UNITS > 10K LBS Bus/Van/Limo (9 or more including driver) 21 - BUS/VAN (9-15 SEATS, INC DRIVER) 22 - BUS (16+ SEATS, INC DRIVER) NON-MOTORIST 23 - ANIMAL WITH RIDER 24 - ANIMAL WITH BUGGY, WAGON, SURREY 25 - BICYCLE/PEDALCYCLIST 26 - PEDESTRIAN/SKATER 27 - OTHER NON-MOTORIST
SPECIAL FUNCTION 01 - NONE 02 - TAXI 03 - RENTAL TRUCK (OVER 10K LBS) 04 - BUS - SCHOOL (PUBLIC OR PRIVATE) 05 - BUS - TRANSIT 06 - BUS - CHARTER 07 - BUS - SHUTTLE 08 - BUS - OTHER	09 - AMBULANCE 10 - FIRE 11 - HIGHWAY/MAINTENANCE 12 - MILITARY 13 - POLICE 14 - PUBLIC UTILITY 15 - OTHER GOVERNMENT 16 - CONSTRUCTION EQUIP.	17 - FARM VEHICLE 18 - FARM EQUIPMENT 19 - MOTORHOME 20 - GOLF CART 21 - TRAIN 22 - OTHER (EXPLAIN IN NARRATIVE)	MOST DAMAGED AREA 01 - NONE 02 - CENTER FRONT 03 - RIGHT FRONT 04 - RIGHT SIDE 05 - RIGHT REAR 06 - REAR CENTER 07 - LEFT REAR	ACTION 1 - NON-CONTACT 2 - NON-COLLISION 3 - STRIKING 4 - STRUCK 5 - STRIKING/STRUCK 9 - UNKNOWN
PRE-CRASH ACTIONS 01 - STRAIGHT AHEAD 02 - BACKING 03 - CHANGING LANES 04 - OVERTAKING/PASSING 05 - MAKING RIGHT TURN 06 - MAKING LEFT TURN	07 - MAKING U-TURN 08 - ENTERING TRAFFIC LANE 09 - LEAVING TRAFFIC LANE 10 - PARKED 11 - SLOWING OR STOPPED IN TRAFFIC 12 - DRIVERLESS	13 - NEGOTIATING A CURVE 14 - OTHER MOTORIST ACTION	NON-MOTORIST 15 - ENTERING OR CROSSING SPECIFIED LOCATION 16 - WALKING, RUNNING, JOGGING, PLAYING, CYCLING 17 - WORKING 18 - PUSHING VEHICLE 19 - APPROACHING OR LEAVING VEHICLE 20 - STANDING	21 - OTHER NON-MOTORIST ACTION
CONTRIBUTING CIRCUMSTANCES PRIMARY 01 - NONE 02 - FAILURE TO YIELD 03 - RAN RED LIGHT 04 - RAN STOP SIGN 05 - EXCEEDED SPEED LIMIT 06 - UNSAFE SPEED 07 - IMPROPER TURN 08 - LEFT OF CENTER 09 - FOLLOWED TOO CLOSELY/ACDA 10 - IMPROPER LANE CHANGE /PASSING/OFF ROAD	MOTORIST 11 - IMPROPER BACKING 12 - IMPROPER START FROM PARKED POSITION 13 - STOPPED OR PARKED ILLEGALLY 14 - OPERATING VEHICLE IN NEGLIGENT MANNER 15 - SWERVING TO AVOID (DUE TO EXTERNAL CONDITIONS) 16 - WRONG SIDE/WRONG WAY 17 - FAILURE TO CONTROL 18 - VISION OBSTRUCTION 19 - OPERATING DEFECTIVE EQUIPMENT 20 - LOAD SHIFTING/FALLING/SPILLING 21 - OTHER IMPROPER ACTION	NON-MOTORIST 22 - NONE 23 - IMPROPER CROSSING 24 - DARTING 25 - LYING AND/OR ILLEGALLY IN ROADWAY 26 - FAILURE TO YIELD RIGHT OF WAY 27 - NOT VISIBLE (DARK CLOTHING) 28 - INATTENTIVE 29 - FAILURE TO OBEY TRAFFIC SIGNS /SIGNALS/OFFICER 30 - WRONG SIDE OF THE ROAD 31 - OTHER NON-MOTORIST ACTION	VEHICLE DEFECTS 01 - TURN SIGNALS 02 - HEAD LAMPS 03 - TAIL LAMPS 04 - BRAKES 05 - STEERING 06 - TIRE BLOWOUT 07 - WORN OR SLICK TIRES 08 - TRAILER EQUIPMENT DEFECTIVE 09 - MOTOR TROUBLE 10 - DISABLED FROM PRIOR ACCIDENT 11 - OTHER DEFECTS	
SEQUENCE OF EVENTS 1 - FIRST HARMFUL EVENT 2 - MOST HARMFUL EVENT 3 - OTHER HARMFUL EVENT 4 - OTHER HARMFUL EVENT 5 - OTHER HARMFUL EVENT 6 - OTHER HARMFUL EVENT	NON-COLLISION EVENTS 01 - OVERTURN/ROLLOVER 02 - FIRE/EXPLOSION 03 - IMMERSION 04 - JACKKNIFE 05 - CARGO/EQUIPMENT LOSS OR SHIFT 06 - EQUIPMENT FAILURE (BLOWN TIRE, BRAKE FAILURE, ETC) 07 - SEPARATION OF UNITS 08 - RAN OFF ROAD RIGHT 09 - RAN OFF ROAD LEFT 10 - CROSS MEDIAN 11 - CROSS CENTER LINE OPPOSITE DIRECTION OF TRAVEL 12 - DOWNHILL RUNAWAY 13 - OTHER NON-COLLISION	COLLISION WITH FIXED OBJECT 25 - IMPACT ATTENUATOR/CRASH CUSHION 26 - BRIDGE OVERHEAD STRUCTURE 27 - BRIDGE PIER OR ABUTMENT 28 - BRIDGE PARAPET 29 - BRIDGE RAIL 30 - GUARDRAIL FACE 31 - GUARDRAIL END 32 - PORTABLE BARRIER 33 - MEDIAN CABLE BARRIER 34 - MEDIAN GUARDRAIL BARRIER 35 - MEDIAN CONCRETE BARRIER 36 - MEDIAN OTHER BARRIER 37 - TRAFFIC SIGN POST 38 - OVERHEAD SIGN POST 39 - LIGHT/LUMINARIES SUPPORT 40 - UTILITY POLE 41 - OTHER POST, POLE OR SUPPORT 42 - CULVERT 43 - CURB 44 - DITCH 45 - EMBANKMENT 46 - FENCE 47 - MAILBOX 48 - TREE 49 - FIRE HYDRANT 50 - WORK ZONE MAINTENANCE EQUIPMENT 51 - WALL, BUILDING, TUNNEL 52 - OTHER FIXED OBJECT		
UNIT SPEED 10	POSTED SPEED 35	TRAFFIC CONTROL 01 - NO CONTROLS 02 - STOP SIGN 03 - YIELD SIGN 04 - TRAFFIC SIGNAL 05 - TRAFFIC FLASHERS 06 - SCHOOL ZONE 07 - RAILROAD CROSSBUCKS 08 - RAILROAD FLASHERS 09 - RAILROAD GATES 10 - CONSTRUCTION BARRICADE 11 - PERSON (FLAGGER, OFFICER) 12 - PAVEMENT MARKINGS 13 - CROSSWALK LINES 14 - WALK/DON'T WALK 15 - OTHER 16 - NOT REPORTED	UNIT DIRECTION FROM 3 TO 4 1 - NORTH 2 - SOUTH 3 - EAST 4 - WEST 5 - NORTHEAST 6 - NORTHWEST 7 - SOUTHEAST 8 - SOUTHWEST 9 - UNKNOWN	