

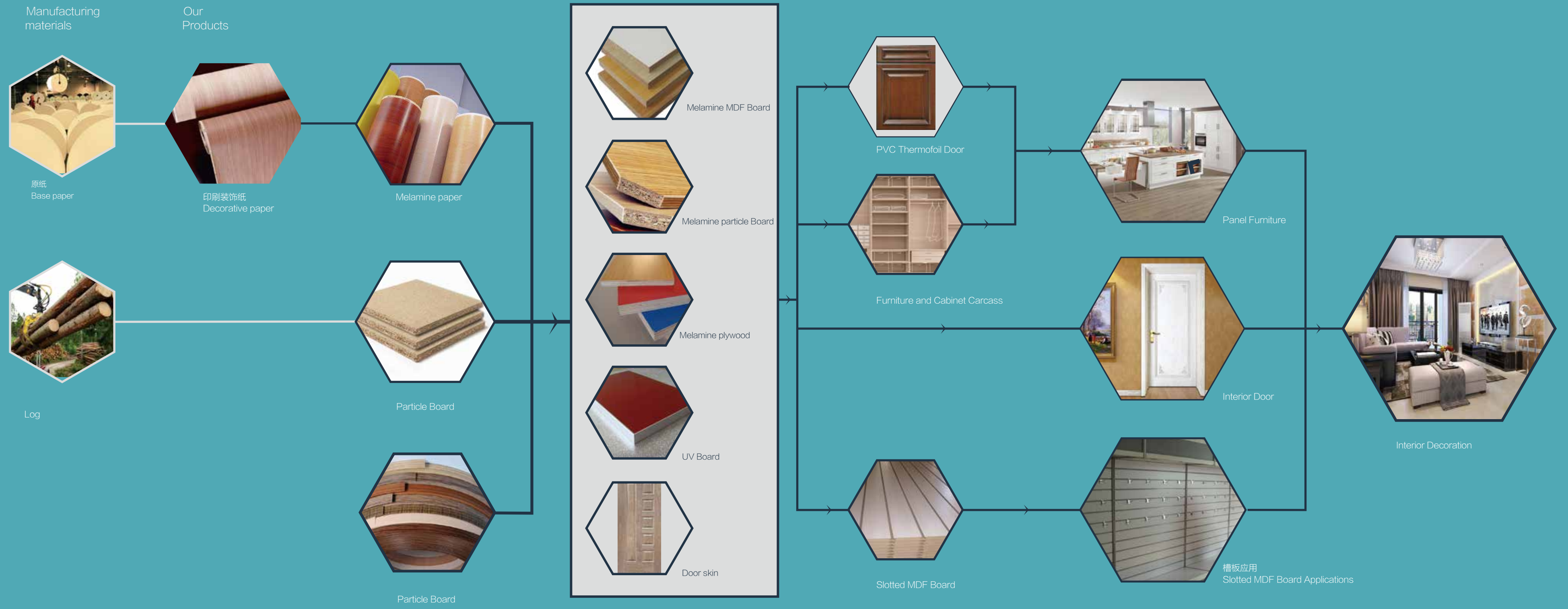

BPD Sourcing
Thermofoil Cabinet

Builders Products Direct
www.buildersproductsdirect.com
shopkins@buildersproductsdirect.com
1-800-891-6680

BPD Sourcing



DECORATIVE PAPER

PRINTED DECORATIVE PAPER



MELAMINE RESIN IMPREGNATED PAPER



Materials: excellent high pressure base paper and imported ink.
 Performance: clear texture, real, strong anti-UV, fadeless and stable color.
 Finished products: low formaldehyde melamine paper, anti-static paper for special purpose. Low cost 45gsm printing paper.
 Size: different sizes melamine paper are available, such as 4x8ft, 5x8ft, 6x8ft, 7x9ft and 8x12ft.



MDF high density



PARTICLE BOARD Performance: customized dimensions, stable and anti-deformation.

ARTIFICIAL BOARD



Products: MDF, PB, PLYWOOD.
 Face design: High glossy, Smooth, Matt, suede and different embossed surface finishing.
 Performance: anti-scratch, anti-fading and anti-aging, Clear and vivid color



PLYWOOD

Performance: high strength, strong screw holding strength and environmentally friendly.



Style: Multi door profile designs.
Surface: matt, high glossy and antique
Performance: imported glue from Germany, stable quality. Completed CNC routered, high precision, automatic and even glue coating. Quality is assured by Germany imported thermofoil forming line: clean, precise, stable..

吸塑门板 PVC THERMOFOIL DOOR



CABINET MATERIAL

Surface finishing: Glossy and Matt.
 Colors: All colors available.
 Performance: Bright and clear color. Rich and good hand-feeling. Strong surface, abrasion resistance and scratch resistance. Excellent stability and anti-fading.

PU LACQUERED BOARD



SLOTTED MDF BOARD

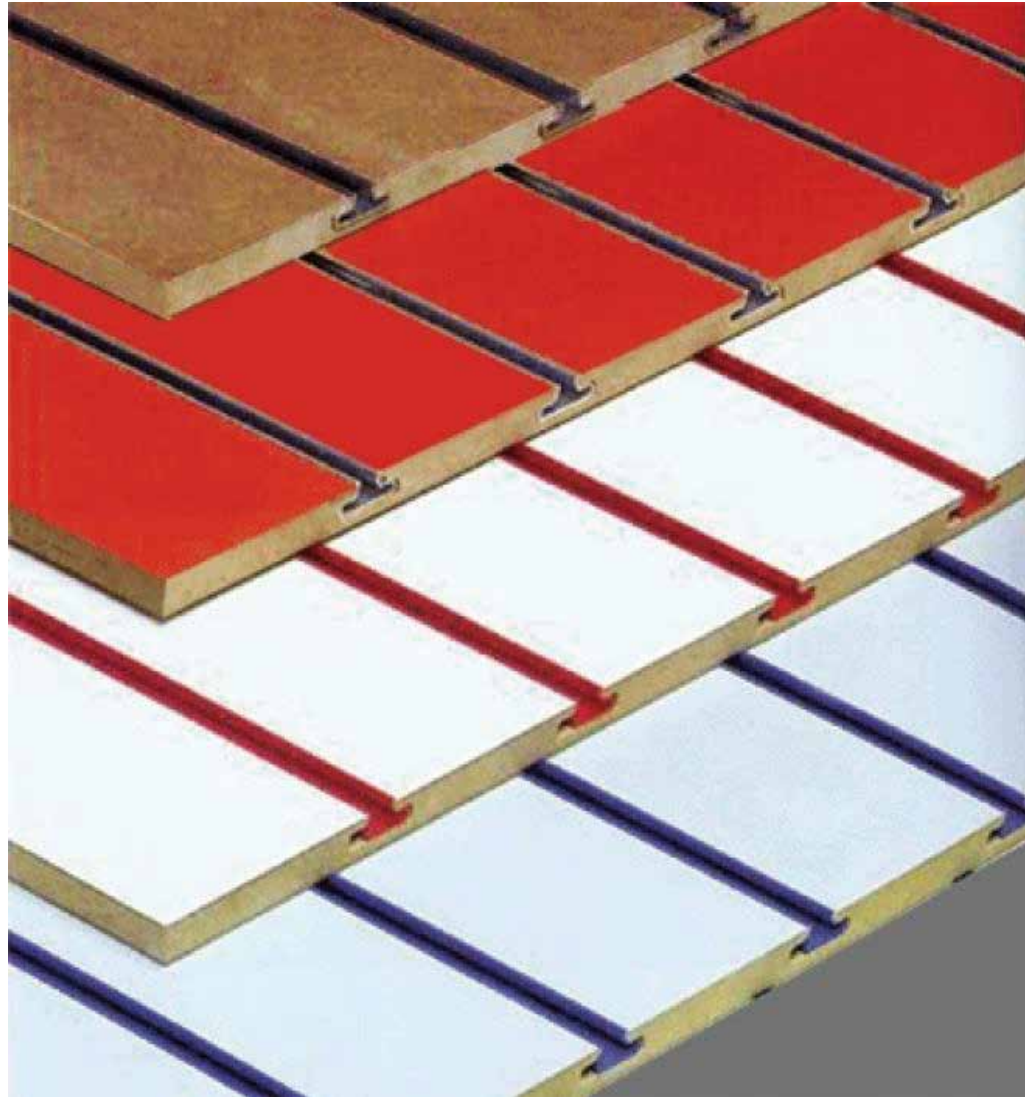

Channel profile: elliptical, rectangular and trapezoid.
Surface finishing smooth, matt and embossed.
Performance: perfect quality, suitable for processing, good looking and high strength.



PVC EDGE BANDING



Color: More than 300 colors and can be produced according to customers' requirements.
Surface Finishing: High glossy, Smooth, Matt, Velvet matt and different embossed surface.
Performance: minor color difference between face and back side, good flexibility, stable and minor color difference for different production batch.











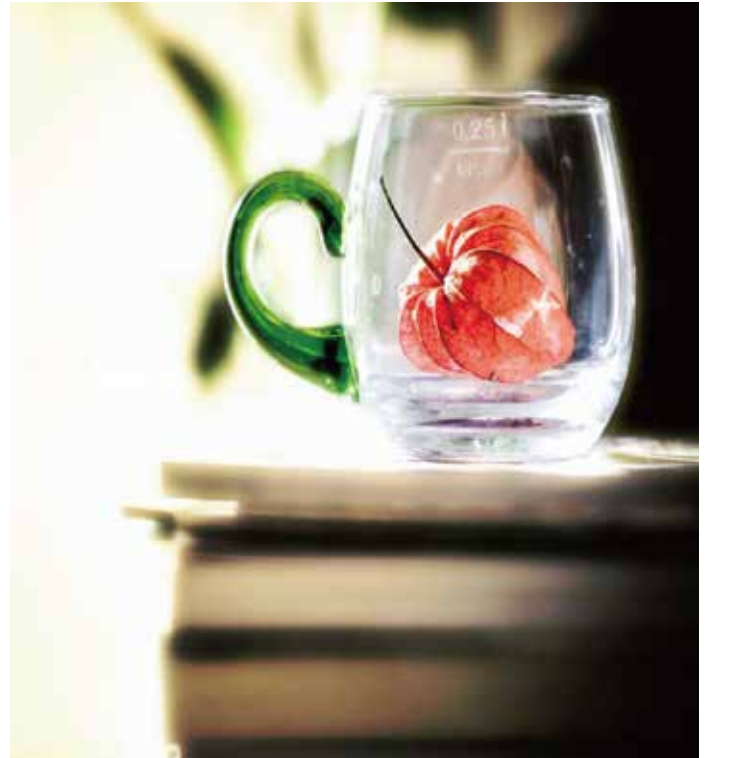







■ ■ ■ WARDROBE DOOR
KITCHEN CABINET DOOR
WALL PROTECTION PANEL



Cabinet Door Style



Cabinet Door Style

Lacquer cabinet door—pure color high glossy



KM12—Ivory White



KM09—Pure White



KM08—Count Gray

Lacquer
cabinet
door



KM12—Aqua Green



KM05—Champagne



KM11—Style Grey



KM07—Coffee

Cabinet Door Style

Lacquer cabinet door—pure color matt



KM10-Pure White



KM06-Count Gray



KM09-Ivory White



KM12-Aqua Green



KM05-Champagne



KM07-Style Grey



KM01-Coffee



KM11-China Red

Cabinet Door Style

Lacquer cabinet door—wood grain piano



KM07 - White Oak



KM08 - Yellow Oak



KM06 - Maple



KM05 - Oak



KM04 - Walnut



KM01 - Black Basswood

Cabinet Door Style

Lacquer cabinet door—automotive paint



KM12-White Pearl



KM11-Automotive Paint



KM08-Purple Silver



KM09-Rosso Corsa



KM04- BMW Champagne



KM02- Golden



KM06- Luxury Golden



KM01- BMW Gray

Cabinet Door Style

Lacquer cabinet door—line drawing



XG03- White with Silver Line



XG04- White with Golden Line



XG03- White with Blue Line



XG04- White with Gray Line

Lacquer cabinet door—Antique



MG38- Antique Yellow Oak



MG33- Antique Ash



MG32- Antique Walnut



MG31- Antique Red Elm

Cabinet Door Style

PVC cabinet door—pure color



MG34-Global White



MJ26-Ivory White



MG37-White Checked



MG38-Long white



KM06-Butternut



KM12-Suede Gray



KM10-Porcelain

PVC
Cabinet
Door



KM11-Rice White Pitted Surface



KM06-Laskine



MJ25-Platinum Brown Checkered



KM10-Azure Blue



KM03-Blueberry



KM05-Golden Cherry



KM08-Golden Yellow



KM11-Sea Blue

Cabinet Door Style

PVC cabinet door—imported film

Cabinet Door Style

PVC cabinet door—high glossy



KM01—Porcelain White

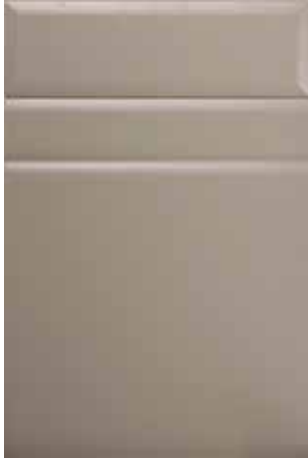

KM06—Pearl Light Grey



KM07—Automotive Paint 760



KM08—Light Purple



KM02—Bentley



KM05—light yellow



KM05—ancient gold



KM04—silvery grey

Cabinet Door Style

PVC cabinet door—wood grain



MJ28— White Wood-Grain



MG35— Gray Oak



MG31— Golden Oak



MG33— Maple



MJ25—Teak



MJ22— Red Elm



KM11—Oak



MG34—Walnut

Component Information



Base cabinet

base units d 23 5/8" –27 9/16" h 23 5/8" –28 3/8"

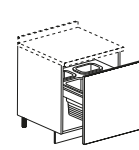

1 dustbin puller
w 17 11/16", 23 5/8"

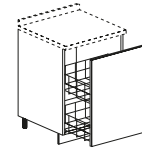

1 puller with baskets
w 5 7/8", 11 13/16", 17 11/16",
23 5/8"

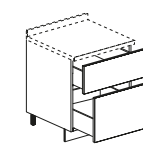

2 pullers
w 11 13/16", 17 11/16", 23 5/8",
29 1/2", 35 7/16", 41 5/16", 47 1/4"

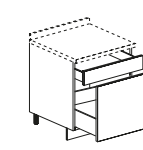

1 drawer, 1 puller
w 11 13/16", 17 11/16", 23 5/8",
29 1/2", 35 7/16"

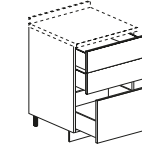

2 drawers, 1 puller
w 11 13/16", 17 11/16", 23 5/8",
29 1/2", 35 7/16", 41 5/16", 47 1/4"

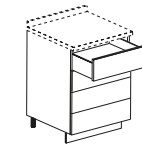

4 drawers
w 11 13/16", 17 11/16", 23 5/8",
29 1/2", 35 7/16", 41 5/16", 47 1/4"

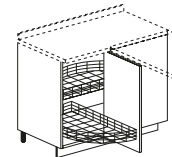

2 revolving baskets
w 43 5/16", 49 3/16"
x d 25 9/16" 29 1/2"

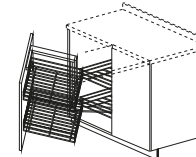

1 pullout structure
w 43 5/16", 49 3/16"
x d 25 9/16" 29 1/2"

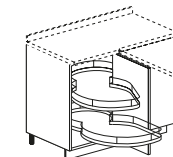

2 pullout baskets
w 43 5/16", 49 3/16"
x d 25 9/16" 29 1/2"

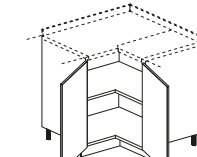

Angle, 2 doors, opening 180°, 1 shelf
w 37 3/8" x 37 3/8"
w 41 5/16" x 41 5/16"

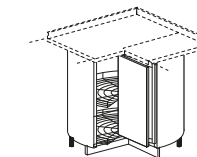

Angle, 2 doors, 2 360°, revolving baskets
w 37 3/8" x 37 3/8"
w 41 5/16" x 41 5/16"

Wall cabinet

upper units D 13 3/8" h 18 7/8" –h 23 5/8" –28 3/8"

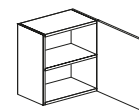

1 door, 1 shelf
w 11 13/16", 17 11/16", 23 5/8"

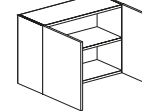

2 doors, 1 shelf
w 29 1/2", 35 7/16"

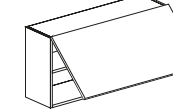

flip opening, 1 shelf
w 17 11/16", 23 5/8", 29 1/2",
35 7/16", 41 5/16", 47 1/4"



1 door, plate rack
w 17 11/16", 23 5/8"



2 doors, plate rack
w 35 7/16"

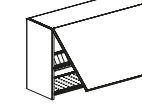

flip opening, plate rack
w 17 11/16", 23 5/8", 29 1/2",
35 7/16", 41 5/16", 47 1/4"

upper units D 13 3/8" h 33 1/16" –37 13/16" –47 1/4"

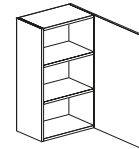

1 door, 2 shelves
w 11 13/16", 17 11/16", 23 5/8"
with plate rack too

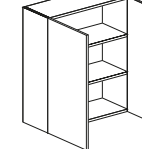

2 doors, 2 shelves
w 29 1/2", 35 7/16"
with plate rack too

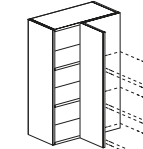

link corner with shelves
or hanging units, 2 shelves
w 25 9/16", 27 1/16", 29 1/2",
37 3/8"

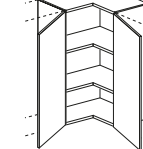

angle, 2 doors opening 180°, 1 shelf
w 25 9/16" x 25 9/16",
27 1/16" x 27 1/16", 29 1/2" x
29 1/2", 25 9/16" x 29 1/2",
29 1/2" x 25 9/16"

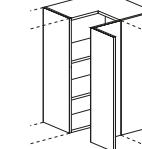

angle, folding door, 2 shelves
w 25 9/16" x 25 9/16",
27 1/16" x 27 1/16"

MT-Cabinet

tall units d 13 3/8" h 54 5/16"

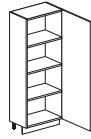

1 door, shelves
w 11 13/16", 17 11/16", 23 5/8"

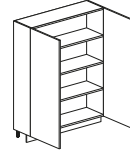

2 doors, shelves
w 35 7/16", 47 1/4"

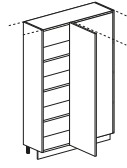

corner, 1 door, shelves
w 43 5/16", 44 3/4", 47 1/4",
49 3/16", 49 5/8", 50 11/16",
53 1/8", 55 1/2"

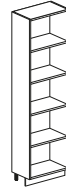

h 54 5/16" -73 1/4" -77 15/16"
d 12 5/8"
fixed shelves w 5 7/8", 11 13/16",
17 11/16", 23 5/8"

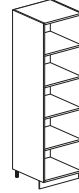

h 54 5/16" -73 1/4" -77 15/16"
d 22 7/16"
fixed shelves w 5 7/8", 11 13/16",
17 11/16", 23 5/8"

tall units d 23 5/8" h 54 5/16"

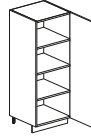

1 door, shelves
w 11 13/16", 17 11/16", 23 5/8"

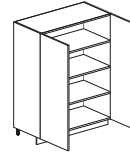

2 doors, shelves
w 35 7/16", 47 1/4"



1 door, pullout revolving equipment
w 11 13/16", 17 11/16"



1 door, pullout equipment
with baskets
w 11 13/16", 17 11/16"

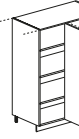

corner, 1 door, shelves
w 43 5/16", 44 3/4", 47 1/4",
49 3/16", 49 5/8", 50 11/16",
53 1/8", 55 1/2"

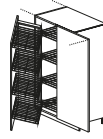

corner, 1 door,
1 pullout structure
w 49 3/16", 50 11/16",
53 1/8", 55 1/2"

T-Cabinet

tall units d 13 3/8" h 82 11/16" -87 3/8"

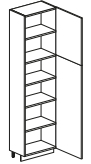

divided doors, shelves
w 11 13/16", 17 11/16", 23 5/8"

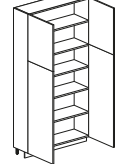

divided doors, shelves
w 35 7/16", 47 1/4"

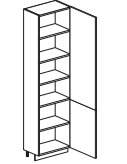

divided doors, shelves
w 11 13/16", 17 11/16", 23 5/8"

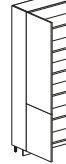

divided doors, shelves
w 35 7/16", 47 1/4"



corner w 43 5/16", 44 3/4",
47 1/4", 49 3/16", 49 5/8",
50 11/16", 53 1/8", 55 1/2"

tall units d 23 5/8" h 82 11/16" -87 3/8"

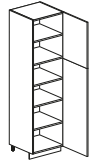

divided doors, shelves
w 11 13/16", 17 11/16", 23 5/8"

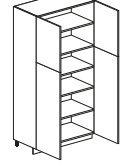

divided doors, shelves
w 35 7/16", 47 1/4"

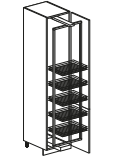

divided doors, pullout
revolving equipment
w 11 13/16", 17 11/16"



corner, divided doors
w 43 5/16", 44 3/4", 47 1/4",
49 3/16", 49 5/8", 50 11/16",
53 1/8", 55 1/2"



corner, divided doors, pullout
structure
corner, divided doors, pullout
w 55 1/2"

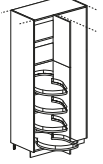

corner, pullout baskets
w 43 5/16", 44 3/4", 47 1/4",
49 3/16", 49 5/8", 50 11/16",
53 1/8", 55 1/2"

tall units for refrigerator d 23 5/8" h 54 5/16" -73 1/4" -77 15/16" -82 11/16" -87 3/8"

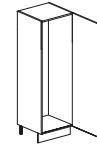

1 door, refrigerator unit
h 54 5/16" only this tall unit
w 23 5/8"

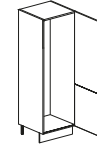

divided doors, refrigerator unit
w 23 5/8"

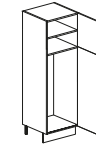

divided doors, refrigerator unit
w 23 5/8"

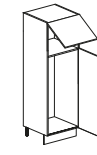

h 73 1/4" -77 15/16"
door, flip opening, refrigerator unit
w 23 5/8"

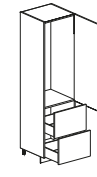

h 77 15/16" -82 11/16" -87 3/8"
door, 2 pullers, refrigerator unit
w 23 5/8"

tall units for oven d 23 5/8" h 54 5/16"

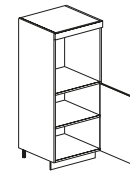

door, shelves, oven unit
w 23 5/8"

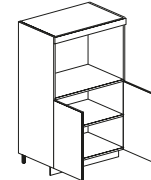

2 doors, shelves, oven unit
w 35 7/16"

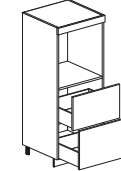

2 pullers, oven unit
w 23 5/8", 35 7/16"

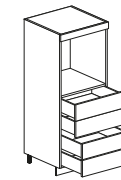

4 drawers, oven unit
w 23 5/8"

tall units for oven d 23 5/8" h 73 1/4" -77 15/16" -82 11/16" -87 3/8"

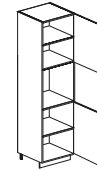

doors, shelves, oven unit
w 23 5/8"

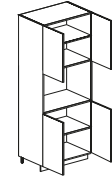

doors, shelves, oven unit
w 35 7/16";
w 27 9/16", 30" exc h 73 1/4"

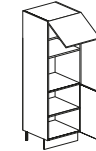

h 73 1/4" -77 15/16"
door, flip opening, shelves, oven unit
w 23 5/8"

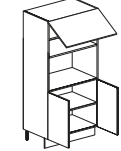

h 73 1/4" -77 15/16"
door, flip opening, shelves, oven unit
w 35 7/16";
w 27 9/16", 30" exc h 73 1/4"

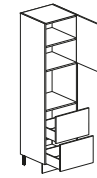

door, 2 pullers, shelves, oven unit
w 23 5/8"

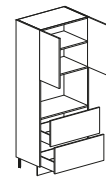

doors, 2 pullers, shelves, oven unit
w 35 7/16";
w 27 9/16", 30" exc h 73 1/4"

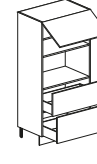

h 73 1/4" -77 15/16"
flip opening, 2 pullers, oven unit
w 23 5/8", 35 7/16";
w 27 9/16", 30" exc h 73 1/4"

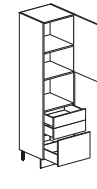

door, 1 puller, 2 drawers, oven unit
w 23 5/8"

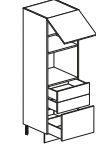

h 73 1/4" -77 15/16"
flip opening, 1 puller, 2 drawers
oven unit
w 23 5/8"

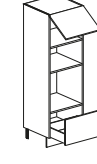

h 73 1/4" -77 15/16"
flip opening, 1 puller, shelves, oven
unit w 23 5/8"

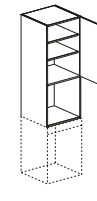

door, oven unit and appliance unit
w 23 5/8"

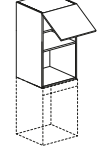

h 73 1/4" -77 15/16"
opening, oven unit and appliance
unit w 23 5/8"

Personalized standard tank

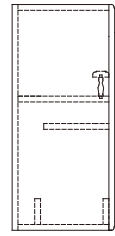
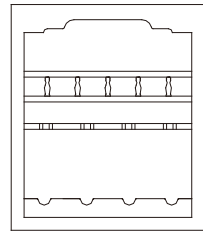

60/80 Wine Rack
(Elevation)
D32 × W60 × H70

(Side Elevation)

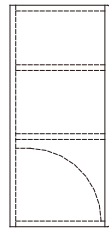
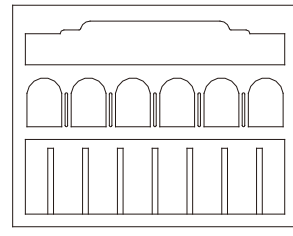

80/90 Wine Rack (Elevation)
D32 × W80 × H70

(Side Elevation)

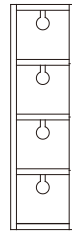

20 Spice Rack
(elevation)
D20 × W20 × H70

(Side Elevation)

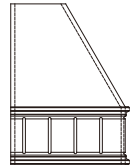
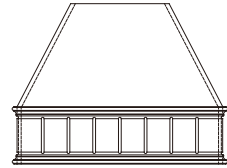

Hoods for Kitchens-A
(elevation)
D50 × W90 × H70

(Side Elevation)

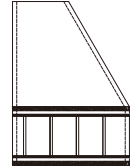
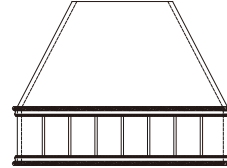

Hoods for Kitchens-B
(elevation)
D50 × W90 × H70

(Side Elevation)



60 Spice Rack (elevation)
D20 × W60 × H24

(Side Elevation)

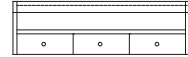

80 Spice Rack (elevation)
D20 × W80 × H24

(Side Elevation)

Roman Column Model



LMZ-01
D2.2 × W6 × H(60-242)



LMZ-02
D2.2 × W8 × H(60-242)



LMZ-03
D2.2 × W8 × H(60-242)



LMZ-04
D3.2 × W8 × H(60-242)

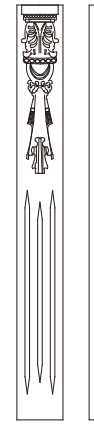

LMZ-05
D3.5 × W8 × H(60-242)

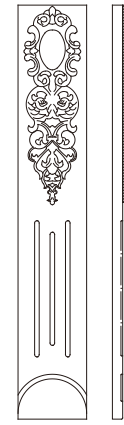

LMZ-06
D2.8 × W12 × H(60-242)

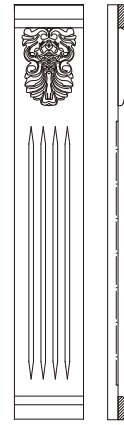

LMZ-07
D3.5 × W12 × H(60-242)

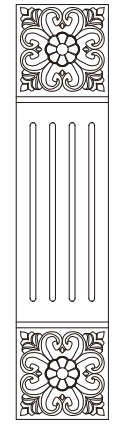

LMZ-08
D2.4 × W12 × H(60-242)

Standard Graph



Decorative Top Line Shape

Eyebrow and Light Line Shape

DX-01
W242 × H8

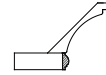

DX-02
W242 × H8

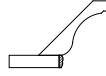

DX-03
W242 × H8

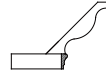

DX-04
W242 × H8.7

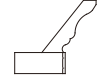

DX-05
W242 × H9.2

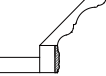

DX-06
W242 × H10

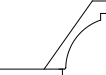

DX-07
W242 × H11.5

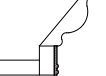

DX-08
W242 × H12

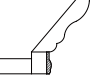

MX-01
D1.8 × W80 × H8



MX-02
D1.8 × W80 × H8

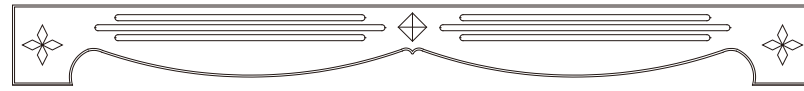

MX-03
D1.8 × W80 × H8

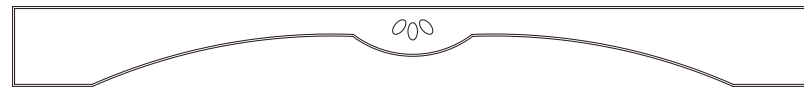

MX-04
D1.8 × W80 × H8



DK-01
D1.8 × W242 × H4



DK-02
D1.8 × W242 × H4



DK-03
D1.8 × W242 × H4



DK-04
D1.8 × W242 × H3.5

