

**CLARIWASH FILTRATION
SYSTEM
ASSEMBLY MANUAL**

INTRODUCTION

The ClariWash system is a self washing filtration system which is hydraulically automatic and does not need manual intervention or a control system to achieve backwash. Provided raw water is supplied to the inlet, the system should continue to operate indefinitely, filtering the water and periodically back-washing, requiring little maintenance. The system is formed from locally available plastic pipes tanks and plumbing and does not require a manufacturing process. Thus keeps the cost low.

In order for the system to operate correctly, it is important that the geometry and dimensions shown on the scheme drawings (supplied separately) are adhered to exactly and that the completed system is tested and shown to be leak tight.

This manual is a step by step guide showing the method and order of assembly of the system.

There are separate instructions for installing the filter media, testing and commissioning of the system.

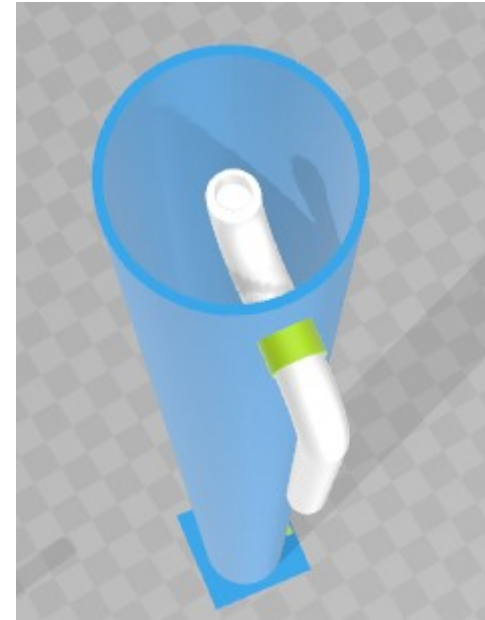
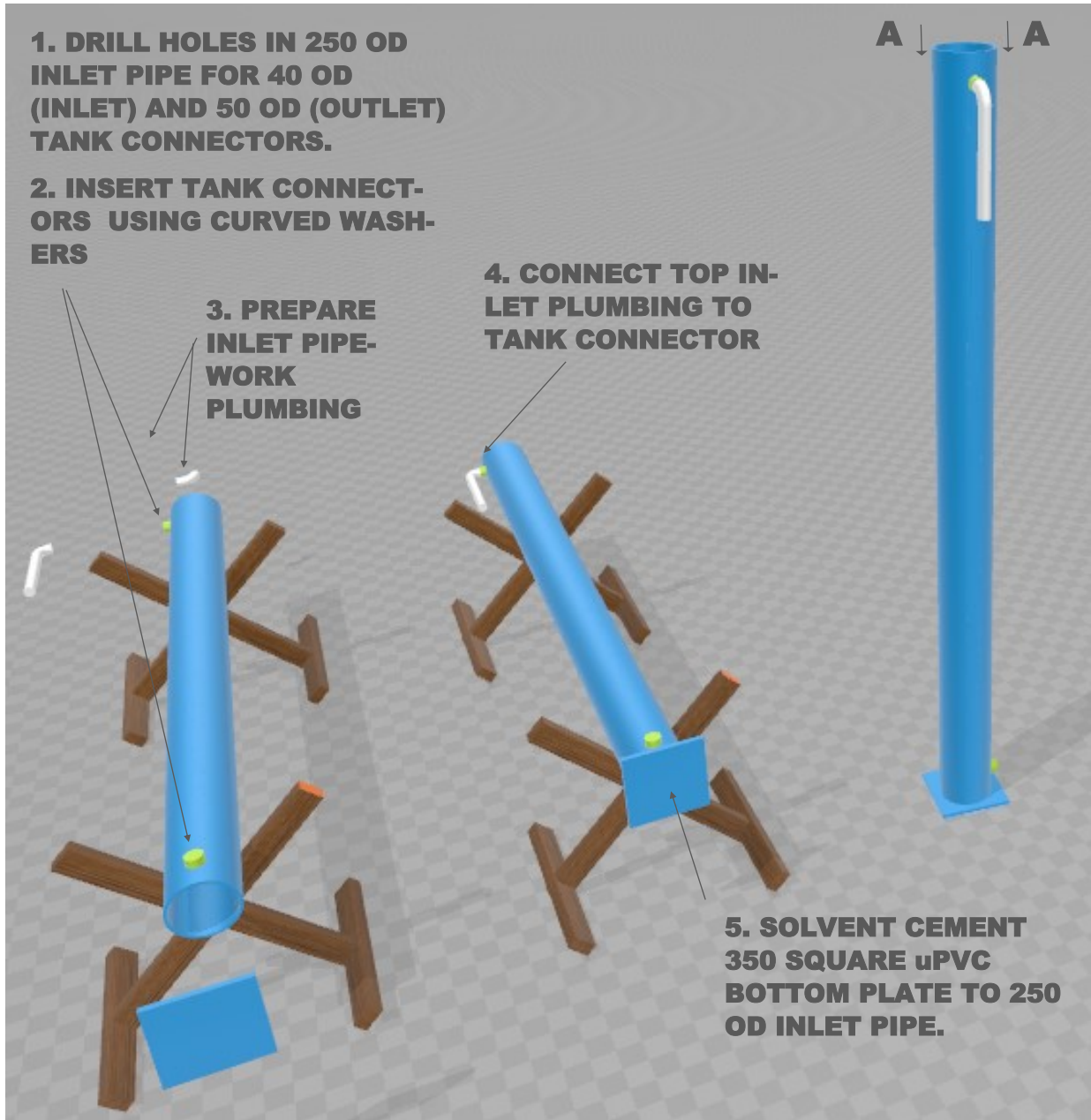

VIEW ON A-A

INLET PIPE ASSEMBLY

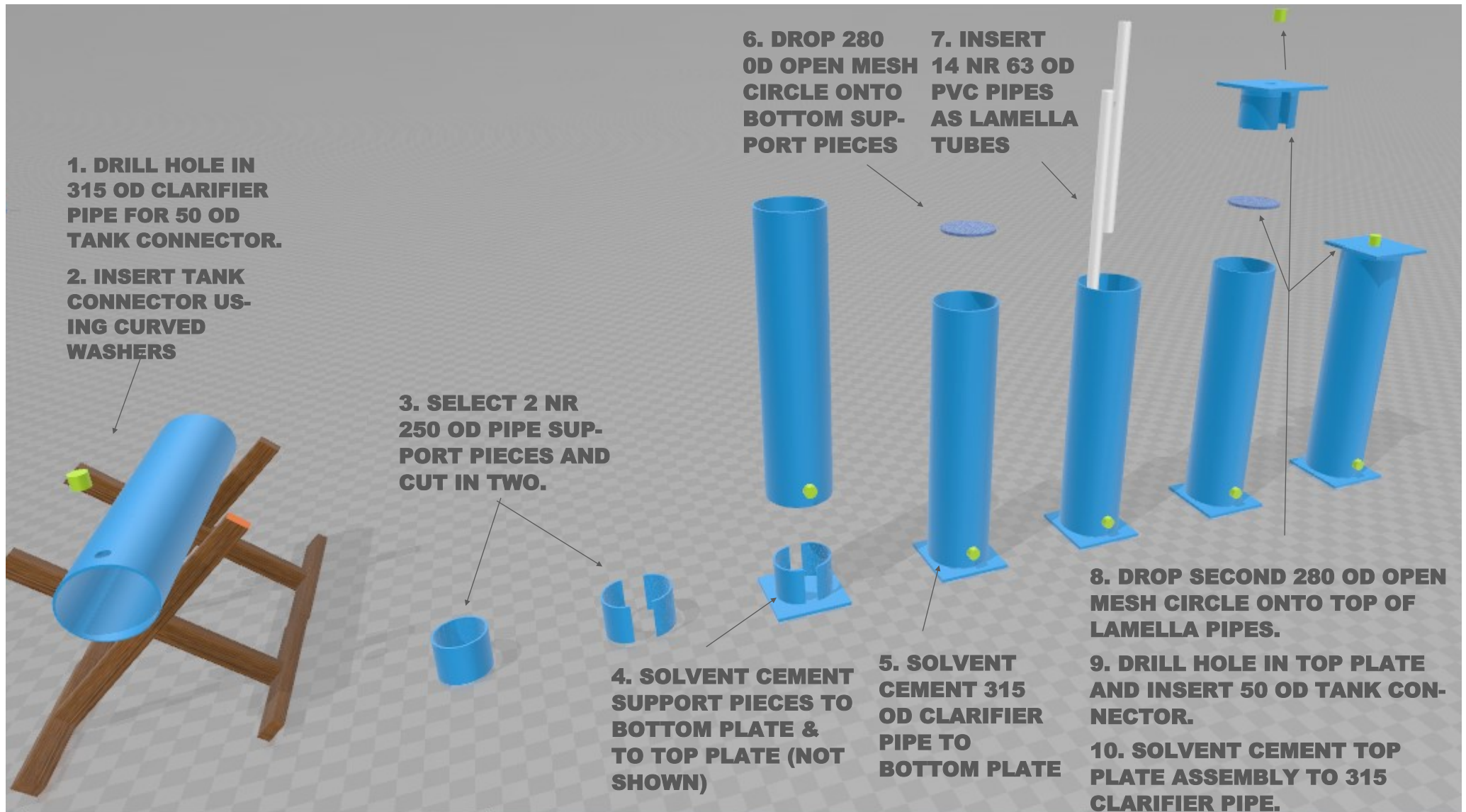

TUBE CLARIFIER ASSEMBLY

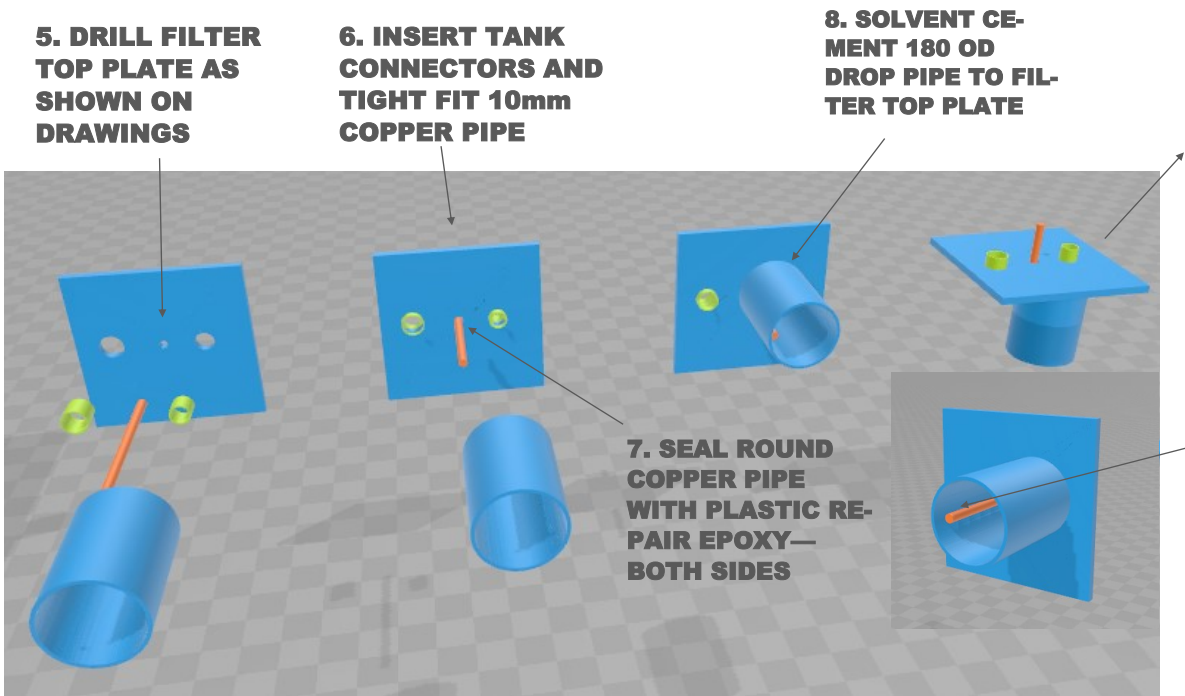
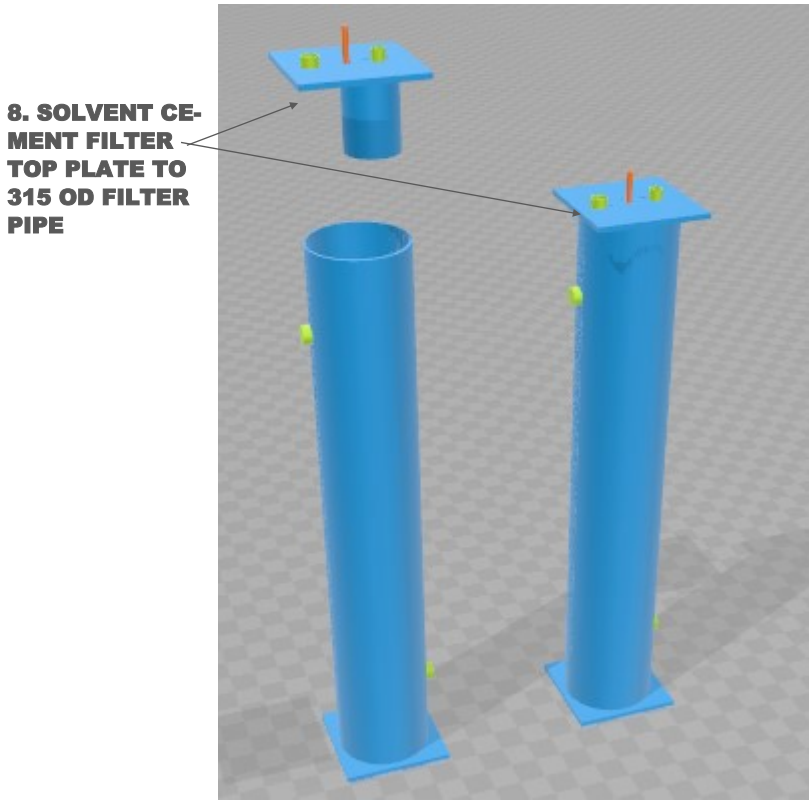
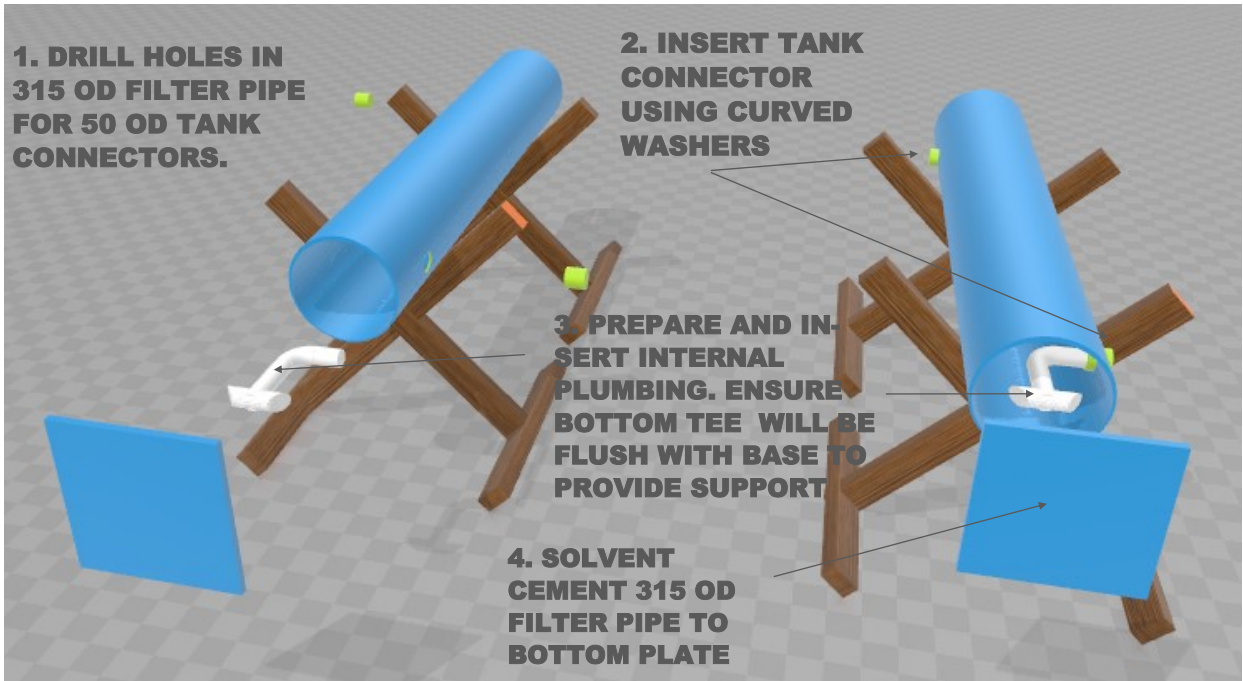

9. PLASTIC REPAIR EPOXY BETWEEN 180 DROP PIPE AND COPPER PIPE TO HOLD IN PLACE

FILTER ASSEMBLY

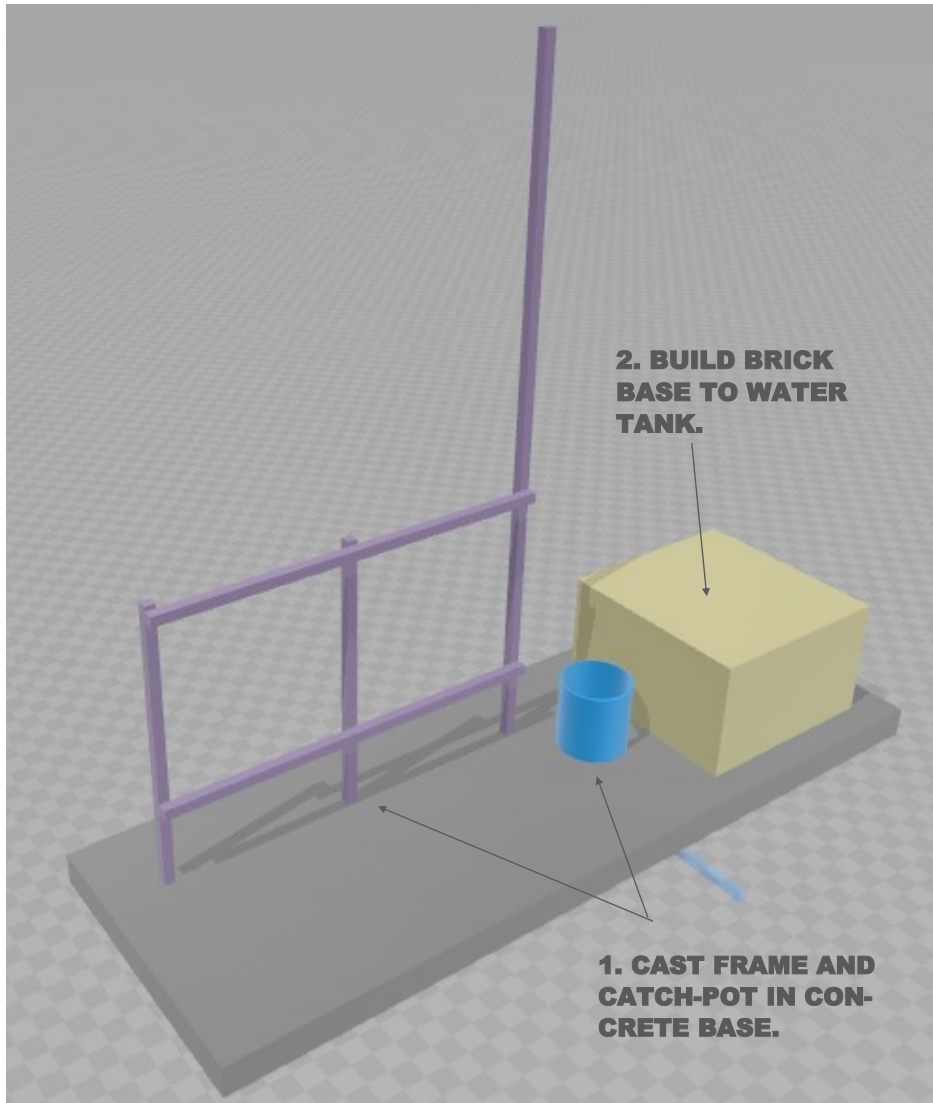

**BASE/FRAME
ASSEMBLY**

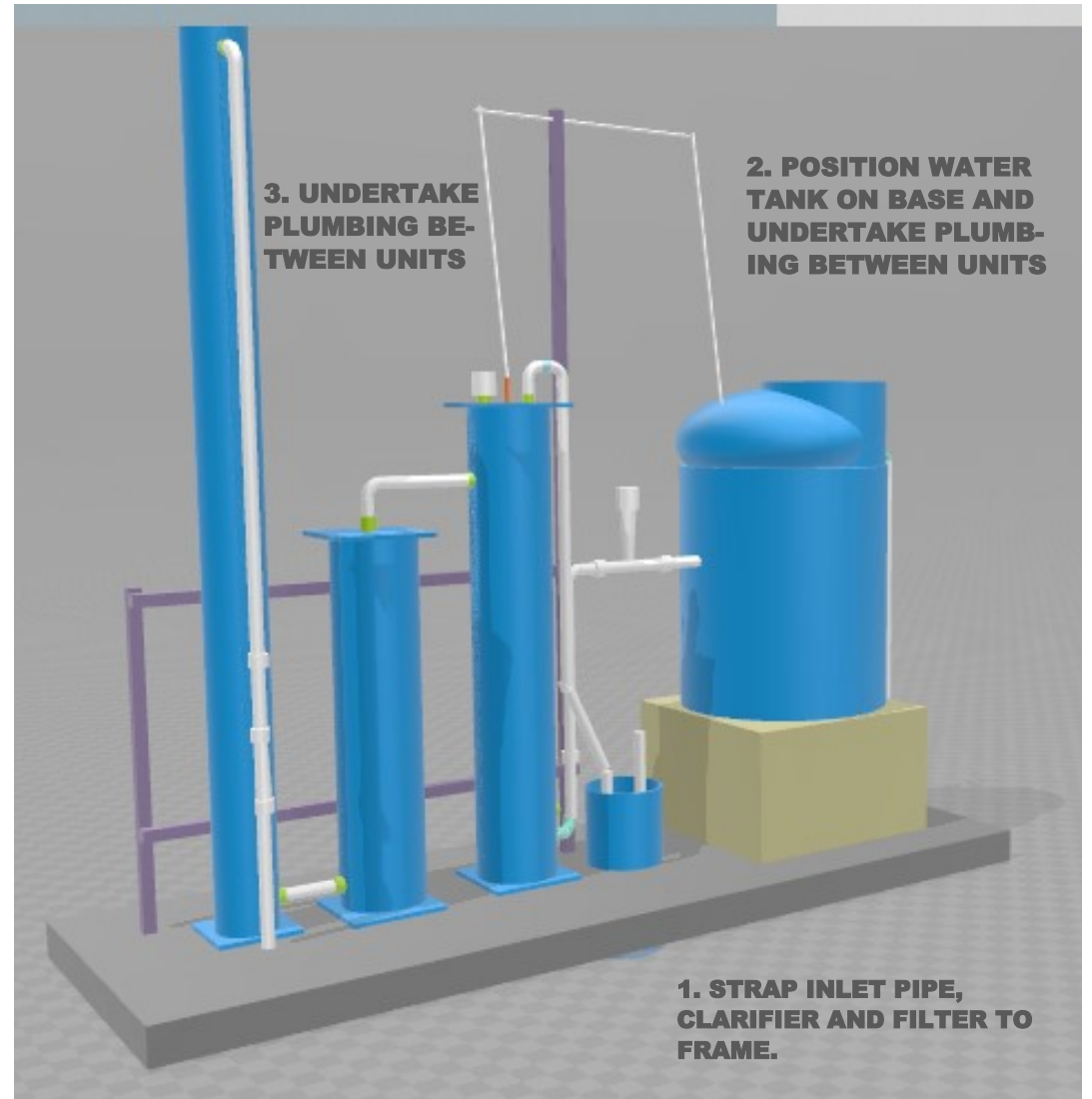

**4. CARRY OUT WATER TEST (SEE SEPARATE INSTRUCTIONS)
5. INSTALL FILTER MEDIA (SEE SEPARATE INSTRUCTIONS)**

COMPLETE SYSTEM