



# MV KEEWATIN

## GENERAL

MV Keewatin is a Canadian flagged, Multi-Purpose tug built in Vancouver (1974) at Yarrows Shipyard. The tug was formally owned by Northern Transportation Company Limited (NTCL) with her primary purpose operating in the Western Arctic, specifically the Mackenzie River, NWT and coastal work in the region. The Keewatin has been operating on the East Coast of Canada for the past 20+ years on various specialized tug and barge projects for the mining industry and other coastal projects and offshore support. The tug is ice navigable and has been played a vital role in marine transportation via tug and barge to the Hudson Bay region over the years for community and industry cargoes. Most recently, the Keewatin in 2019 has successfully completed offshore surveillance duties at the Hibernia Site and other incremental projects with regards to harbour assist and coastal deliveries.



*Narrows,  
St. John's, Newfoundland*

## PRINCIPAL DIMENSIONS

Length Overall	38.33m / 126' 6"
Length @ WL	37.58m / 124' 0"
Breadth Moulded	11.52m / 38' 1"
Depth Moulded	3.64m / 12' 1"
Light Draught	1.97m / 6' 6"
Loaded Draught	2.67m / 8' 10" »
Gross Tonnage	476 T
Net Tonnage	198 T
Accommodation	9 Crew
	2 Supernumeries



*Offshore Support*



*Harbour Assist*

**PROPULSION**

Main Propulsion Triple Screw  
 3 - Caterpillar D399, 1125 HP each @ 1,050 RPM

Reduction Gears 3 - Caterpillar, Model 7261  
 Ratio 2.89:1 ahead / 3.18:1 astern  
 Brake HP - 3,375 BHP

Propellers Three (3): One (1) center righthand turning,  
 Two (2) outer inboard turning (Kort Nozzles)  
 60" diameter x 54" pitch

Rudders Six (6)

Auxiliary Gen Sets Two (2)  
 Port Cat D3304, RPM 1800 c/w  
 Kato Volts 230, 3PH, 90 KW  
 Starboard Cat D3306, RPM 1800 c/w  
 Brown Bovari Volts  
 230, 3PH, 115KW

Emergency Gen Set Harbour Kohler, Gasoline Engine  
 Model 15RN181, 4 cylinder, 1800 RPM  
 Volts 208/220, 3PH, 20KW

Fuel Consumption 6.5 - 7.5 m3 / day

Range 5,500 Nautical Miles

Max Speed 9.5 knots

Towing Speed 6.5 knots

**DECK EQUIPMENT**

Tow Winch Burrard Iron Works Ltd.  
 2 drum, Type HF-D  
 Capacity 2500' of 1 3/4" SWR on each  
 Each Brake designed to hold 100,000Ibs.  
 Mid drum Pull 36,000Ibs @ 75 FPM or  
 18,000Ibs @ 150 FPM

Anchor Windlass Harrison & Robbins  
 Hydraulic with 150 FMS of 1 1/4" chain

Anchors Three (3) - 2000Ibs Navy



**NAVIGATION & COMMUNICATION**

2 - Gyro Compasses  
 1 - Auto Pilot  
 1 - Marine Fax  
 1 - Satellite Navigator  
 1 - Indicating Echo Sounder  
 1 - Chart Recorder Sounder  
 2 - Radars  
 3 - Searchlights  
 1 - VHF Radio Telephone  
 2 - HF Radio Telephones, Single Side Band  
 1 - Direction Finder  
 1 - Loudhailer  
 1 - EPIRB  
 1 - Magnetic Compass

**CAPACITIES**

Fuel 236,000 Litres  
 51,900 Imperial Gallons

Fresh Water 41,000 Litres  
 9,000 Imperial Gallons

**REFRIDGERATED STORAGE**

Freezer 460 cubic feet  
 Cooler 600 cubic feet  
 Dry Goods 1100 cubic feet

**SPECIAL FEATURES**

Meets Transport Canada, MARPOL, SOLAS,  
 & IMO requirements, standards and regulations.



# GENERAL ARRANGEMENT PLAN – MV KEEWATIN

## SIDE PROFILE

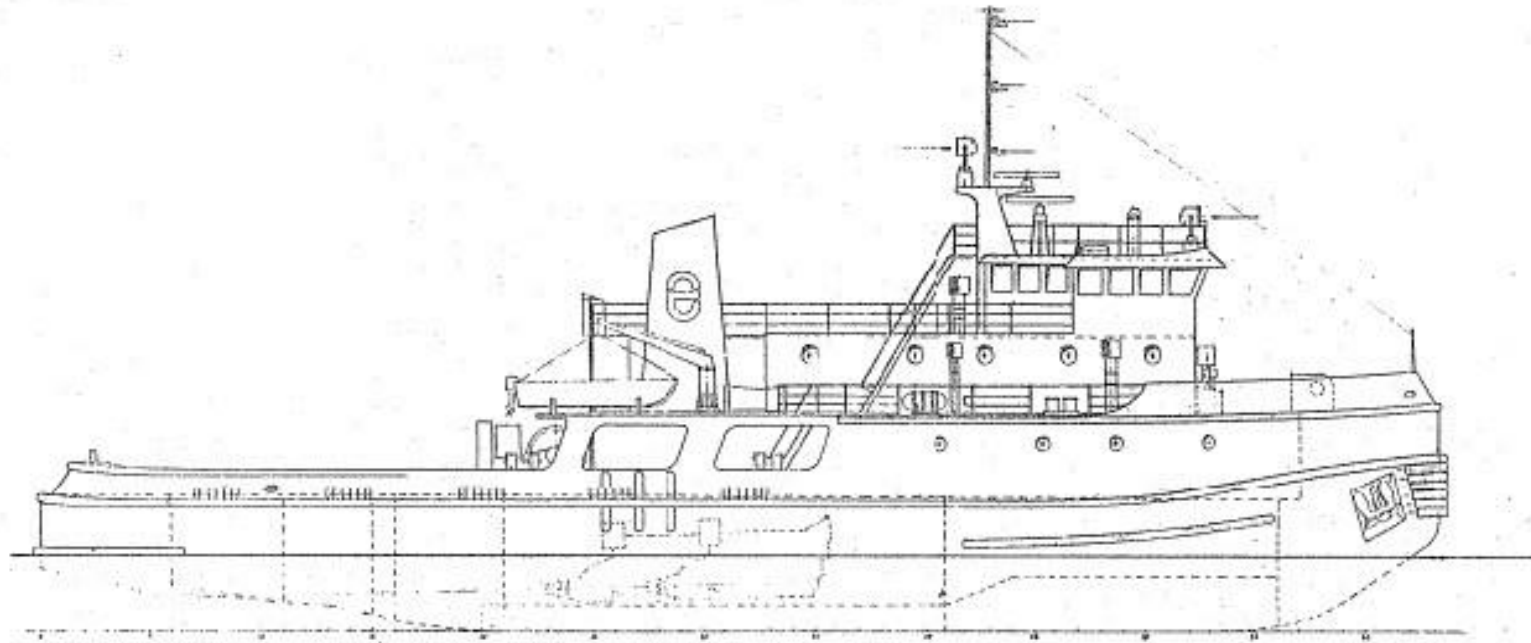

# TANK PLAN

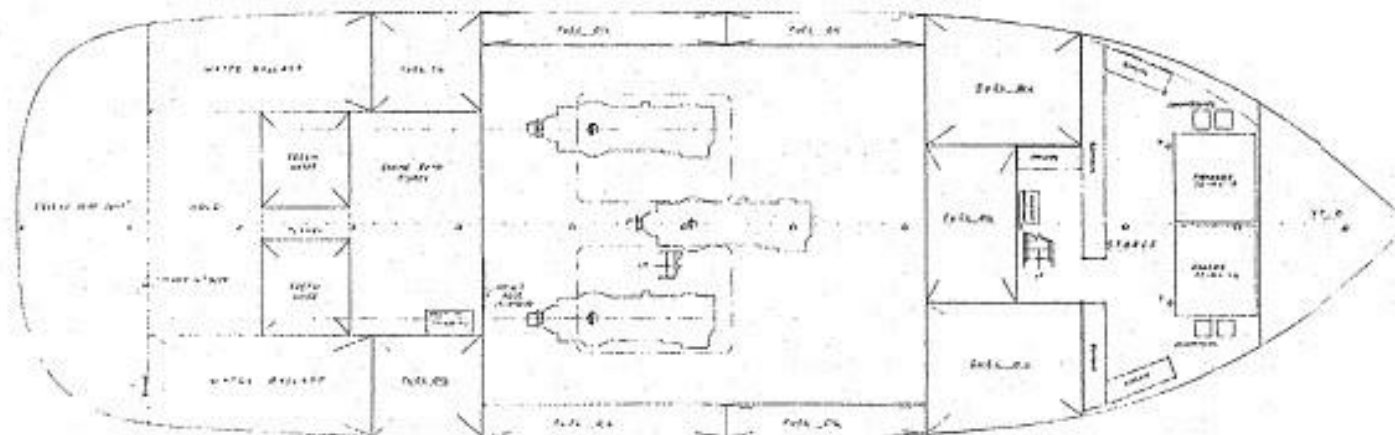

# FORECASTLE DECK

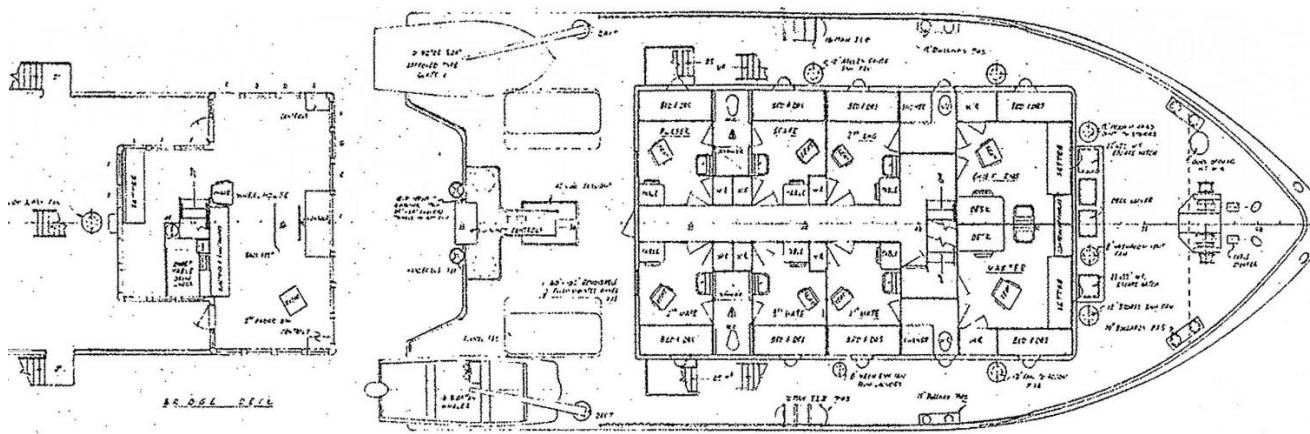

## MAIN DECK

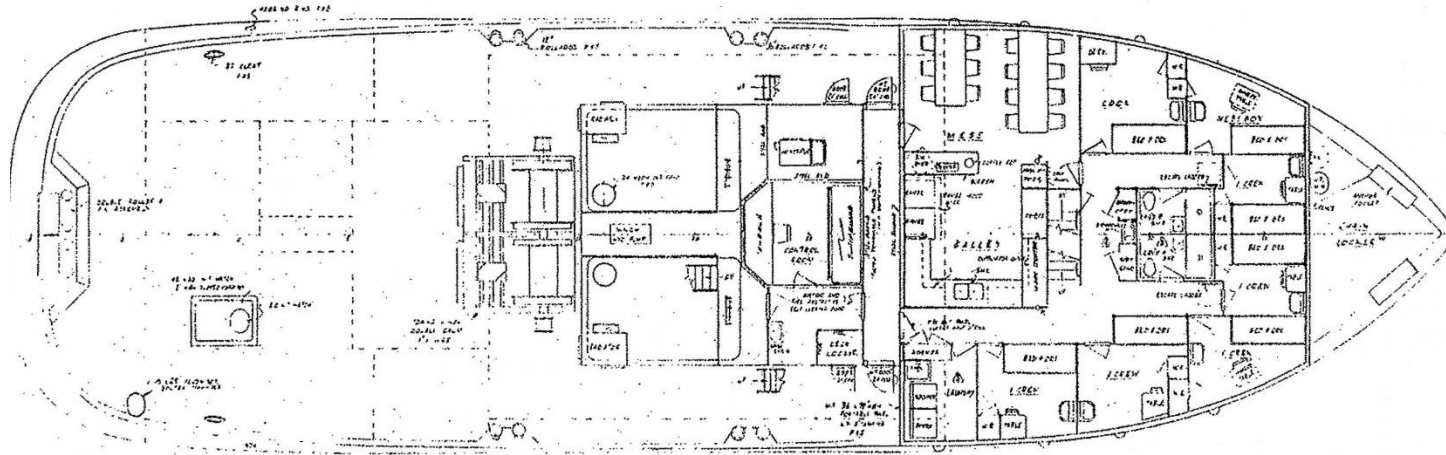

### RJG CONSTRUCTION LIMITED

P.O. Box 8421, Str. A • St. John's, NL A1B 3N9 • 162 Duckworth Street, Suite 300 • St. John's, NL • A1C 1G2  
Phone: (709) 753-5229 • Facsimile: (709) 753-4676

Vessel Chartering: [aperrot@rjgconstruction.com](mailto:aperrot@rjgconstruction.com)  
Website: [www.rjgconstruction.com](http://www.rjgconstruction.com)

📞 24/7 Rescue Towing & Salvage • (709) 691-8027 📞