



Owners Mannual for ICS Quality Baths

ICS Quality Baths is a major supplier of many types of bathtubs. Care instructions vary from type to type, but all of our tubs are easy to clean.

For general cleaning, all types of tubs can be cleaned with liquid kitchen and bath cleaners that are non- abrasive. Use a cotton terry cloth, clean sponge, or solid white paper towel to apply the cleaner. Do not use chemicals or abrasives on your tub until you check the following specific instructions for each tub type.



Vaccum Formed Acrylics: No Painted suraces 2018 pg2

Drop-In or Skirted Tile Flanged Tubs All white or biscuit acrylic tubs

Two-Piece Acrylic Freestanding All white or biscuit acrylic tubs

Acrylic Claw Foot Freestanding No custom painted exteriors

Acrylic Pedestal Freestanding "

Classic Skirted Freestanding "

- 1) For general cleaning, use most comercial kitchen and bath cleaners on a weekly basis.
- 2) For glue and hard to remove sticky materials and paint overspray use car polishes, auto waxes or silicone spray wax designed for exterior car use. Use alcohol only if you are sure your tub has no painted surfaces. Do not use Actetone, Mineral Spirts or paint removers !
- 3) Fine surface scratches can be buffed out with an auto polishing compound. Acrylic is thicker at the top of the tub and thinner at the bottom.
- 4) Scratches you can feel with your fingernail can be sanded out with 600 grit sand paper followed by 2000 or finer sand papers and polish with auto polishing compond to restore the shine. This is for the tub interior only, unless you are sure your tub has no paint.
- 5) If you have gouges, cracks, or spots where you can see the fiberglass underlayment, please call a tub repair professional to repair or replace the tub.

Seamless Acrylic Freestanding Tubs and Acrylic Tubs with Custom Painted Exteriors: Special Custom Exterior Colors:

ICS does not paint the interior of any tub.

The exterior custom colors are car paint. Clean carefully with liquid bath cleaners and never use alcohol or any chemicals. Auto polish and wax are best for stubborn stains or sticky substances on the tub.

Seamless acrylics are chemically welded, filed, sanded and painted on the exterior near the top of the tub. Care should be taken in this area of the exterior, like a custom color.

Seamless tubs with scratches, gouges, or deep scrapes near the top cannot be sanded out and will require a painting professional to restore the original appearence of the exterior of your tub.

Use the same instructions as Acrylic above. Today's Gel Coats are much improved and often hold up as well as acrylic with these main advantages:

***Thickness is consistent over the entire tub, while vacuum formed acrylics are thicker at the top and thinner at the bottom of tub.**

***Deep gouges in the gel coat can easily be fixed or replaced, where acrylic, never being a liquid, cannot be replaced after tub is made.**

***Deep tub designs are best suited for baked hardened gel coats.**

Enameled Cast Iron: A Time Tested Favorite

The interior of your cast iron tub is made by dropping dry porcelain on a fiery hot tub and the finish is then melted, thus the inconsistent thickness and slight runs are common.

The exterior of your tub was painted with quality car paints. Some finishes have clear coats over basic paint, and some finishes have multiple layers of paint.

Clean the inside of your tub using the same instructions above for Acrylic tubs. You may use alcohol on the interior of the tub **ONLY**.

Any major damage to the exterior will require a painting professional to repair.

Minor surface scratches can be polished out with auto polish on the interior only.

Chipped porcelain can be filled and painted over by a repair professional. There are commercially available kits from hardware stores that can cover small repairs.

Cast Solid Surface Tubs: Solid and Thick color All the Way

Solid surfaces are poured from stone and resins. The surface is more porous than other finishes but can be sanded to clean stubborn stains. Use 300 to 800 grit foam sanding blocks. ICS uses Simple Green, Mean Green, Purple Power, etc with rags and foam sanding blocks. Minor scratches and sometimes deep scratches can be sanded out because there is a lot of material to work with. Polishing with car polish is recommended periodically.



Water Jetted Tubs

pg 4

Jetted tubs operate from on-off buttons which turn pumps on with a quick push of a button. A rubber balloon in the body of the on-off button is compressed and a puff of air exits at the pump, activating a pressure switch.

Some jetted tubs have a variable speed control with maximum and minimum settings which allow air to bleed into pump impeller, reducing all jet pressures.

ICS uses adjustable jets where possible. Adjust the flow by turning the face. Some jets will turn 360 degrees, while others will hit a stop position to the left or right. Turn by hand only!

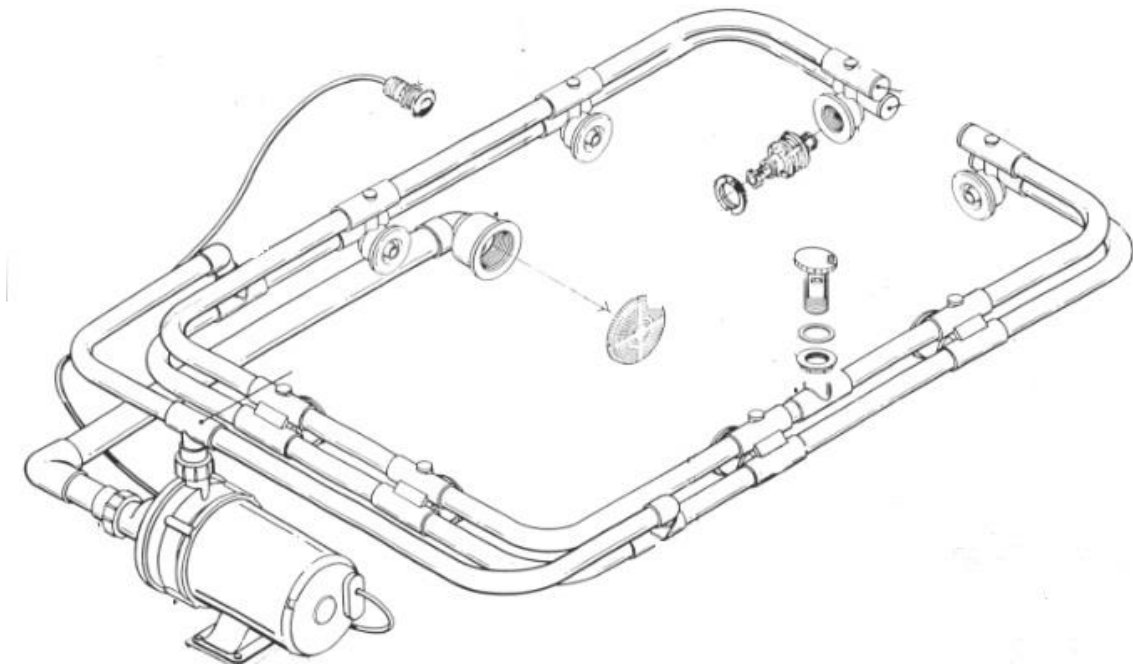

Typical Jetted tub System

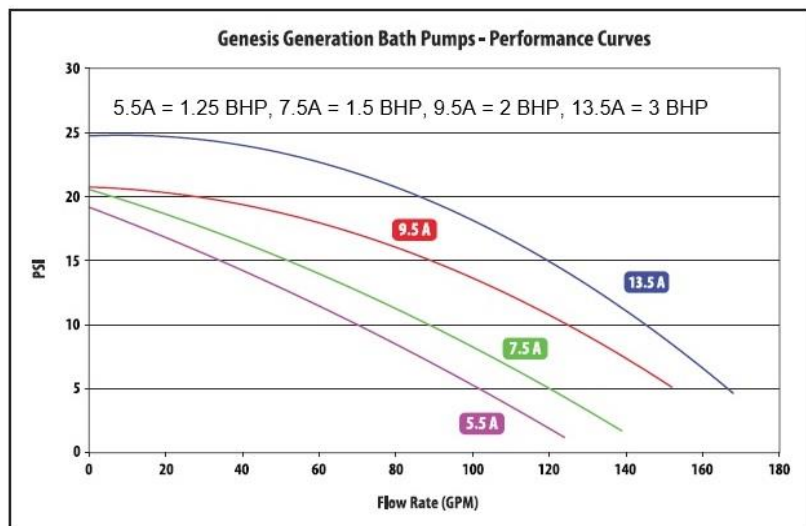
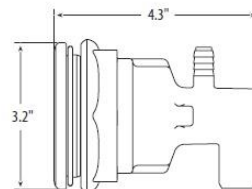
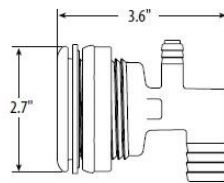

Water enters the jetted tub system from the jets and suction fitting, then is circulated by the pump. Soap, body oil, dirt, and scum accumulate in pipes during use and is normal.

Use of bubble baths and bath salts will void pump warranty and build up will occur in lines and fittings. ICS recommends limited use of bubble baths and scented products, and no use of salts.

Optional Heaters with 120 V 1500 watt or Friction styles are not user adjustable and are automatic.

To clean, pour 1/2 cup of bleach into a half tub of water, covering the jets. Add a squirt of Dawn liquid soap and run the pump for half an hour/every 3 months.

ICS Air Jetted Tubs



Typical Air Jetted Drop-In Tub

Sidewall Mounted Jets

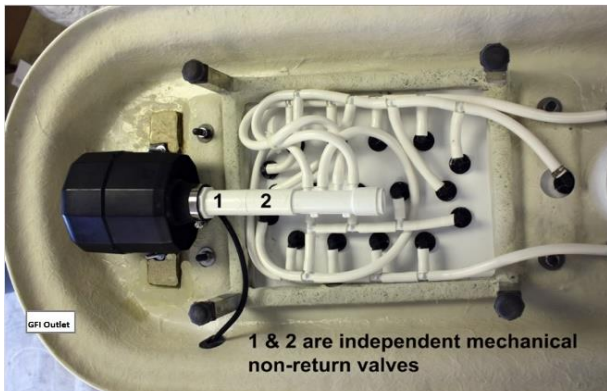

Pedestal Mounted Blower

1 & 2 are independent mechanical non-return valves

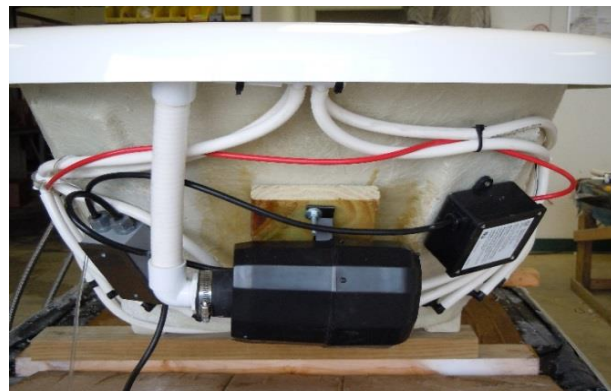

Tub Mounted Blower

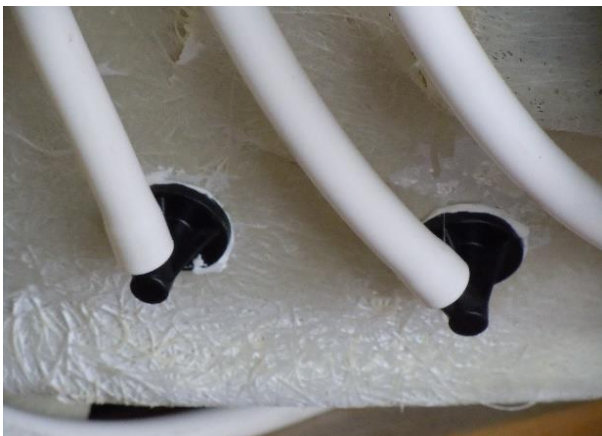

Real Air Jets instead of Drilled Holes

No routine maintenance is required for air tubs.

The 200 watt heater inside blower is automatic.

Push button on-off cycles blower through speeds

Auto Purge runs blower after each use

20 minute timed delay on auto purge

ICS Walk-In tubs use a rubber gasket to seal the door that is pressure operated by the door handle. Keep this gasket clean by soaking it in Dawn liquid soap dissolved in water, using a soft cloth.

There are a few special instructions for walk-in baths. The hardened marine graded gel -coat finish will last for many years of normal use. Application on car polish to the finish twice a year will preserve the finish from oxidation and extend the life. Do not polish or wax the floor of the tub!

Always use a non slip floor mats outside the door for extra safety from a fall.



Tub Installation: Tub Creaks or Pops When Standing in the Empty Tubs

Drop-in tubs are set in concrete and concrete shrinks when cured. If noise goes away when tub is full of water, do nothing. Placing paper or plastic between concrete and the tub would have prevented the noise, but once tub is set ICS recommends leaving tub set as is.

Freestanding tubs have adjustable legs designed to support the weight of the tub, water, & bather. If legs were not adjusted properly, fiberglass is bending to compensate for the weight. Remove tub, flip upside down and adjust legs level with or slightly below tub base or skirt. Drain height is important as tub will rock back and forth on a high drain hub.

Walk-In Tub Gasket Leaks

Clean gasket per instructions above. If problem persists, check if the tub is level so weight is distributed evenly. If door still leaks call ICS for a thicker door cam to tighten the door.

Whirlpool Jetted Tub Motor or Air Blower Does Not Operate

Reset the GFCI. Ground Fault Circuit Interrupters are tripped by a power surge or lightning. Make sure equipment is plugged in or there is no power outage. Check power at receptacle plug-in. Finally, check the connection of the air hose from the on-off button actuator to the equipment. A loose hose will not carry air sufficient to trip air switch.

One or More Jets Do Not Operate Properly

Turn the face of the adjustable water jets to activate flow. If equipped with variable pump speed control turn to maximum before adjusting adjustable jets. Air jets are not adjustable and will vary slightly based on location of jet and the location of bather covering some of the air jets.

Water Pump Surges and Pulsates or Stops Pumping

Modern suction pumps use safety air release to stop pressure from suction fitting. If bather blocks suction with body or other objects, the pump stops pumping to prevent drowning if hair etc, is caught in the suction fitting by pump pressure.