

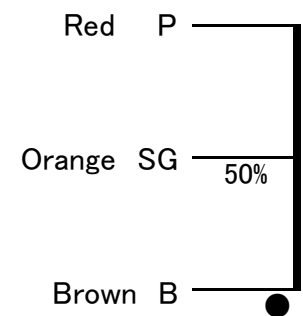

FME-20WS
 FINEMET® NANOCRYSTALLINE Core Single Ended Output Transformer Audio Feast

Wiring Connection



	2.5k	3.5k	5k	Pri. Zp(Ω)
Blue	16			
Purple		16		
Gray	8		16	Sec. Zs(Ω)
White	6	8		
Yellow	4		8	
Black	COM			

Output 20W 50Hz 5K, 20W 40Hz 3.5K, 20W 35Hz 2.5K
 Freq. Response 14-40KHz (2.5K-8 ohm, 1W, -3dB)
 Pri. Inductance 15H (DC 80mA 50Hz)
 Pri. DCR 200 ohm, Sec. DCR 0.51 ohm (5K-8), Loss 0.44dB
 Pri. max DC Current 170mA
 Dimension 100x90x120(H)mm Black hammered metal case, or Urushi finish

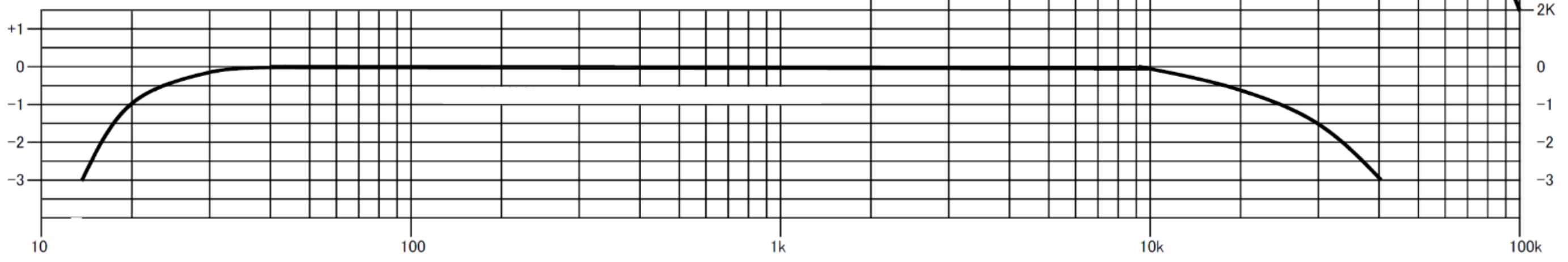

Email: CleanUnderwear@gmail.com
 Web: TheAudioFeast.com
 Distributed by Audio Feast (Nashville, TN, USA)
 Final finish by Teramoto (Myoko, Japan)
 Designed by General Ind. (Saitama, Japan)

Available on Black metal case OR
Urushi finish

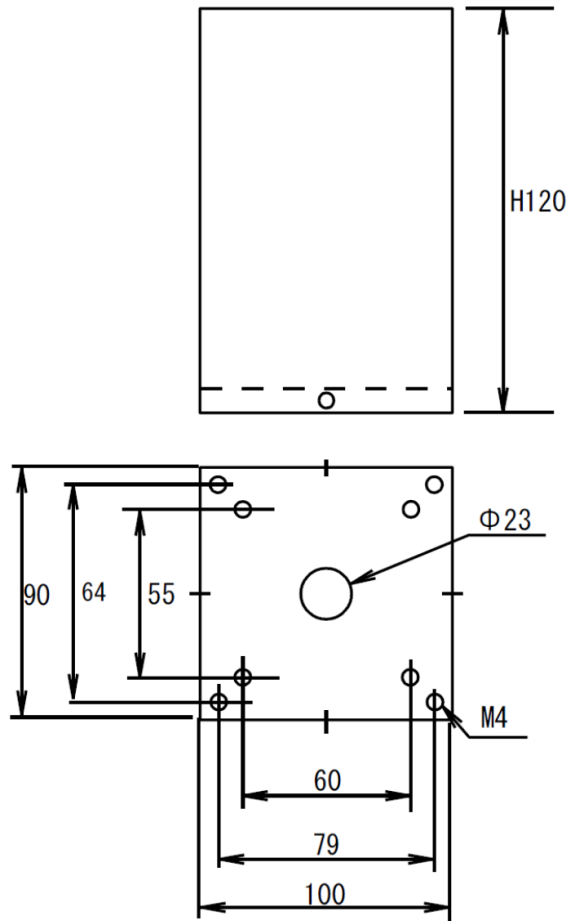

Black Metal Case



Urushi finish

All dimension is in mm.

Dimension does not include screws around the case.

