



GUARANTEE

10.437

N.º _____

INSTRUCTIONS

SECTIONAL VIEW
AND PARTS LIST

SANTA BARBARA GUARANTEE

NEW MODEL ARMY REVOLVER CAL. 44

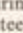
This arm has been proof tested according to the rigid standards established by The International Proof House Commission (C.I.P.) and confirmed by the marks  and  on the parts of the gun subject to stress during firing, by the Spanish Government and is fully guaranteed to the original purchaser against any defects in material or workmanship present at the time of purchase.

SANTA BARBARA agrees to correct such defects by repair or replacement at our option, if the complete gun is returned to the point of purchase, postpaid. Full instructions concerning the nature of the problem must accompany the gun which must be COMPLETELY UNLOADED. Return must be made within one year of original purchase.

This guarantee does not cover any service required because of normal use or wear of any part including blueing or wood finish and is void if gun has been subjected to abuse, damage, unauthorized servicing, or if unauthorized alterations have been made. No one is authorized to vary the terms of this guarantee.

THE GUARANTEE WILL BE VOID IF ANY PROPELLANT OTHER THAN BLACK POWDER HAS BEEN USED AND THE MANUFACTURER WILL ACCEPT NO LIABILITY FOR THE CONSEQUENCES OF SUCH USE.

Empresa Nacional Santa Bárbara de Industrias
Militares, S. A.

Spanish National Weapons Factories

INSTRUCTIONS FOR CAP AND BALL REVOLVERS

ONLY «BLACK POWDER» CAN BE USED IN THIS TYPE OF FIREARM

1. Clean out all grease and oil inside the barrel and cylinder.
2. Set the hammer at half-cock and place a percussion cap on each nipple. Cock and fire (without a powder charge) until all caps have been exploded. This will clean any foreign matter from the nipple flashholes.
3. Set the half-cock and hold the revolver in an upright position. Fill each chamber in the cylinder with 3f (fffg) «BLACK POWDER». Cylinders can be filled leaving just enough room to seat the ball.
4. Place the lead balls on the chambers of the cylinders and push down on the loading lever until the ball is firmly seated on the powder charge. Do not crush the powder.
5. Fill the remainder of the cylinder chamber with grease.
6. Place a cap on each nipple. For convenience we recommend using a straight line nipple capper.
7. For fety position set yuor hammer down between the caps on the cylinder nipples.
8. Do not «dry fire» the revolver as the nipples will be damaged unless protected by the percussion cap.

YOU ARE NOW PREPARED TO FIRE

NEW MODEL ARMY REVOLVER, .44 caliber

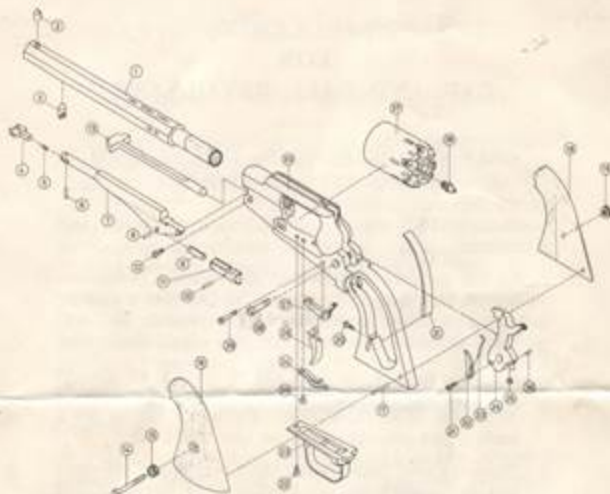

NEW MODEL CAL. 44 REVOLVER PARTS

DRAWING NUMBER	NAME	PART NUMBER	DRAWING NUMBER	NAME	PART NUMBER
1	BARREL	R. R. 44001	10	MAIN SPRING SCREW	R. R. 44008
2	FRONT SIGHT	R. R. 44002	11	MAIN SPRING	R. R. 44009
3	LOADING LEVER RETAINER	R. R. 44003	12	TRIGGER GUARD SCREW	R. R. 44010
4	LOADING LEVER LATCH	R. R. 44004	13	TRIGGER GUARD	R. R. 44011
5	SPRING CATCH	R. R. 44005	14	TRIGGER & CYLINDER STOP SPRING	R. R. 44012
6	LATCH PIN	R. R. 44006	15	SPRING RETAINER SCREW	R. R. 44013
7	LOADING LEVER	R. R. 44007	16	TRIGGER	R. R. 44014
8	LATCH PIN	R. R. 44008	17	CYLINDER STOP	R. R. 44015
9	LATCH	R. R. 44009	18	HAMMER SCREW	R. R. 44016
10	REAR HAMMER PIN	R. R. 44010	19	TRIGGER & CYLINDER STOP SCREW	R. R. 44017
11	BULLET HAMMER	R. R. 44011	20	FRAME	R. R. 44018
12	LOADING LEVER SCREW	R. R. 44012	21	HAND SCREW	R. R. 44019
13	CYLINDER PIN	R. R. 44013	22	HAND	R. R. 44020
14	DRIP SCREW	R. R. 44014	23	HAND SPRING	R. R. 44021
15	DRIP WELDER	R. R. 44015	24	HAMMER	R. R. 44022
16	LEFT DRIP	R. R. 44016	25	ROLLER	R. R. 44023
17	DRIP PIN	R. R. 44017	26	ROLLER PIN	R. R. 44024
18	RIGHT DRIP	R. R. 44018	27	CYLINDER	R. R. 44025
19	DRIP NUT	R. R. 44019	28	SPRIG	R. R. 44026

Santa Bárbara  **FABRICA DE ARMAS DE FUEGO**

USE DRAWING NUMBER, NAME AND PART NUMBER WHEN ORDERING PARTS

U.S. Patent Office
Copyright © 1938, R. R. & F. Co., Inc., Springfield, Mass.
Manufactured in U.S.A.