

ClearCreek Siding

Installation Instructions

Concrete Log and Timber Siding

(January 2019)

Thank you for taking the time to review these Installation Instructions.

If you have any questions, we are only a phone call away.

(417) 862-9511

ClearCreek's training program consists of three easy steps:

- **Step 1** – Watch Installation Videos
- **Step 2** – Review Installation Instructions, Photos & Diagrams
- **Step 3** – Pre-Installation visit with Install Professional
(by phone or at our facility)

We ask that these three steps take place prior to installation so that your installation is a success. While a warranty will be issued without that completion, there will be a note attached to the warranty indicating that training was not completed.

Table of Contents

Prior to Installation		
	Page 3	Receipt of Order
	Page 3	Storage and Handling
	Page 3	Special Tools You Will Need
	Page 4	Recommended Installation Sequence
	Page 4	Cutting
	Page 5-6	Key Installation Info
Installation		
	Page 7	Getting Started
	Page 7	Decks, Porches, Rakes, and Custom Concrete Trim
	Page 8	Install Round Outside Corner Base
	Page 8	Install Inside Corners
	Page 9	Install Starter Course
	Page 10	Install Siding
	Page 11-12	Install Window and Door Trim: Sill, Head and Termination Trim
	Page 13	Install Outside Corners (Round and Square)
	Page 14	Finishing Up
Additional Information		
	Page 14	Cleaning, Maintenance and Repair
	Page 15	Codes, Climate & Safety

Receipt of Order

ClearCreek's Siding System includes siding, trim, fasteners and silicone. For a complete listing refer to **ClearCreek's Part Catalog**.

The following paperwork is included with each order:

- **Packing Slip**
A list of items included on order
- **Installation Instructions**
A copy of these Installation Instructions
- **Load Sheet**
A list of material on each pallet
- **Part Catalog**
A complete list of all items offered by ClearCreek
- **Sill Schedule**
A list of window and door Sill and Head trim.

Storage and Handling

Siding and Accessories:

Store product in a dry area until installed. Product that is stored wet may develop stains.

To avoid cracking or breaking, carry product on end and make sure it is supported on each end.

Damage due to improper storage or handling is not covered by the warranty.

Silicone:

At all times the manufacturer's instructions should be followed as they relate to storage and permissible installation conditions. For best results, store at room temperature prior to use.

Concrete Sealer:

Do not allow concrete sealer to freeze. If it does, it will no longer be useable.

Special Tools You Will Need

Required:

- 12" Sliding Miter Saw with recommended blade
- Circular Saw with recommended blade
- Caulk gun
- Screw gun

Optional:

- Table saw with recommended blade
- Jigsaw with recommended blade
- 4" angle grinder with recommended blade
- Keyhole Saw - This is used for short cuts

Recommended Blades:

- Blades designed for fiber cement board cutting
- General purpose segmented masonry blades
- For jigsaws, use blades designed for tile cutting

Recommended Installation Sequence

1	Determine starting elevation
2	For projects with round corners, install Wooden Corner Base
3	Install starting point Inside Corner or begin first wall at Outside Corner moving from Left to Right.
4	Install Starter Clips
5	Install Starter Course (first course of siding)
6	<p>Install Siding</p> <p>The following are done as they are encountered:</p> <ul style="list-style-type: none"> • Install Head and Sill Trim • Install Accessory Blocks • Apply Foam Coat 550, as needed
7	Install Outside Corners and 135 Degree Outside Corners and window and door Termination Trim
8	Complete required window/door and accessory caulking
9	Fill in screw holes with Concrete Fill Mix and Sealer

Cutting

Siding	<p>Cut siding to length with a miter saw using a recommended blade.</p> <p>Cut siding to conform to the shape of the Sill and the Head trim as well as other building features.</p> <p>In some cases when a long cut is required, a table saw may be used.</p>
Inside and Outside Corners	<p>Cut Inside and Outside Corners with a miter saw with a recommended blade. <u>Do not cut end that is finished.</u></p>
Termination Trim	<p>Cut Termination Trim to length with a miter saw.</p> <p>When used as window Termination Trim, cut the bottom edge at an angle to conform to the slope of the Sill.</p>
Sill and Head Trim	<p>The Sill and Head trim parts are produced to length in the factory so that the exposed ends may receive the same concrete coating as the other parts.</p>

Key Installation Info

<h2>Fastener Placement</h2>	
<ul style="list-style-type: none"> • Starter Clips 2 ½ screws 36" on center • Starter Siding Course 2½" screws with ¾" washer 12" on Center 	<ul style="list-style-type: none"> • Siding 2.5" screws with ¾" washer 24" on Center • Trim 5" screws, unless otherwise specified
<h2>Siding/Trim Placement</h2>	
<ul style="list-style-type: none"> • Maintain siding system a minimum of 6" above the finished grade 	<ul style="list-style-type: none"> • Maintain siding system a minimum of 1" above roofs, decks, porches, etc.
<ul style="list-style-type: none"> • The first course of siding, or "Starter Course," will require a starter clip. • The siding is attached to the wall with a 2 ½" screw with a ¾" nylon washer. DO NOT over-tighten • Set screw at the middle top flange at a 20 degree angle and keep at least 1 ½" from the ends of siding. • When attaching Sill and Head trim, set the head of 5" screw just below the surface of the concrete. Do not over-tighten. Set the screw so that the surrounding siding will cover the screw head. 	
<p>Treating Cut Ends with Foam Coat 550</p>	<p>In cases where siding or trim does <u>not</u> terminate into another piece of trim, coat exposed foam with Foam Coat 550. For example, the bottom of a door termination trim.</p> <p>This treatment is ONLY required if the cut end (exposed foam) does NOT terminate into another part</p> <p>Do not apply to siding that terminates into a corner or termination trim.</p>
<p>Clear Silicone</p>	<p>Silicone will be used at:</p> <ul style="list-style-type: none"> • All end-to-end siding joints • Siding to Termination Trim or Corner • Siding to Sill and Head trim • Termination Trim to Sill and Head trim
<p>Concrete Fill Mix and Sealer</p>	<p>At installation completion, fill screw holes with Concrete Fill Mix. Once Concrete Fill Mix has dried, apply Concrete Sealer.</p>

Key Installation Info (continued)

DO NOT:

- Bounce parts.... They may crack.
 - Install siding or any accessory such that it is in contact with dirt/grade.
 - Leave stray concrete dust on the siding. If it gets wet it is difficult to remove.
 - Leave foam exposed.
 - Smear clear silicone on siding or trim. It is very hard to remove.
-

ALWAYS:

- Verify correct Sill and Head trim sizes upon delivery.
- Ensure doors and windows are properly flashed/taped prior to installation.
- Protect product from weather prior to installation.
- Protect Concrete Sealer from freezing.

Getting Started

Establish the beginning elevation on each wall as you would with most horizontal siding products.

<ul style="list-style-type: none"> • Maintain siding system a minimum of 6" above the finished grade 	<ul style="list-style-type: none"> • Maintain siding system a minimum of 1" above roofs, decks, porches, etc.
<ul style="list-style-type: none"> • Only fasten siding and accessories to structural sheathing such as a code approved OSB or Plywood or to framing members. <p>For other types of sheathing or walls, please contact your ClearCreek Siding representative.</p>	<ul style="list-style-type: none"> • Apply siding system over a weather-resistant barrier in accordance with local building codes. • As with all siding systems, it is CRITICAL that all window, door and other wall openings be properly sealed and/or flashed, including at the roofline.

- The Starter Course siding may terminate at the foundation from ½" to 3" below the sheathing. A level line should be established where the Starter Course siding will be positioned.
- All joints should be tight as there is minimal expansion and contraction. Placement of the joints is primarily an aesthetic feature. **However, use of siding pieces that are less than 2' is not recommended, unless necessary.**
- Avoid placing end-to-end joints within 6" of the head trim if possible.
- Each piece of Log and Timber Siding has a concrete coated factory end. Always use factory ends to join pieces of siding end to end. Cut ends of siding should only be joined to pieces of trim such as a Termination Trim or Corner.

Decks, Porches, Rakes, and Special Details

Starting elevation changes may occur at decks, porches, and foundation changes. It is preferable to accommodate these changes using full courses of siding.

For Example - A single course of Log Siding (with Chinking) is 7 ½" tall. If a deck is 13" above the foundation line, it would be possible to run the first course of siding such that it hangs 1" below the foundation line, and therefore would run 1" above the level of the porch.

If the elevation change cannot be accommodated by using full courses of siding, the siding can be cut lengthwise. The bottom edge of siding will need to be coated with Foam Coat 550.

In all cases in which the end of Termination Trim does not join to another part, it is necessary to finish the end with Foam Coat 550. It can be applied with a brush or putty knife. **Avoid smearing on face of siding. It is very hard to remove.**

This treatment is **ONLY** required if the cut end (exposed foam) does **NOT** terminate into another part

Round Outside Corner Base

Install Wood Corner Base tight to the wall. See Detail A

Attach the base to the sheathing with a minimum of **four 2 ½"** screws.

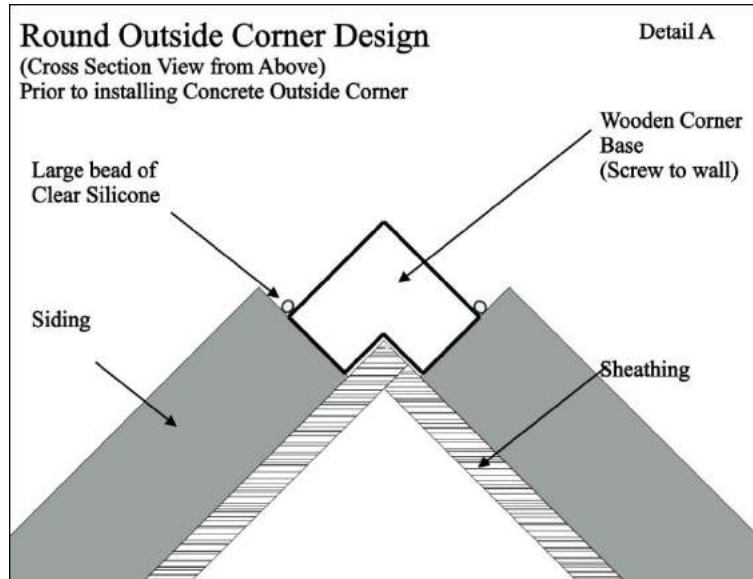

Later in the installation, the siding will be screwed tight to the corner base with a large bead of clear silicone.

Inside Corner

IMPORTANT: Be sure to install corners with finished end facing down.

Set corner **½" to 1"** below anticipated bottom of the Starter Course siding based on aesthetic preference.

Use a minimum of **four 5" screws**. These screws will be set permanently and should be spaced such that they are not visible once siding is installed.

Set screws **12"** from the top and bottom and spaced evenly between these two screws.

During installation, any siding that terminates into an Inside Corner should have a **¼"** bead of clear silicone applied along the edge of the siding where the siding will contact the Inside Corner.

For Multi-story installations, the Inside Corner may be stacked on top of one another. Coat top with clear silicone prior to installing the corner above.

Starter Course

IMPORTANT: Installation is different depending on which Outside Corner style is used.

- Begin the Starter Course in an Outside or Inside Corner location moving left to right.
- Prior to installing the Starter Course, install the **Starter Clips at 36" intervals** at the proper height using a **2 ½" screw**.
- Below is a chart showing where the lowest point of the siding will hang below the top of the Starter Clip:

Log with Chinking	Log without Chinking	Timber with Chinking	Timber without Chinking
3 1/8" to 3 1/4"	3 1/4" to 3 3/8"	3 3/8" to 3 1/2"	3 3/8" to 3 1/2"

See Detail B

Using ROUND Outside Corners

The left edge of the siding should be set snugly against the "Wood Corner Base." It is important that the siding be installed precisely here as the Outside Corner will be installed after the siding and the fit of the corner will be determined by how precisely the ends are set. It is important that the left edge of all siding results in a straight line as the siding is installed up the wall.

Using SQUARE Outside Corners

Temporarily set the Outside Corner in place using **four 5" screws**. Do not overdrive the screw. The corners should be snug.

The corner will be removed and permanently installed later. Do not apply the silicone to the ends of the siding that terminate into the temporarily set Outside Corner at this time.

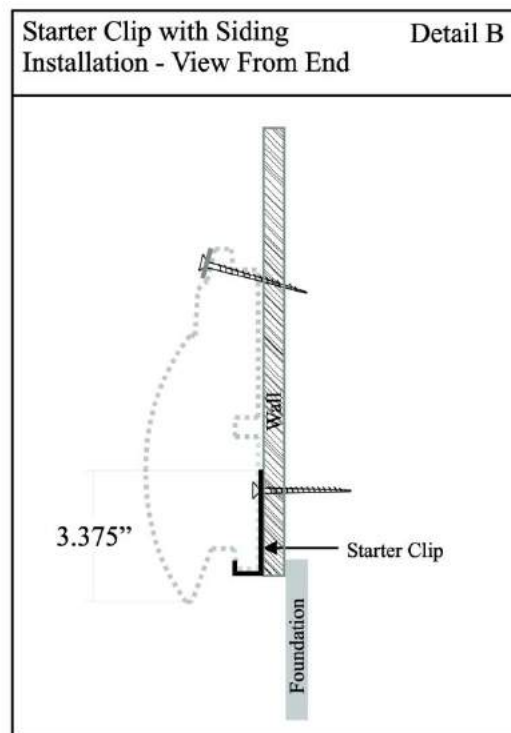

- Install the **Starter Course siding** using **2 ½" screws** and **¾" plastic washers** on **no greater than 12" centers**. Set screws in at the center of the top flange at a 20 degree angle. Do not over sink screw heads. See **Detail B**
- Each piece of Log and Timber Siding has a concrete coated factory end. Always use factory ends to join pieces of siding end to end. Cut ends of siding should only be joined to pieces of trim such as a Termination Trim or Corner.
- In addition to the screws set on 12" centers, install a screw through the top flange 1 ½" from each end of siding. **It is not necessary to screw into studs.**

- After fastening the 1st piece of siding, apply a bead of clear silicone along the length of the right-hand edge of the part. The bead should be approximately ¼" in diameter. **See Detail C**
- The joint between siding parts should be tight since the siding will not expand/contract with moisture/temperature change. **DO NOT** caulk the outside joint.

Detail D



Siding

Install Siding in the same way as the Starter Course, with the exception of setting screws **24" centers**. **See Detail D**

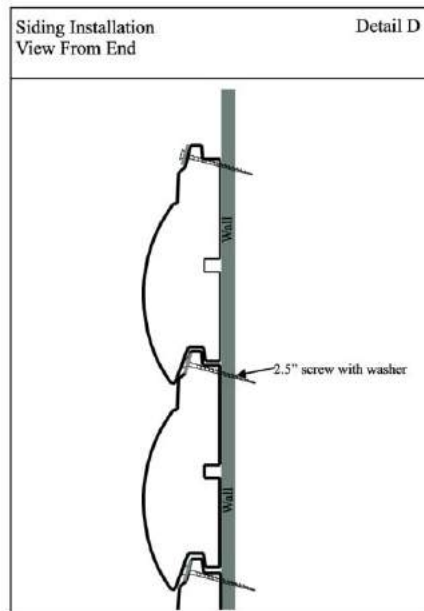

Window and Door Trim

Please read the entire section prior to beginning installation.

Sill and Head trim are finished to length by ClearCreek's. They are attached first. Siding is installed up the wall around them, leaving space for the vertical trim (Termination Trim).

Prior to installing Sill and Head trim, ensure you are using the correct Sill and Head trim for that particular Window or Door.

Sill Trim See Detail E

- Toenail **5"** screws through the Sill trim at an angle such that the screw attaches to the sheathing with a minimum $\frac{3}{4}$ " of screw entering the sheathing. Do not use a washer.
- Ensure that the screw does not enter the window frame. Set the screw head carefully just at the surface of the concrete coating. **DO NOT** allow the screw head to break through the concrete layer of the trim.
- Set a minimum of **two 5" screws** approximately **2"** from each end of the Sill trim. Longer trim may require additional screws.
- Toenail a **2 1/2" screw** at the top of the Sill where the bottom of the termination will cover the screw head. These screws will remain permanently installed.

Head Trim

- Install the Head Trim over the Door or Window in a manner similar to that of the Sill. Toenail above and also from below where the Termination Trim will cover the screw.

Cut Siding around Sill/Head Trim

- The siding will need to be cut in order to fit around the Sill and Head trim. It is useful to use a scrap piece of siding to transfer marks to the siding to be cut. Dry fit the part in place to ensure that the part fits well.
- When installing Siding below a window, back cut the top of the Siding to clear the Sill. See Detail E

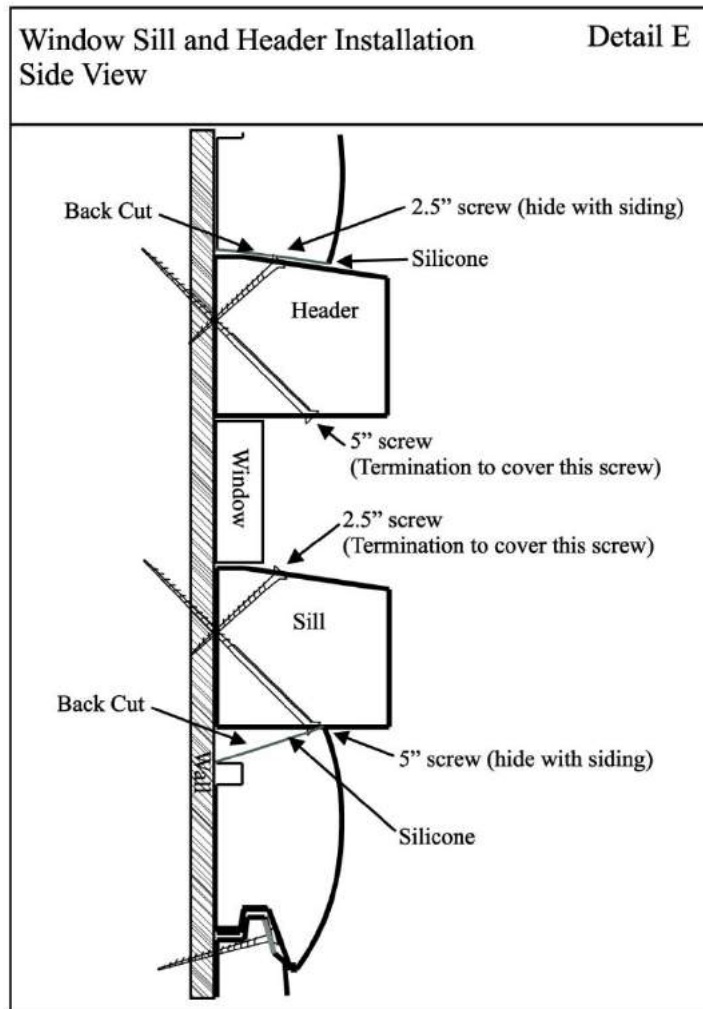

- If the siding that runs under the Sill is less than 1 ½", it is acceptable to silicone and/or screw part in place under the Sill instead of attempting to run a complete piece of siding under the Sill. The part can be cut from a piece of scrap siding and screwed in place. The joint between the fill piece and the siding should be caulked using the clear silicone. **See Detail F**

Termination Trim See Detail G

(Vertical trim on left and right side of window/door frame)

- Use a scrap piece of Termination Trim to determine the proper space to leave for the Termination Trim as Siding is installed up each side of the door or window.
- The Termination Trim is installed after the Siding.
- The Termination Trim must be cut to the proper length and must be cut to the proper angle.
- Prior to installing the Termination Trim,
 - Place a ¼" bead of clear silicone on the entire edge of the siding that will be positioned against the Termination Trim.
 - Place a ¼" bead of clear silicone at the bottom of the Head Trim and the Top of the Sill where it will come into contact with the vertical Termination Trim.
 - Install the Termination Trim using 5" screws.

The Termination Trim should fit snug in the pocket created between the installed siding and the window or doorframe, but it should not be forced to fit as the edge of the siding may break.

Caulking

- Caulk all joint between Sill or Head trim and the adjacent siding using the clear silicone.

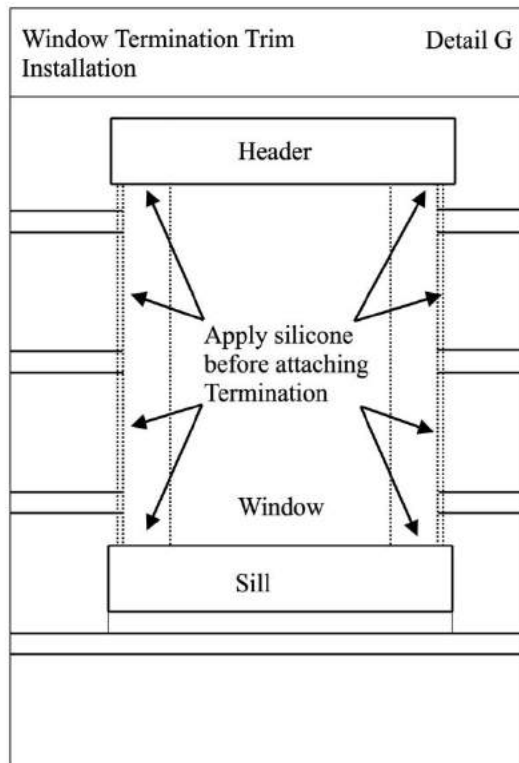
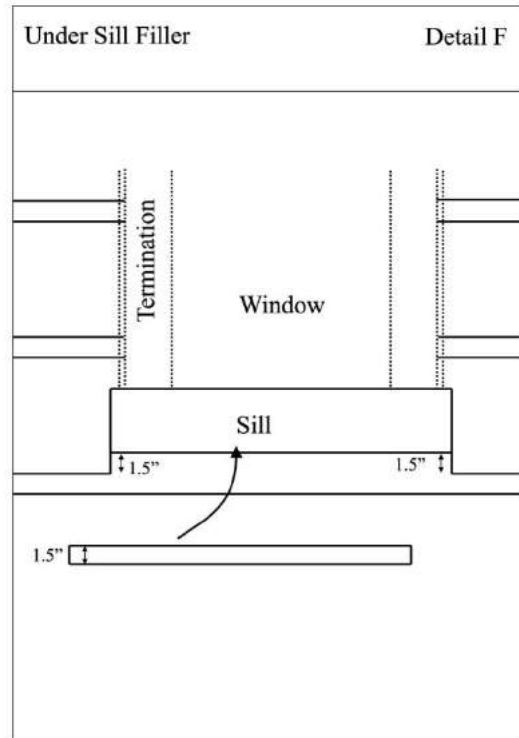

Outside Corners

After installing siding up the wall as far as required, the Outside Corners may be permanently installed.

IMPORTANT: Be sure to install corners with finished end facing down

- Set corner $\frac{1}{8}$ " to 1" below anticipated bottom of the Starter Course siding based on preference.
- After carefully cutting and dry fitting the corner, place a $\frac{1}{4}$ " bead of clear silicone along the entire edge of each wall of siding that will be in contact with the edges of the Outside Corner Trim. **See Detail H**
- Apply $\frac{1}{4}$ " bead of clear silicone in the shape of "S" down the length of the two faces of the wood corner base.

DETAIL H

A -Prior to Sealant

B -Sealant Applied

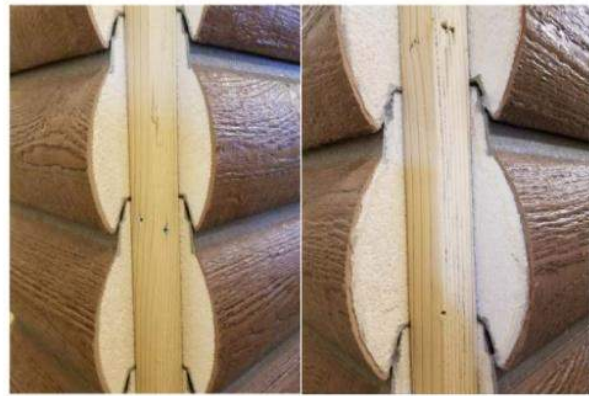

Position the corner and secure with **four 5" screws**. Ensure that the corner is set tight to each wall of siding. Counter sink screws

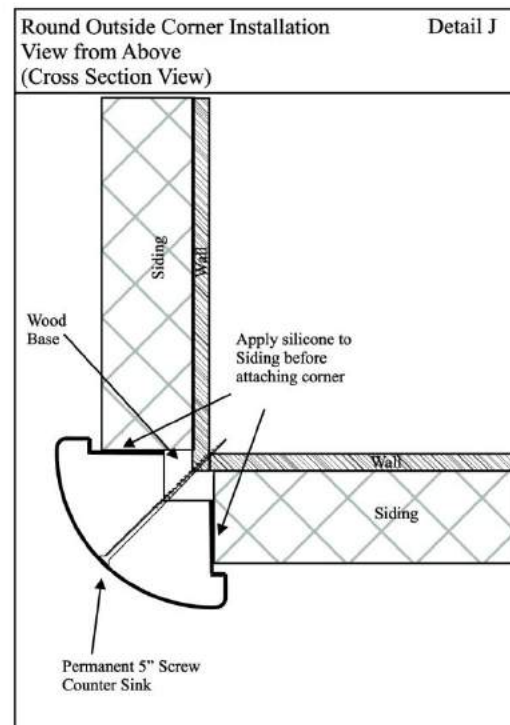
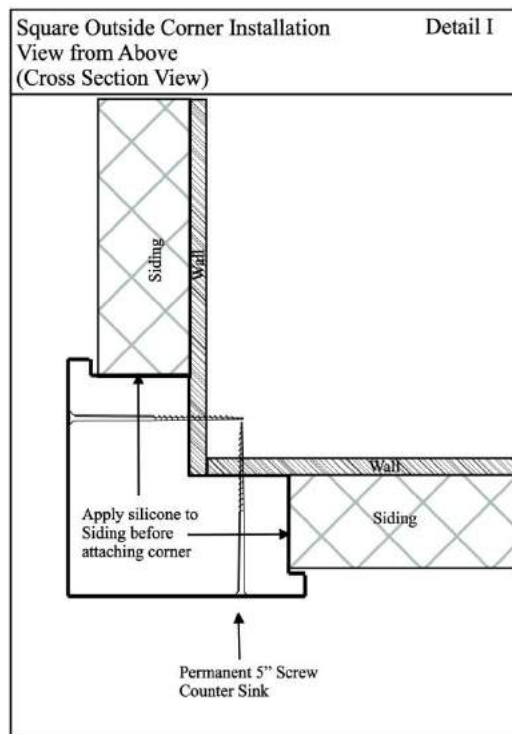

Finishing Up

Cover screw holes	At installation completion, fill screw holes with Concrete Fill Mix . Once Concrete Fill Mix has dried, apply Concrete Sealer .
Caulk Window/Door Trim	Caulk all window and door joints with clear silicone.

Cleaning, Maintenance and Repair

Cleaning

Dirt, tree debris, bird droppings, and other contaminants may be removed by simply washing with a garden hose or power washer. Use only a wide fan tip at a minimum of 6' from wall at pressures under 1500 psi.

Damage to the siding can occur from improper cleaning and is not covered under the warranty.

Maintenance

To ensure the longevity of your Concrete Siding, we recommend you do an ANNUAL review for periodic maintenance and/or repair. Specifically you will want to look for the following:

Silicone around Window and Door Trim and Accessories - It is important to do a periodic review of the caulking around your windows, doors and accessories to ensure it is intact.

Concrete Sealer - Our siding comes coated with Concrete Sealer. However, it is important to perform a periodic review to make sure your product is still adequately protected. The best way to do this is to wet several small areas on each wall and wait a few minutes. If the spot disappears quickly, it is time for a fresh coat of sealer.

Repairs

Small scratches to the finish of the siding may be removed or greatly diminished by applying a coat of ClearCreek Siding Sealer. Larger patches can be fixed with a little Concrete Fill Mix and Concrete Sealer.

If you have any questions or encounter any of the items listed above, please give **ClearCreek** a call at **417-862-9511** and a ClearCreek representative will assist you.

CODES, CLIMATE AND SAFETY

Building Code

Important -- Failure to install this product in accordance with all applicable building codes and regulations and the most recent Installation Instructions may:

- 1) Violate local building codes
- 2) Lead to personal injury
- 3) Void any and all applicable warranties

Climate Zone

For projects located in very cold regions (Climate zones 6, 7 or 8), please visit with your ClearCreek representative prior to installation. Due to the R-Value of the siding, depending on the wall that will be covered it may be necessary to install a drainage type house wrap prior to siding installation.

Temperature

Be aware that the silicone has specific temperature ranges that are recommended for installation and storage. See containers for specific ranges.

Safety

- Wear protective eyewear whenever using any power tool. Follow all tool and product manufacturer safety instructions.
- Follow all OSHA guidelines.
- When siding components are cut, dust containing crystalline silica may be produced which can pose a health risk. It is important that all cutting and safety instructions be followed.
- Always cut siding and accessories outdoors in a well ventilated area.
- Position cutting station such that wind will blow dust away from user, others in the area and ClearCreek materials.
- Use a recommended blade when using power saws. *Use a dust collection system in association with your saw.*
- NIOSH-approved respirators can be used in conjunction with above cutting practices to further reduce dust exposure.

Tool Safety

- Use double insulated tools or ensure that all tools are properly grounded. Protect all power tools with ground fault circuit interrupters (GFCI).
- Ensure that all saws have required blade guards. Use only the recommended blade types listed in the **Tools** section on Page 4.