

Arta Devi International School  
Holidays Homework  
Session 2026-27

Fun • Learn • Explore • Create

Name : \_\_\_\_\_ Class : 3rd

Section : \_\_\_\_\_ Roll No. : \_\_\_\_\_

"Every child is an artist and every holiday is a new adventure!"

Enjoy Your Summer Vacation



## English Instructions

### हिंदी निर्देश

1. Wake up early and follow a healthy routine.  
सुबह जल्दी उठें और स्वस्थ दिनचर्या अपनाएँ।
2. Read books and practice writing daily.  
प्रतिदिन पुस्तक पढ़ें और लिखने का अभ्यास करें।
3. Complete your holiday homework neatly.  
अपना अवकाश कार्य साफ-सुथरा पूरा करें।
4. Eat healthy food and drink plenty of water.  
पौष्टिक भोजन करें और खूब पानी पीएँ।
5. Use cucumber and onion salad in your meal.  
भोजन में खीरा और प्याज का अधिक सेवन करें।
6. Play outdoor games and exercise regularly.  
प्रतिदिन खेलें और व्यायाम करें।

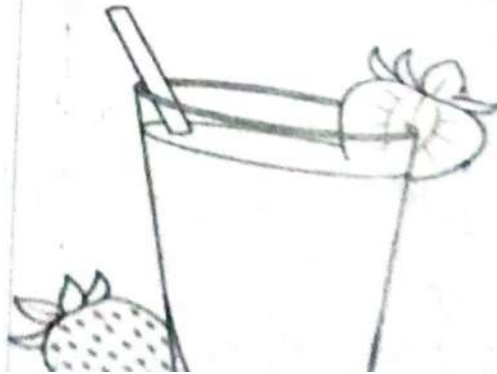

7. Help your parents in household work.  
घर के कार्यों में माता-पिता की सहायता करें।
  8. Avoid use of mobile phones and TV.  
मोबाइल फोन और टीवी का उपयोग न करें।
  9. Keep your surroundings clean and maintain hygiene.  
स्वच्छता बनाए रखें और आसपास साफ रखें।
  10. Learn a new skill like drawing, dancing, singing, or gardening.  
चित्रकला, नृत्य, संगीत या बागवानी जैसी नई चीजें सीखें।
  11. Respect elders and speak politely to everyone.  
बड़ों का सम्मान करें और सभी से विनम्रता से बात करें।
- "Holidays are a time to refresh your mind and learn new things."  
"छुट्टियाँ मन को ताज़ा करने और नई बातें सीखने का समय होती हैं।"

Q: 1 Tick (✓) the correct think.

Answer:-

(a) Brain  (b) Head

(i) We need food to

(vi) Grapevine is a

(a) stay alive

(a) Creeper  (b) Climber

(b) stay unhealthy

(vii) Food gives us

(ii) Which of the followi

(a) Work  (b) Energy

ng is an external organ?

(viii) Which of the following is an example of protective food?

(a) Hand  (b) Lungs

(a) Banana  (b) Egg

(iii) \_\_\_\_\_ keeps our body in good shape

(ix) Which of the following insect is harmful?

(a) good posture

(a) Butterfly  (b) Mosquito

(b) Food

(iv) We live in a

(x) Pucca houses are made up of

(a) Market  (b) House

(v) \_\_\_\_\_ helps us to

(a) Cement and bricks

(b) Bricks and mud

(ii) Bear ⇒

D:2 Write 'will grow'

(iii) Dog ⇒

or 'will not grow'

(iv) Rabbit ⇒

(a) Ant ⇒

(v) Deer ⇒

(b) Baby ⇒

D:4 Read and colour

(c) Tree ⇒

all land transport:

(d) Pen ⇒

Ship Car Boat

(e) Clock ⇒

Aeroplane Taxi

(f) Duck ⇒

Bus Helicopter Jeep

D:3 Choose correct

Rocket Truck

favourite food and

D:5 Cross (x) the odd

write in front of

ones:

of animals given:

(i) Potato, Apple, Banana

[carrot, grass, bone,

(ii) Chair, Pencil, Table

honey, sugarcane]

(iii) Sunday, Monday, Jun

(i) elephant ⇒

(iv) Tiger, Cat, Cow

Q:6 Guess the season: } Kutcha house and

(i) You eat mangoes 'p' for Pucco house  
and watermelon = Bamboo  Glass   
Liment  Wood

(ii) You carry umbrella } Bricks  Iron   
to the school Straw

Q:8 Unscramble the letters:

(iii) You see colourful } ACTDNNGN -  
flowers in the } PITNGINA -  
garden = } CRARER -  
(iv) You see lot of } HEITHAY -  
dry leaves on } HOBIEBS -  
the ground

Q:7 Write 'K' for } Q:9 Fill correct body  
things used for } parts to complete the  
the building a } sentences:

(i) We work or write  
with our \_\_\_\_\_

(ii) We see with our  
\_\_\_\_\_

(iii) We hear with our  
\_\_\_\_\_

(iv) We smell with  
our \_\_\_\_\_

(v) We taste with  
our \_\_\_\_\_

Q:10 Give two examples  
of each:

(i) Summer Clothes  
\_\_\_\_\_, \_\_\_\_\_

(ii) Summer Fruits  
\_\_\_\_\_, \_\_\_\_\_

(iii) Winter Clothes  
\_\_\_\_\_

Q:11 Circle five sense  
organs:-

leg ears hand  
head stomach  
tongue nose lips  
eyes skin  
arm elbow toes

Q:12 Fill all following  
in correct columns:-

Sugar apple eggs  
grain, carrot, rice,  
brinjal, potato, milk  
energy-giving foods

(a)  
(b)  
(c)

Body -

Protective

dinning table, bucket,

Building

Foods

fruit basket, refrigerator

Foods

Kitchen

Bathroom

(a)

(b)

(c)

Dinning Room

Q:13 Write Missing

letters :

(i) C \_ O \_ HS

(ii) S \_ E \_ P

(iii) C \_ \_ L

(iv) U \_ IF \_ R \_

(v) W \_ A R

Q:15 Colour the rain-

bow and write the

name:

(i)

(v)

(ii)

(vi)

(iii)

(vii)

Q:14 Put the things in

the correct column:

(knives, towel, fans, ...)

Q:17 Collect five leaves  
of different plants  
dry them and paste  
in your notebook with  
name of plant:-

Q:16 Make a list:-

Breakfast, Lunch

Bath, Dinner, Play

Brush, Study, T.V

A.M

P.M

Q:18 Write 'L' for living (i)

things 'N' for non- (ii)

living things: (iv)

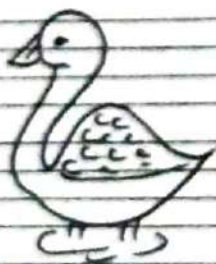

(v)

Q:20 Write 'Yes' or No. Then write the correct answer whenever needed:

(i) Mother's brother is grandfather.

(ii) Uncle's wife is aunt.

(iii) Uncle's children are parents.

(iv) Father's brother is uncle.

(v) Parents parents are

Q:19 Write 5 sense

organs and

also write its

function:

(i)

are cousins.  (iii)

(iv)

(vi) Mother's daughter (v)

is sister.

Q:21. Arrange the follow-

-ing means of

transport from

slowest to fastest:

(i) Bullock cart

(ii) Car

(iii) Auto rickshaw

(iv) Bus

(v) Aeroplane

Ans: (i)

(ii)

Q:22. Draw any five

healthy and unhealth-

-y food :-

Healthy Food

Unhealthy - Food

April

February

September

August

November

June

March

Q:24 Fill in the

Q:23 Fill in the blanks

and put the correct number according to the order:

junk, milk, work, speed, feel, shape,

lungs, toddler, calf

December

January

October

May

July

(i) Bones give \_\_\_\_\_

and support to our body.

(ii) \_\_\_\_\_ helps us to breathe.

(iv) Food gives us energy to do \_\_\_\_\_ (v) A skin helps us to \_\_\_\_\_

(vi) The young one of a cow is a \_\_\_\_\_ Q:25 Write the names of our helpers and write their work:-

(vii) \_\_\_\_\_ is a complete food. Ans:1. Name Work

(viii) Burger and pizza are \_\_\_\_\_ food. 2. 3.

(ix) Car has more \_\_\_\_\_ than a bicycle. 4. 5. 6.

(x) A baby who just learns to walk is called a \_\_\_\_\_. Q:26 Draw any three internal organs:-

(v) Food from animals =  
\_\_\_\_\_, \_\_\_\_\_, \_\_\_\_\_

(vi) Food from plants =  
\_\_\_\_\_, \_\_\_\_\_, \_\_\_\_\_

Q: 28 Solve the riddles:

Q: 27 Write any three names :-

(i) Festival = \_\_\_\_\_  
\_\_\_\_\_, \_\_\_\_\_

(ii) Fruit = \_\_\_\_\_  
\_\_\_\_\_ and energy from

(iii) Vegetable = \_\_\_\_\_  
\_\_\_\_\_ me = \_\_\_\_\_

(iv) Body-building food = \_\_\_\_\_  
\_\_\_\_\_ and I have beauti-  
-ful fins = \_\_\_\_\_

(i) I am tallest animal  
I eat only plants =

(ii) I am yellow in  
colour. People get lights

(iii) I live in water  
and I have beauti-  
-ful fins =

(iv) I am a domestic  
animals. I give  
you milk =

Q:29 Colour the traffic  
lights:-

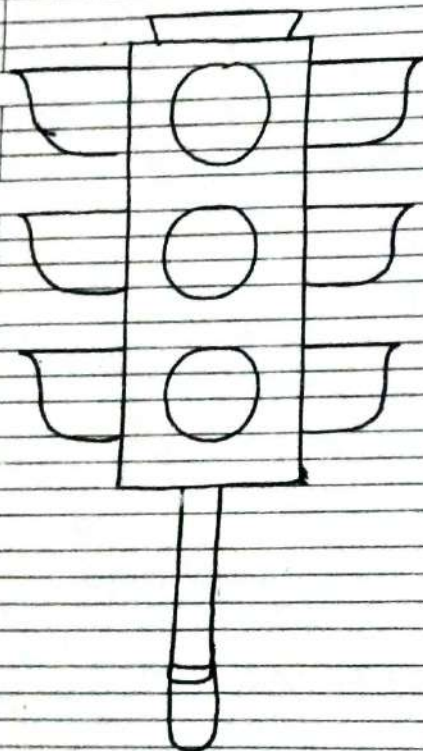

Q:30 Write True or False.

(i) We should eat  
healthy food -

(ii) We should not  
harm the animals

(iii) We should throw  
garbage in water

(iv) We have five  
colours in rainbow

=

(v) We should cross  
the road at zebra  
crossing =

Q:31 Write 10 lines  
on myself.

Q:32 Write A for foods Q:33

we get from  
animals and 'p'  
for foods we get  
from plants:-

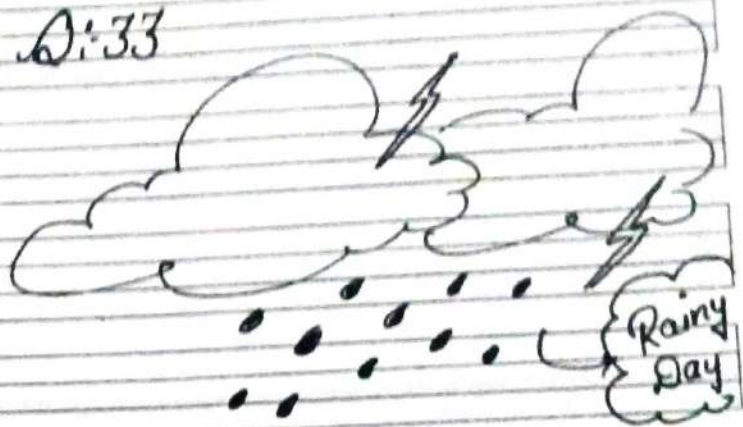
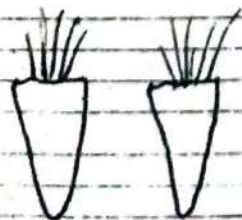
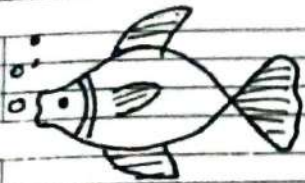

Observe nature for

5 days and write:-

Day I saw... Weather

was

1.

Q:34 Answer the foll. } Ans:-

questions:-

(i) Which organ helps us to smell?

Ans:-

(ii) Which organ helps us to hear?

Ans:-

(iii) Write any two internal organs?

Ans:-

(iv) Write any two external organs?

Ans:-

(v) How many sense organs do we have? Name them.

Q:(vi) Which organs helps us to feel?

Ans:-

Q:(vii) Which body part helps us to hold things?

Ans:-

Q:35 Complete the

puzzle below:-

Down:- 1. Air — the wind mill.

2. Air occupies.

Across:- (3) All living things need air to



Q:-38 Match the following:-

(i) Eggs

(a) Smell

(ii) Legs

(b) Junk food

(iii) Banana

(c) Feel

(iv) Burger

(d) Seas and rivers

(v) Skin

(e) Walk, run, jump

(vi) Fish

(f) Den

(vii) Nose

(g) Banana tree

Q:-39 Write Days of

the week:-

Q:-40 Write months of

the year:-

Q-41. Make a family tree by pasting  
the pictures of your family  
members.

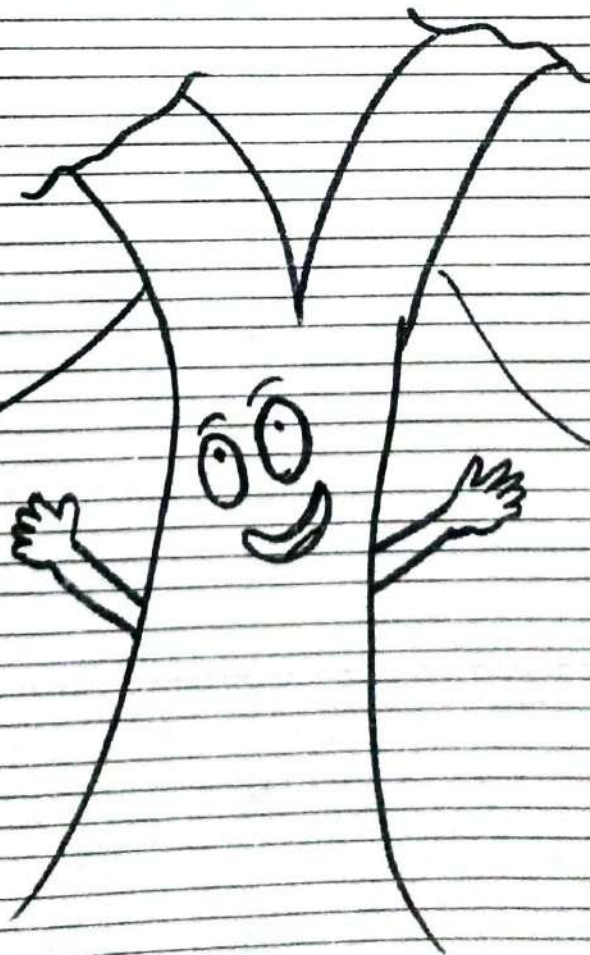

Q:42 Collect the leaves  
and make any  
animals figures:-

Q:43 Paste pencil savings  
on house and write  
types of houses:-

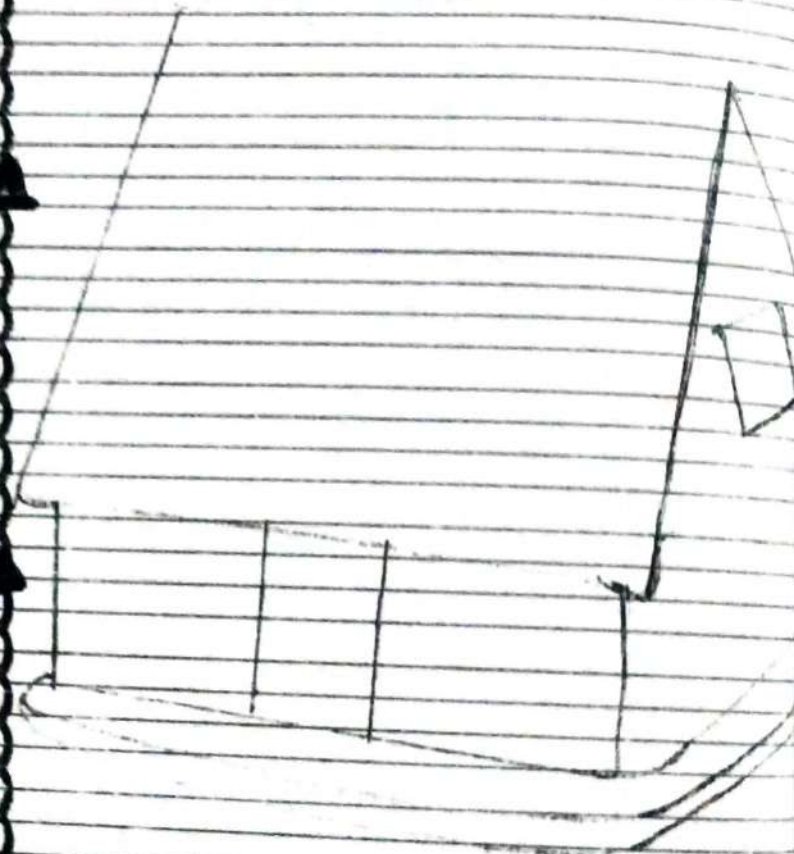





Q-45 Find out the number of wheels each means of transport has. Write it in the given box.

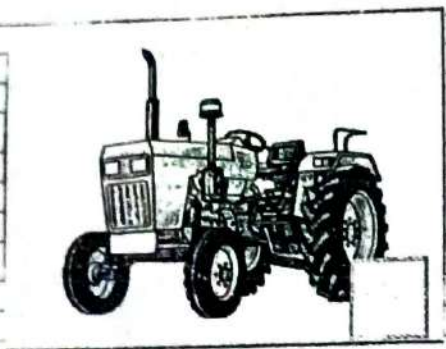
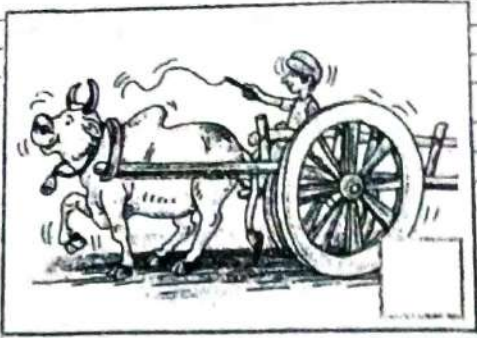
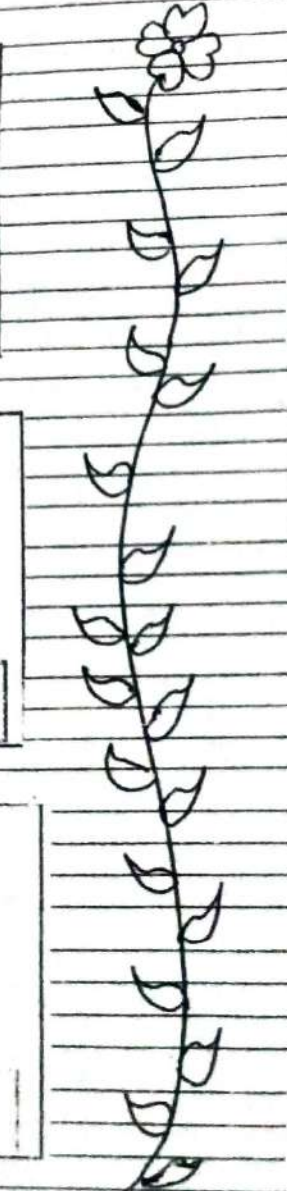
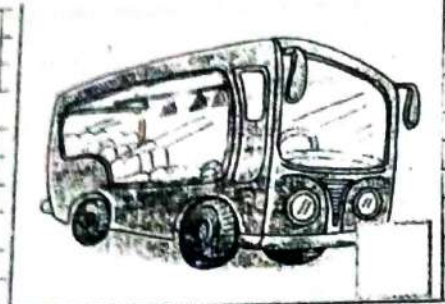

Write spell - well of lesson -

